

## G ELECTRICAL WIRING ROUTING

□ : Location of Connector Joining Wire Harness and Wire Harness

▽ : Location of Ground Points

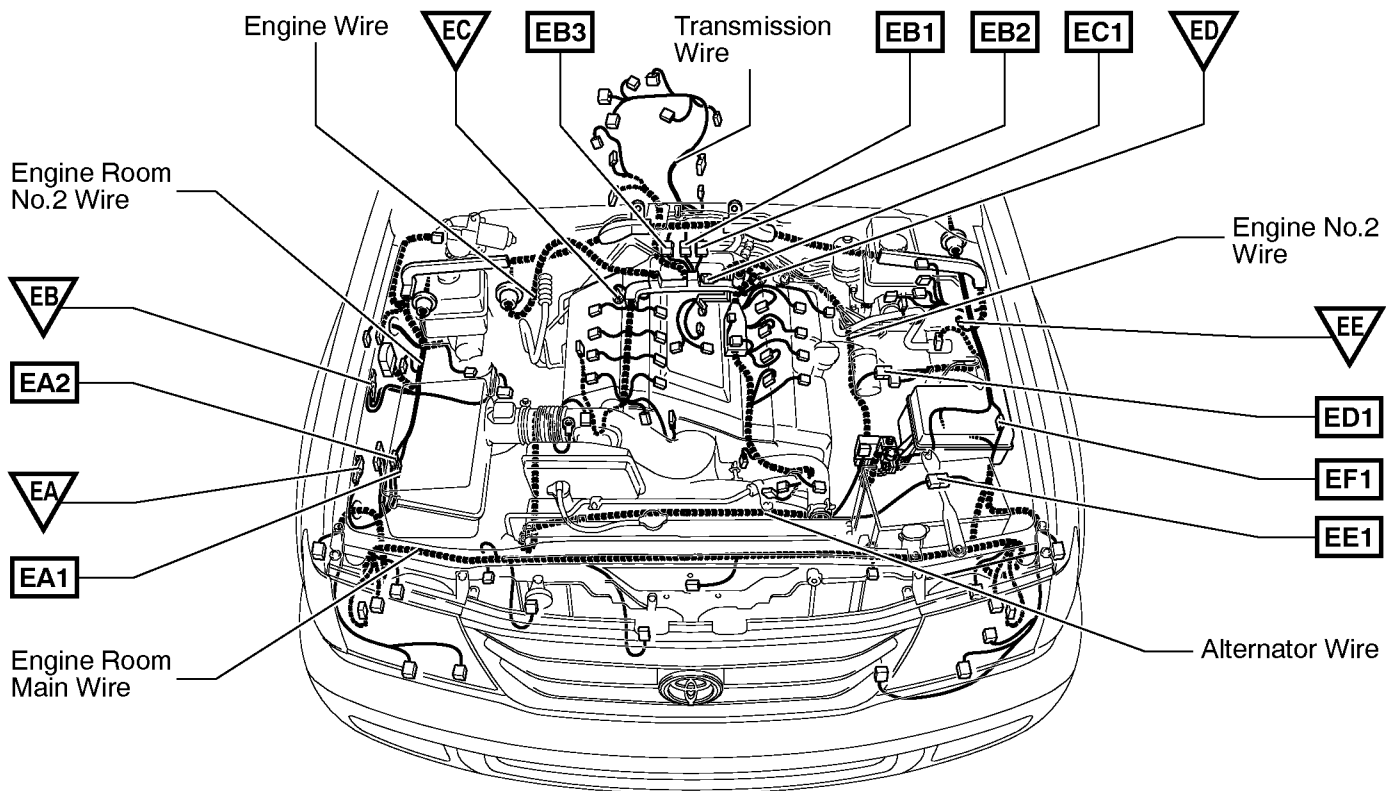

○ : Location of Splice Points

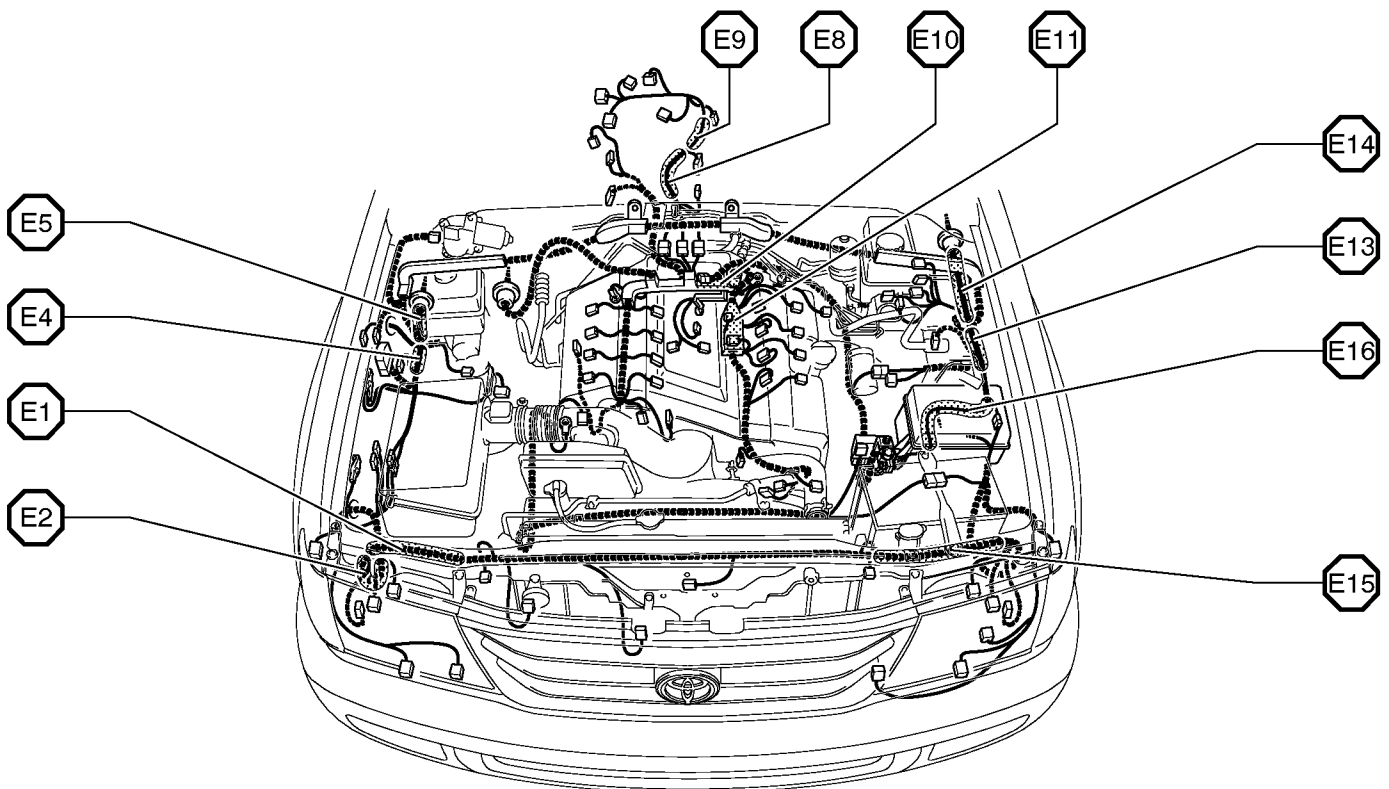

## Connector Joining Wire Harness and Wire Harness

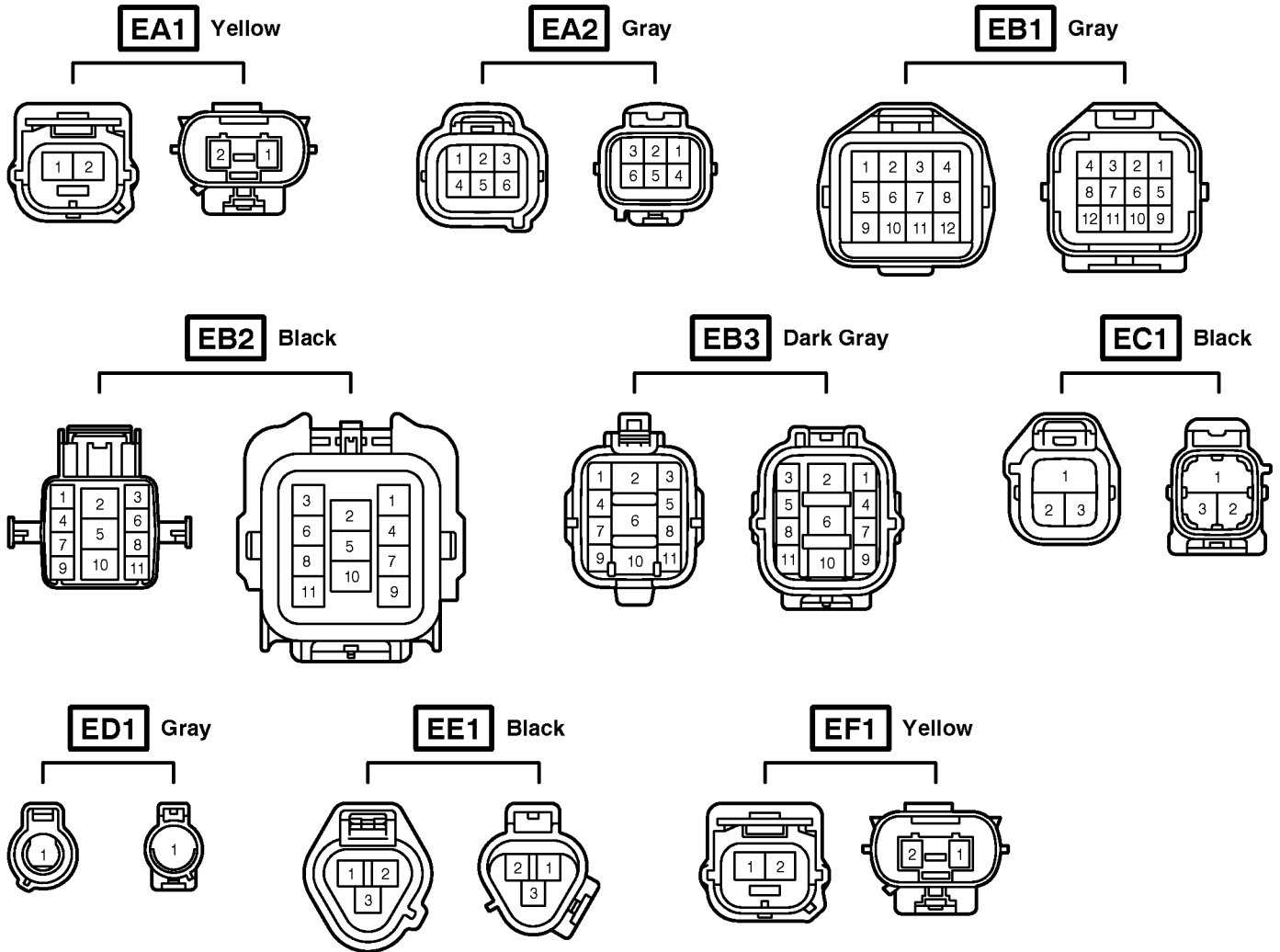

Code	Joining Wire Harness and Wire Harness (Connector Location)
EA1	Engine Room Main Wire and Engine Room No.2 Wire (Engine Compartment Right)
EA2	
EB1	Engine Wire and Transmission Wire (On the Transmission)
EB2	
EB3	
EC1	Engine No.2 Wire and Engine Wire (On the Transmission)
ED1	Engine No.2 Wire and Engine Room No.2 Wire (Near the Engine Room J/B)
EE1	Engine Room Main Wire and Alternator Wire (Near the Battery)
EF1	Engine Room No.2 Wire and Engine Room Main Wire (Under the Engine Room J/B)

## G ELECTRICAL WIRING ROUTING

□ : Location of Connector Joining Wire Harness and Wire Harness

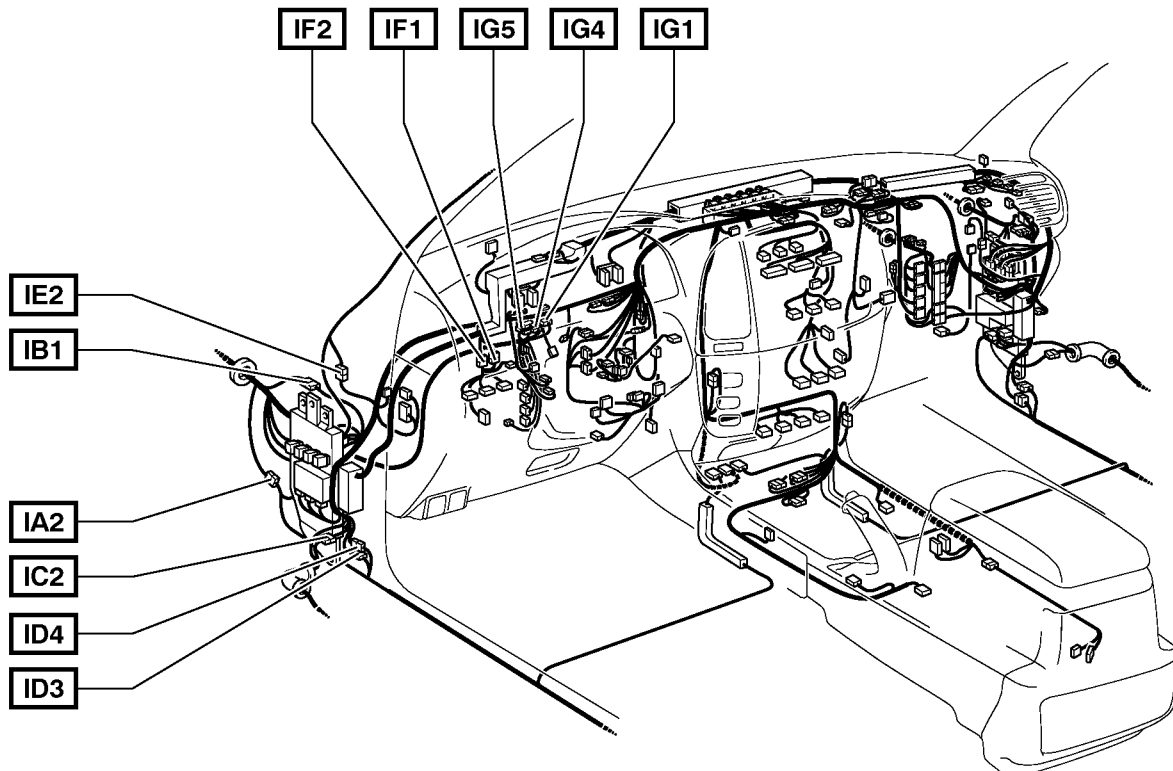

▽ : Location of Ground Points

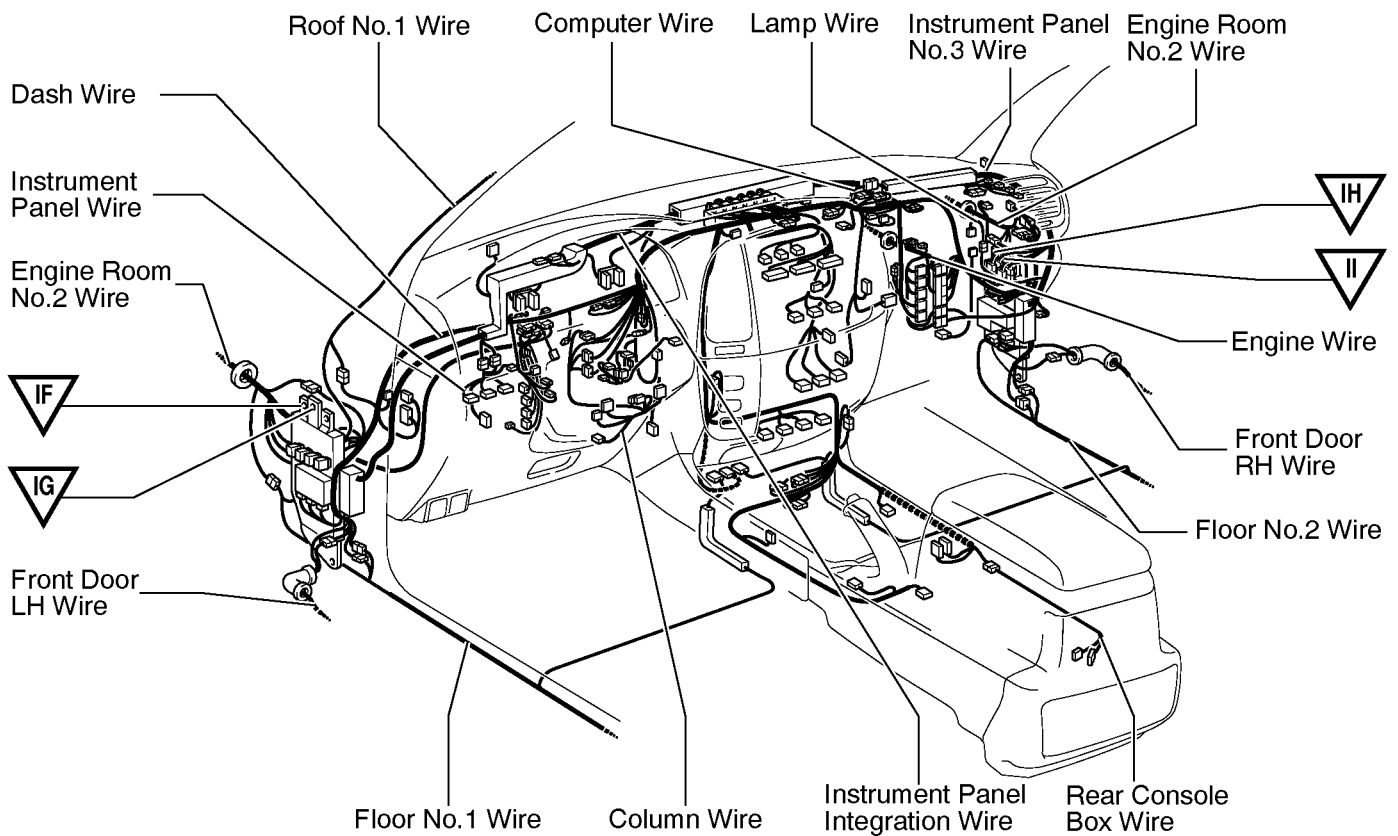

## Connector Joining Wire Harness and Wire Harness

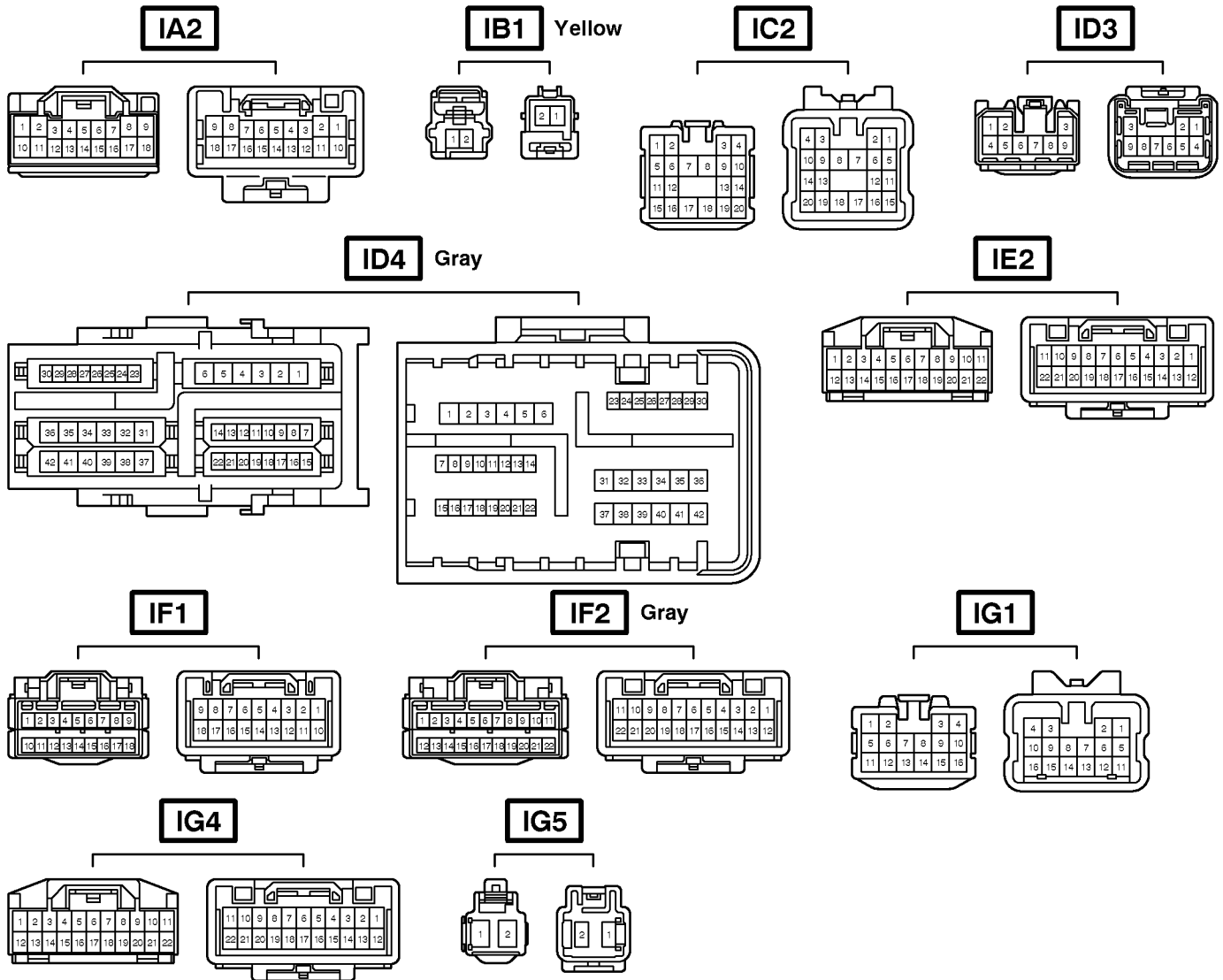

Code	Joining Wire Harness and Wire Harness (Connector Location)
IA2	Engine Room No.2 Wire and Floor No.1 Wire (Left Kick Panel)
IB1	Engine Room No.2 Wire and Dash Wire (Left Kick Panel)
IC2	Front Door LH Wire and Dash Wire (Left Kick Panel)
ID3	Dash Wire and Floor No.1 Wire (Left Kick Panel)
ID4	Dash Wire and Floor No.1 Wire (Left Kick Panel)
IE2	Dash Wire and Roof No.1 Wire (Left Kick Panel)
IF1	Instrument Panel Integration Wire and Instrument Panel Wire (Left Side of Instrument Panel)
IF2	Instrument Panel Integration Wire and Instrument Panel Wire (Left Side of Instrument Panel)
IG1	
IG4	Engine Room No.2 Wire and Dash Wire (Behind the Combination Meter)
IG5	

## G ELECTRICAL WIRING ROUTING

□ : Location of Connector Joining Wire Harness and Wire Harness

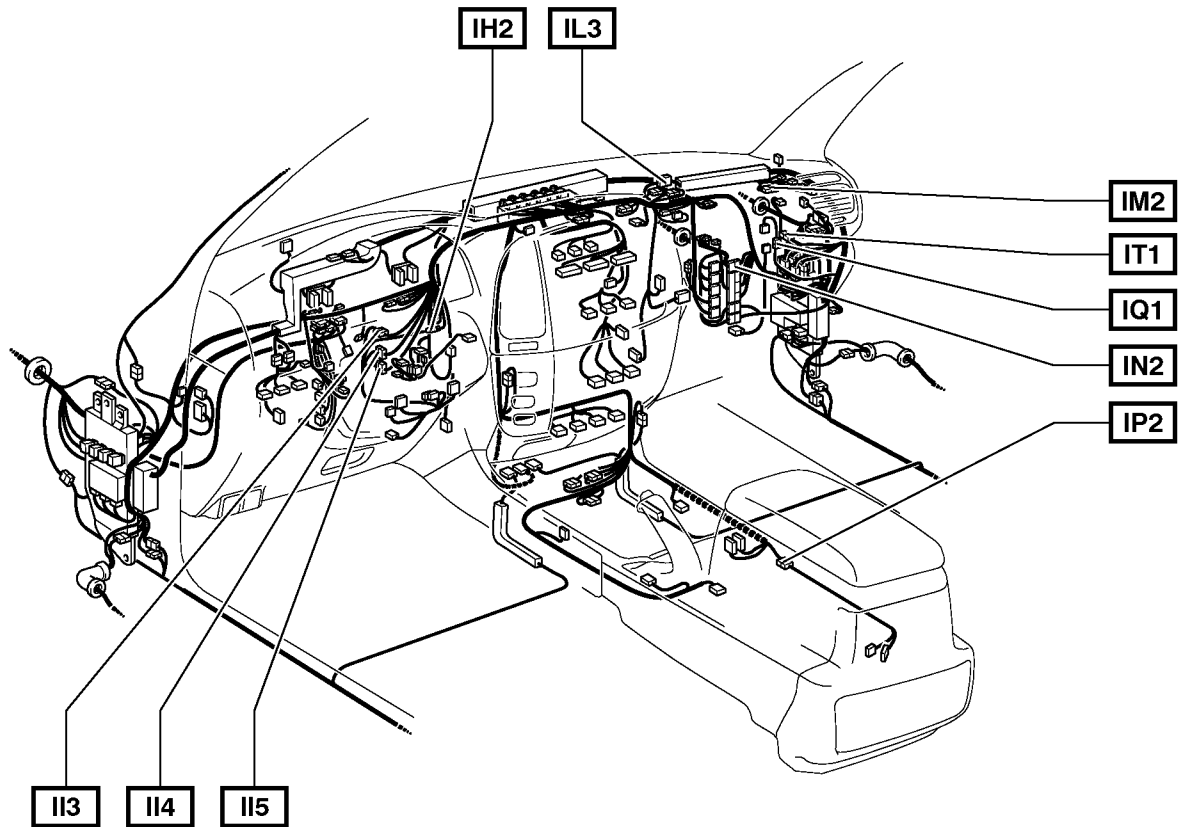

○ : Location of Splice Points

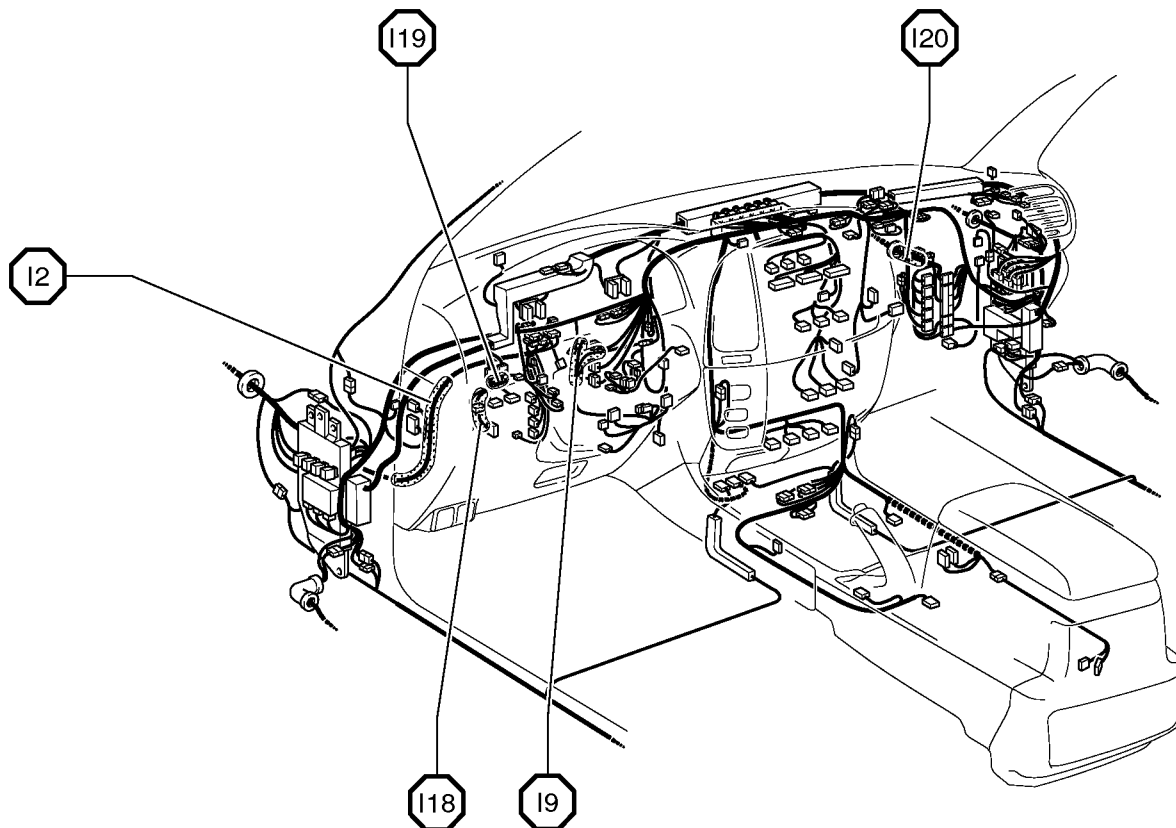

## Connector Joining Wire Harness and Wire Harness

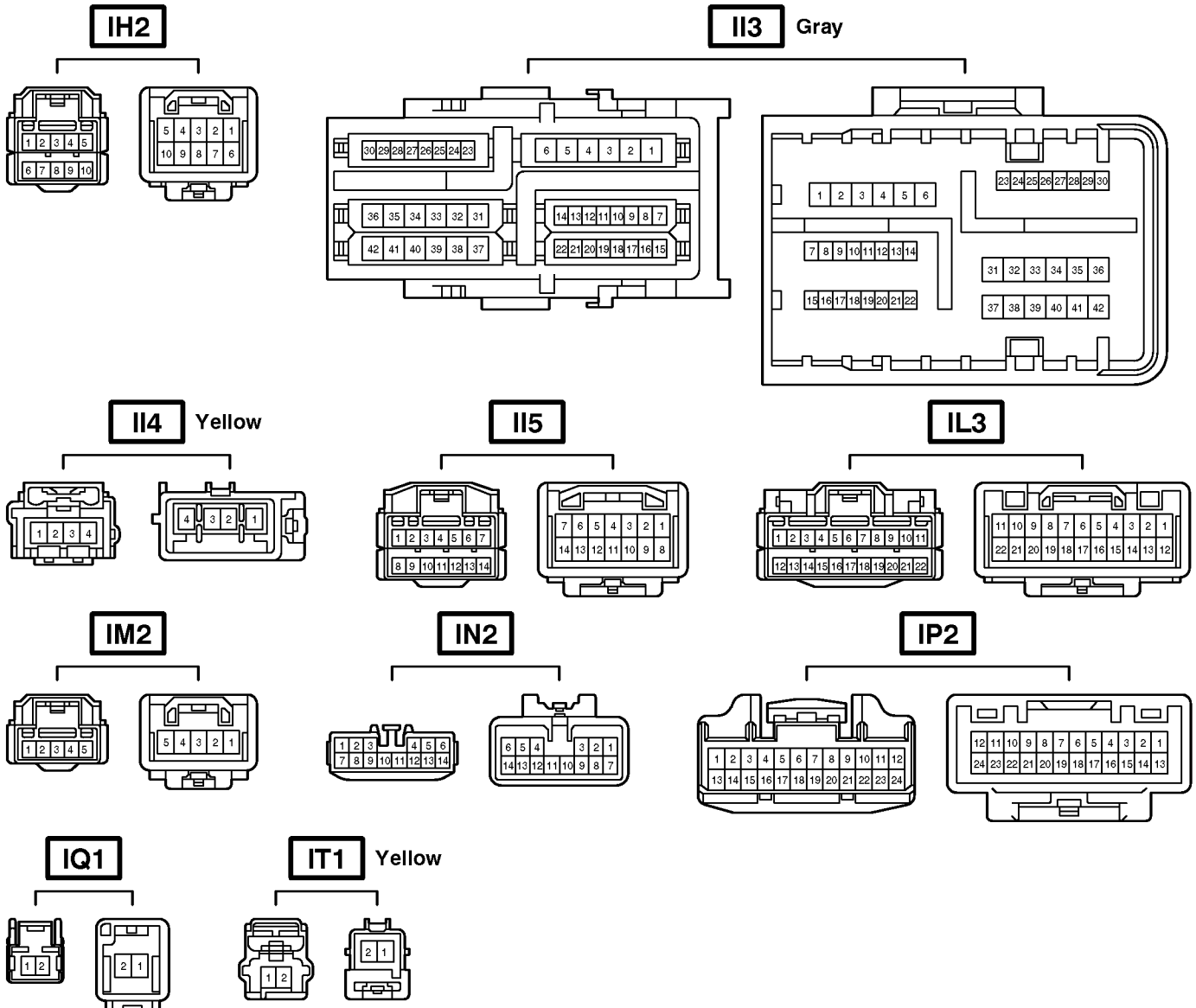

Code	Joining Wire Harness and Wire Harness (Connector Location)
IH2	Instrument Panel Integration Wire and Column Wire (Near the Ignition SW)
II3	
II4	Dash Wire and Column Wire (Near the Ignition SW)
II5	
IL3	Instrument Panel Integration Wire and Computer Wire (Instrument Panel Center)
IM2	Instrument Panel Integration Wire and Instrument Panel No.3 Wire (Right Side of Instrument Panel)
IN2	Engine Wire and Dash Wire (Behind the Glove Box)
IP2	Rear Console Box Wire and Dash Wire (Right Side of Rear Console)
IQ1	Instrument Panel Integration Wire and Lamp Wire (Behind the Glove Box)
IT1	Engine Room No.2 Wire and Dash Wire (Right Kick Panel)

## G ELECTRICAL WIRING ROUTING

□ : Location of Connector Joining Wire Harness and Wire Harness

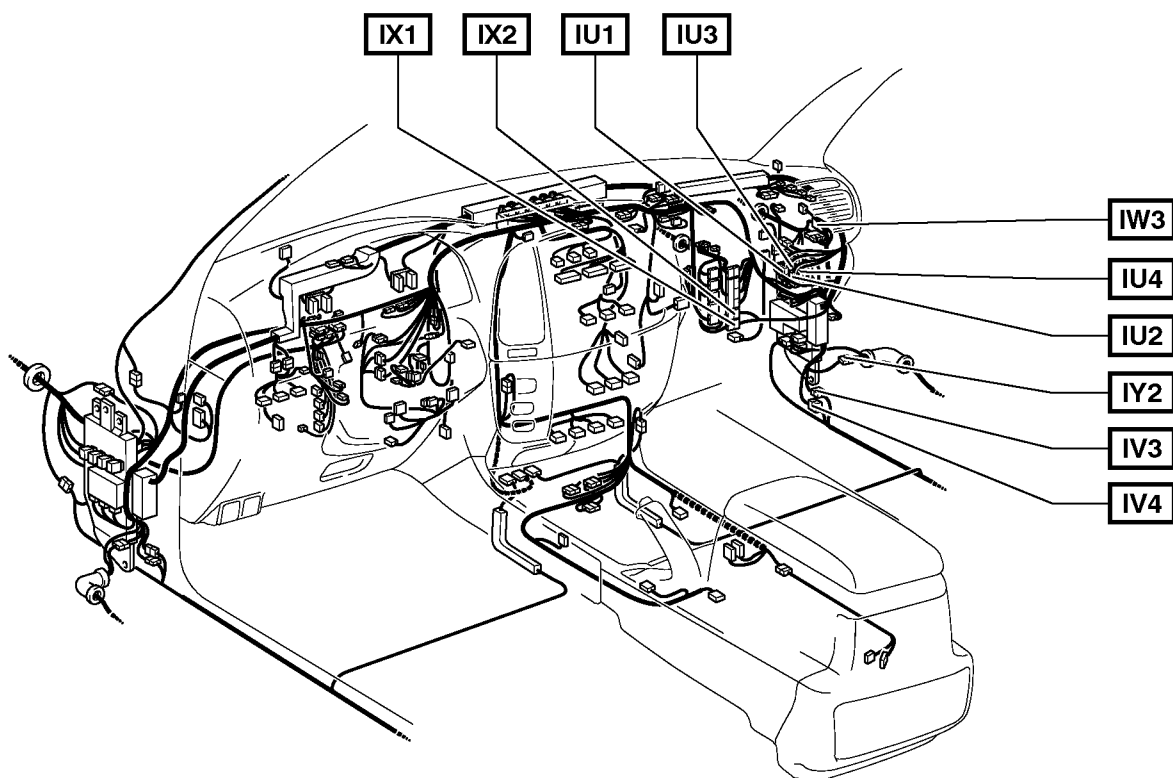

## Connector Joining Wire Harness and Wire Harness

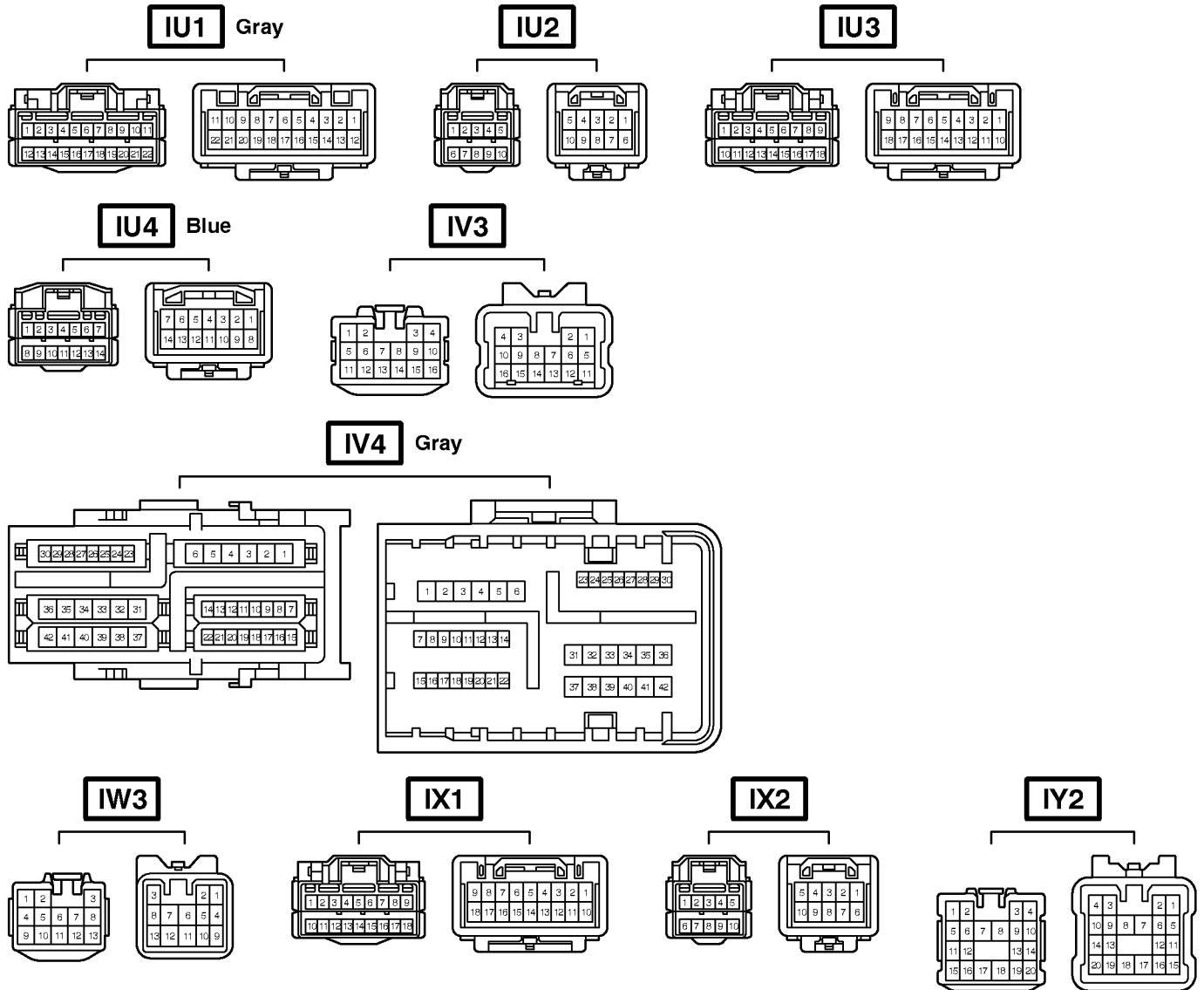

Code	Joining Wire Harness and Wire Harness (Connector Location)
IU1	Instrument Panel Integration Wire and Dash Wire (Behind the Glove Box)
IU2	
IU3	
IU4	
IV3	Dash Wire and Floor No.2 Wire (Right Kick Panel)
IV4	
IW3	Engine Room No.2 Wire and Dash Wire (Behind the Glove Box)
IX1	Instrument Panel Integration Wire and Engine Wire (Behind the Glove Box)
IX2	
IY2	Front Door RH Wire and Dash Wire (Right Kick Panel)



## G ELECTRICAL WIRING ROUTING

□ : Location of Connector Joining Wire Harness and Wire Harness

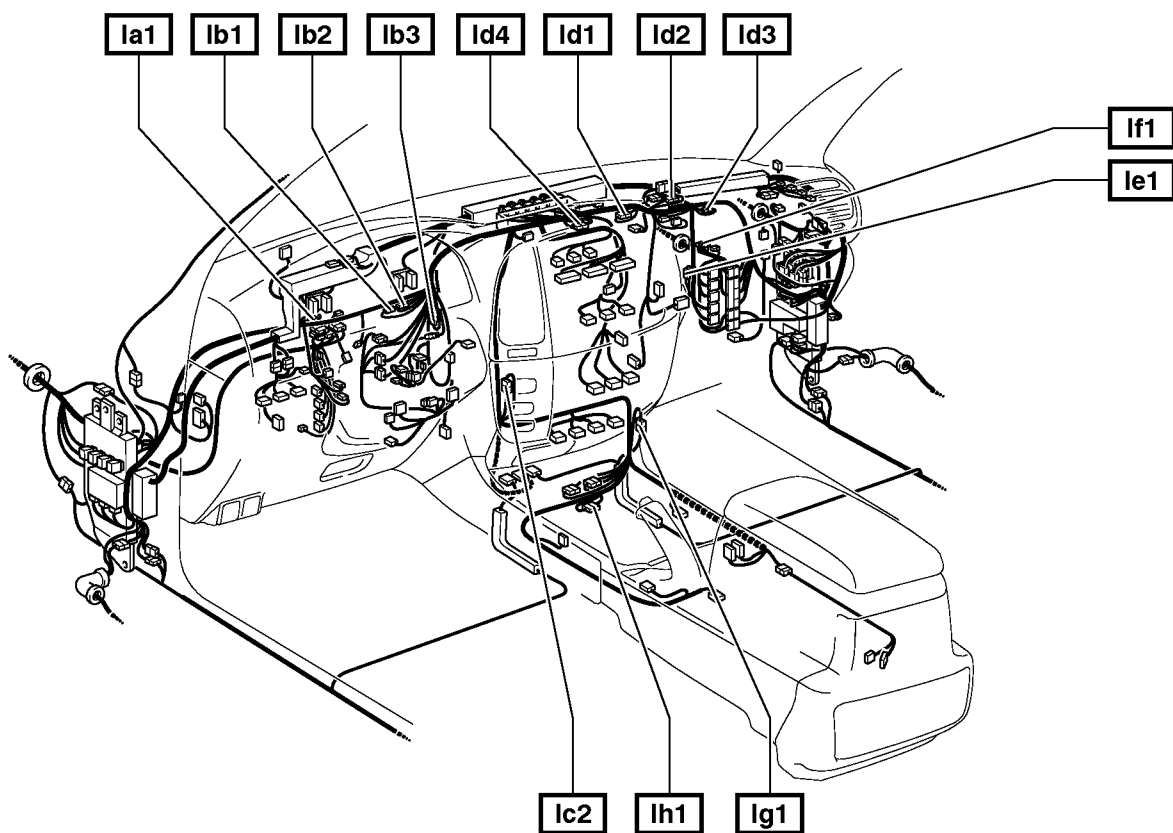

## Connector Joining Wire Harness and Wire Harness

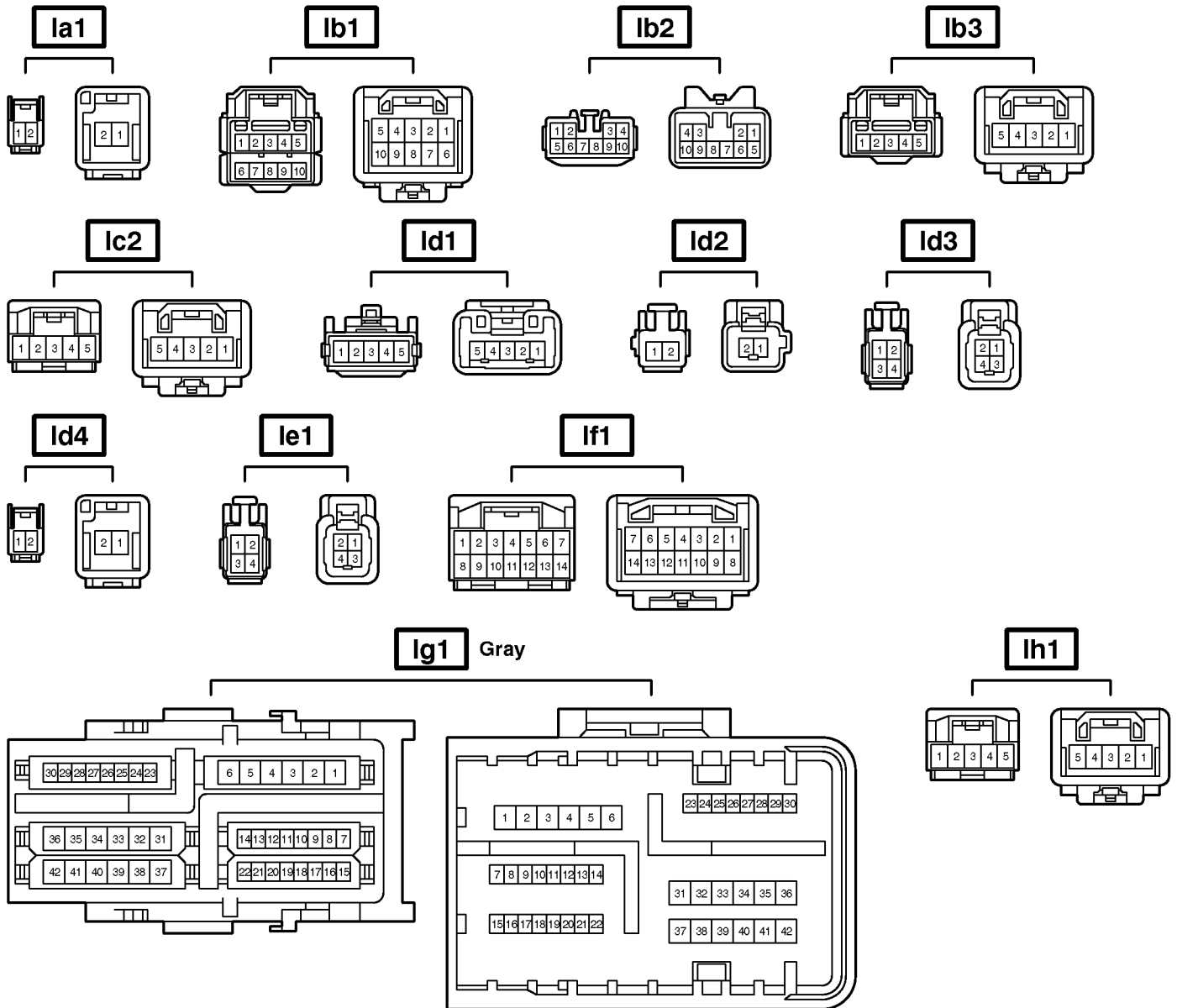

Code	Joining Wire Harness and Wire Harness (Connector Location)
la1	Dash Wire and Dash Wire (Behind the Combination Meter)
lb1	
lb2	Dash Wire and Dash Wire (Behind the Combination Meter)
lb3	
lc2	Dash Wire and Dash Wire (Behind the Center Panel)
ld1	
ld2	
ld3	Dash Wire and Dash Wire (Instrument Panel Center)
ld4	
le1	Dash Wire and Dash Wire (Behind the Glove Box)
lf1	Engine Wire and Engine Wire (Behind the Glove Box)
lg1	Dash Wire and Floor No.2 Wire (Right Side of Front Console)
lh1	Dash Wire and Dash Wire (Center Side of Front Console)

## G ELECTRICAL WIRING ROUTING

□ : Location of Connector Joining Wire Harness and Wire Harness

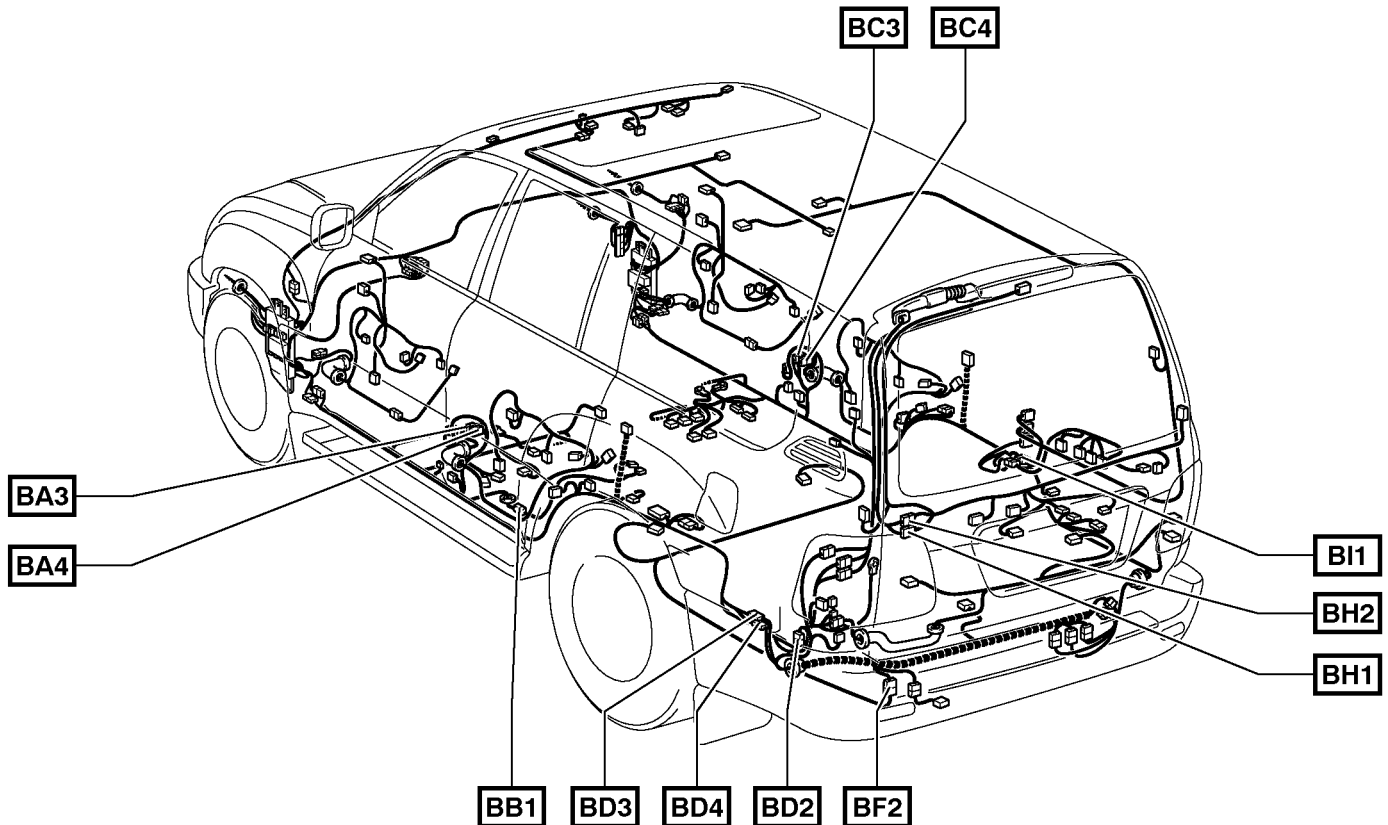

▽ : Location of Ground Points

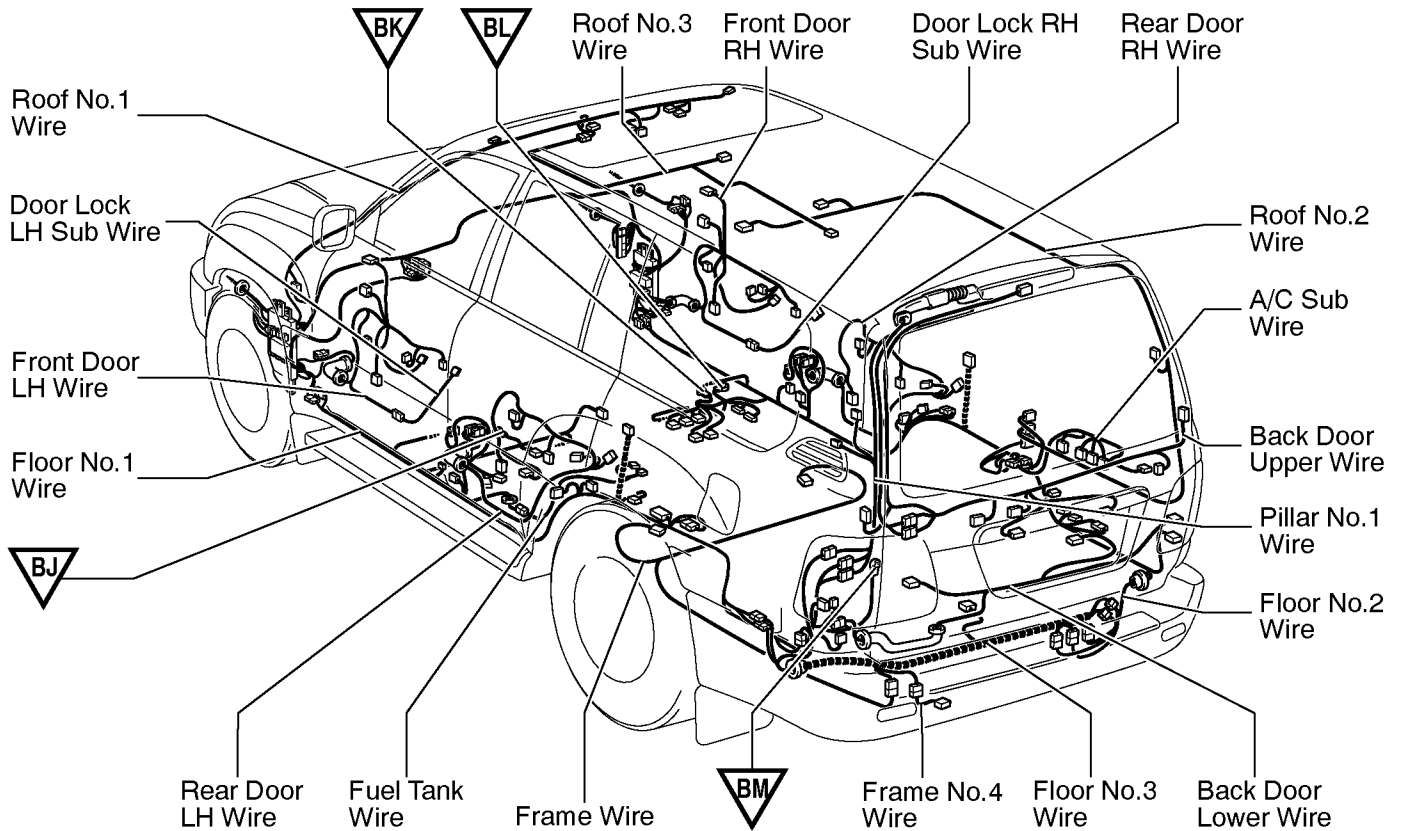

## Connector Joining Wire Harness and Wire Harness

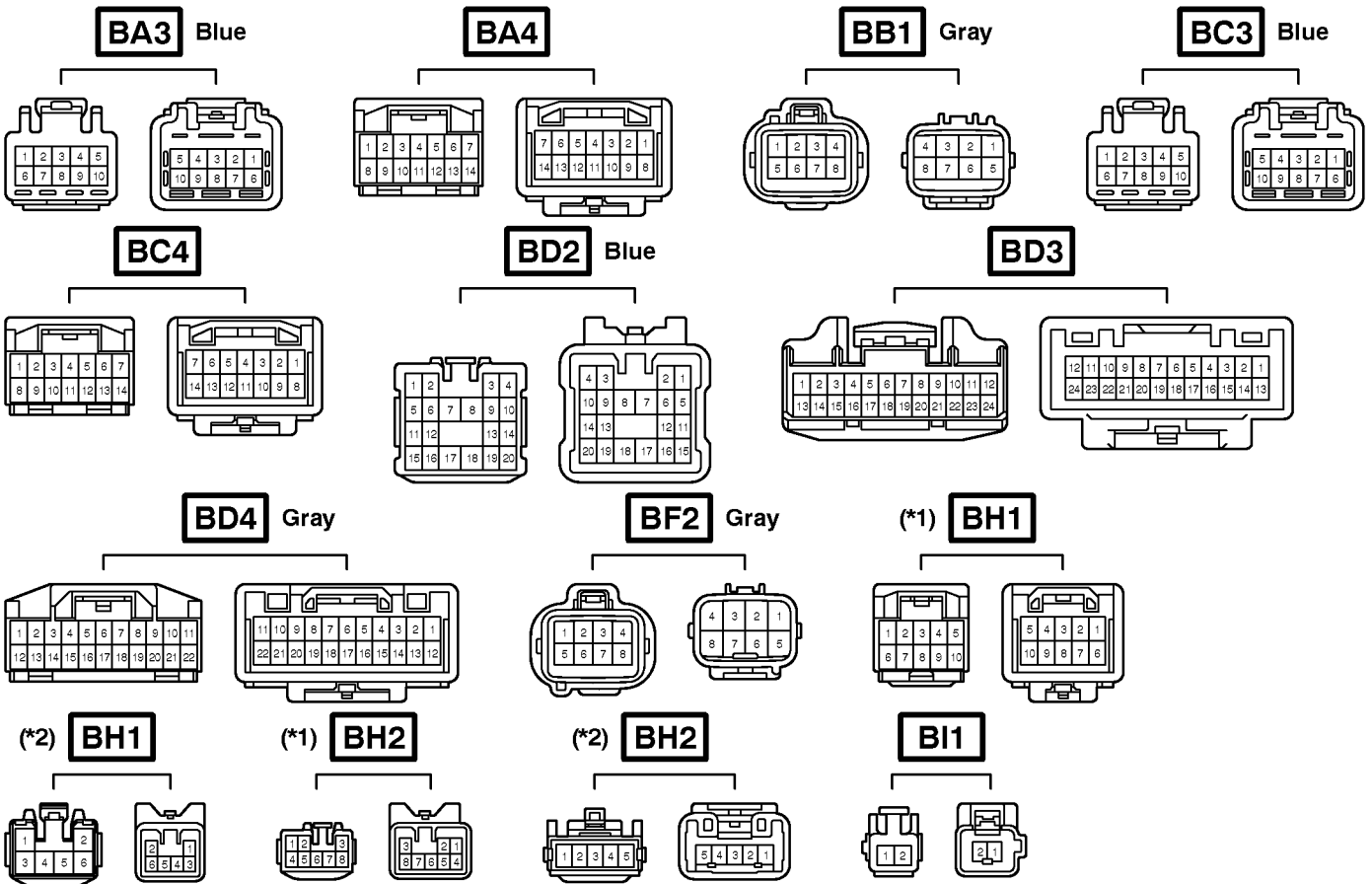

\* 1:w/ Navigation System  
\* 2:w/o Navigation System

Code	Joining Wire Harness and Wire Harness (Connector Location)
BA3	Rear Door LH Wire and Floor No.1 Wire (Left Side of Center Pillar)
BA4	Rear Door LH Wire and Floor No.1 Wire (Left Side of Center Pillar)
BB1	Floor No.1 Wire and Fuel Tank Wire (Near the Fuel Tank)
BC3	Rear Door RH Wire and Floor No.2 Wire (Right Side of Center Pillar)
BC4	Rear Door RH Wire and Floor No.2 Wire (Right Side of Center Pillar)
BD2	Floor No.3 Wire and Floor No.1 Wire (Left Rear Side Quarter Panel)
BD3	Floor No.3 Wire and Floor No.1 Wire (Left Rear Side Quarter Panel)
BD4	Floor No.3 Wire and Floor No.1 Wire (Left Rear Side Quarter Panel)
BF2	Frame Wire and Floor No.3 Wire (Left Side of Rear Floor Crossmember)
BH1	Pillar No.1 Wire and Back Door Upper Wire (Left Side of Back Door)
BH2	Pillar No.1 Wire and Back Door Upper Wire (Left Side of Back Door)
BI1	Roof No.2 Wire and Floor No.2 Wire (Right Side Rear Quarter Panel)

## G ELECTRICAL WIRING ROUTING

□ : Location of Connector Joining Wire Harness and Wire Harness

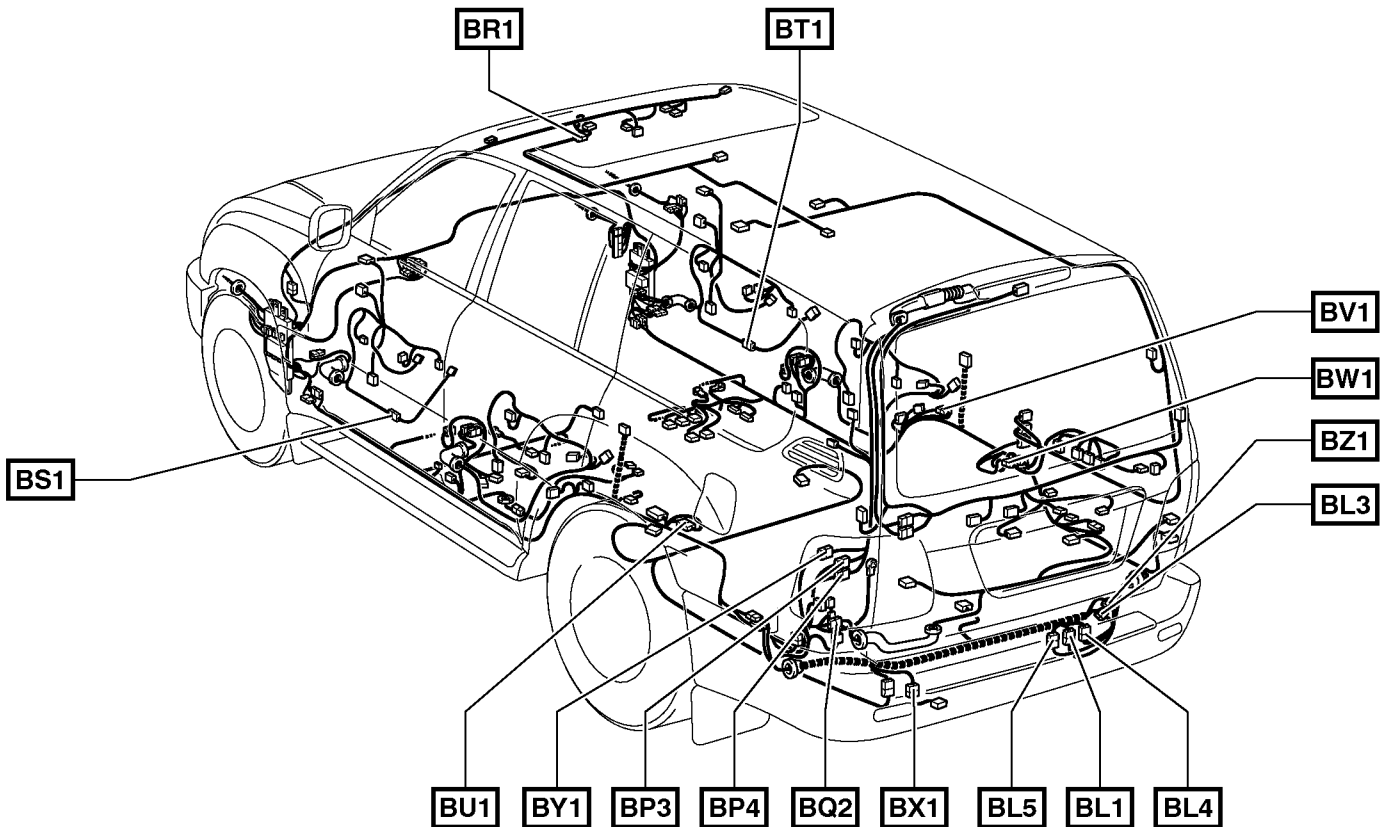

○ : Location of Splice Points

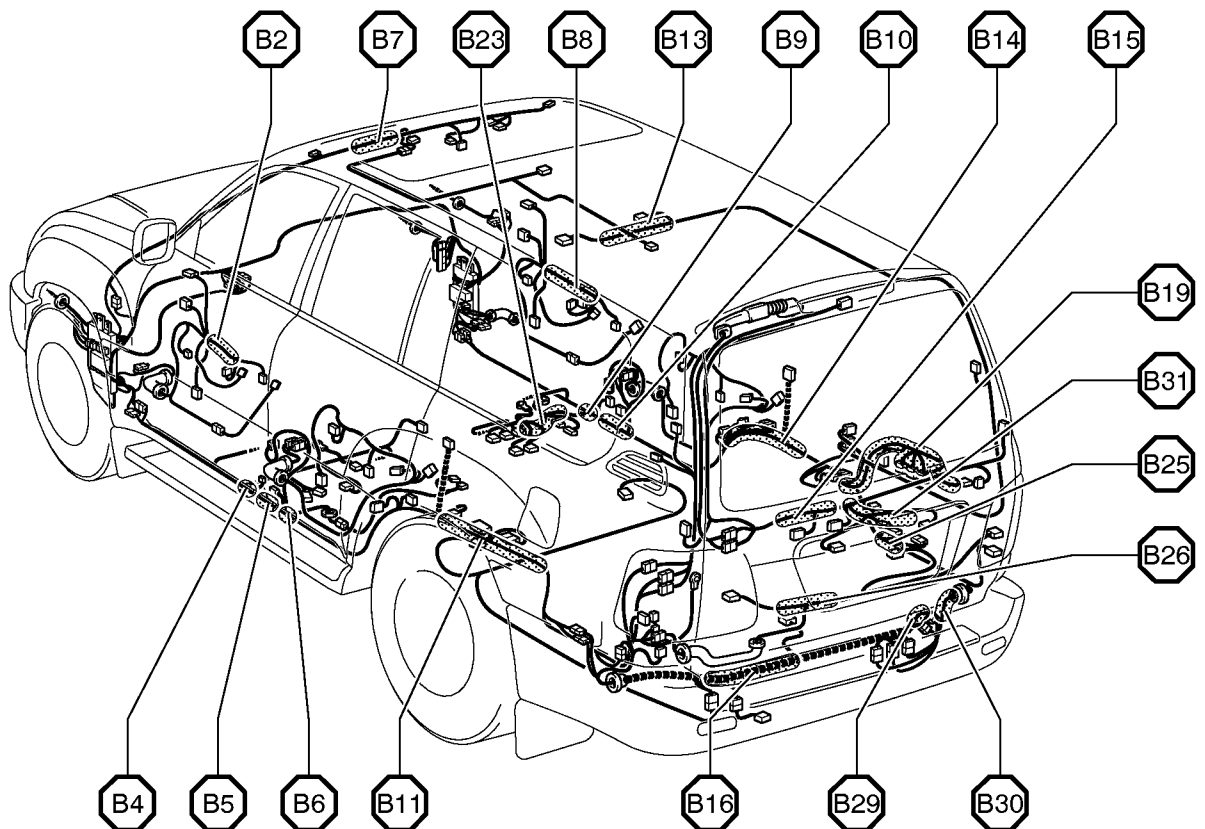

## Connector Joining Wire Harness and Wire Harness

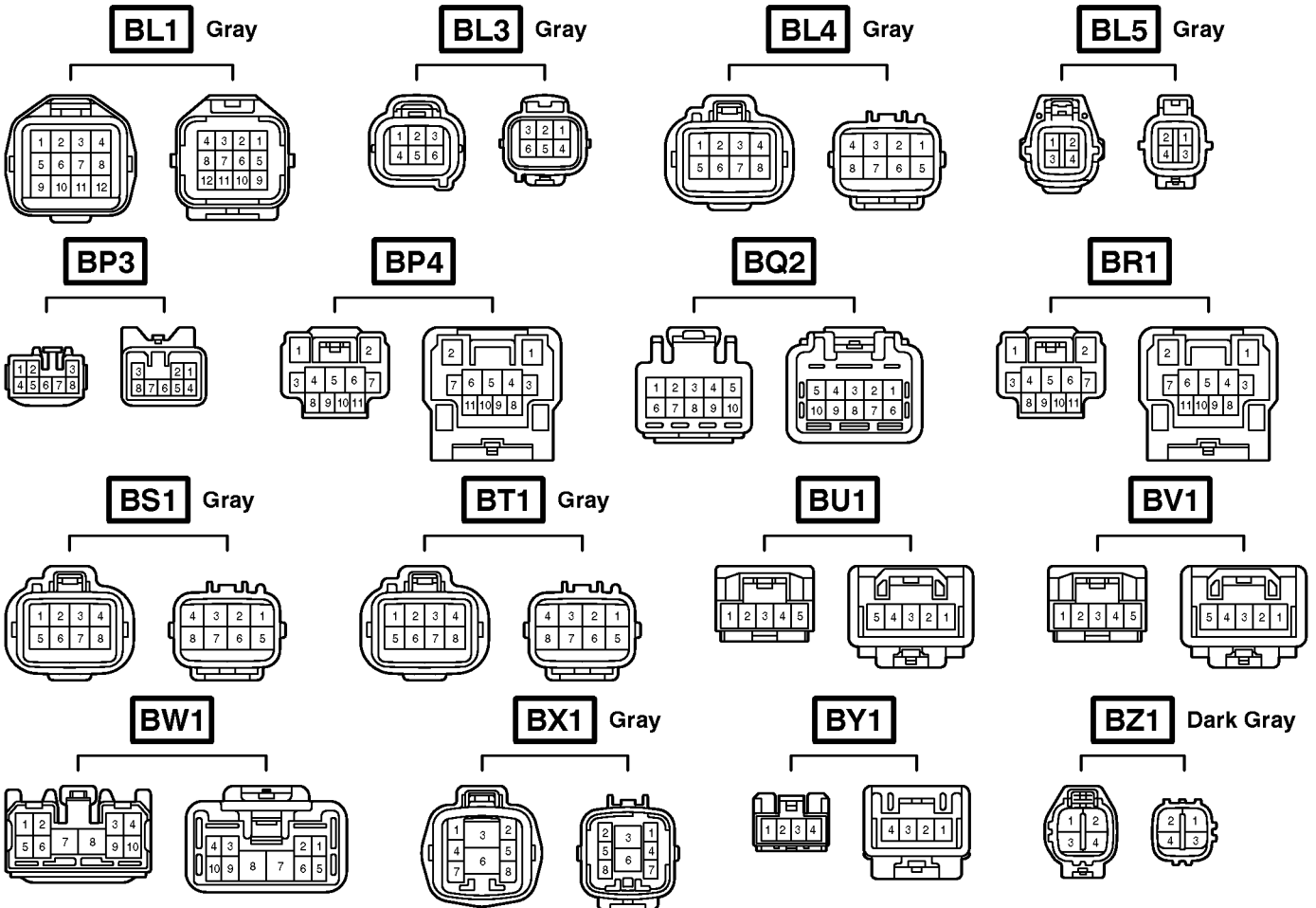

Code	Joining Wire Harness and Wire Harness (Connector Location)
BL1	Floor No.2 Wire and Floor No.3 Wire (Right Side of Rear Floor Crossmember)
BL3	
BL4	
BL5	
BP3	Pillar No.1 Wire and Floor No.1 Wire (Left Rear Side Quarter Panel)
BP4	
BQ2	Back Door Lower Wire and Floor No.1 Wire (Left Rear Side Quarter Panel)
BR1	Roof No.3 Wire and Roof No.1 Wire (Front Side of Roof)
BS1	Door Lock LH Sub Wire and Front Door LH Wire (Front Door LH)
BT1	Door Lock RH Sub Wire and Front Door RH Wire (Front Door RH)
BU1	Floor No.1 Wire and Floor No.1 Wire (Near the Left Rear Suspension Support)
BV1	Floor No.2 Wire and Floor No.2 Wire (Near the Right Rear Suspension Support)
BW1	Floor No.2 Wire and A/C Sub Wire (Right Side Rear Quarter Panel)
BX1	Frame No.4 Wire and Floor No.3 Wire (Left Side of Rear Floor Crossmember)
BY1	Pillar No.1 Wire and Floor No.3 Wire (Left Rear Side Quarter Panel)
BZ1	Floor No.3 Wire and Floor No.2 Wire (Right Side of Rear Floor Crossmember)

## G ELECTRICAL WIRING ROUTING

□ : Location of Connector Joining Wire Harness and Wire Harness

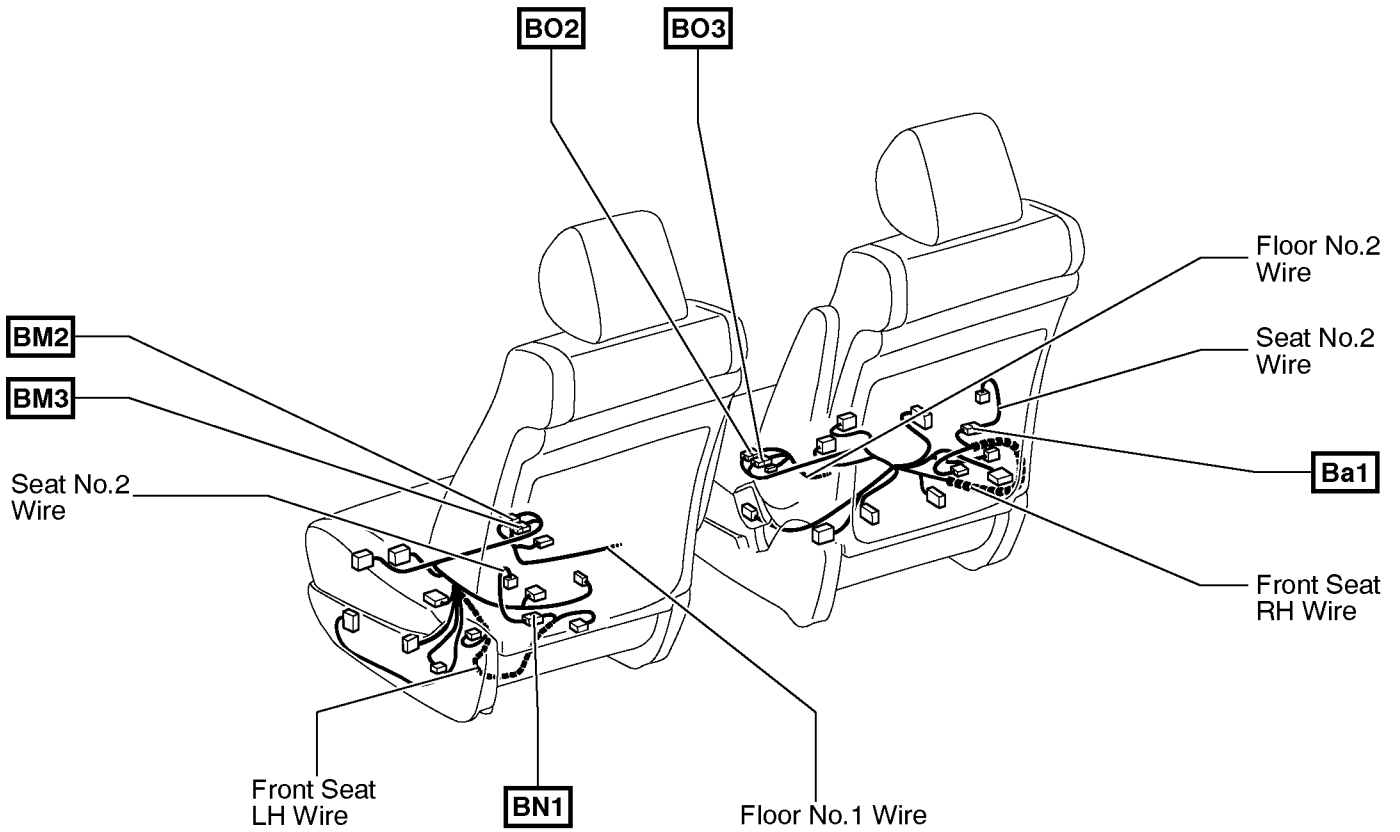

○ : Location of Splice Points

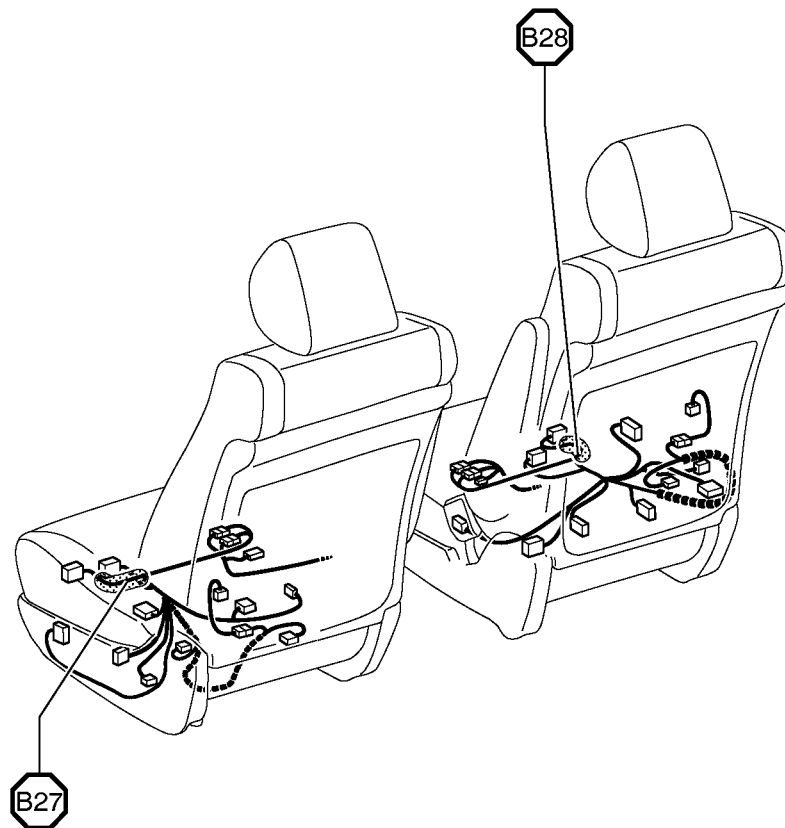

## Connector Joining Wire Harness and Wire Harness

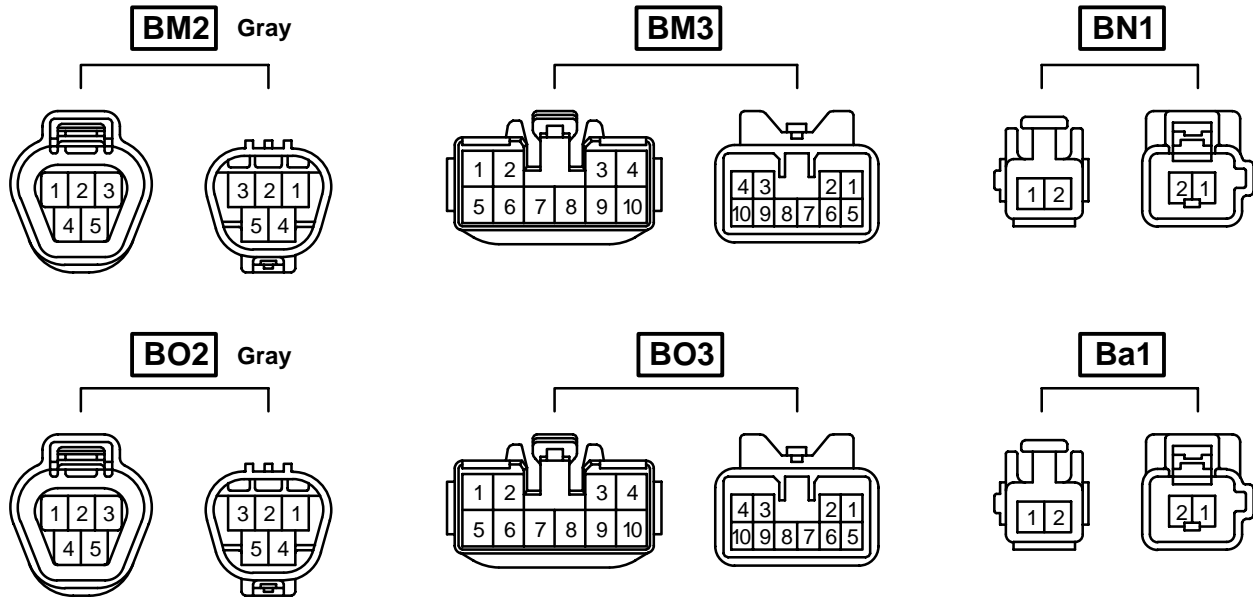

Code	Joining Wire Harness and Wire Harness (Connector Location)
BM2	Floor No.1 Wire and Front Seat LH Wire (Front Side Under the Driver's Seat)
BM3	
BN1	Seat No.2 Wire and Front Seat LH Wire (Rear Side Under the Driver's Seat)
BO2	Floor No.2 Wire and Front Seat RH Wire (Front Side Under the Front Passenger's Seat)
BO3	
Ba1	Seat No.2 Wire and Front Seat RH Wire (Rear Side Under the Front Passenger's Seat)



## HINT

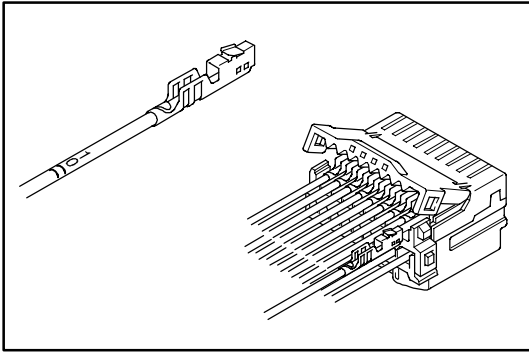

### WIRE COLOR AND TERMINAL NUMBER

In some parts of the instrumental panel wiring harness, the same wire color (i.e. SB: Sky Blue) is used for all the wiring to a specific connector.

In order to identify the wiring, the terminal number is printed on the wiring.

Install the wiring to the connector position with the same terminal number.

Some early production Vehicles may not have these terminal numbers printed.