

### 26. Immobilizer Antenna

#### A: REMOVAL

- 1) Disconnect the ground cable from battery.
- 2) Remove the screws, and detach the upper column cover and lower column cover.

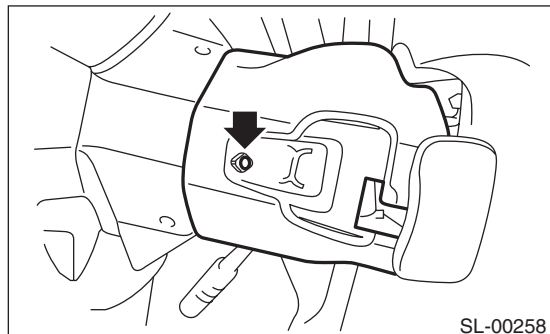

- 3) Remove the instrument panel lower cover. <Ref. to EI-38, REMOVAL, Instrument Panel Lower Cover.>
- 4) Disconnect the immobilizer antenna connector (A) and ignition switch lighting connector (B).
- 5) Loosen the screw and release the lock (D) at opposite side using flat tip screwdriver (1), and then detach the immobilizer antenna (C).

#### CAUTION:

**Do not apply excessive force to remove the immobilizer antenna and lock. Otherwise they may be broken because those parts are the products made of a plastic.**

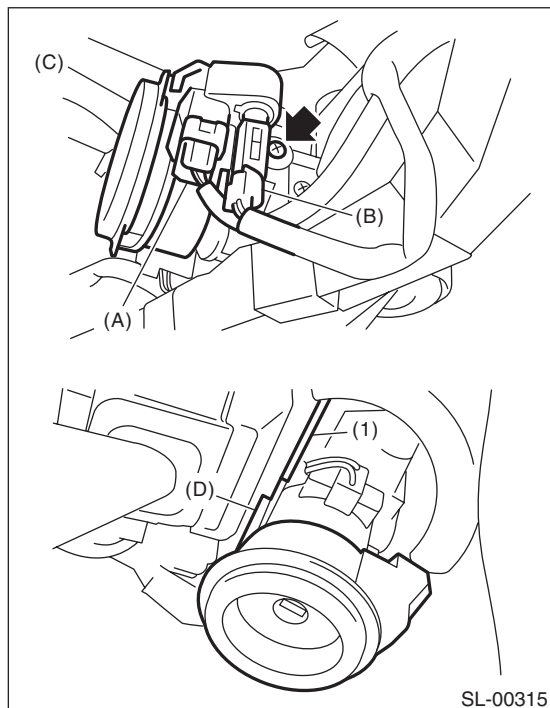

#### B: INSTALLATION

Install in the reverse order of removal.

# SUNROOF/T-TOP/CONVERTIBLE TOP (SUNROOF)

# *SR*

---

|                                 | Page |
|---------------------------------|------|
| 1. General Description .....    | 2    |
| 2. Sunroof Control System ..... | 4    |
| 3. Glass Lid .....              | 5    |
| 4. Sunroof Assembly .....       | 7    |
| 5. Sunroof Motor .....          | 8    |
| 6. Sunroof Switch .....         | 10   |
| 7. Sunshade .....               | 11   |