

## 5. Seat Heater System

### A: REMOVAL

#### 1. SEAT HEATER UNIT

- 1) Remove the front seats. <Ref. to SE-7, REMOVAL, Front Seat.>
- 2) Remove the backrest cover of front seat and seat cushion cover. <Ref. to SE-8, DISASSEMBLY, Front Seat.>
- 3) Remove the hog rings, and then remove the seat heater unit.

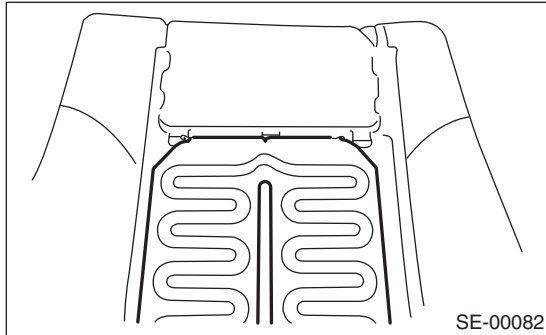

#### 2. SEAT HEATER SWITCH

The seat heater switch is built into the control panel. <Ref. to AC-32, REMOVAL, Control Panel.>

### B: INSTALLATION

#### CAUTION:

If the seat cushion cover is removed or replaced, make sure to perform occupant detection system adjustment after installing the seat. <Ref. to OD(diag)-14, SYSTEM CALIBRATION (REZEROING), OPERATION, Subaru Select Monitor.>

Failure to do so may prevent the passenger's airbag from operating properly.

Install in the reverse order of removal.

### C: INSPECTION

#### 1. WIRING DIAGRAM

<Ref. to WI-86, WIRING DIAGRAM, Power Seat System.>

#### 2. SEAT HEATER MODULE

Disconnect the connector of the seat heater module, and check for continuity between terminals in connector.

#### Connector & terminal

No. 1 — No. 3:

No. 1 — No. 4:

No. 3 — No. 4:

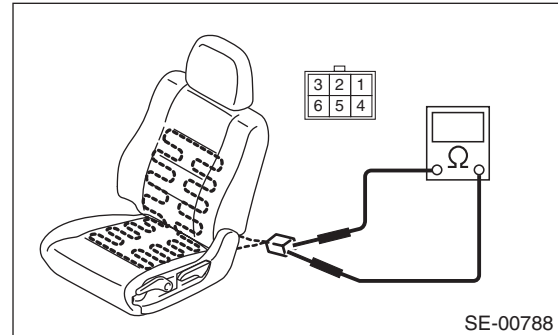

If there is no continuity, replace the seat heater module.

#### 3. SEAT HEATER SWITCH

- 1) Perform the self-diagnosis of control panel. <Ref. to AC(diag)-10, Diagnostic Chart for Self-Diagnosis.>
- 2) Repair the harness between the seat heater module and the auto air conditioner control module.
- 3) Check the auto air conditioner control module. <Ref. to AC(diag)-8, Auto A/C Control Module I/O Signal.>