

7. Rear Disc Brake Assembly

A: REMOVAL

CAUTION:

Do not allow brake fluid to come in contact with vehicle body. If it does, wash off with water and wipe away completely.

- 1) Lift up the vehicle, and then remove the rear wheels.
- 2) Disconnect the brake hose from caliper body assembly.
- 3) Remove the caliper lower bolt.

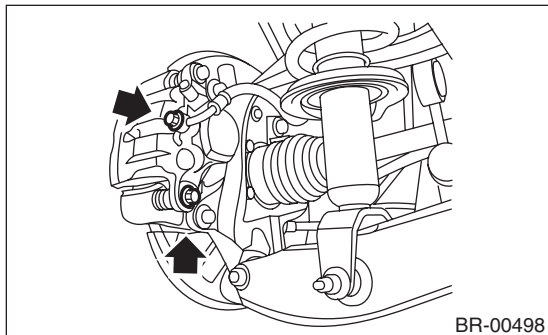

- 4) Raise the caliper body, and then move it toward vehicle center to separate it from the support.
- 5) Remove the support from housing.

NOTE:

Remove the support only when replacing the rotor or support. It is not necessary to remove it when servicing the caliper body assembly.

- 6) Remove mud and foreign matter from the caliper body assembly and the support.

CAUTION:

Be careful not to allow foreign matter to enter the brake hose connector.

B: INSTALLATION

- 1) Apply a thin coat of Molykote M7439 (Part No. 003602001) or the grease included with pad kit to the support.

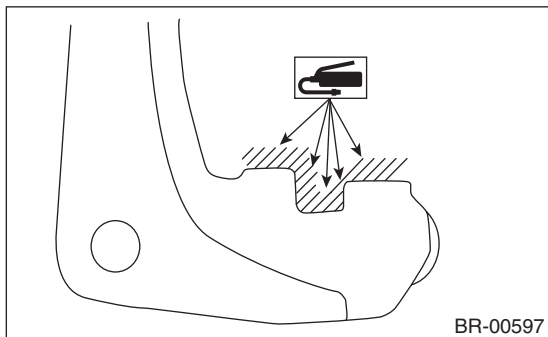

- 2) Install the support to the housing.

Tightening torque:

66 N·m (6.7 kgf-m, 48.7 ft-lb)

- 3) Apply a thin coat of Molykote M7439 (Part No. 003602001) or grease contained in the pad kit to the pad clip.

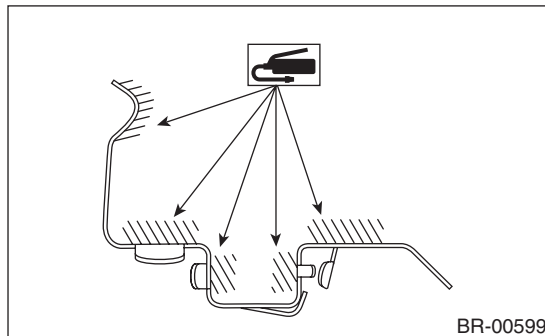

- 4) Apply a thin coat of Molykote AS880N (Part No. K0777YA010) or the grease contained in the pad kit to the contact surface between the outer-side pad and shim.

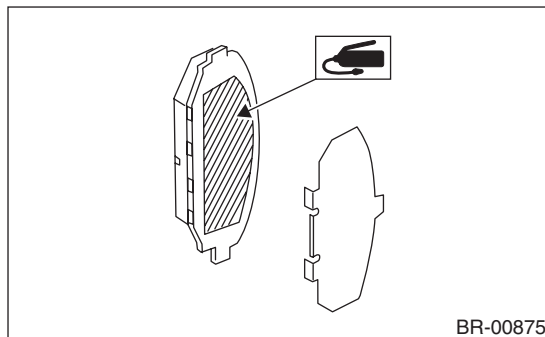

- 5) Apply a thin coat of Molykote AS880N (Part No. K0777YA010) or grease contained in the pad kit to both surfaces of the inner pad inner shim.

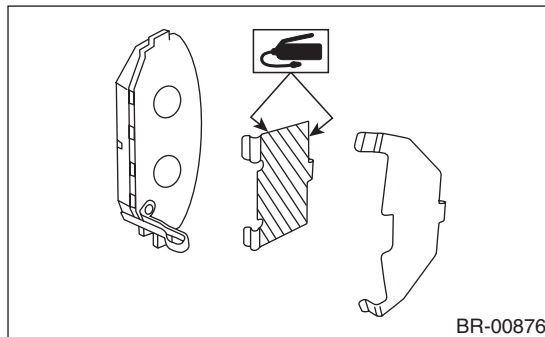

- 6) Install the pad to support.
- 7) Install the caliper body to the support.

Tightening torque:

27 N·m (2.8 kgf-m, 19.9 ft-lb)

- 8) Connect the brake hose using a new brake hose gasket.

Tightening torque:

18 N·m (1.8 kgf-m, 13.3 ft-lb)

- 9) Bleed air from the brake system.

Rear Disc Brake Assembly

BRAKE

C: DISASSEMBLY

- 1) Remove the piston boot.

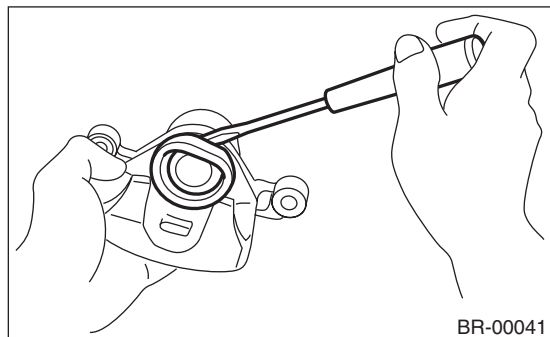

- 2) Place a wooden block in the caliper body as shown in the figure to prevent the piston from jumping out and being damaged.
- 3) Gradually apply compressed air via the brake hose installation hole to push the piston out.

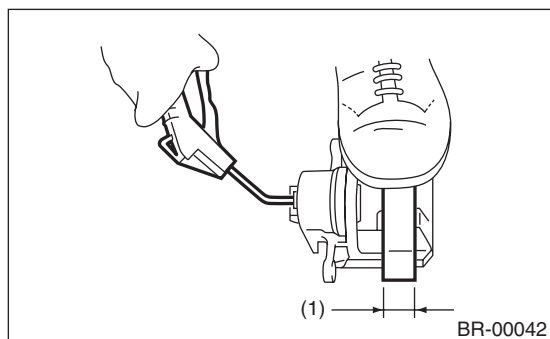

- (1) Place a wood block of 18 mm (0.71 in) width.

- 4) Remove the piston seal from caliper body cylinder.

CAUTION:

Do not damage the cylinder and piston seal groove.

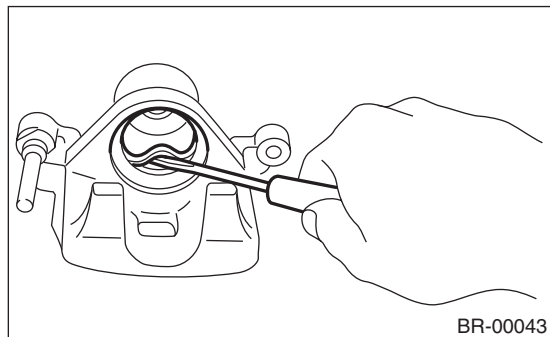

- 5) Remove the lock pin sleeve and boot from caliper body.
- 6) Remove the guide pin boot.

D: ASSEMBLY

- 1) Clean the inside of the caliper body using brake fluid.
- 2) Apply a coat of brake fluid to piston seal and install the piston seal to the caliper body groove.

- 3) Apply a coat of brake fluid to the inner surface of cylinder and the entire outer surface of the piston.
- 4) Apply grease contained in the piston seal kit to the boot, and install it to the groove at the ends of the cylinder.
- 5) Insert the piston into cylinder.

CAUTION:

Do not force the piston into cylinder.

- 6) Position the boot in the grooves on piston and cylinder.

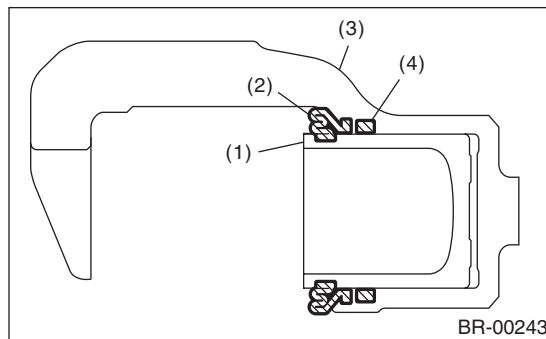

- (1) Piston
- (2) Piston boot
- (3) Caliper body
- (4) Piston seal

- 7) Apply grease contained in the piston seal kit to the guide pin, outer surface, sleeve outer surface, cylinder inner surface, and boot grooves.

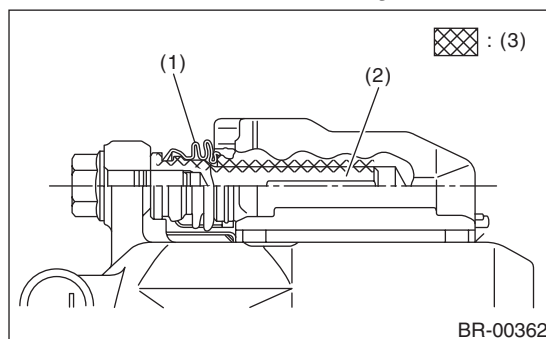

- (1) Pin boot
- (2) Lock pin or guide pin
- (3) Grease applied area

- 8) Insert the guide pin boot to the support.
- 9) Insert the lock pin boot to support, and then insert the lock pin sleeve into the specified position.

E: INSPECTION

- 1) Repair or replace the faulty parts.
- 2) Check the caliper body and piston for uneven wear, damage or rust.
- 3) Check the rubber parts for damage or deterioration.