

### 23. Drive Plate

#### A: REMOVAL

1) Remove the transmission assembly from the vehicle. <Ref. to 5AT-37, REMOVAL, Automatic Transmission Assembly.>

2) Use the ST to lock the crankshaft, and remove the drive plate.

ST 498497100 CRANKSHAFT STOPPER

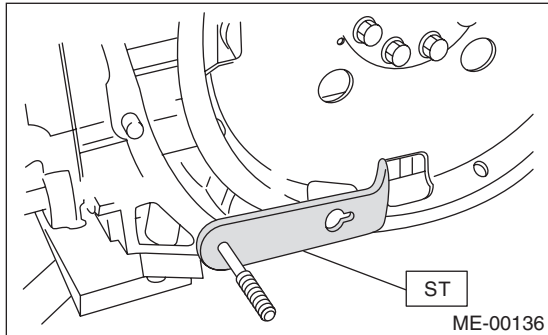

#### B: INSTALLATION

1) Temporarily tighten the drive plate.

2) Using the ST, lock the crankshaft.

ST 498497100 CRANKSHAFT STOPPER

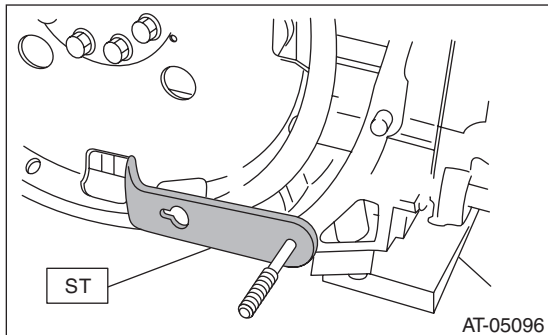

3) Tighten the drive plate to the specified torque.

#### NOTE:

Tighten the drive plate mounting bolts gradually. Each bolt should be tightened in a crisscross order.

#### **Tightening torque:**

**90 N·m (9.2 kgf-m, 66.4 ft-lb)**

4) Install the transmission assembly to the vehicle. <Ref. to 5AT-40, INSTALLATION, Automatic Transmission Assembly.>