

## 19. Axle Boots & Joints

### A: INSPECTION

#### 1. FRONT AND REAR AXLE BOOTS

Inspect the front axle boots (A) and rear axle boots (B) for deformation, damage or failure. If faulty, replace with a new part. <Ref. to DS-25, Front Drive Shaft.> <Ref. to DS-29, Rear Drive Shaft.>

- Front

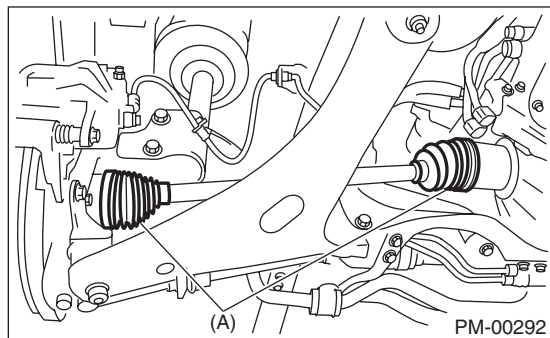

- Rear

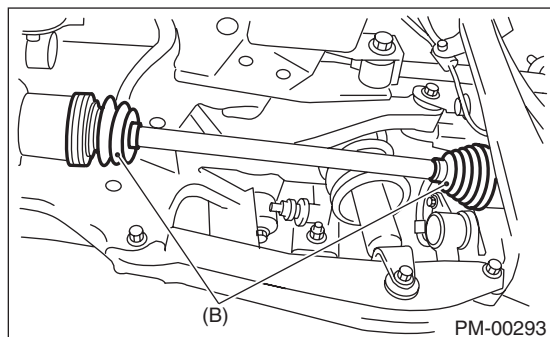

#### 2. PROPELLER SHAFT

Inspect the propeller shaft for damage or failure. If faulty, replace with a new part. <Ref. to DS-10, Propeller Shaft.>