

11. Automatic Transmission Fluid

A: INSPECTION

CAUTION:

The level of ATF varies with fluid temperature. Pay attention to the ATF temperature when checking ATF level.

- 1) Raise the ATF temperature by driving a distance of 5 to 10 km (3 to 6 miles). Otherwise, idle the engine to raise ATF temperature to 70 — 80°C (158 — 176°F) on Subaru Select Monitor. <Ref. to 5AT(diag)-16, READ CURRENT DATA, OPERATION, Subaru Select Monitor.>
- 2) Make sure the vehicle is level.
- 3) After selecting all positions (P, R, N, D), shift the select lever in “P” range. Idle the engine for 1 to 2 minutes.
- 4) Remove the oil level gauge and wipe it clean.
- 5) Reinsert the level gauge all the way. Make sure the level gauge is inserted correctly and in the proper orientation.
- 6) Remove the oil level gauge again and make sure that the ATF level is between upper and lower marks of the “HOT” side.

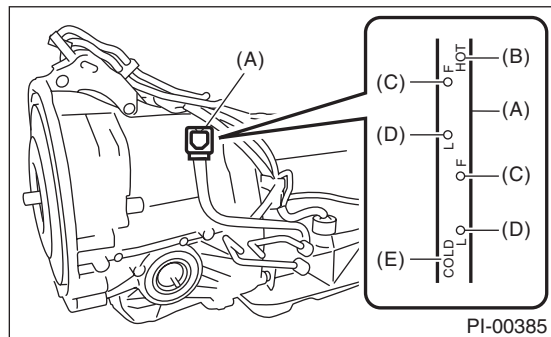

- (A) Level gauge
- (B) ATF level range at “HOT” [70 — 80°C (158 — 176°F)]
- (C) Upper level
- (D) Lower level
- (E) ATF level range at “COLD” [20 — 30°C (68 — 86°F)]

- 7) If the ATF level is below the lower mark, add recommended ATF until the fluid level is between upper and lower marks.

CAUTION:

- Be careful not to exceed the upper level limit.
- If ATF is added to the upper limit mark on “HOT” side when the ATF temperature is less than 70°C (158°F), ATF will overfill and cause the oil to spill out.

- 8) Check the ATF for leaks.

Check for leaks in the transmission. If there are leaks, it is necessary to repair or replace gaskets, oil seals, plugs or other parts.

B: REPLACEMENT

- 1) Lift up the vehicle.
- 2) Remove the ATF drain plug to drain ATF.

CAUTION:

- Directly after the vehicle has been running or the engine has been long idle running, the ATF is hot. Be careful not to burn yourself.
 - Be careful not to spill the ATF on the exhaust pipe to prevent it from emitting smoke or causing fire. If the ATF is spilt, wipe it off completely.
- 3) Check the ATF condition. <Ref. to 5AT-30, CONDITION CHECK, Automatic Transmission Fluid.>
 - 4) Tighten the ATF drain plug to the specified torque.

NOTE:

Use a new gasket.

Tightening torque:

20 N·m (2.0 kgf·m, 14.8 ft·lb)

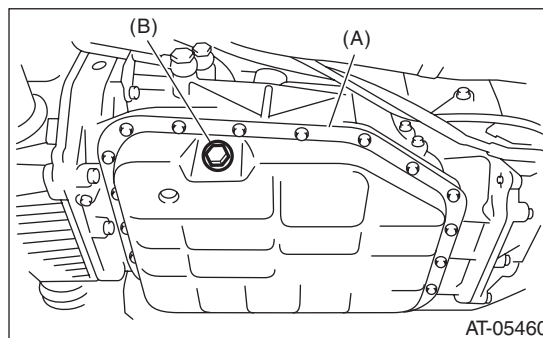

- (A) Oil pan
- (B) ATF drain plug

- 5) Lower the vehicle.
- 6) Pour ATF through the oil charge pipe.

Recommended ATF:

Refer to “RM” section. <Ref. to RM-4, FLUID, RECOMMENDED MATERIALS, Recommended Materials.>

Capacity:

Fill with the same amount of ATF as drained.

CAUTION:

Be sure to use the recommended or equivalent ATF. Using material except recommended one or substitute would cause trouble.

- 7) Check the level and leaks of the ATF. <Ref. to PM-13, INSPECTION, Automatic Transmission Fluid.>