

## 26. License Plate Light Assembly

### A: REMOVAL

- 1) Remove the rear gate trim. <Ref. to EI-52, REMOVAL, Rear Gate Trim.>
- 2) Disengage the claws, and disconnect the connectors, and then detach the license plate light assembly.

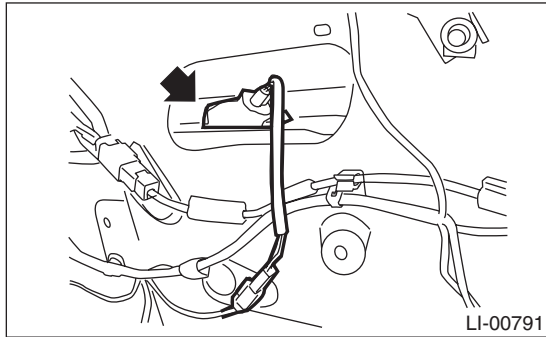

### B: INSTALLATION

Install in the reverse order of removal.