

2. Accelerator Pedal

A: REMOVAL

- 1) Disconnect the ground cable from the battery.
- 2) Disconnect the connector.
- 3) Remove the nut securing accelerator pedal assembly.

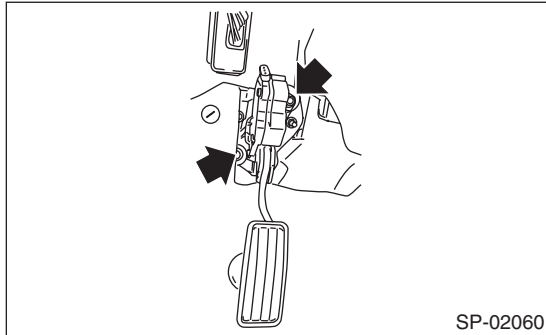

B: INSTALLATION

Install in the reverse order of removal.

Tightening torque:

18 N·m (1.8 kgf-m, 13.3 ft-lb)

C: DISASSEMBLY

NOTE:

The accelerator pedal cannot be disassembled.

D: INSPECTION

- 1) Check for smooth operation when the accelerator pedal is depressed.
- 2) Check if the accelerator pedal returns to its original position smoothly when the pedal is released.

Accelerator Pedal

SPEED CONTROL SYSTEMS

IGNITION

IG(H6DO)

	Page
1. General Description	2
2. Spark Plug	5
3. Ignition Coil	8

