

16. Cam Sprocket

A: REMOVAL

NOTE:

When replacing the single part, perform the work with the engine installed to body.

- 1) Remove the V-belts. <Ref. to ME(H6DO)-43, REMOVAL, V-belt.>
- 2) Remove the crank pulley. <Ref. to ME(H6DO)-44, REMOVAL, Crank Pulley.>
- 3) Remove the chain cover. <Ref. to ME(H6DO)-45, REMOVAL, Chain Cover.>
- 4) Remove the timing chain assembly. <Ref. to ME(H6DO)-51, REMOVAL, Timing Chain Assembly.>
- 5) Remove the cam sprocket. To lock the camshaft, use the ST.

ST 499977500 CAM SPROCKET WRENCH

- Intake side

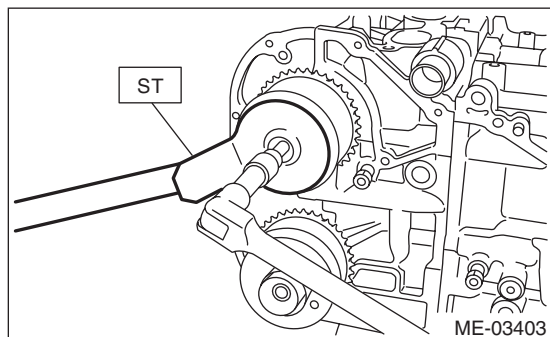

- Exhaust side

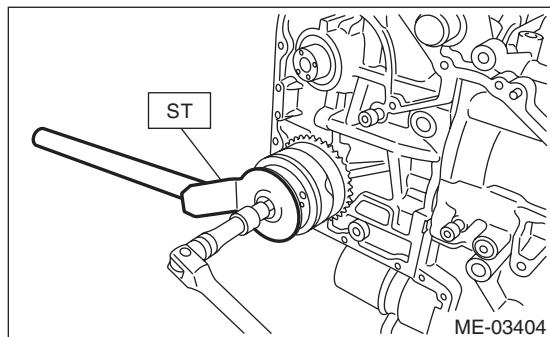

B: INSTALLATION

- 1) Install the cam sprocket. To lock the camshaft, use the ST.

Tightening torque:

29.5 N·m (3.0 kgf-m, 21.8 ft-lb)

- 2) Further tighten the bolt.

Tightening angle:

45°±5°

ST 499977500 CAM SPROCKET WRENCH

- Intake side

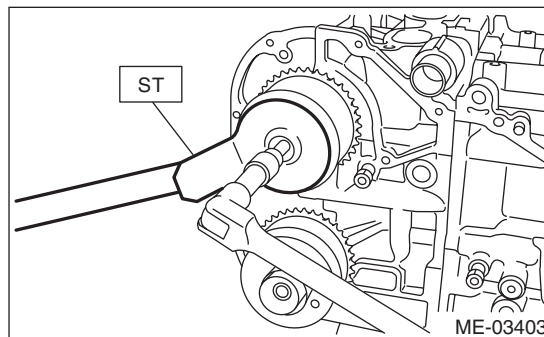

- Exhaust side

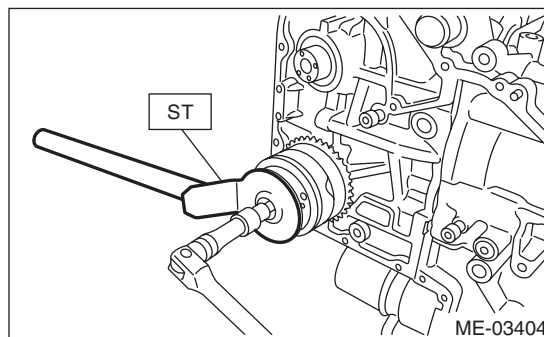

- 3) Install the timing chain assembly. <Ref. to ME(H6DO)-57, INSTALLATION, Timing Chain Assembly.>

- 4) Install the chain cover. <Ref. to ME(H6DO)-46, INSTALLATION, Chain Cover.>

- 5) Install the crank pulley. <Ref. to ME(H6DO)-44, INSTALLATION, Crank Pulley.>

- 6) Install the V-belts. <Ref. to ME(H6DO)-43, INSTALLATION, V-belt.>

C: INSPECTION

- 1) Check the cam sprocket teeth for abnormal wear and scratches.
- 2) Make sure there is no free play between cam sprocket and key.