

19. Axle Boots & Joints

A: INSPECTION

1. FRONT AND REAR AXLE BOOTS

Inspect the front axle boots (A) and rear axle boots (B) for deformation, damage or failure. If faulty, replace with a new part. <Ref. to DS-27, Front Drive Shaft.> <Ref. to DS-32, Rear Drive Shaft.>

- Front

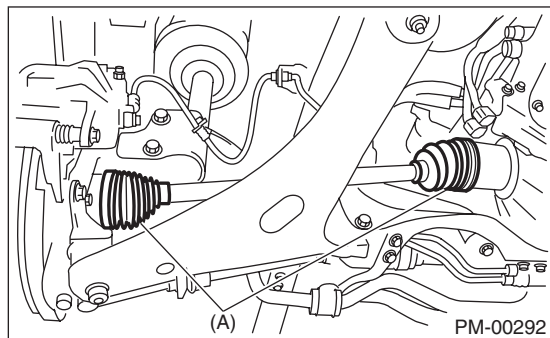

- Rear

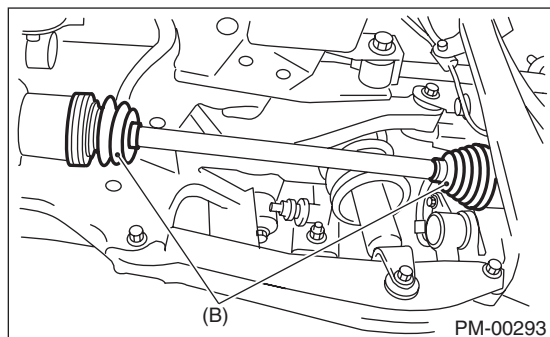

2. PROPELLER SHAFT

Inspect the propeller shaft for damage or failure. If faulty, replace with a new part. <Ref. to DS-10, Propeller Shaft.>