

2. Front Brake Pad

A: REMOVAL

- 1) Lift up the vehicle, and remove the front wheels.
- 2) Remove the caliper bolt.

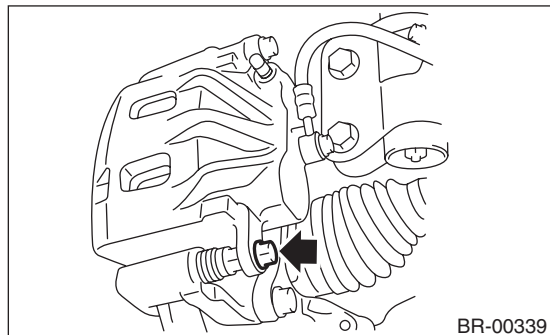

- 3) Raise the caliper body and support it.

NOTE:

Do not disconnect the brake hose from the caliper body.

- 4) Remove the pad.

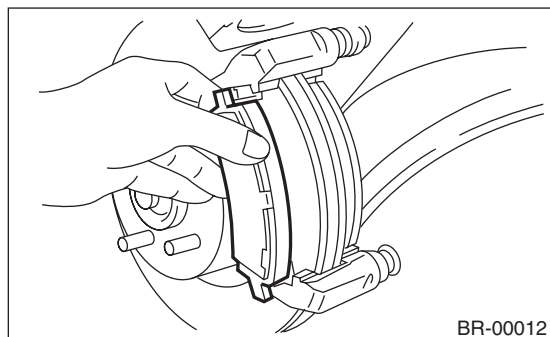

B: INSTALLATION

- 1) Apply a thin coat of Molykote M7439 (Part No. K0770YA000) or grease contained in the pad kit to the pad clip.

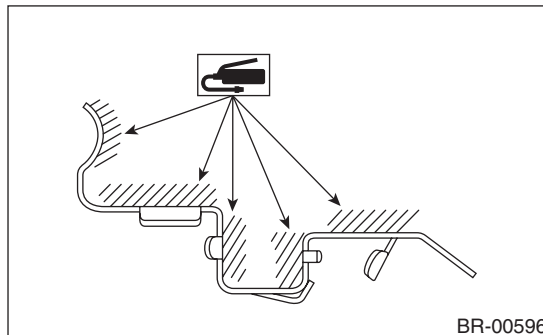

- 2) Apply a thin coat of Molykote AS880N (Part No. K0777YA010) or grease contained in the pad kit to both surfaces of the pad inner shim.

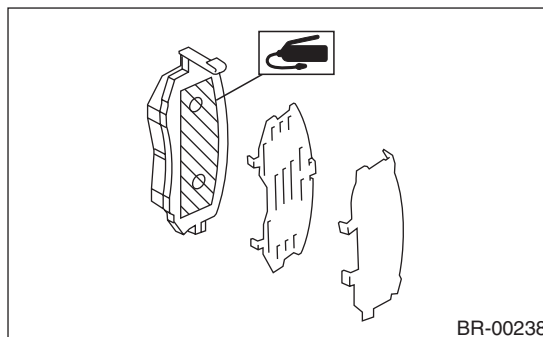

- 3) Apply a thin coat of Molykote AS880N (Part No. K0777YA010) or grease contained in the pad kit to the three contact surfaces between inner shim and outer shim of outer pads.

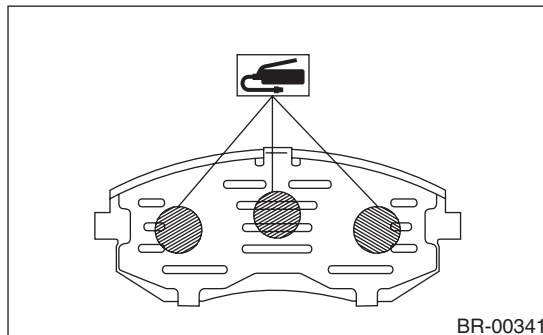

4) Install the pad to support.

NOTE:

Install the pad indicator in proper direction.

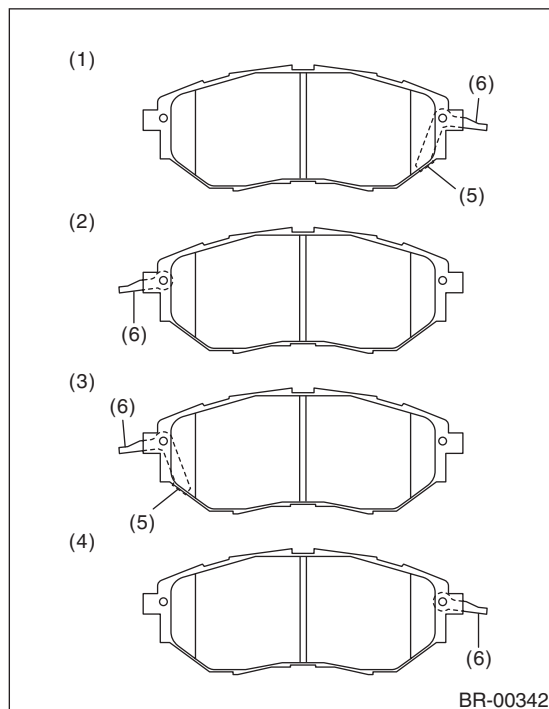

- (1) LH — IN
- (2) LH — OUT
- (3) RH — IN
- (4) RH — OUT
- (5) Pad indicator
- (6) Pad return spring

CAUTION:

- Be sure to install so that the pad return spring faces the input side of the direction of brake rotor rotation, as shown in the figure.
- Correctly install the pad return spring to the supporting surface of the pad clip as shown in the figure.
- If the pad return spring is deformed or damaged, replace the brake pad.

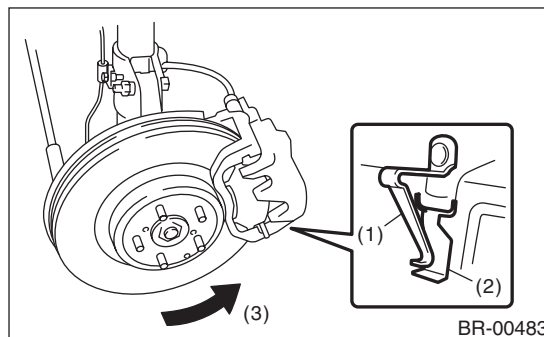

- (1) Pad return spring
- (2) Supporting surface of pad clip
- (3) Direction of brake rotor rotation

5) Install the caliper body to the support.

Tightening torque:

27 N·m (2.8 kgf-m, 19.9 ft-lb)

C: INSPECTION

Check the pad thickness A.

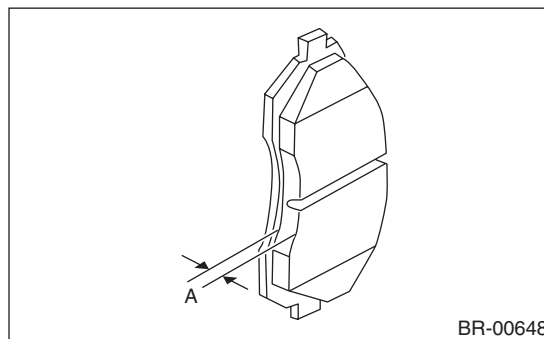

Pad thickness mm (in)	Standard	11 (0.433)
	Wear limit	1.5 (0.059)

NOTE:

- Always replace the pads of both sides as a set on both wheels.
- Replace pad clips if they are twisted or worn.
- Replace the pad if there is oil or grease on it.