

## 5. Spark Plug

### A: REPLACEMENT

- 1) Remove the battery and battery carrier.
- 2) Remove the air cleaner case.
- 3) Detach the connector from ignition coil.
- 4) Remove the ignition coil.

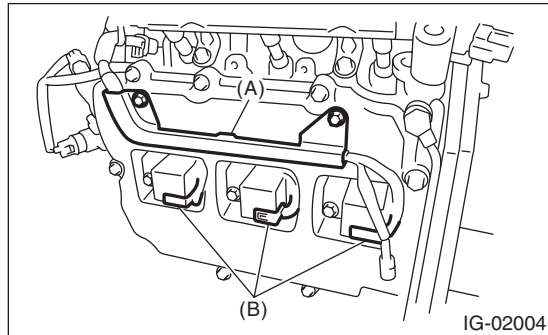

- (A) Bracket  
(B) Connector

- 5) Remove the spark plug with a spark plug socket.

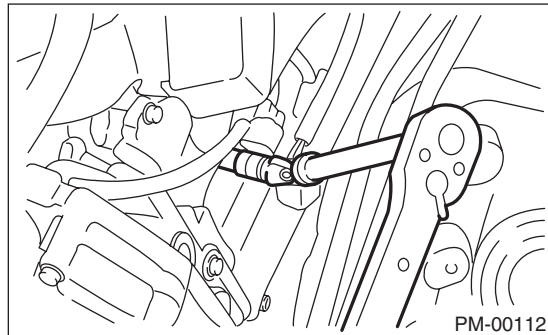

- 6) Tighten the new spark plug lightly with hand, and then secure with a spark plug socket to the specified torque.

#### **Recommended spark plug:**

**NGK: SILFR6A**

#### **Tightening torque:**

**21 N·m (2.1 kgf-m, 15.2 ft-lb)**

- 7) Tighten the ignition coil.

#### **Tightening torque:**

**16 N·m (1.6 kgf-m, 11.8 ft-lb)**

#### **NOTE:**

- Be sure to place the gasket between the cylinder head and spark plug.
- If the torque wrench is not available, tighten the spark plug until gasket contacts cylinder head; then tighten further 1/4 to 1/2 turns.