

## 12.V-belt

### A: REMOVAL

#### NOTE:

Perform the work with the engine installed to body when replacing a single part.

- 1) Remove the collector cover.
- 2) Install the tool to belt tension adjuster assembly installation bolt.
- 3) Rotate the tool clockwise and loosen the V-belt to remove.

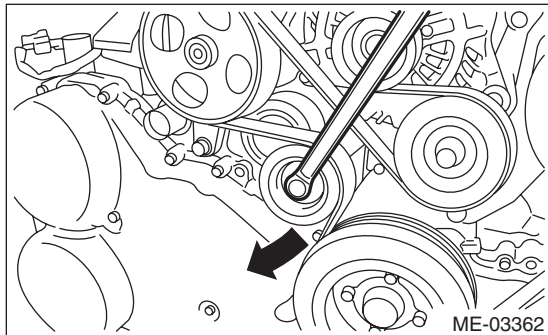

### B: INSTALLATION

Install in the reverse order of removal.

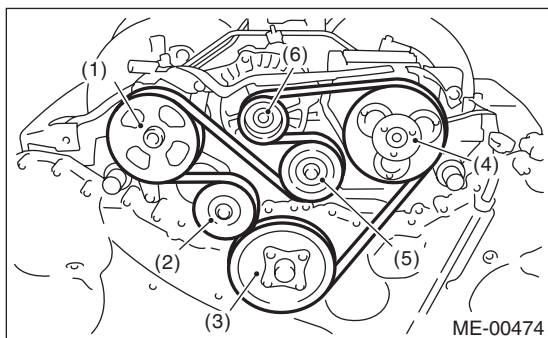

- (1) Power steering oil pump pulley
- (2) Belt tension adjuster ASSY
- (3) Crank pulley
- (4) A/C compressor
- (5) Belt idler
- (6) Generator

### C: INSPECTION

- 1) Replace the V-belt, if cracks, fraying or wear is found.
- 2) Make sure that the V-belt automatic belt tension indicator (A) is within the range (D).

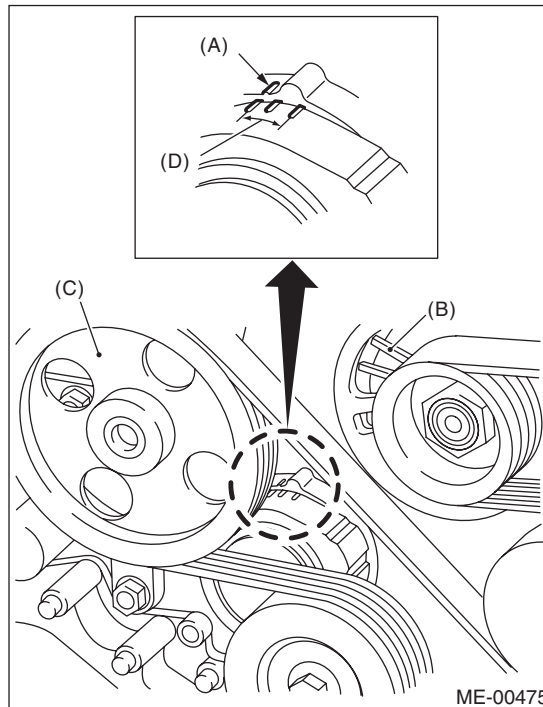

- (A) Indicator
- (B) Generator
- (C) Power steering oil pump pulley
- (D) Service limit