

13. Oil Flow Control Solenoid Valve

A: REMOVAL

1. INTAKE SIDE

- 1) Remove the collector cover.
- 2) Disconnect the ground cable from battery.
- 3) Remove the generator harness from the fuel protector RH.
- 4) Disconnect the connector from intake oil flow control solenoid valve RH.

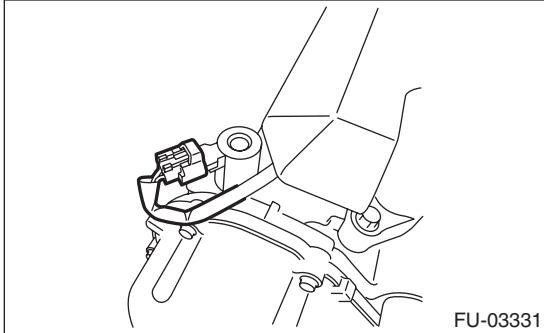

- 5) Remove the intake oil flow control solenoid valve RH.

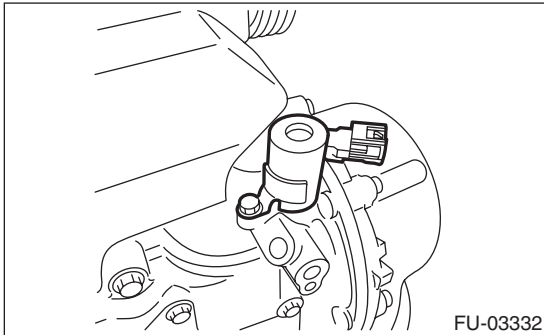

- 6) Remove the intake oil flow control solenoid valve LH in the same procedure as RH.

2. EXHAUST SIDE

- 1) Disconnect the ground cable from battery.
- 2) Lift up the vehicle.
- 3) Remove the under cover.
- 4) Disconnect the connector from exhaust oil flow control solenoid valve LH.

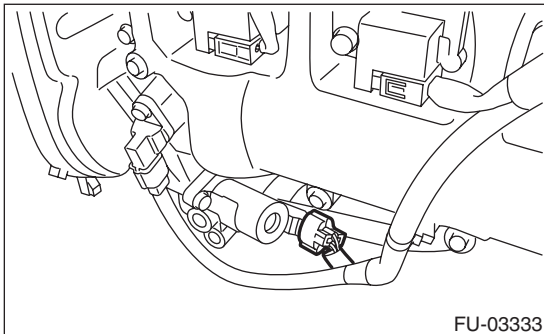

- 5) Remove the exhaust oil flow control solenoid valve LH.

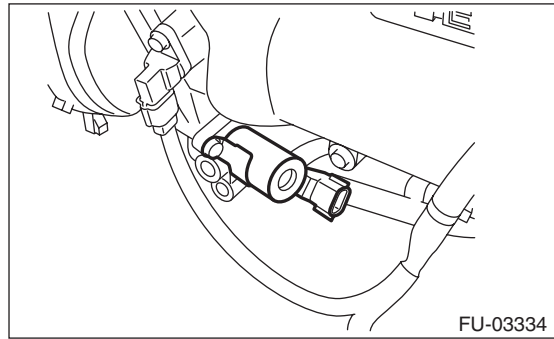

- 6) Remove the exhaust oil flow control solenoid valve RH in the same procedure as LH.

B: INSTALLATION

1. INTAKE SIDE

Install in the reverse order of removal.

Tightening torque:

Intake oil flow control solenoid valve
6.4 N·m (0.7 kgf-m, 4.7 ft-lb)

2. EXHAUST SIDE

Tightening torque:

Exhaust oil flow control solenoid valve
6.4 N·m (0.7 kgf-m, 4.7 ft-lb)