

2. Front Brake Pad

A: REMOVAL

- 1) Lift up the vehicle, and remove the front wheels.
- 2) Remove the caliper bolt.

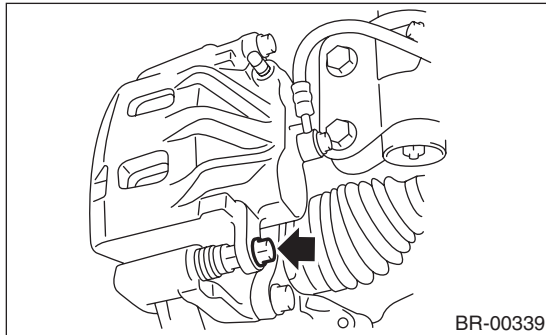

- 3) Raise the caliper body and support it.

NOTE:

Do not disconnect the brake hose from the caliper body.

- 4) Remove the pad.

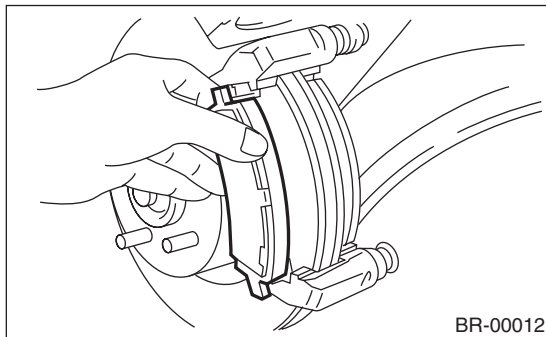

B: INSTALLATION

- 1) Apply a thin coat of Molykote M7439 (Part No. K0770YA000) to the pad clip.

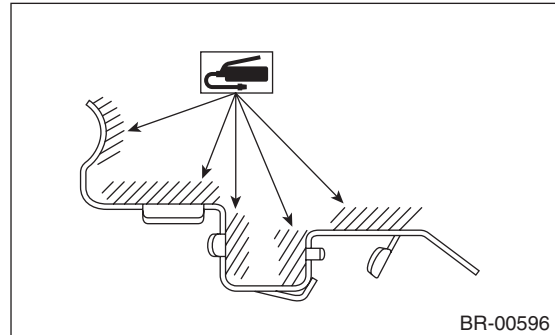

- 2) Apply a thin coat of Molykote AS880N (Part No. K0777YA010) to the contact surface between the pad and pad inner shim.

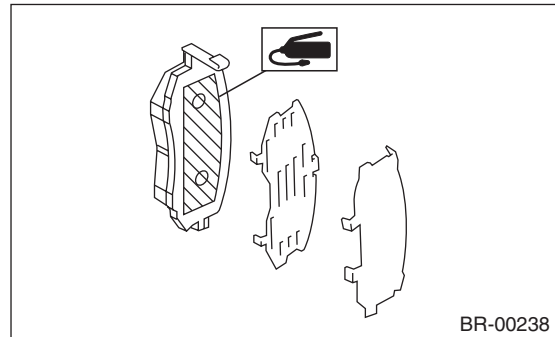

- 3) Apply a thin coat of Molykote AS880N (Part No. K0777YA010) to three locations between inner shim of the outer side pad and outer shim.

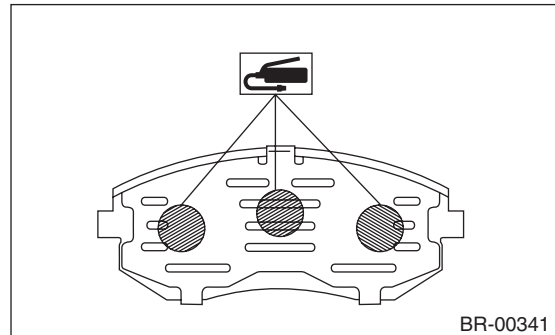

Front Brake Pad

BRAKE

4) Install the pad to support.

NOTE:

Install the pad indicator in proper direction.

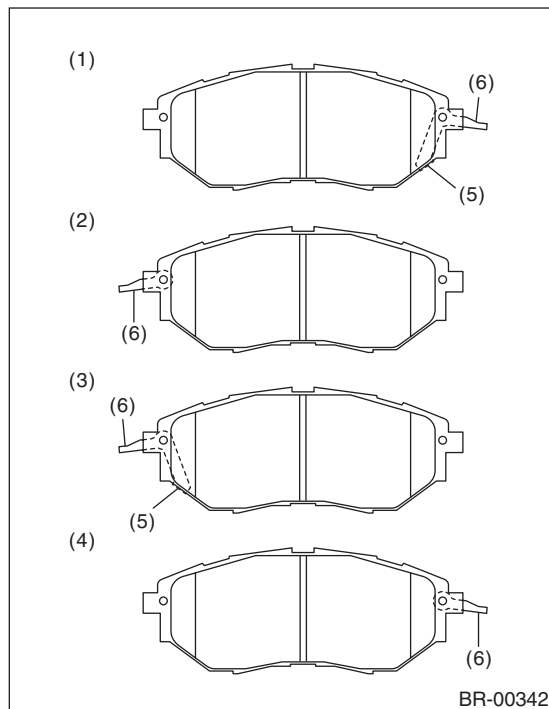

- (1) LH — IN
- (2) LH — OUT
- (3) RH — IN
- (4) RH — OUT
- (5) Pad indicator
- (6) Pad return spring

CAUTION:

- Be sure to install so that the pad return spring faces the input side of the direction of brake rotor rotation, as shown in the figure.
- Correctly install the pad return spring to the supporting surface of the pad clip as shown in the figure.
- If the pad return spring is deformed or damaged, replace the brake pad.

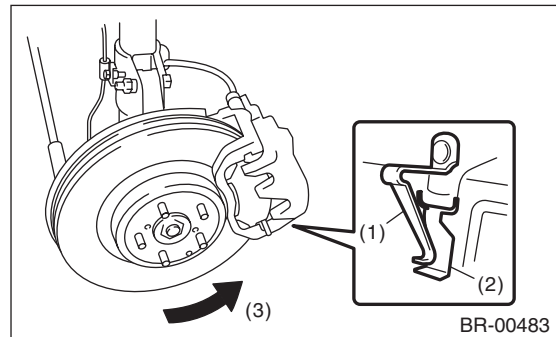

- (1) Pad return spring
- (2) Supporting surface of pad clip
- (3) Direction of brake rotor rotation

5) Install the caliper body to the support.

Tightening torque:

27 N·m (2.8 kgf-m, 19.9 ft-lb)

C: INSPECTION

Check thickness A of the pad.

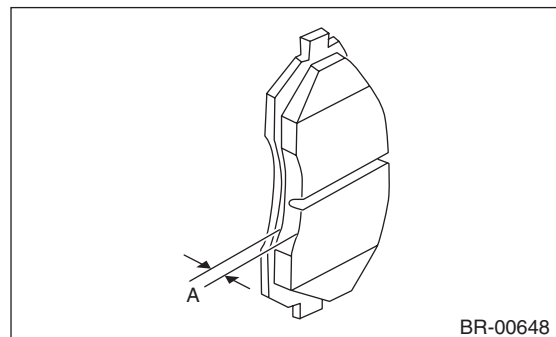

Pad thickness	Specification	11 (0.433)
mm (in)	Wear limit	1.5 (0.059)

NOTE:

- Always replace the pads on both sides as a set.
- Replace pad clips if they are twisted or worn.
- Replace the pad if there is oil or grease on it.