

4. Anticorrosion Wax

A: SPECIFICATION

Used material:

Rust-stop aerosol (K0877YA015)

▨: Application area

- Door (Application thickness = 20 μm or more)

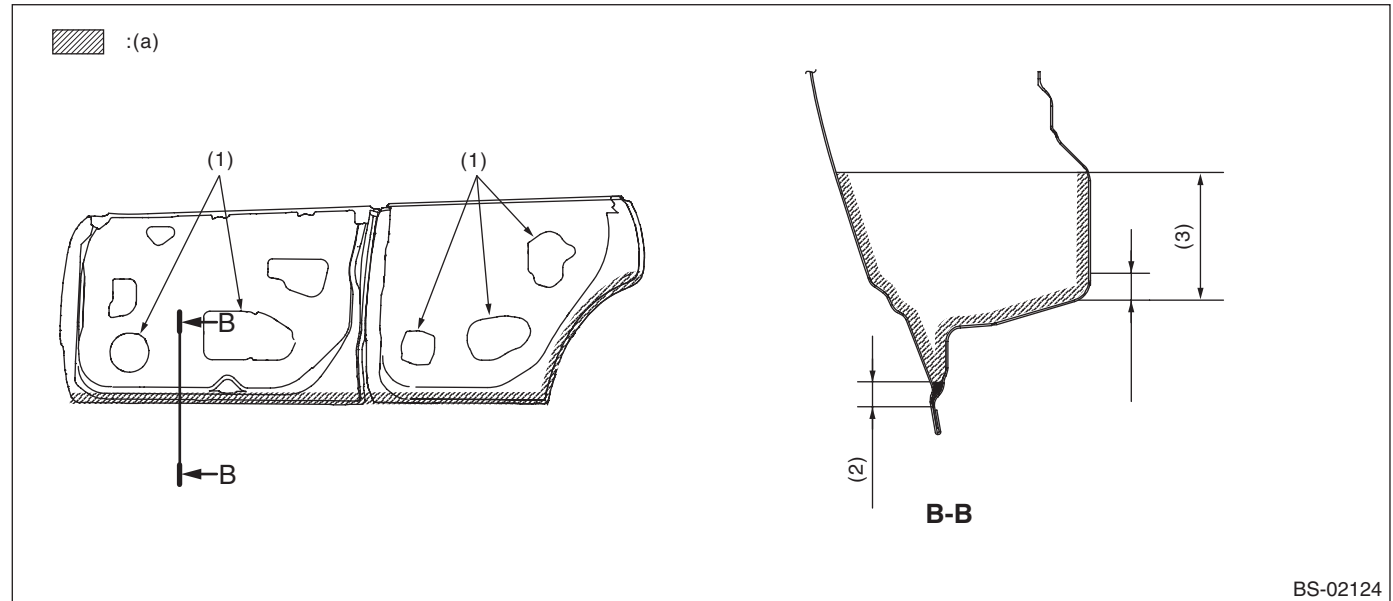

(a) Rust-stop aerosol

(1) Wax application work openings

(2) 10 mm (0.39 in)

(3) 50 mm (1.97 in)

- Rear gate (Application thickness = 15 μm or more)

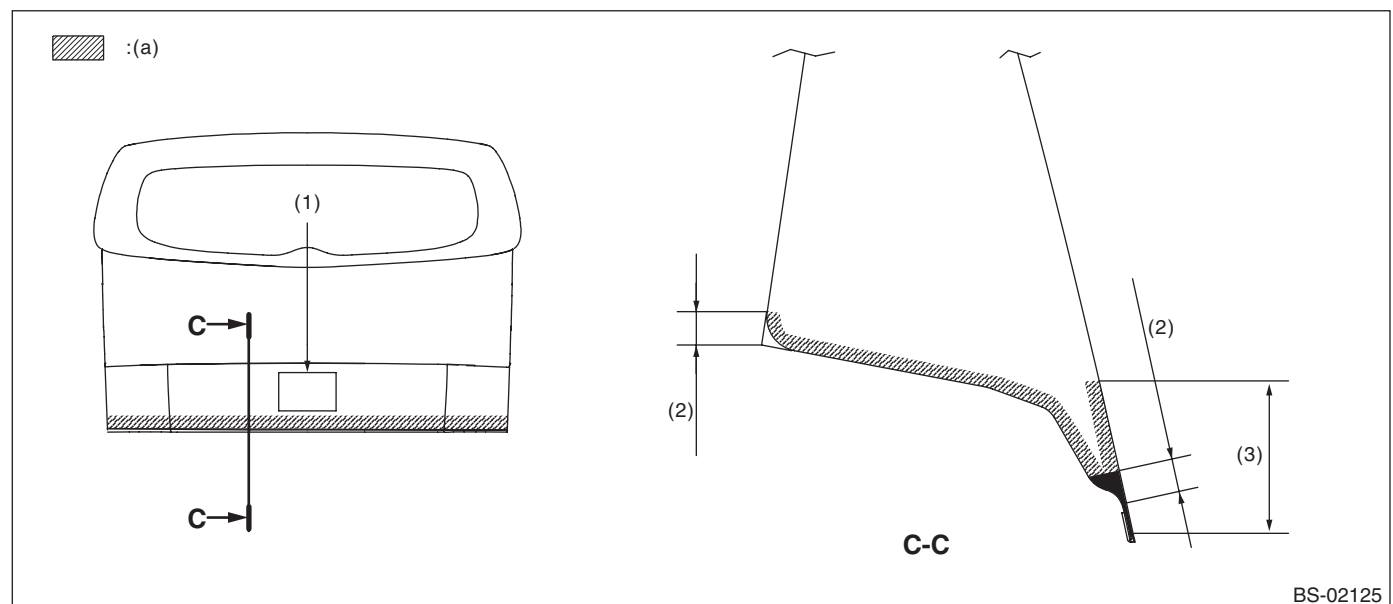

(a) Rust-stop aerosol

(1) Wax application work openings

(2) 10 mm (0.39 in)

(3) 50 mm (1.97 in)

Anticorrosion Wax

BODY STRUCTURE

- Front hood hinge (Application thickness = 15 μm or more)

Apply around the installation outer circumference (indicated range) at two locations on the left and right.

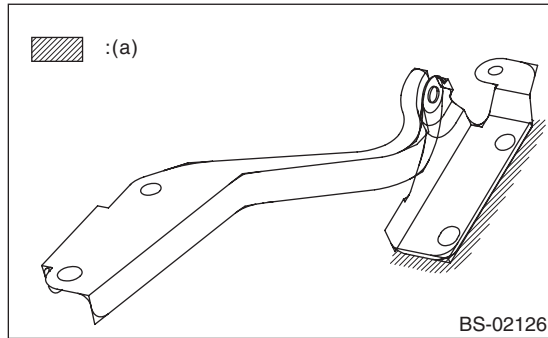

(a) Rust-stop aerosol

- Rear gate hinge (Application thickness = 15 μm or more)

Apply around the installation outer circumference (plate edges) at two locations on the left and right.

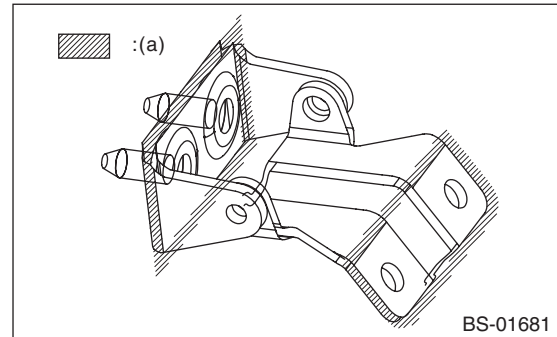

(a) Rust-stop aerosol

- Door hinge (Application thickness = 15 μm or more)

Apply to the installation outer circumference (indicated range) at two locations at the top and bottom (eight locations in all).

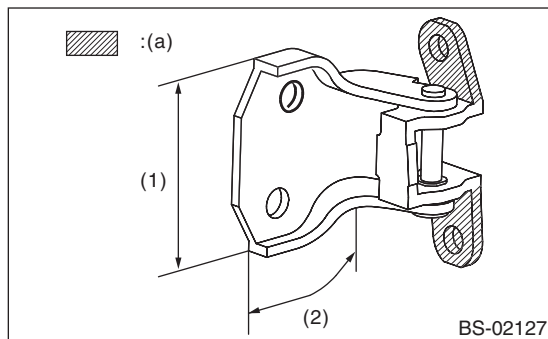

(a) Rust-stop aerosol

- (1) Application thickness of 15 μm or less is acceptable only on the front door hinge
- (2) Application thickness of 15 μm or less is acceptable both on the front and rear door hinge

- Overall view 1

 : (a)

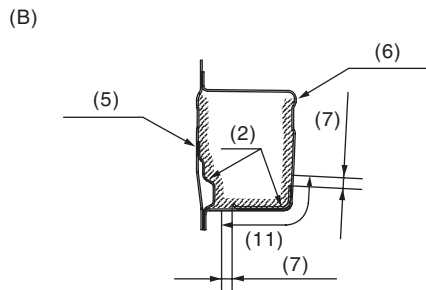
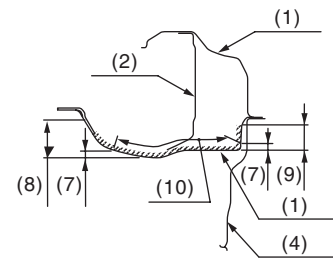
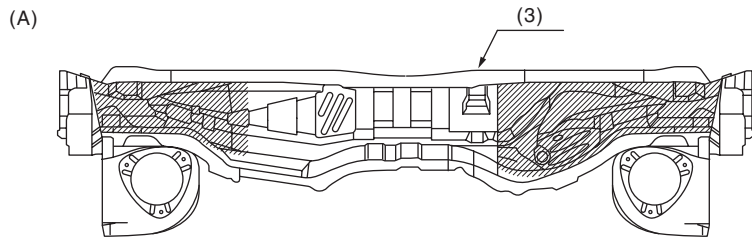
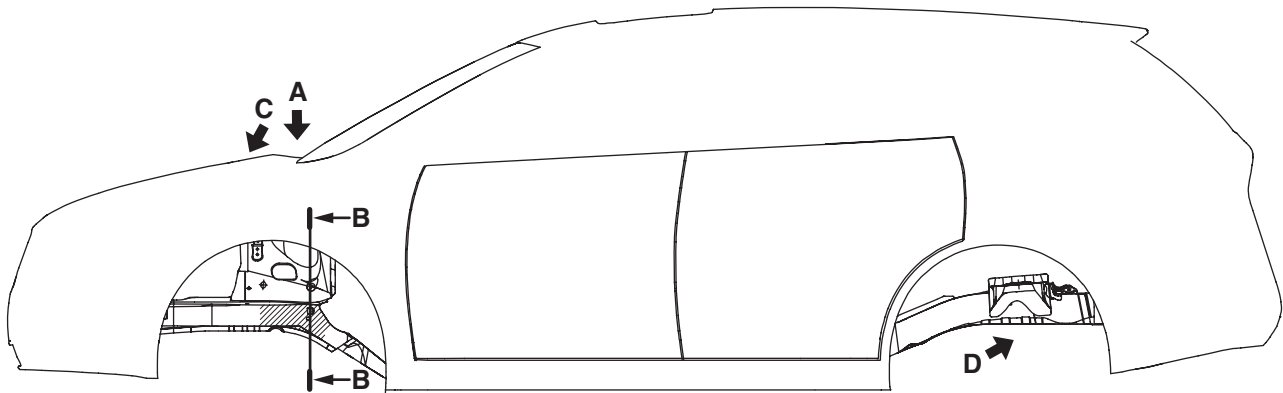
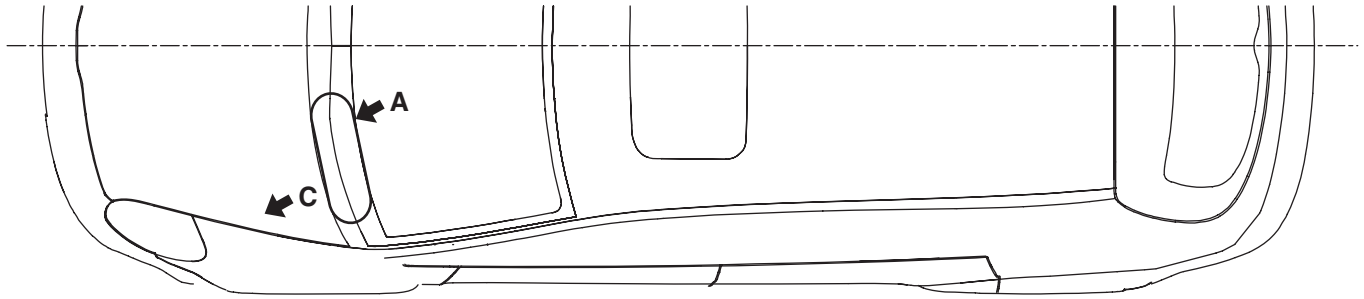

BS-01682

Anticorrosion Wax

BODY STRUCTURE

(a) Rust-stop aerosol

(A) View A (Application thickness = 20
µm or more)

(B) Cross section B — B (Application
thickness = 15 µm or more)

(1) Front panel

(2) Reinforcement

(3) Bulkhead

(4) Toe board

(5) Closing plate

(6) Side frame

(7) 10 mm (0.39 in)

(8) 50 mm (1.97 in)

(9) 35 mm (1.38 in)

(10) Application thickness = 50 µm or
more

(11) Application thickness = 50 µm or
more
(Reinforcement mating surface)

- Overall view 2

 : (a)

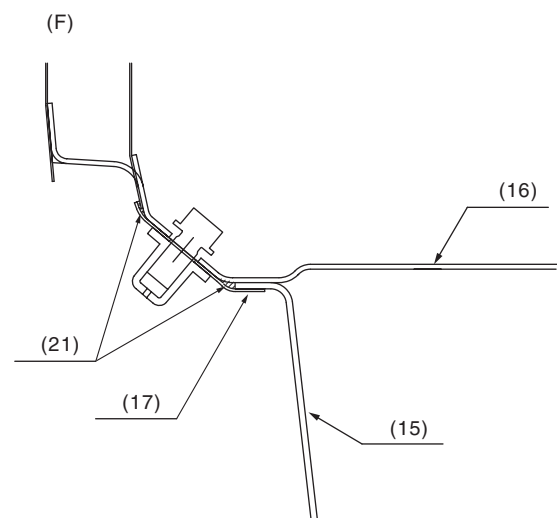
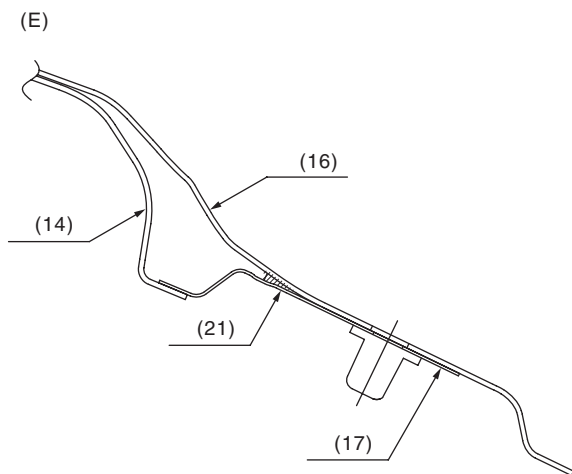
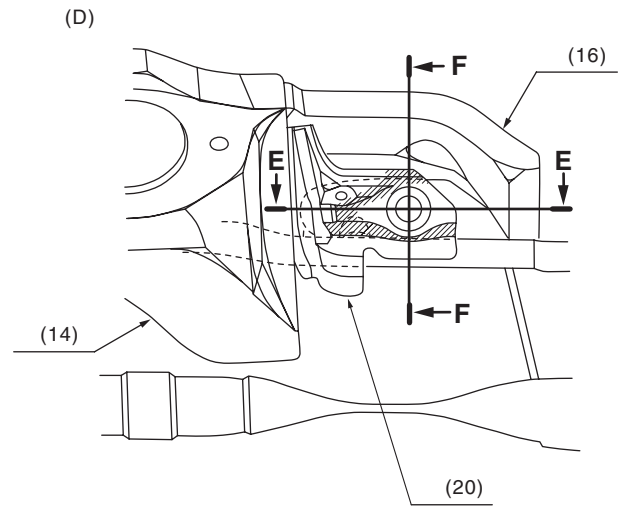
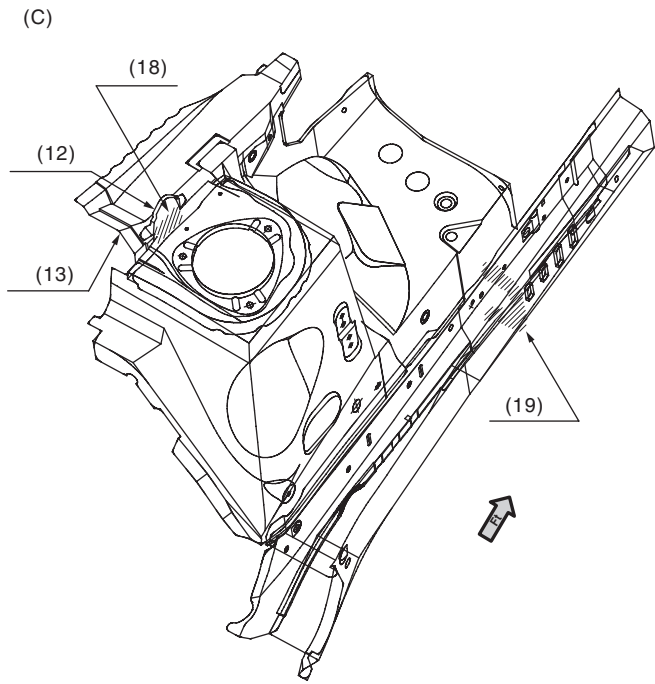

BS-01716

Anticorrosion Wax

BODY STRUCTURE

(a) Rust-stop aerosol

(C) View C

(D) View D

(E) Cross section E — E

(F) Cross section F — F

(12) Hood stay bracket

(13) Wheel apron upper

(14) Damper bracket

(15) Side frame

(16) Closing plate

(17) Anchor bracket

(18) Apply to the mating surface and between the hood stay bracket wheel apron upper.

(Application thickness = 15 µm or more)

(19) Apply to the side frame welded seam.
(Application thickness = 15 µm or more)

(20) Third-row seat anchor bracket

(21) Application area

- Bottom view

 : (a)

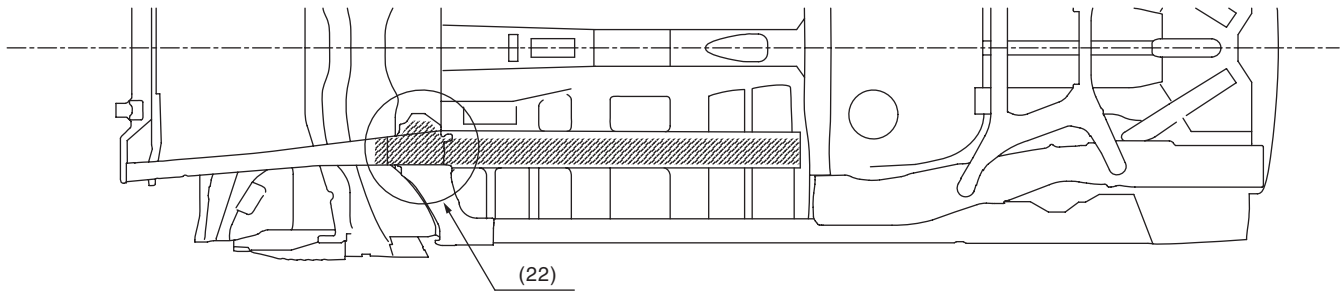

(G)

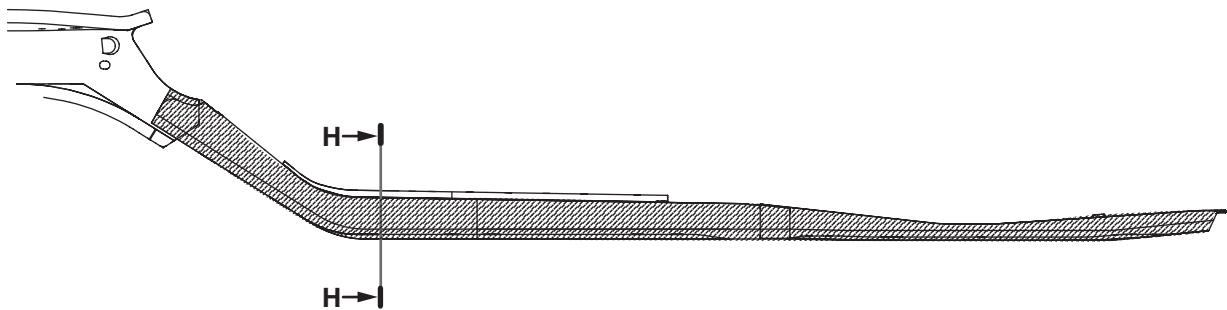

(H)

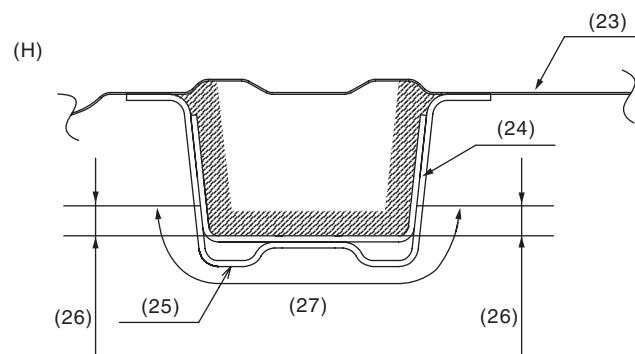

BS-01710

Anticorrosion Wax

BODY STRUCTURE

- | | | |
|---|---|--|
| (a) Rust-stop aerosol | | |
| (G) Side frame side view | (H) Cross section H — H (Application thickness = 20 µm or more) | |
| (22) Apply to the inside of suspension bracket. | (24) Reinforcement | (27) Application thickness = 50 µm or more |
| | (25) Side frame | |
| (23) Floor pan | (26) 10 mm (0.39 in) | |