

## 6. V-belt

### A: INSPECTION

- 1) Replace the belts if cracks, fraying or wear are found.
- 2) Make sure that the V-belt automatic belt tension indicator (A) is within the range of its use limit (D).

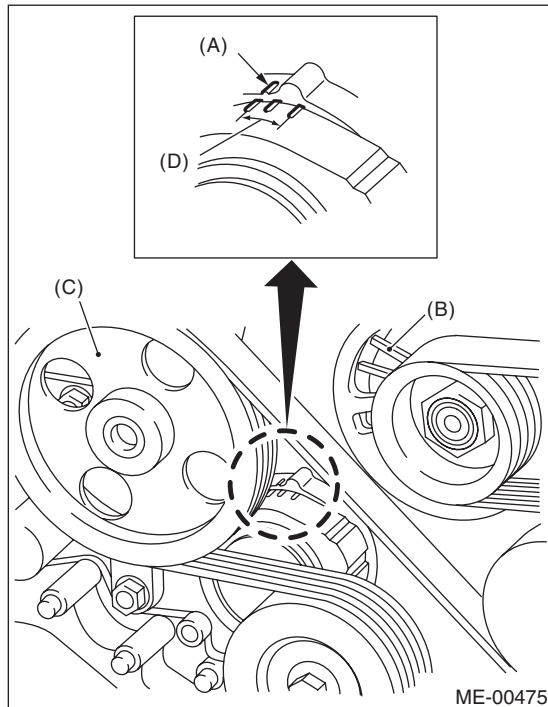

- (A) Indicator
- (B) Generator
- (C) Power steering oil pump
- (D) Service limit

### B: REPLACEMENT

- 1) Remove the cover.
- 2) Fit the tool to the belt tensioner mounting bolt.
- 3) Turn the tool in the direction of the arrow, and loosen the V-belt to remove it.

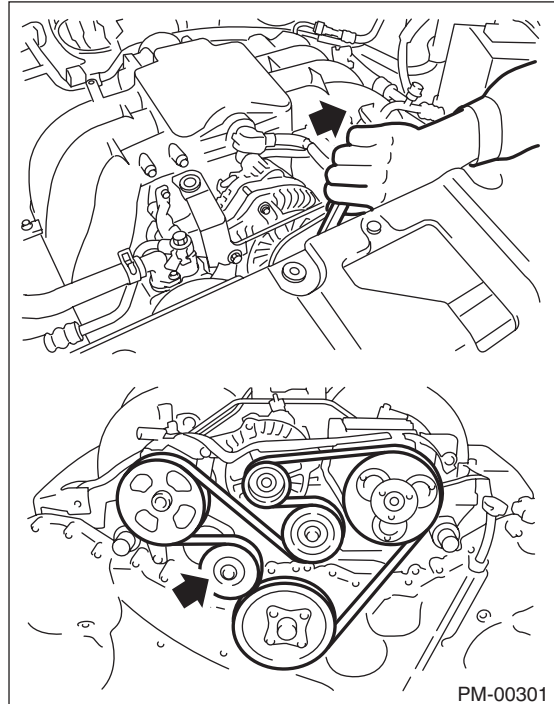

- 4) Install in the reverse order of removal.

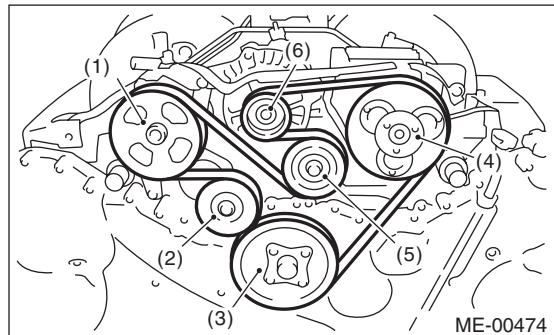

- (1) Power steering oil pump
- (2) Belt tension adjuster
- (3) Crank pulley
- (4) A/C compressor
- (5) Belt idler
- (6) Generator