

13.Oil Temperature Sensor

A: REMOVAL

- 1) Remove the collector cover.
- 2) Disconnect the ground cable from the battery.
- 3) Remove the air intake chamber. <Ref. to IN(H6DO)-6, REMOVAL, Air Intake Chamber.>
- 4) Disconnect the connector from oil temperature sensor.
- 5) Remove the oil temperature sensor.

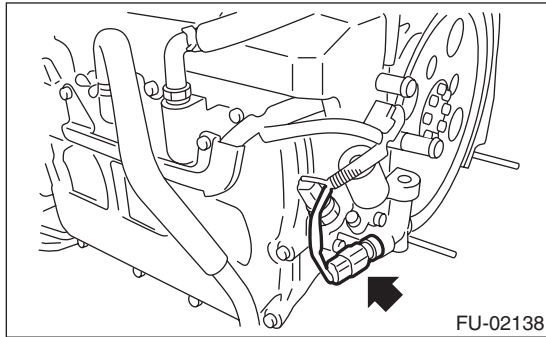

B: INSTALLATION

Install in the reverse order of removal.

Tightening torque:

18 N·m (1.8 kgf-m, 13.3 ft-lb)