

# Front Brake Pad

## BRAKE

### 2. Front Brake Pad

#### A: REMOVAL

- 1) Lift-up the vehicle, and remove the front wheels.
- 2) Remove the caliper bolt.

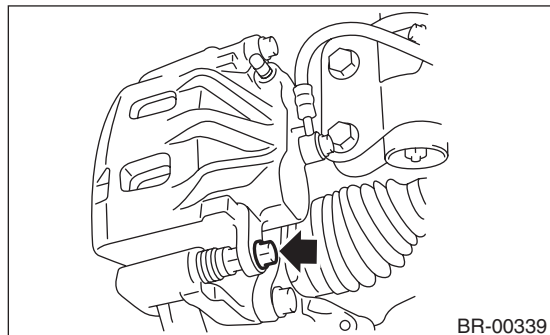

- 3) Raise the caliper body and support it.

#### NOTE:

Do not disconnect the brake hose from the caliper body.

- 4) Remove the pad.

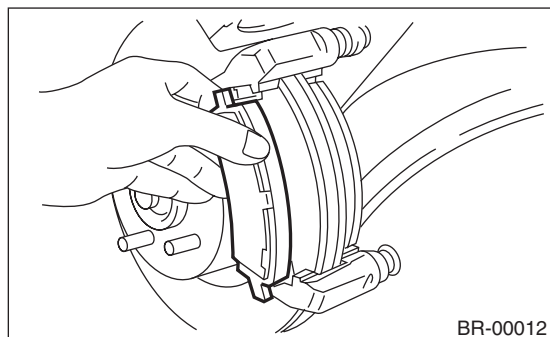

#### B: INSTALLATION

- 1) Apply a thin coat of Molykote M7439 to the pad clip.

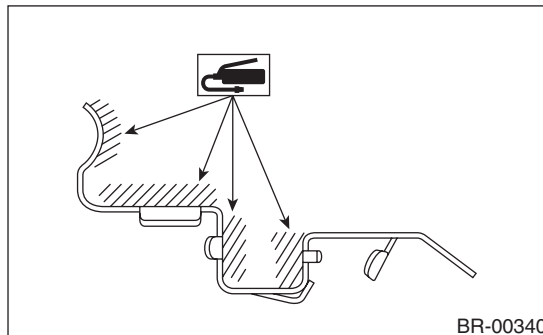

- 2) Apply a thin coat of Molykote AS880N (Part No. K0779YA010) to the contact surface between the pad and pad inner shim.

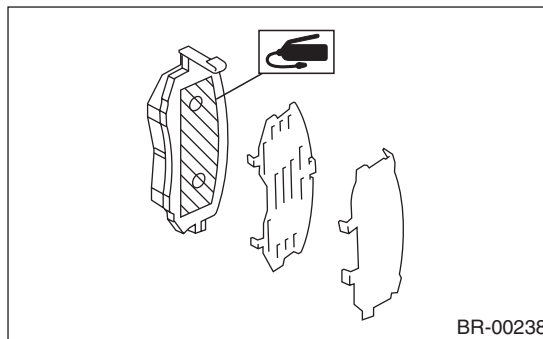

- 3) Apply a thin coat of Molykote AS880N (Part No. K0779YA010) to the three contact surfaces between inner shim and outer shim of outer pads.

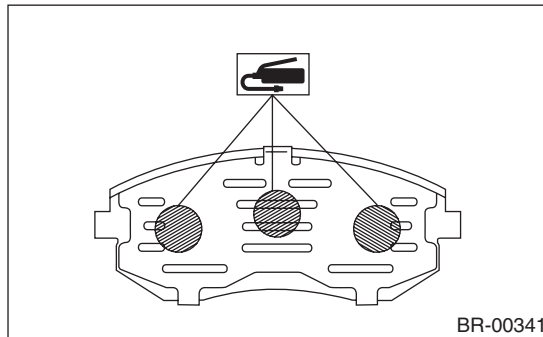

4) Install the pad to support.

**NOTE:**

Install the pad indicator in proper direction.

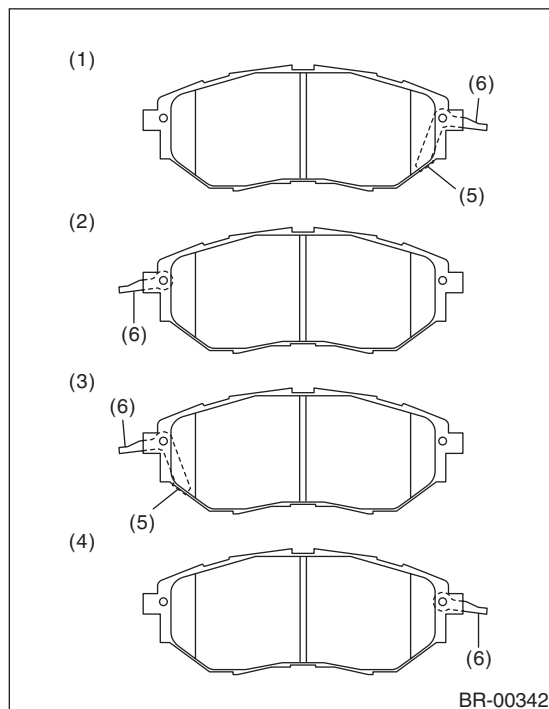

- (1) LH – IN
- (2) LH – OUT
- (3) RH – IN
- (4) RH – OUT
- (5) Pad indicator
- (6) Pad return spring

**CAUTION:**

- Be sure to install so that the pad return spring faces the input side of the direction of brake rotor rotation, as shown in the figure.
- Correctly install the pad return spring to the supporting surface of the pad clip as shown in the figure.
- If the pad return spring is deformed or damaged, replace the brake pad.

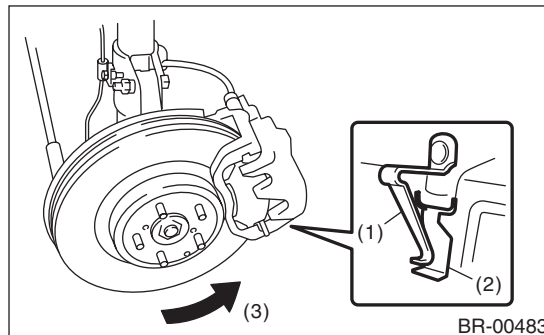

- (1) Pad return spring
- (2) Supporting surface of pad clip
- (3) Direction of brake rotor rotation

5) Install the caliper body to the support.

**Tightening torque:**

**27 N·m (2.8 kgf-m, 19.9 ft-lb)**

**C: INSPECTION**

Check thickness A of the pad.

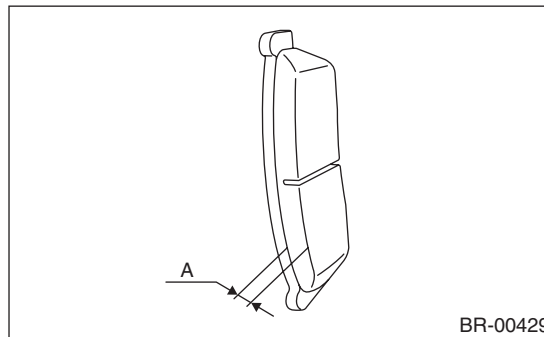

Pad thickness mm (in)	Specification	11 (0.433)
	Wear limit	1.5 (0.059)

**NOTE:**

- Always replace the pads on both sides as a set.
- Replace pad clips if they are twisted or worn.
- Replace the pad if there is oil or grease on it.