

# Front Oxygen (A/F) Sensor

## FUEL INJECTION (FUEL SYSTEMS)

### 14. Front Oxygen (A/F) Sensor

#### A: REMOVAL

- 1) Set the vehicle on a lift.
- 2) Disconnect the ground cable from battery.
- 3) Lift-up the vehicle.
- 4) Disconnect the connector of front oxygen (A/F) sensor.

- LH side

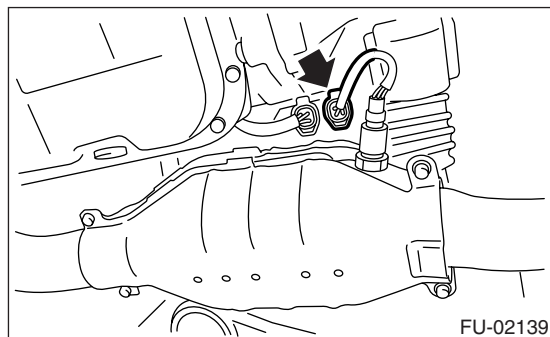

- RH side

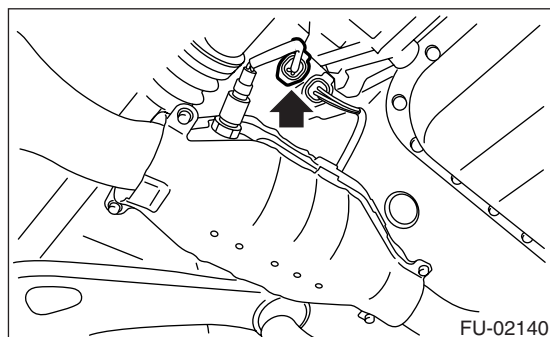

- 5) Apply spray-type lubricant to the threaded portion of front oxygen (A/F) sensor, and leave it for one minute or more.
- 6) Remove the front oxygen (A/F) sensor.

#### CAUTION:

**When removing the front oxygen (A/F) sensor, wait until exhaust pipe cools, otherwise it will damage the exhaust pipe.**

- LH side

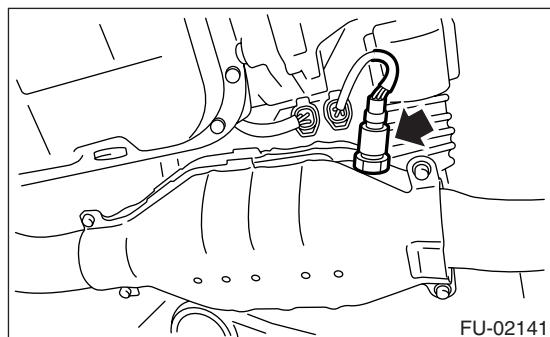

- RH side

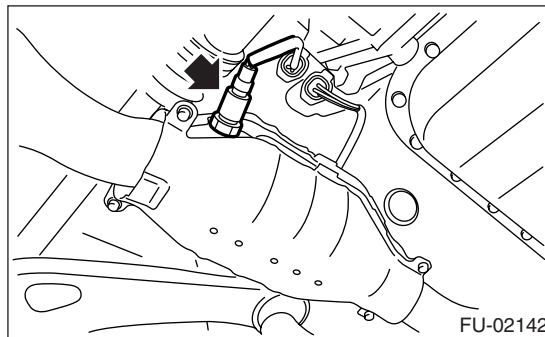

#### B: INSTALLATION

- 1) Before installing front oxygen (A/F) sensor, apply anti-seize compound only to the threaded portion of front oxygen (A/F) sensor to make the next removal easier.

#### Anti-seize compound:

**NEVER-SEEZ NS-165 or the equivalent**

#### CAUTION:

**Never apply anti-seize compound to the protector of front oxygen (A/F) sensor.**

- 2) Install the front oxygen (A/F) sensor.

#### Tightening torque:

**21 N·m (2.1 kgf-m, 15.2 ft-lb)**

- LH side

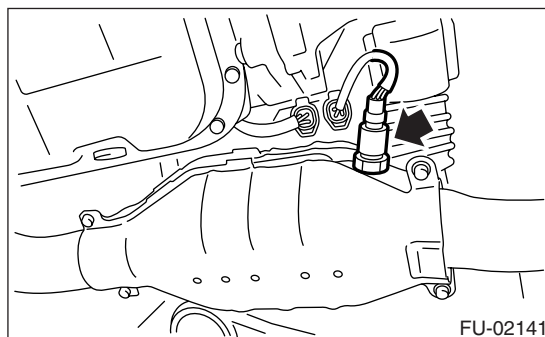

- RH side

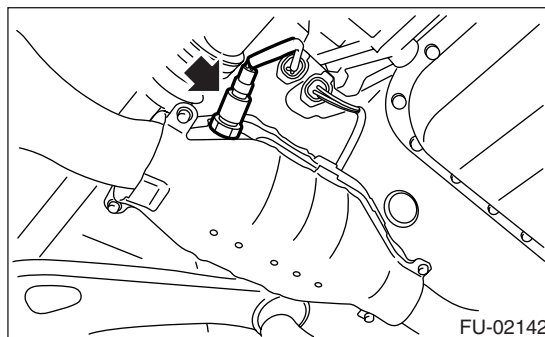

## Front Oxygen (A/F) Sensor

FUEL INJECTION (FUEL SYSTEMS)

3) Connect the connector of front oxygen (A/F) sensor.

- LH side

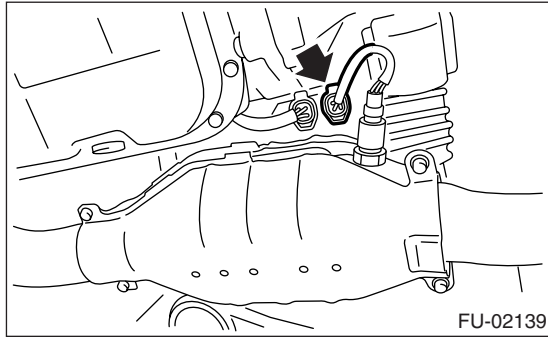

- RH side

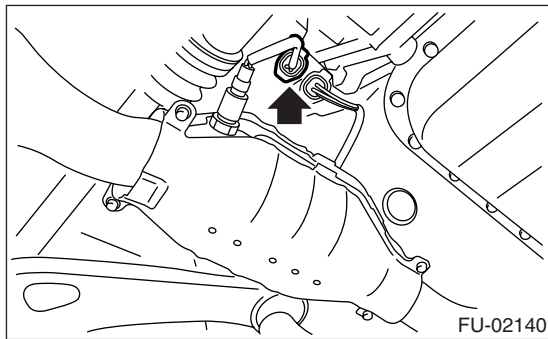

4) Lower the vehicle.

5) Connect the battery ground cable to the battery.