

Front Wiper Motor and Link

WIPER AND WASHER SYSTEMS

8. Front Wiper Motor and Link

A: REMOVAL

- 1) Disconnect the ground cable from battery.
- 2) Remove the cowl panel. <Ref. to EI-30, REMOVAL, Cowl Panel.>
- 3) Disconnect the connector of wiper motor assembly.
- 4) Remove the bolt, and then remove the wiper assembly.

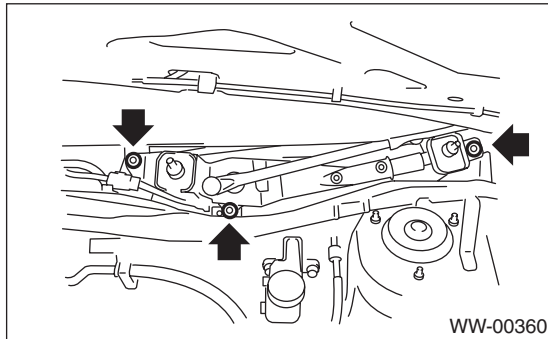

NOTE:

The wiper motor and wiper link is an assembly part and is not to be disassembled.

B: INSTALLATION

Install in the reverse order of removal.

Tightening torque:

Refer to “COMPONENT” of “General Description”.

<Ref. to WW-2, FRONT WIPER, COMPONENT, General Description.>

C: INSPECTION

- 1) When the battery is connected to the terminal of connectors, confirm that the wiper motor operates at low speed.

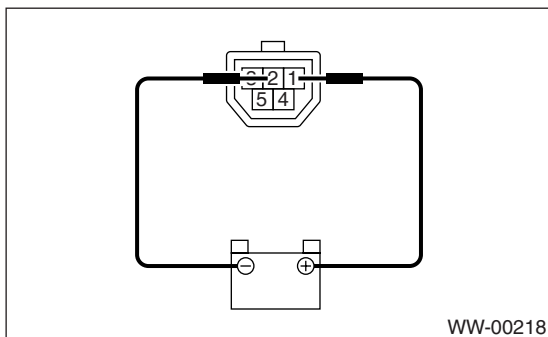

- 2) When the battery is connected to the terminal of connectors, confirm that the wiper motor operates at high speed.

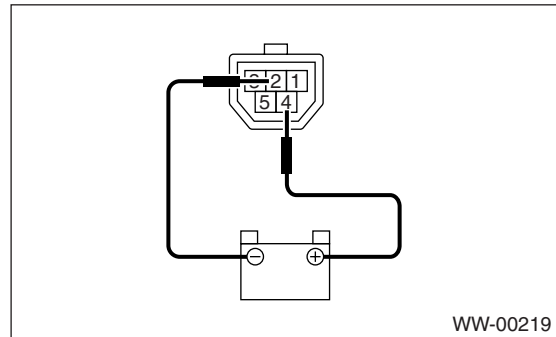

- 3) Connect the battery to the terminals to the connector, then run the wiper motor at low speed and disconnect the terminal in mid motion.

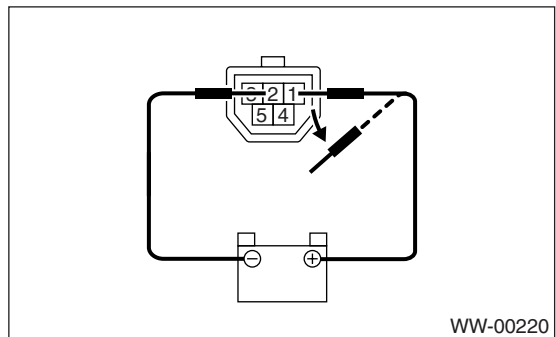

- 4) Connect the battery and confirm that the wiper motor stops at the automatic stop position after the wiper motor operates at low speed again.

