

### 3. Glass Lid

#### A: REMOVAL

- 1) Completely close the glass lid, and then open the sunshade.
- 2) Remove the cover (A), and then remove the TORX® bolts (B).

#### CAUTION:

The thread locker is applied to the TORX® bolts, so use the new parts once they are removed.

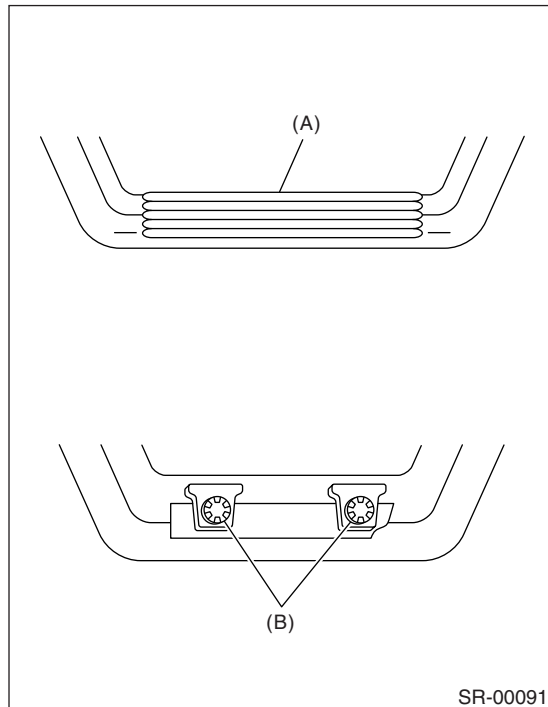

- 3) Remove the glass lid carefully.

#### B: INSTALLATION

Install in the reverse order of removal.

#### C: ADJUSTMENT

Loosen the glass lid mounting TORX® bolts (A), and then adjust the height with moving the lid.

**Difference in height between glass lid and roof panel L:**

**$2.0 \pm 1.0 \text{ mm}$  ( $0.079 \pm 0.039 \text{ in}$ )**

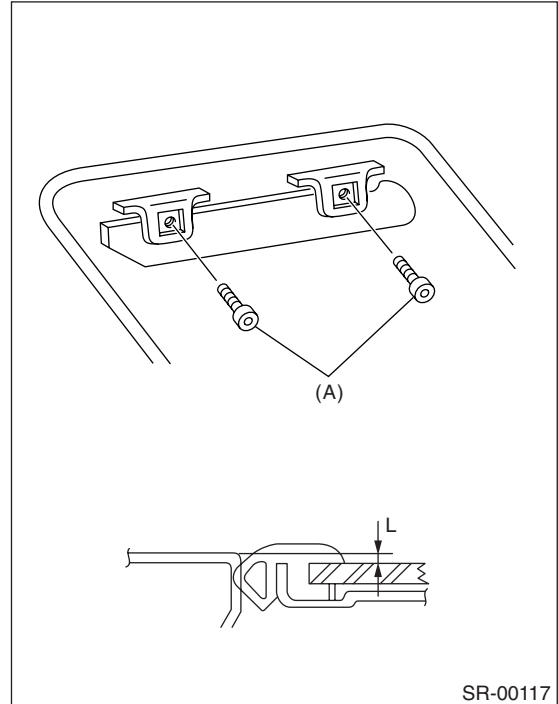

## Glass Lid

### SUNROOF/T-TOP/CONVERTIBLE TOP (SUNROOF)

---

#### D: FORCED DRIVE

If glass lid dose not operate or is not supplied with power, move the glass lid using the hexagon wrench \*.

\*: ***L shape universal purpose hexagon wrench  
bolt width 4 mm (0.16 in)***

- 1) Remove the spot map light. <Ref. to LI-29, REMOVAL, Spot Map Light.>
- 2) Remove the sunroof opening trim.

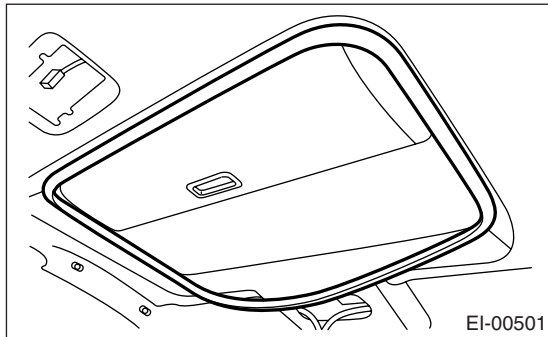

- 3) Remove the sun visor clip.
- 4) Insert the hexagon wrench securely until it touches the motor shaft edge.

#### **CAUTION:**

**Make sure not to bend or wrinkle the roof trim during work.**

- 5) Turn the hexagon wrench, and move the glass lid.
  - Turning right, the glass lid open.
  - Turning left, the glass lid close.