

### 18.Hose and Tube

#### A: REMOVAL

##### CAUTION:

- When disconnecting/connecting hoses, do not apply an excessive force to them. After installing, check that no torsion or excessive tension applied to the hoses.
- Seal the disconnected hose with a plug or vinyl tape to prevent foreign matter from entering.

#### 1. FRONT

- 1) Disconnect the ground cable from battery.
- 2) Using the refrigerant recovery system, discharge refrigerant. <Ref. to AC-20, PROCEDURE, Refrigerant Recovery Procedure.>
- 3) Remove the evaporator unit mounting bolt (A) and low-pressure hose bracket bolt (B).
- 4) Remove the low-pressure hose attaching bolts (C).
- 5) Disconnect the low-pressure hose from evaporator unit.
- 6) Disconnect the low-pressure hose from compressor.
- 7) Remove the low-pressure hose from vehicle.
- 8) Remove the high-pressure hose attaching bolt (D).
- 9) Disconnect the high-pressure hose from compressor.
- 10) Disconnect the high-pressure hose from condenser.
- 11) Remove the high-pressure hose from vehicle.
- 12) Remove the high-pressure tube attaching bolt (E).

- 13) Remove the high-pressure tube from vehicle.

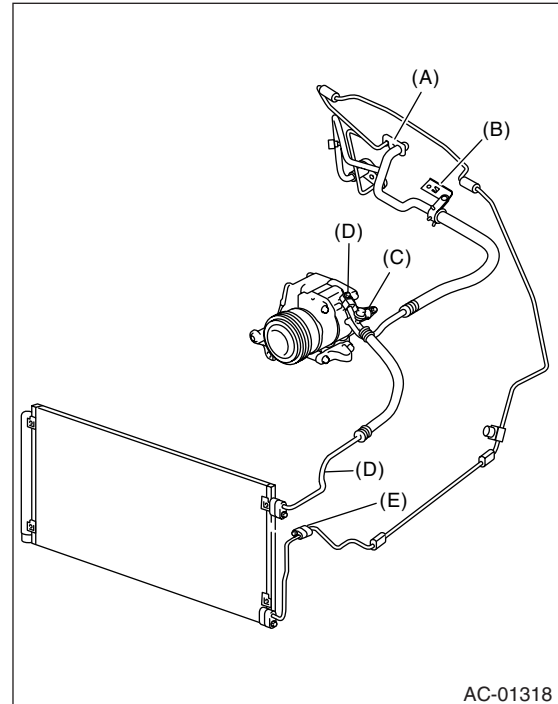

#### 2. REAR

- 1) Disconnect the ground cable from battery.
  - 2) Using the refrigerant recovery system, discharge refrigerant. <Ref. to AC-20, PROCEDURE, Refrigerant Recovery Procedure.>
  - 3) Remove the sheet and floor mat. <Ref. to EI-47, REMOVAL, Floor Mat.>
  - 4) Remove the ECM bracket and tube protector. <Ref. to FU(H6DO)-32, REMOVAL, Engine Control Module (ECM).>
  - 5) Remove the quick connectors (A and B).
- ST REMOVER PS73499XA01A  
ST REMOVER PD73499XA00A

##### NOTE:

Refer to the instruction manual for the ST when working.

- 6) Remove the tube bracket.
- 7) Remove the front tube and rear tube connecting bolts (C)
- 8) Remove the connecting bolts (D) of the rear cooler unit.

9) Remove the front tube (E) and rear tube (F).

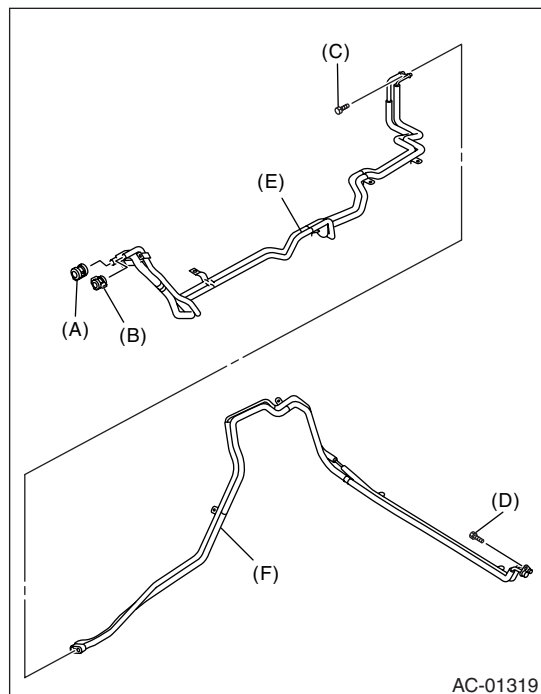

## B: INSTALLATION

### CAUTION:

- When disconnecting or connecting the hoses, do not apply excessive force. After installing, check that no torsion or excessive tension applied to the hoses.
- Seal the disconnected hose with a plug or vinyl tape to prevent foreign matter from entering.

- 1) Install in the reverse order of removal.
- 2) Charge refrigerant. <Ref. to AC-21, PROCEDURE, Refrigerant Charging Procedure.>

### Tightening torque:

**Refer to “COMPONENT” of “General Description”.** <Ref. to AC-11, AIR CONDITIONING UNIT, COMPONENT, General Description.>

## C: INSPECTION

Check the hoses for cracks, damage and expansion. If any fault is found, replace with new parts.