

## 7. Woofer

### A: REMOVAL

#### 1. SEDAN MODEL

NOTE:

harman/kardon® audio system only.

- 1) Disconnect the ground cable from battery.
- 2) Remove the rear shelf trim. <Ref. to EI-120, REMOVAL, Rear Shelf Trim.>
- 3) Remove the woofer.
  - (1) Remove the screws.
  - (2) Disconnect the harness connector and remove the woofer assembly.

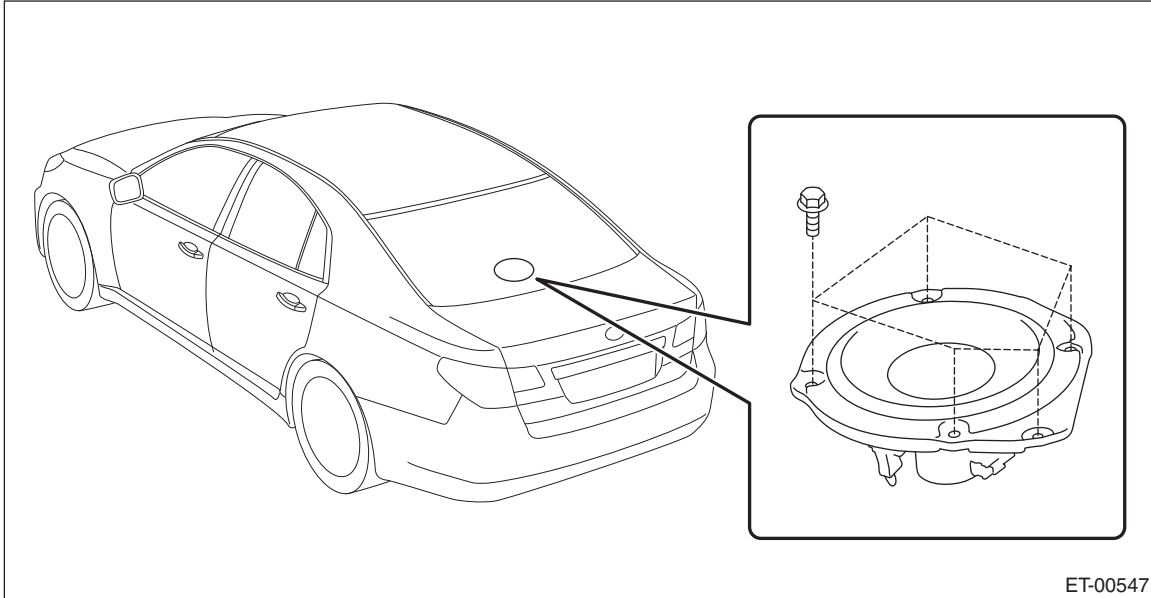

### 2. OUTBACK MODEL

#### NOTE:

harman/kardon® audio system only.

- 1) Disconnect the ground cable from battery.
- 2) Remove the rear quarter trim LWR. <Ref. to EI-114, OUTBACK MODEL, REMOVAL, Rear Quarter Trim.>
- 3) Remove the woofer.
  - (1) Remove the woofer bracket mounting clips and screws, then remove the woofer bracket.
  - (2) Disconnect the harness connector and remove the woofer assembly.

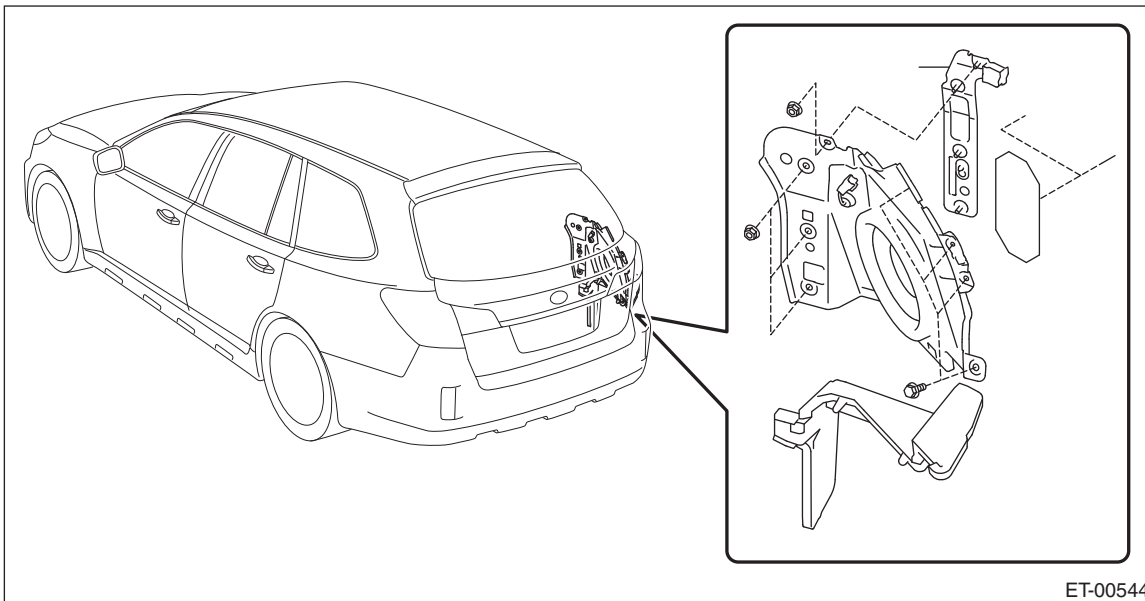

ET-00544

### B: INSTALLATION

Install each part in the reverse order of removal.

#### ***Tightening torque:***

***7.5 N·m (0.76 kgf-m, 5.5 ft-lb)***