

8. Front Washer Nozzle

A: REMOVAL

- 1) Disconnect the ground cable from battery.
- 2) Remove the front wiper arm assembly.

CAUTION:

Follow the steps below when standing up the wiper arm. Not following the steps may cause contact-
ing of wiper arms and damages of wiper arms.

1. Stand up the driver's side wiper arm.
2. Stand up the passenger's side wiper arm.

Fold the wiper arms in the reverse order.

- (1) Remove the cap.
- (2) Remove the nuts, and remove the front wiper arm assembly.

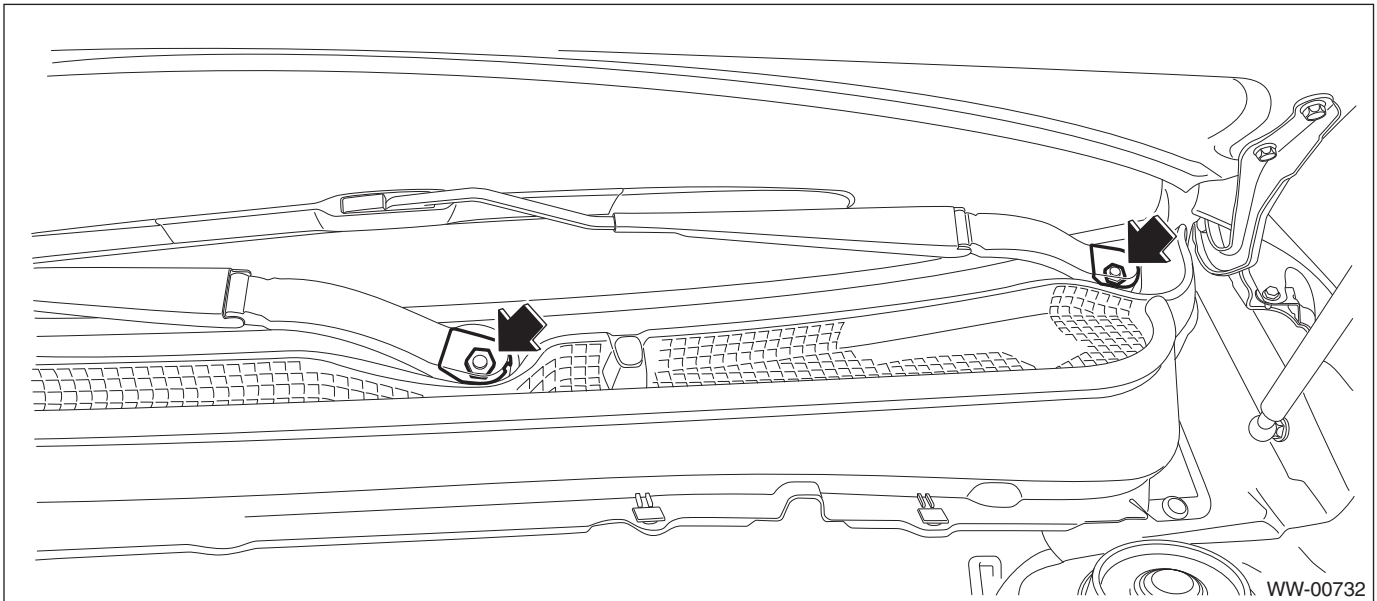

Front Washer Nozzle

WIPER AND WASHER SYSTEMS

3) Remove the cowl panel side.

- (1) Detach the pins of the cowl panel side.
- (2) Remove the cowl panel side from inside the fender panel by pulling it.

CAUTION:

Applying excessive pulling force may damage the cowl panel side. If it is difficult to remove, use a plastic remover or equivalent tool.

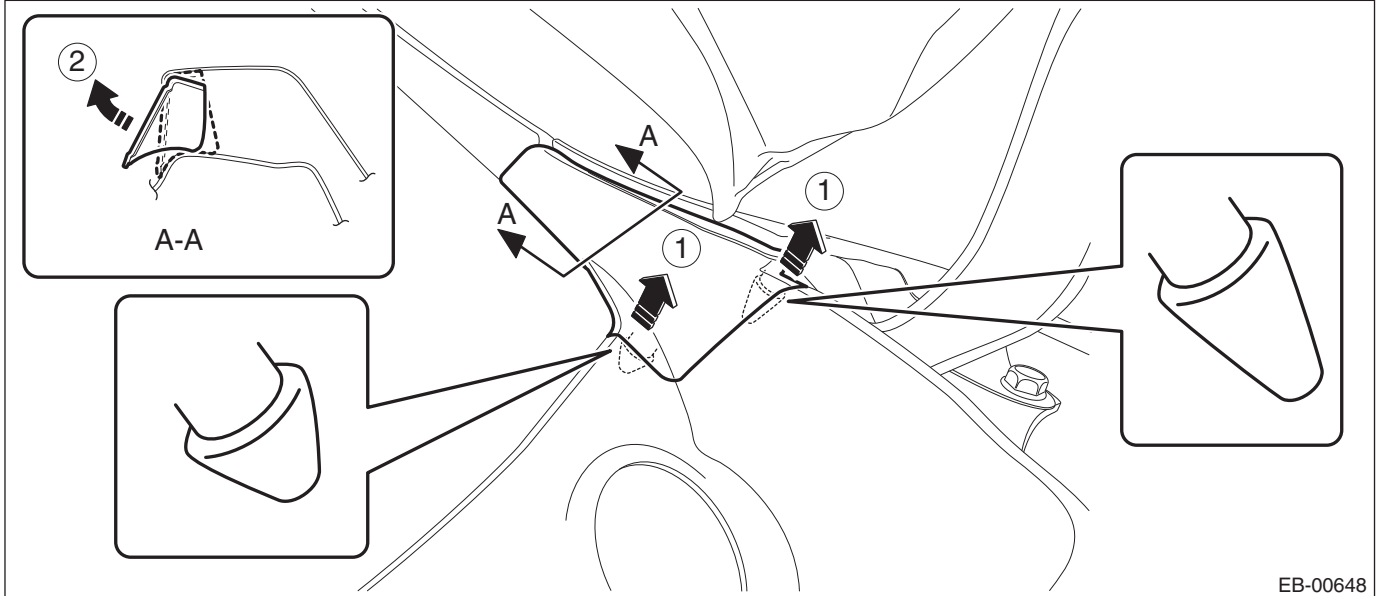

4) Remove the cowl panel.

- (1) Release the clip (A).
- (2) Push the claw of the clip (B) from both sides to remove it.

CAUTION:

When removing the clip (B), push the claw of the clip from both sides. The clip may be damaged if forcibly pulled.

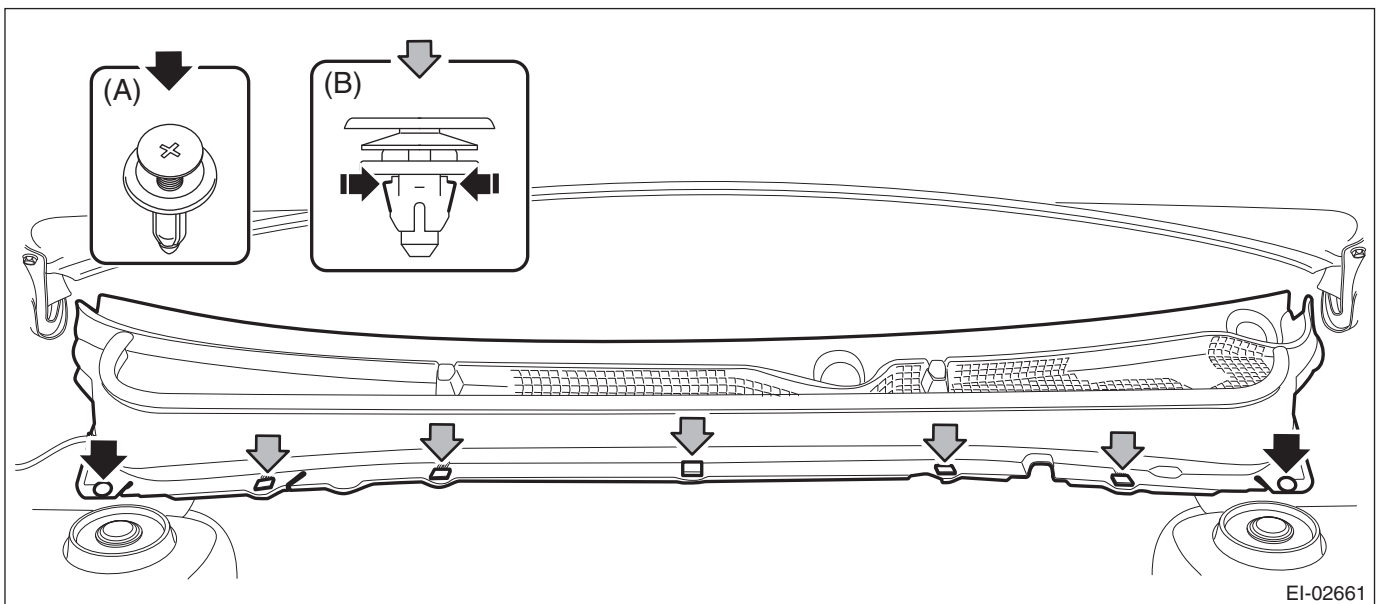

- (3) Disconnect the washer hose.

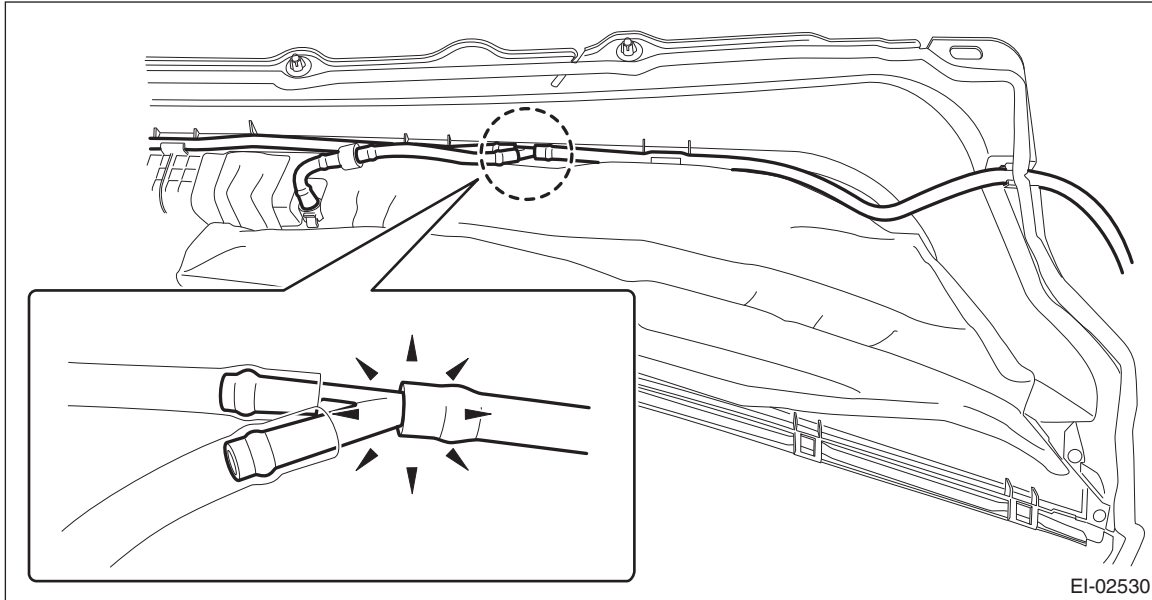

- 5) Remove the front washer nozzle.

- (1) Push the claw using a flat tip screwdriver, etc.
- (2) When the washer nozzle lifts up, pull out the nozzle using a clip remover, etc.
- (3) Disconnect the washer hose and remove the washer nozzle.

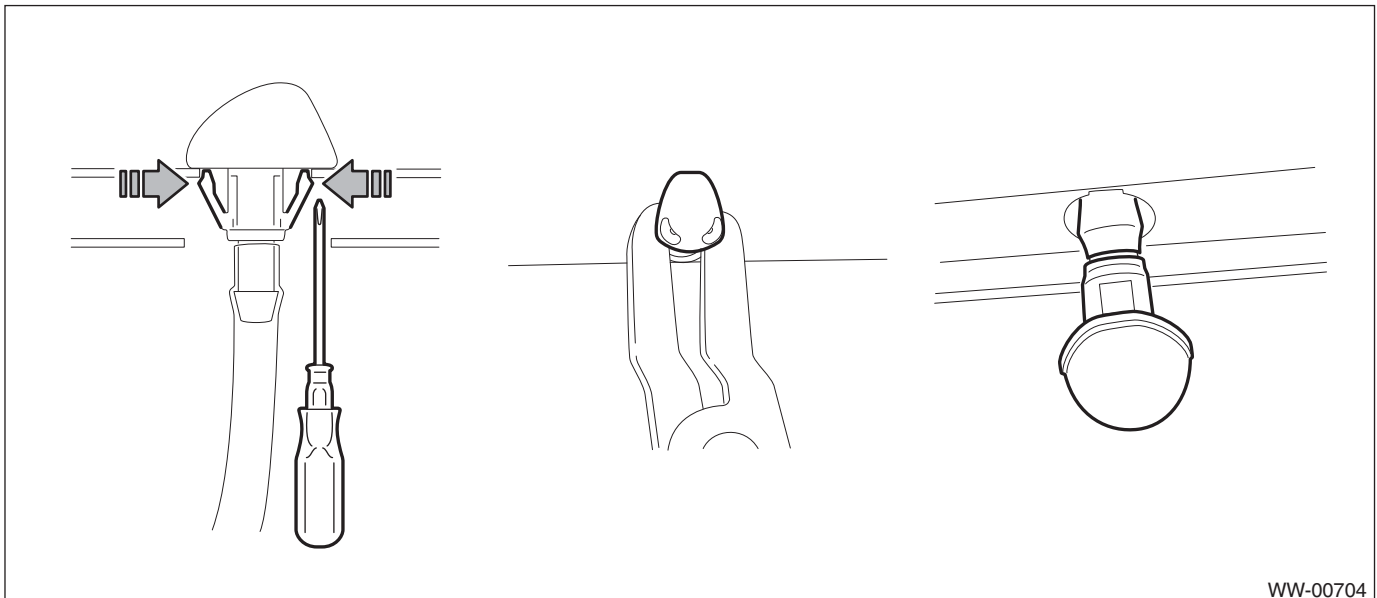

B: INSTALLATION

- 1) Install each part in the reverse order of removal.

Tightening torque:

Refer to “COMPONENT” of “General Description”. <Ref. to WW-3, FRONT WIPER, COMPONENT, General Description.>

- 2) Adjust the washer nozzle position. <Ref. to WW-34, ADJUSTMENT, Front Washer Nozzle.>

C: INSPECTION

- Make sure the nozzle and hose are not clogged.
- Make sure the hose is not bent.

Front Washer Nozzle

WIPER AND WASHER SYSTEMS

D: ADJUSTMENT

- 1) Turn the wiper switch to OFF position.
- 2) While the vehicle is at a standstill, adjust the washer injection position as shown in the figure.

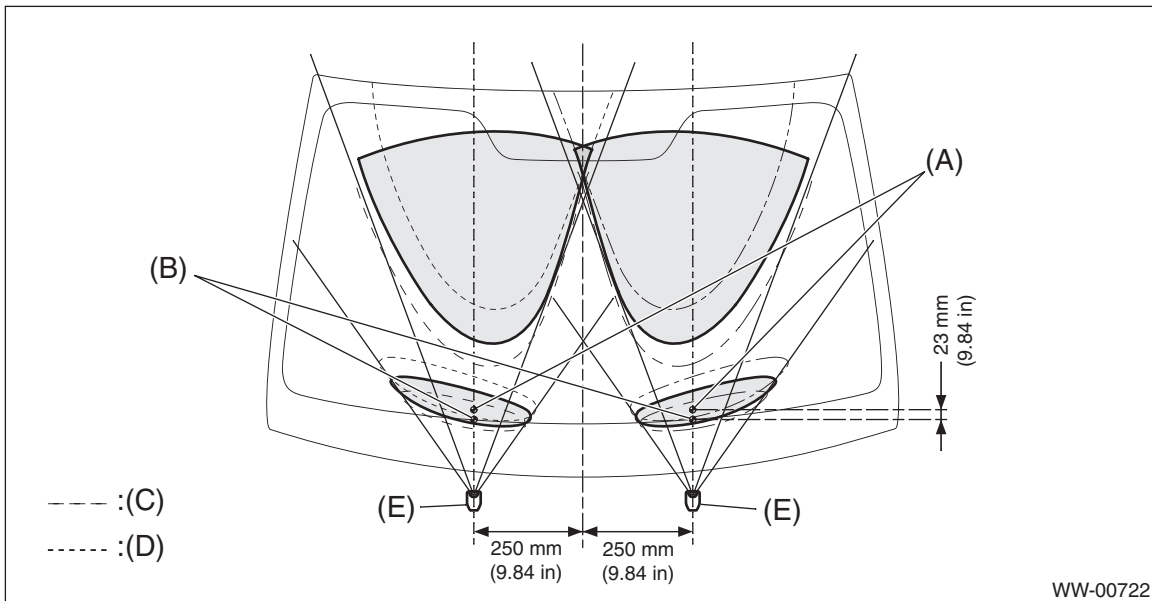

- (A) Hitting point center
- (B) Lower-side spray position center
- (C) Washer fluid elevation angle/dispersal angle lower limit
- (D) Washer fluid elevation angle/dispersal angle upper limit
- (E) Upper spray nozzle center of washer nozzle