

### 13.Headlight Assembly

#### A: REMOVAL

##### CAUTION:

**Do not perform work with wet hands.**

- 1) Disconnect the ground cable from battery.
- 2) Remove the clips and remove the air intake duct. (When removing the headlight RH).

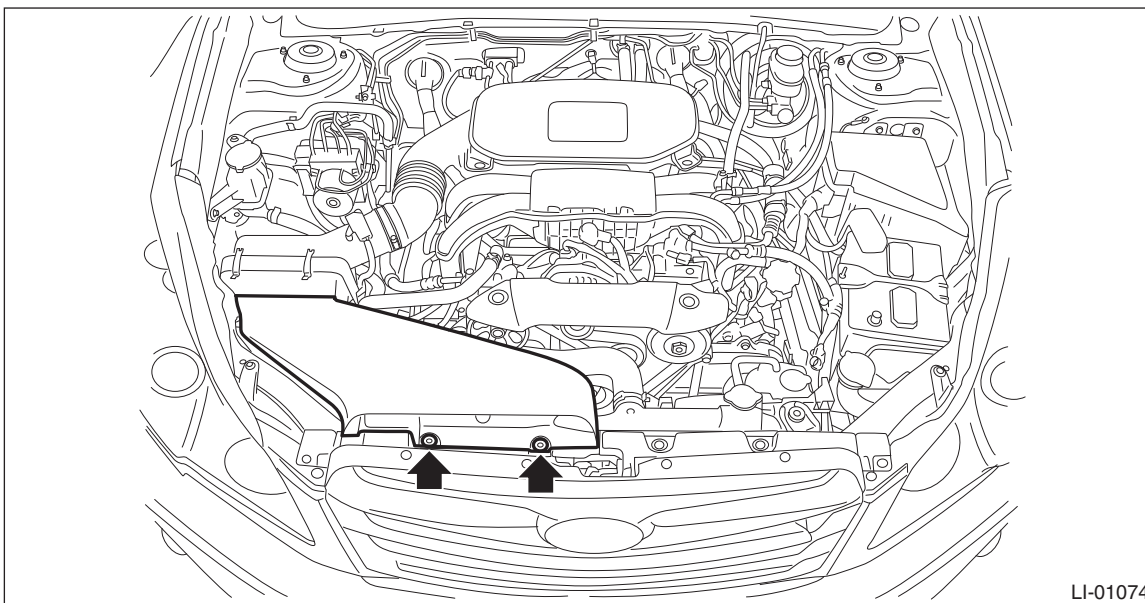

- 3) Remove the front bumper face assembly. <Ref. to EI-39, REMOVAL, Front Bumper.>
- 4) Remove the fender cover assembly UPR.
  - (1) Remove the clip.
  - (2) Release the claws of the fender cover assembly UPR by pulling it forward and remove the fender cover.

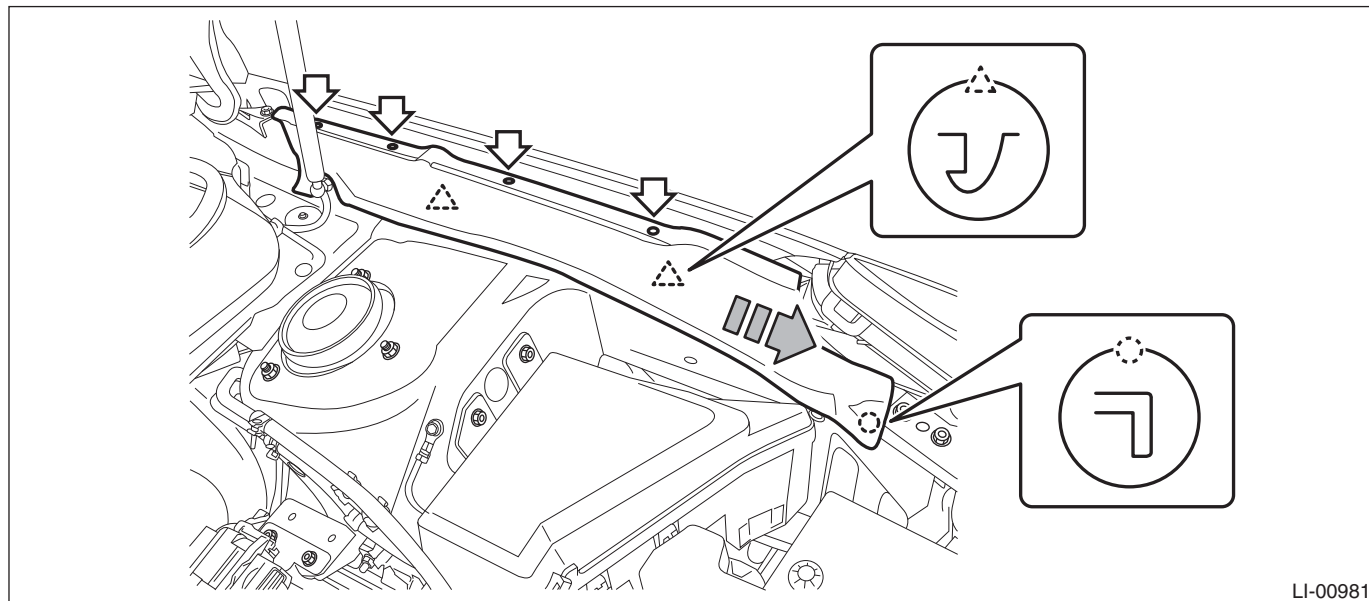

- 5) Remove the headlight assembly.

(1) Remove the bolts and clips, and pull out the headlight assembly to the front of the vehicle.

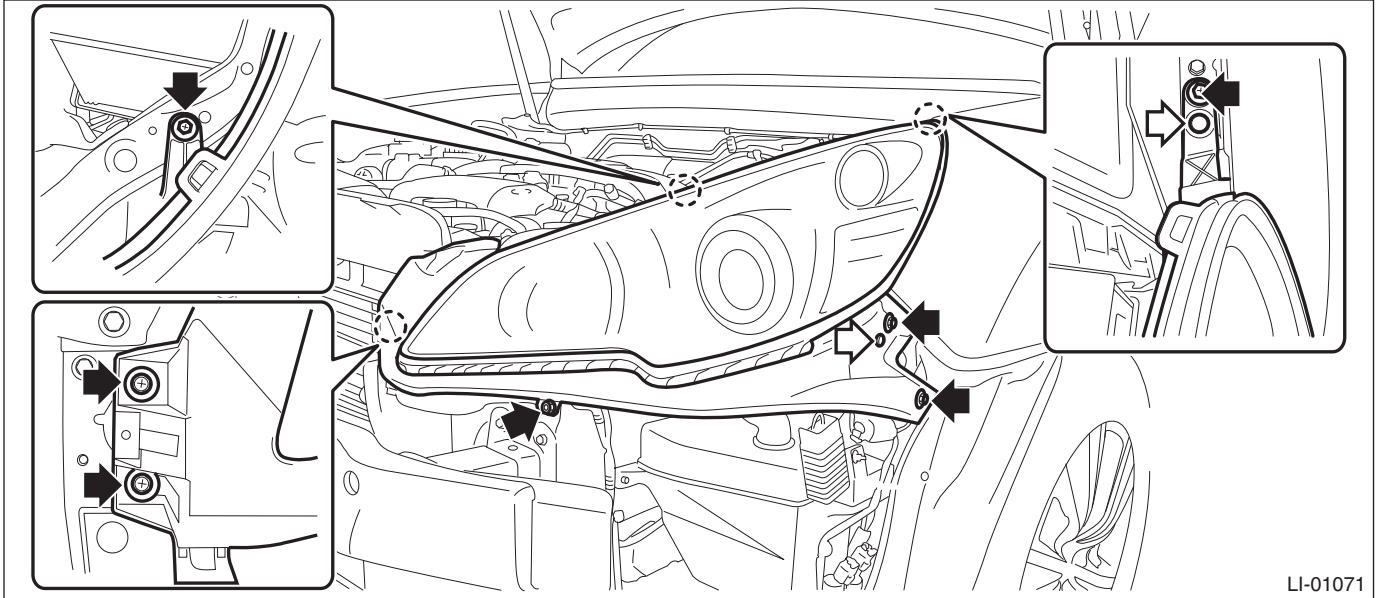

(2) Disconnect the connector and remove the headlight assembly.

- Headlight connector RH

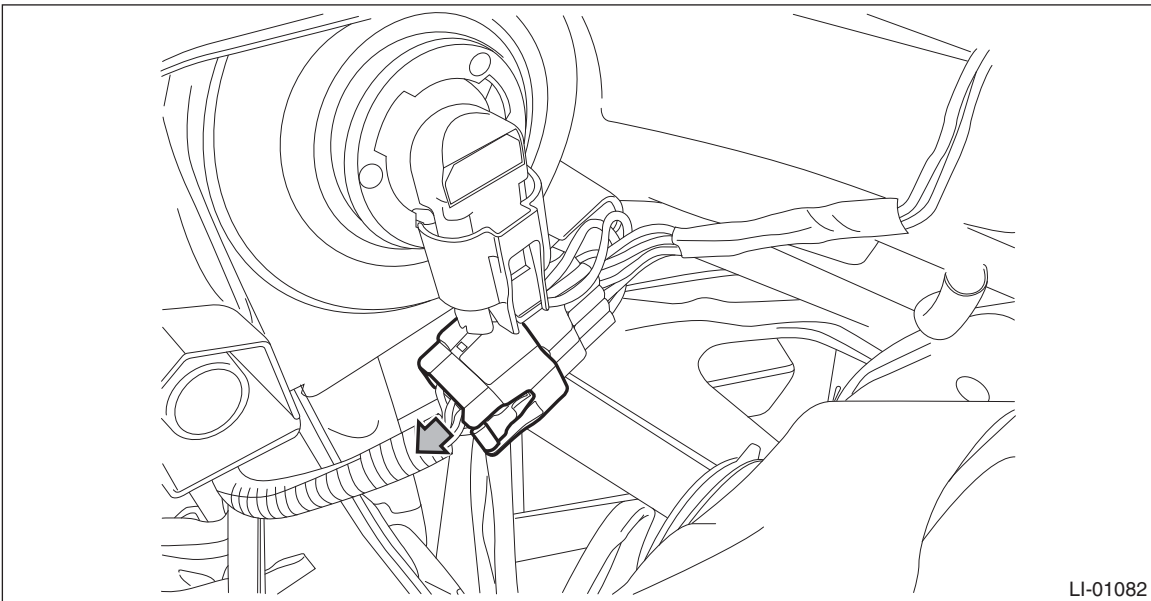

- Headlight connector LH

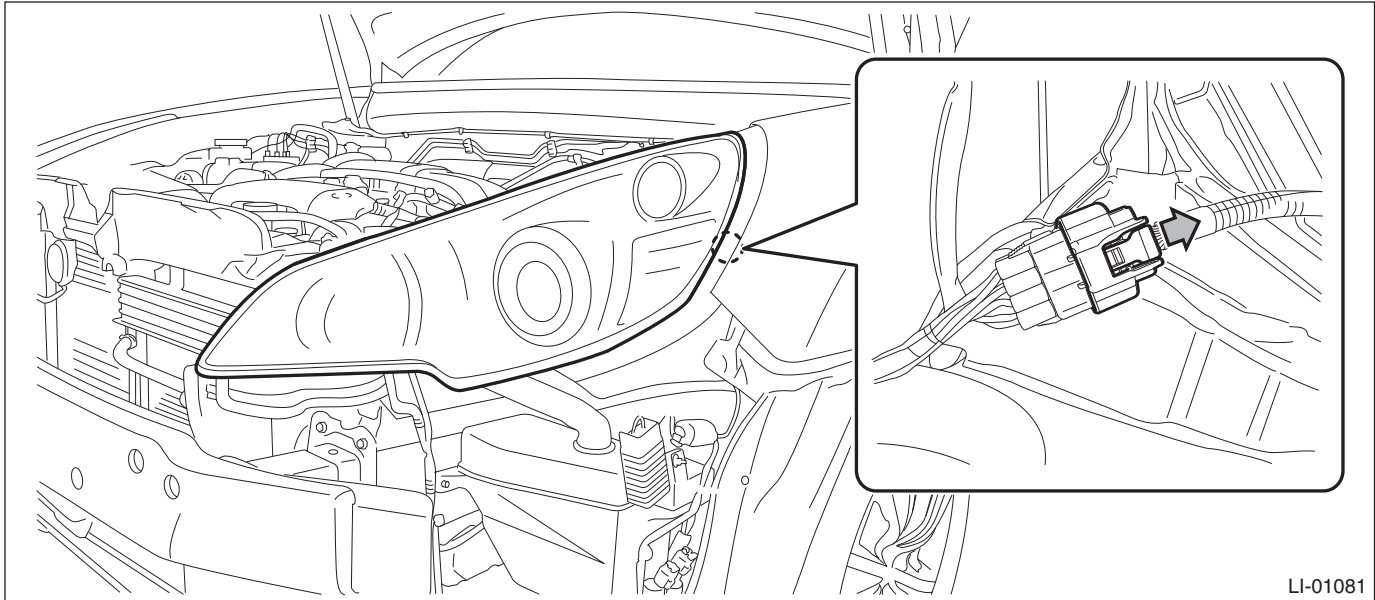

### B: INSTALLATION

Install each part in the reverse order of removal.

#### *Tightening torque:*

**Headlight ASSY: 7.5 N·m (0.76 kgf-m, 5.5 ft-lb)**

### C: ADJUSTMENT

#### 1. HEADLIGHT BEAM ADJUSTMENT

##### **CAUTION:**

**Turn off the light before adjusting the headlight beam level. If it is necessary to inspect the beam level, do not keep the light on for two minutes or more.**

1) Before checking the headlight beam level, be sure of the following:

- the area around the headlight has not sustained any scratches, damage or other type of deformation.
- Vehicle is parked on a level surface.
- The inflation pressure of tires is correct.
- Vehicle's fuel tank is fully filled.

2) For vehicle with a manual leveler, set the headlight beam leveler switch to the "0" position.

3) Bounce the vehicle several times to normalize the suspension.

4) Make certain that someone is seated in the driver's seat.

# Headlight Assembly

LIGHTING SYSTEM

5) Measure the distance between the low beam bulb centers, and the height of the bulb center.

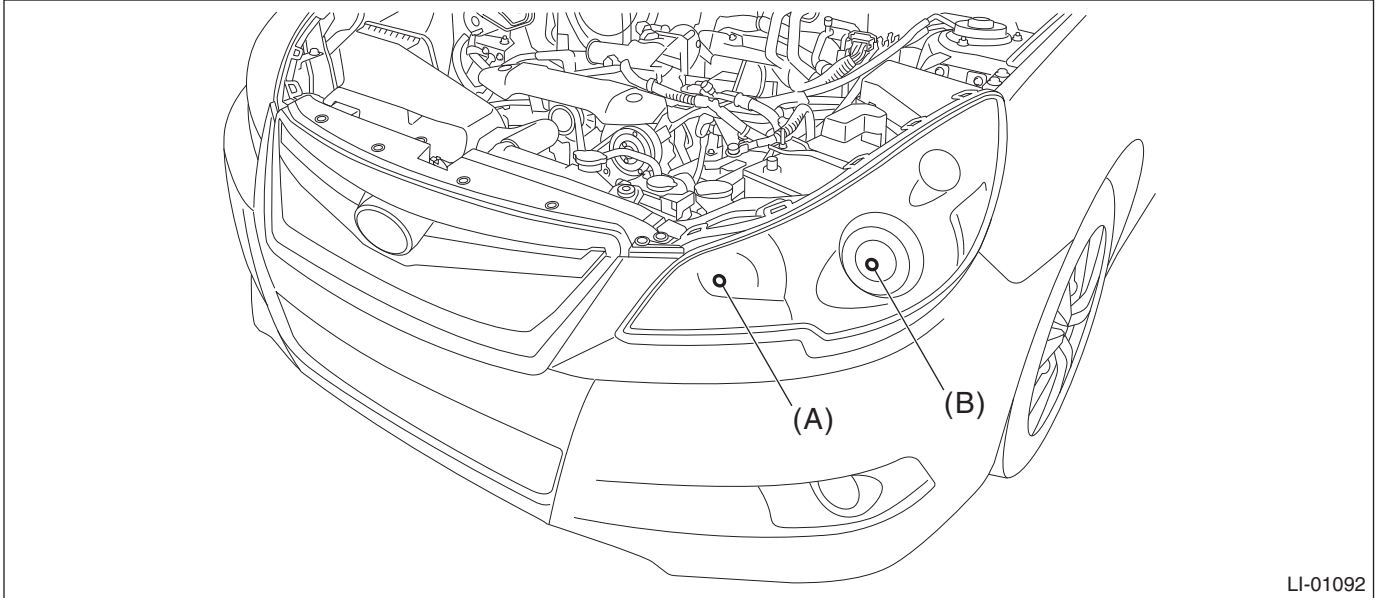

(A) High beam

(B) Low beam

6) Place the vehicle with the front end facing to the measurement panel.

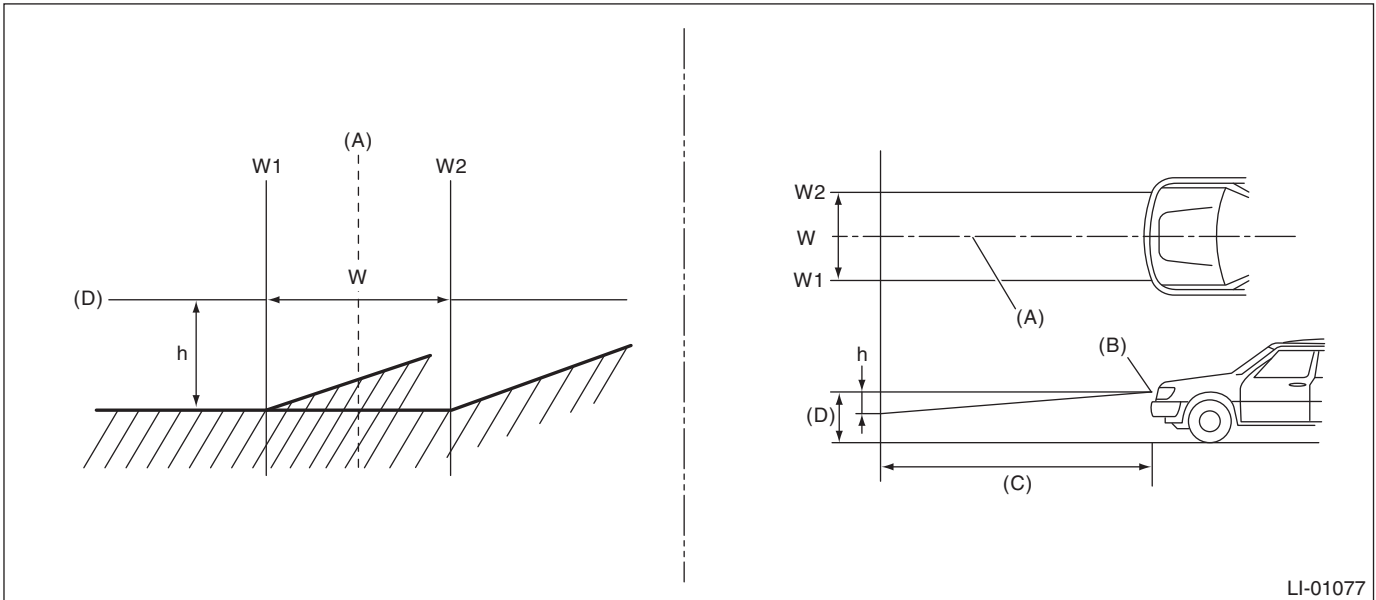

(A) Vehicle center

(C) 3 m (10 ft)

(D) Height of headlight center

(B) Bulb center marking

W mm (in)	h mm (in) at 3 m (10 ft)
1,404 (55.28)	21 (0.83)

# Headlight Assembly

## LIGHTING SYSTEM

---

7) Adjust the headlight low beam by turning the aiming screw.

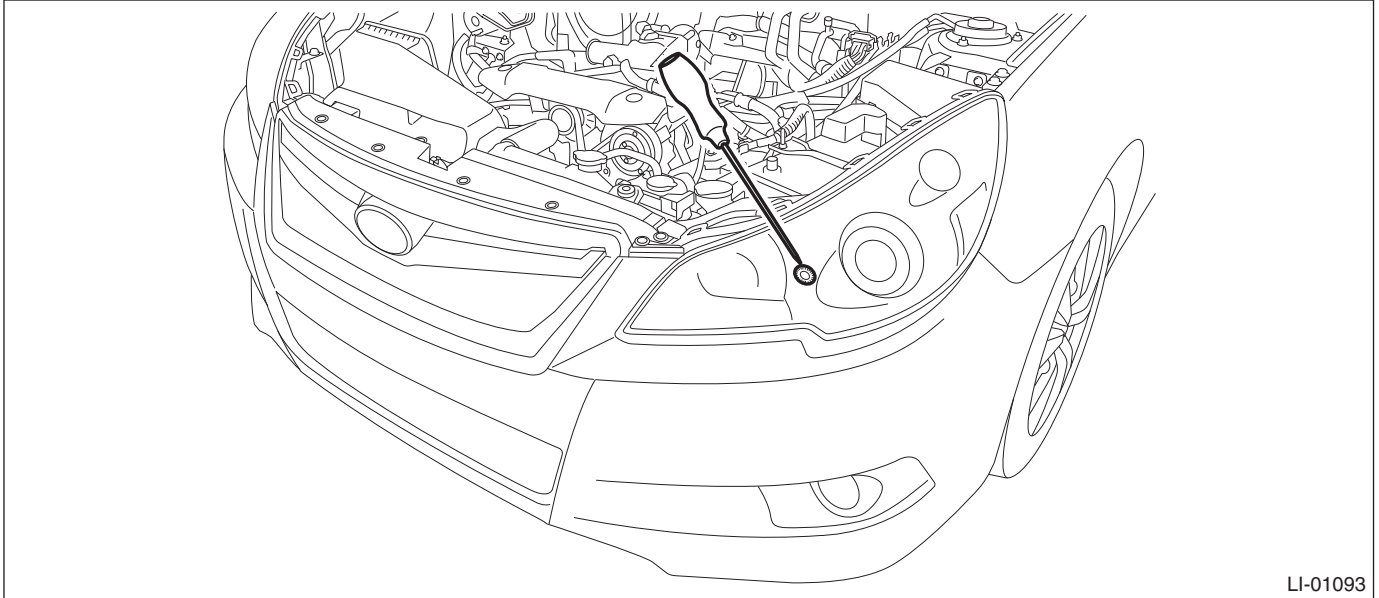

LI-01093

### NOTE:

When using a tester, follow the instructions of the tester manual.