

Turn Signal Light and Hazard Light System

LIGHTING SYSTEM

7. Turn Signal Light and Hazard Light System

A: WIRING DIAGRAM

Refer to “Turn Signal and Hazard Light System” in the WIRING DIAGRAM. <Ref. to WI-221, WIRING DIAGRAM, Turn Signal Light and Hazard Light System.>

B: INSPECTION

1. CHECK TURN SIGNAL SWITCH

Measure the resistance between turn signal switch terminals. <Ref. to LI-23, INSPECTION, Combination Switch (Light).>

2. CHECK HAZARD SWITCH

1) Remove the A/C control panel.

- Manual A/C model:<Ref. to AC-42, MANUAL A/C MODEL, REMOVAL, Control Panel.>
- Auto A/C model:<Ref. to AC-39, AUTO A/C MODEL, REMOVAL, Control Panel.>

2) Measure the resistance between hazard switch terminals.

Preparation tool: Circuit tester

- AUTO A/C MODEL

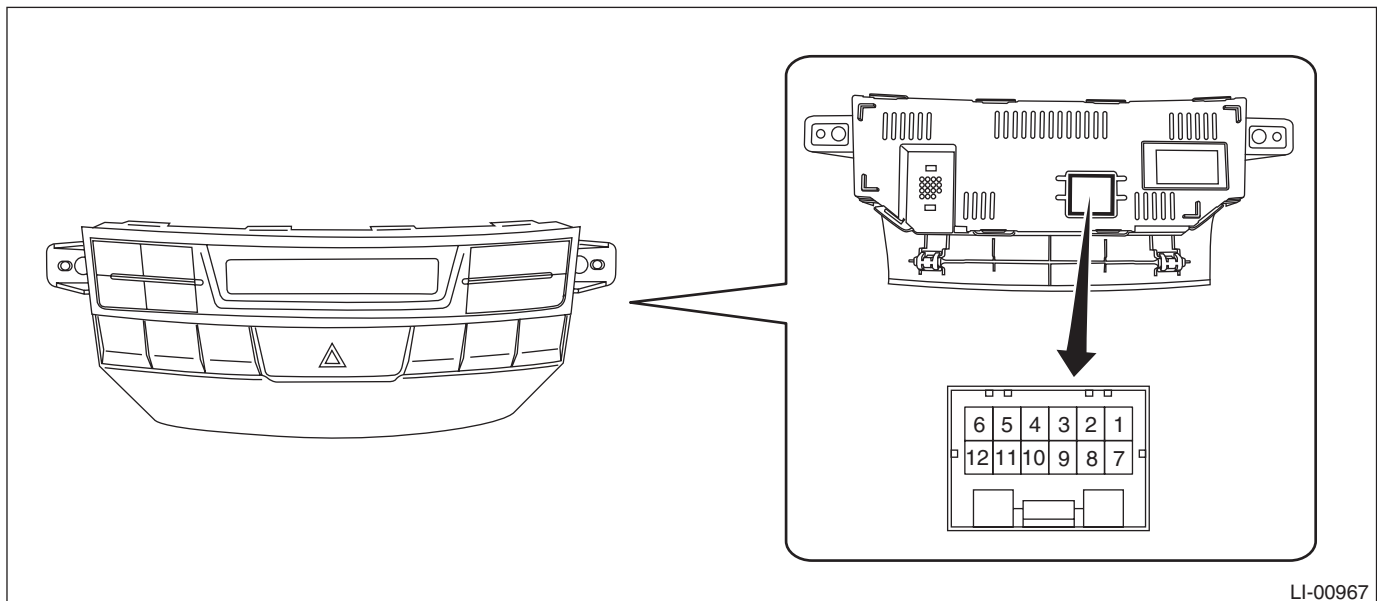

Terminal No.	Inspection conditions	Specification
1 — 2	Switch OFF	1 MΩ or more
	Switch ON	Less than 1 Ω

- MANUAL A/C MODEL

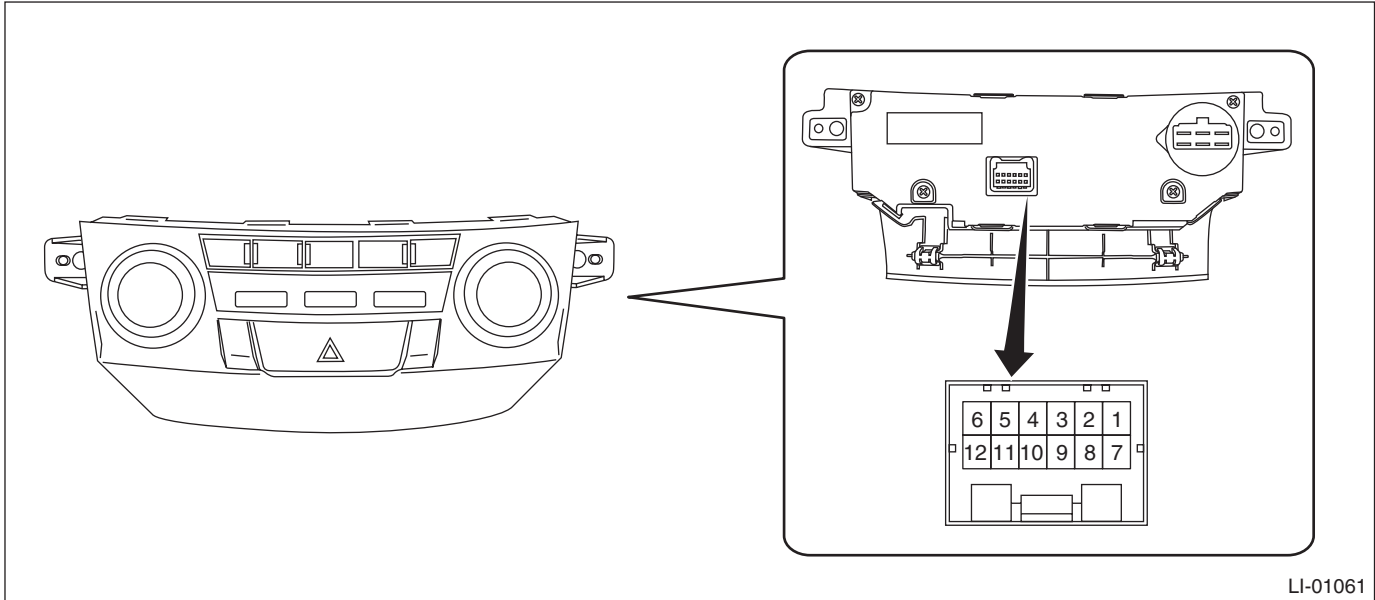

Terminal No.	Inspection conditions	Specification
4 — 5	Switch OFF	1 MΩ or more
	Switch ON	Less than 1 Ω

3) Replace the A/C control panel if the inspection result is not within the standard value.

3. CHECK TURN SIGNAL AND HAZARD MODULE

1) Measure the voltage between turn signal & hazard module connector and chassis ground.

Preparation tool: Circuit tester
Connector

Terminal No.	Input/Output	Inspection conditions	Standard
6 ↔ Chassis ground	Input	Turn signal switch (Right) OFF → ON	9 V or more → less than 1 V
5 ↔ Chassis ground	Input	Turn signal switch (Left) OFF → ON	9 V or more → less than 1 V
8 ↔ Chassis ground	Input	Hazard switch OFF → ON	9 V or more → less than 1 V
2 ↔ Chassis ground	Output	Turn signal switch (Right) OFF → ON	Repeat less than 1 V → less than 1 V ↔ 9 V or more at 60 to 120 times per minute.
3 ↔ Chassis ground	Output	Turn signal switch (Left) OFF → ON	Repeat less than 1 V → less than 1 V ↔ 9 V or more at 60 to 120 times per minute.
2 ↔ Chassis ground	Output	Hazard switch OFF → ON	Repeat less than 1 V → less than 1 V ↔ 9 V or more at 60 to 120 times per minute.
3 ↔ Chassis ground	Output	Hazard switch OFF → ON	Repeat less than 1 V → less than 1 V ↔ 9 V or more at 60 to 120 times per minute.

2) Replace the turn signal and hazard module if the inspection result is not within the standard value.

Turn Signal Light and Hazard Light System

LIGHTING SYSTEM

C: NOTE

For operation procedures of each component of the turn signal and hazard light system, refer to the respective sections.

- Combination switch (light):<Ref. to LI-19, Combination Switch (Light).>
- Front turn signal light bulb:<Ref. to LI-35, Front Turn Signal Light Bulb.>
- Side turn signal light assembly:<Ref. to LI-44, Side Turn Signal Light Assembly.>
- Rear combination light assembly:<Ref. to LI-45, Rear Combination Light Assembly.>
- Rear turn signal light bulb:<Ref. to LI-51, Rear Turn Signal Light Bulb.>