

23.In-Vehicle Sensor (Auto A/C Model)

A: REMOVAL

CAUTION:

Be careful not to damage the sensors and interior trims when removing.

- 1) Disconnect the ground cable from battery.
- 2) Remove the clips, and remove the instrument panel side cover LH.

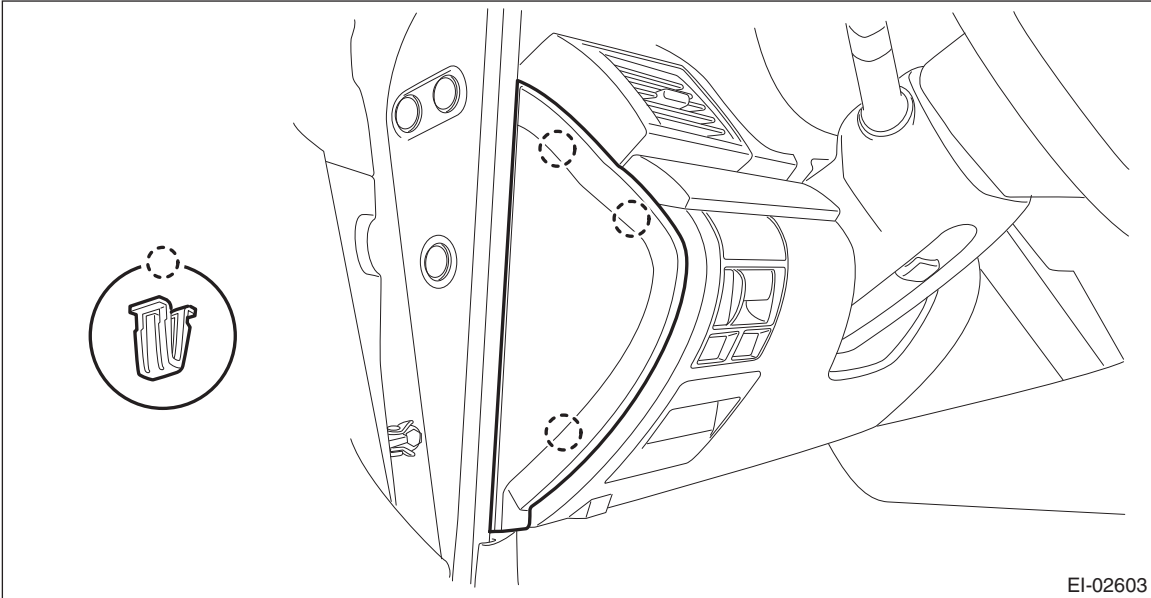

- 3) Remove the instrument panel lower cover.
 - (1) Remove the clip.
 - (2) Remove the data link connector, and remove the instrument panel lower cover under.

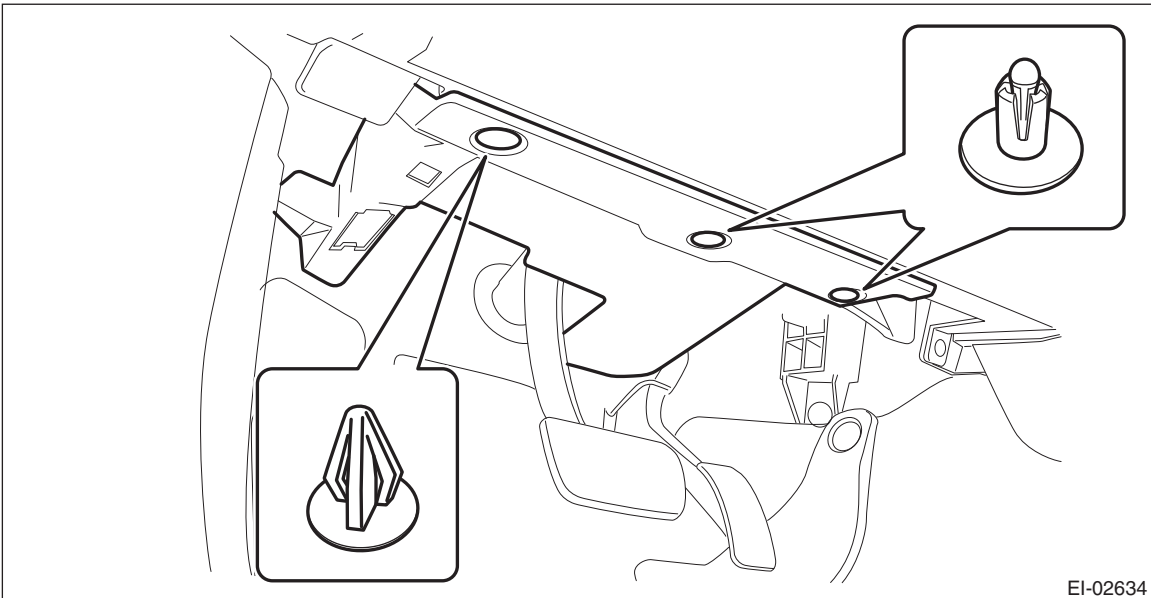

In-Vehicle Sensor (Auto A/C Model)

HVAC SYSTEM (HEATER, VENTILATOR AND A/C)

- (3) Remove the screws and clips and release the claws, and remove the instrument panel lower cover while disconnecting the harness connectors.

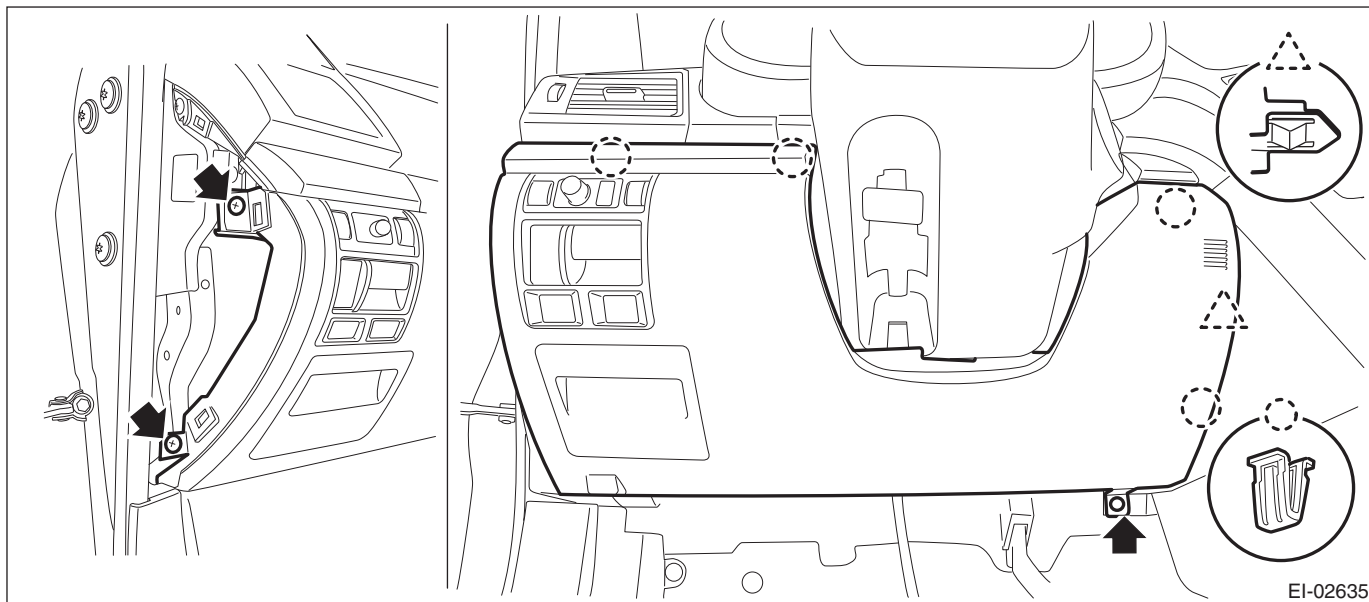

- 4) Remove the screw and remove the in-vehicle sensor from the instrument lower cover.

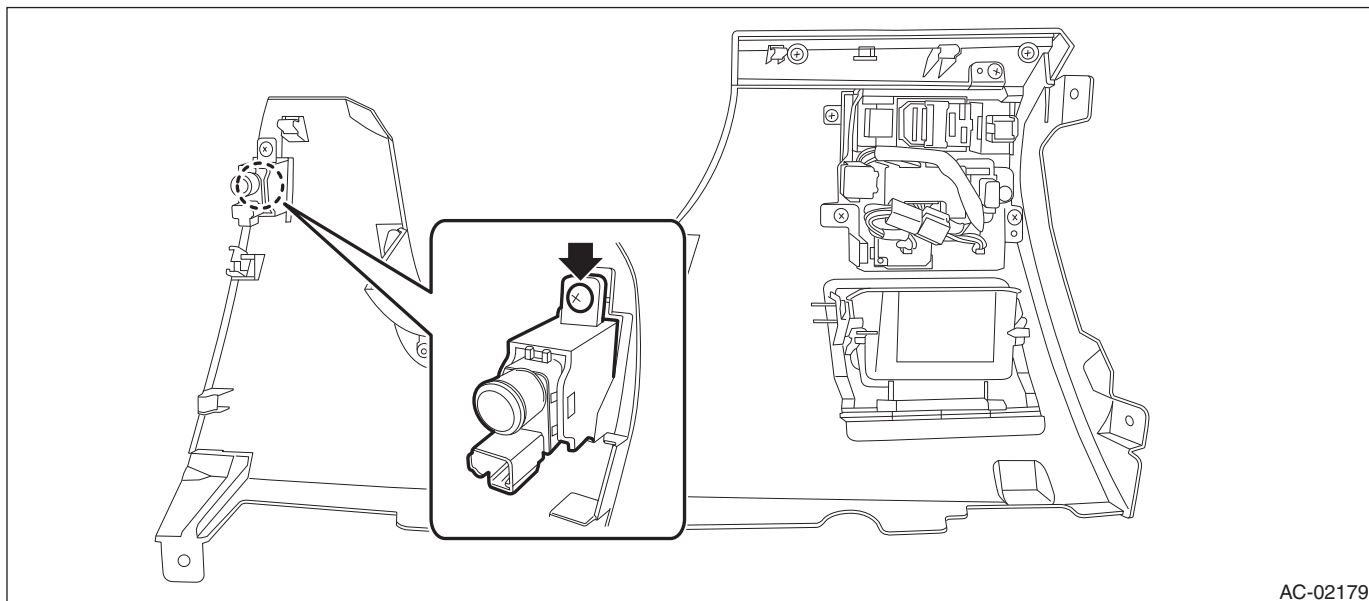

B: INSTALLATION

Install each part in the reverse order of removal.

C: INSPECTION

- 1) Perform a diagnosis code (DTC) check by connecting the Subaru Select Monitor.
- 2) If any diagnosis code (DTC) is displayed, consult the List of Diagnostic Trouble Code (DTC) in HVAC SYSTEM (AUTO A/C) (DIAGNOSTICS). <Ref. to AC(diag)-31, LIST, List of Diagnostic Trouble Code (DTC).>