

## 4. Tire Pressure Monitoring System

### A: REMOVAL

#### 1. TRANSMITTER (TIRE INFLATION PRESSURE SENSOR)

- 1) Remove the wheels from the vehicle. <Ref. to WT-4, REMOVAL, Tire and Wheel.>
- 2) Remove the tire from the wheel.

#### CAUTION:

**When removing the tire from the wheel, use the tire changer.**

- 3) Remove the screw, and remove the transmitter from the valve stem.

#### NOTE:

When reusing the transmitter, replace the valve and screw with new parts.

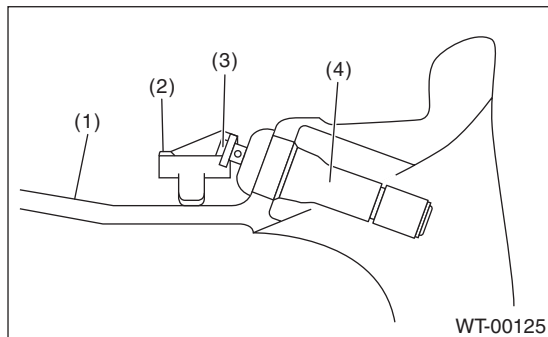

- (1) Wheel
- (2) Transmitter
- (3) Screw
- (4) Valve

- 4) Remove the valve from the wheel.

#### 2. TIRE PRESSURE MONITORING CONTROL MODULE

- 1) Remove the driver's seat. <Ref. to SE-10, REMOVAL, Front Seat.>
- 2) Turn over the floor mat.
- 3) Remove the connector, and remove the tire inflation pressure monitor control module.

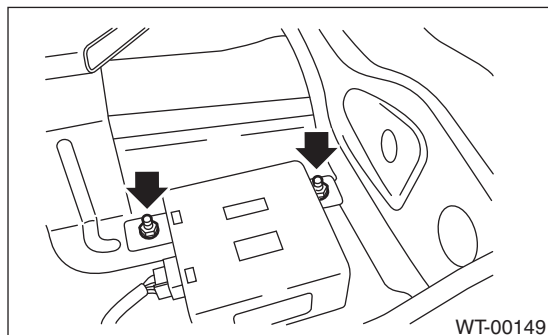

### B: INSTALLATION

#### 1. TRANSMITTER (TIRE INFLATION PRESSURE SENSOR)

#### CAUTION:

**When installing, use new transmitter assembly or the transmitter equipped with new valve and screw.**

- 1) When reusing the transmitter, replace the valve and screw with new parts and install.

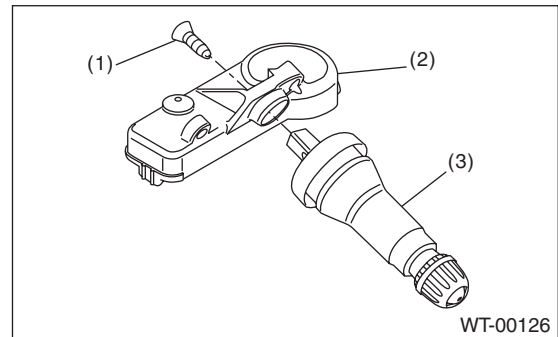

- (1) Screw
- (2) Transmitter
- (3) Valve

#### Tightening torque:

**1.4 N·m (0.14 kgf-m, 1 ft-lb)**

- 2) Align the transmitter with the valve hole, and install.

#### NOTE:

When using the jig which is used by hitching the root of the valve cap and pulling it out, use different short cap.

- 3) Install the tire to the wheel.

#### CAUTION:

- When installing the tire to the wheel, use the tire changer.

# Tire Pressure Monitoring System

## WHEEL AND TIRE SYSTEM

- Set the tire changer boom to the position shown in the figure so as not to damage the transmitter.

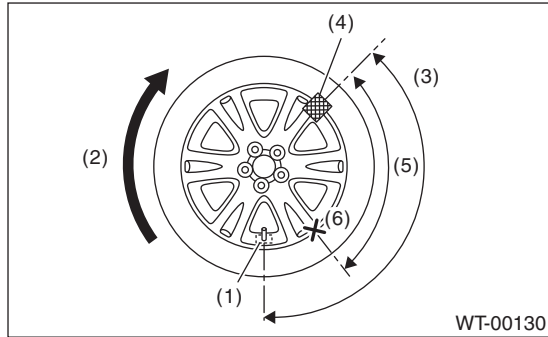

- (1) Transmitter
- (2) Direction of the turn table rotation
- (3) 135°
- (4) Tire changer boom
- (5) 90°
- (6) Starting point where bead is inserted into the rim

4) Install the wheels to the vehicle. <Ref. to WT-4, INSTALLATION, Tire and Wheel.>

5) Register the transmitter ID to the tire inflation pressure monitor control module. <Ref. to TPM(diag)-14, Register Transmitter (ID).>

## 2. TIRE PRESSURE MONITORING CONTROL MODULE

Install in the reverse order of removal.

### *Tightening torque:*

**8 N·m (0.8 kgf-m, 5.9 ft-lb)**

## C: ADJUSTMENT

If the transmitter is replaced, re-register the transmitter ID. <Ref. to TPM(diag)-14, Register Transmitter (ID).>