

7. Front Lateral Link

A: REMOVAL

- 1) Lift up the vehicle, and then remove the rear wheels.
- 2) Remove the rear trailing link. <Ref. to RS-10, REMOVAL, Rear Trailing Link.>
- 3) Remove the snap pin and nut.

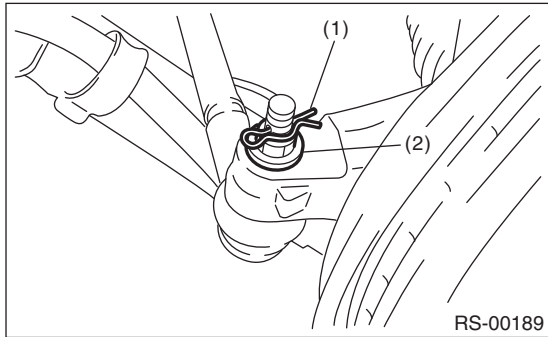

- (1) Snap pin
(2) Nut

- 4) Using a puller, remove the ball joint.

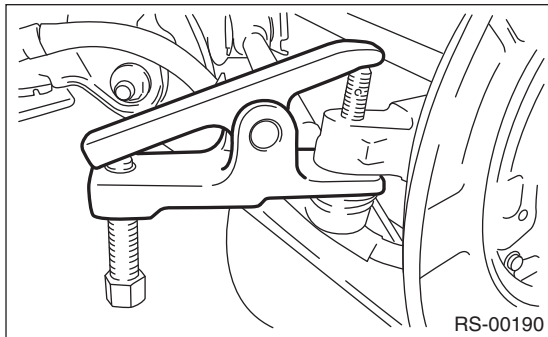

- 5) Place an alignment mark on the front lateral link adjusting bolt and rear sub frame.
- 6) Remove the adjusting bolt, and remove the front lateral link.

CAUTION:

When removing the adjusting bolt, make sure to fix the bolt head in place, and loosen the nut.

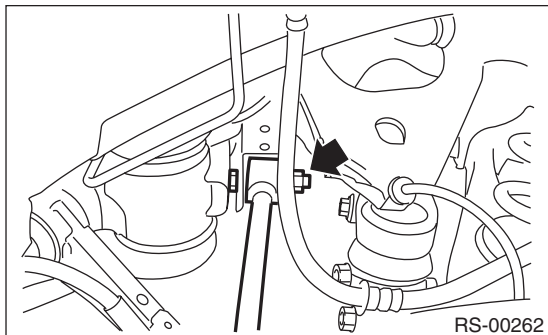

B: INSTALLATION

CAUTION:

- Be sure to use a new self-locking nut.
- Always tighten the bushing in the state where the vehicle is at curb weight and the wheels are in full contact with the ground.

- 1) Install in the reverse order of removal.

Tightening torque:

Front lateral link to Sub frame
120 N·m (12.2 kgf-m, 88.5 ft-lb)

Front lateral link to Rear axle housing
60 N·m (6.1 kgf-m, 44.3 ft-lb)

- 2) Inspect the wheel alignment and adjust if necessary.

C: DISASSEMBLY

Using the ST A and ST B, press the bushing out.

ST A 20099AE000 INSTALLER & REMOVER

ST B 20099AE000 INSTALLER & REMOVER

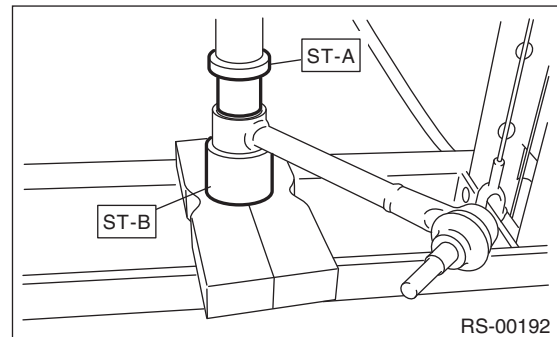

D: ASSEMBLY

Using the ST A and ST B, press-fit the bushing.

ST A 20099AE000 INSTALLER & REMOVER

ST B 20099AE000 INSTALLER & REMOVER

CAUTION:

Press-fit the bushing straight.

E: INSPECTION

- 1) Visually check the front lateral link for damage and deformation.
- 2) Visually check the bushing for abnormal cracks, damages or fatigue.