

5. Upper Arm

A: REMOVAL

1) Remove the rear ABS wheel speed sensor from the rear axle.

CAUTION:

- Be careful not to damage the sensor.
- Do not apply excessive force to the sensor harness.

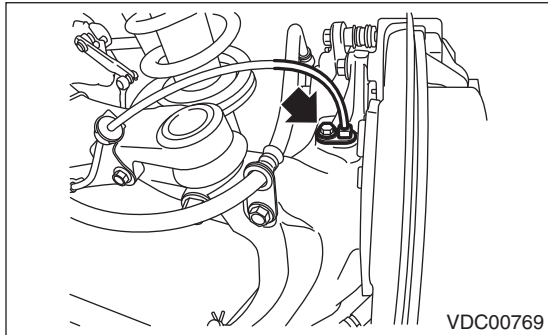

2) Remove the rear ABS wheel speed sensor bracket from the upper arm.

NOTE:

Leave the sensor harness clamp on the vehicle side.

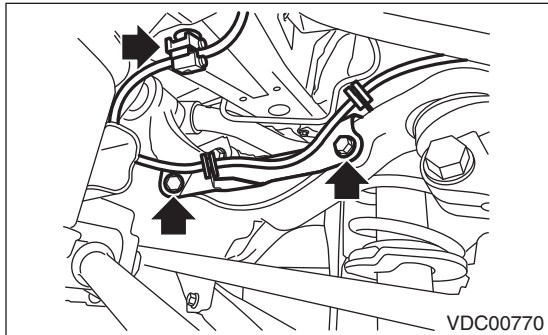

3) Remove the rear sub frame. <Ref. to RS-17, REMOVAL, Rear Sub Frame.>

4) Remove the bolts, then remove the upper arm.

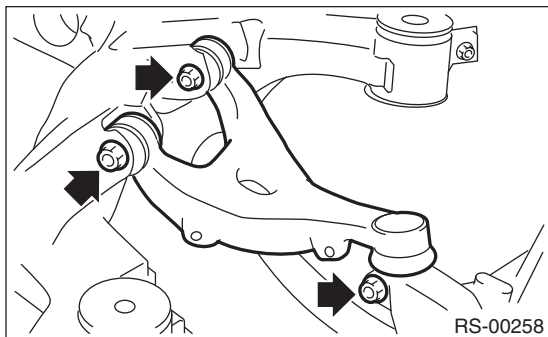

B: INSTALLATION

CAUTION:

- Use a new self-locking nut.
- Always tighten the bushing at the arm position; in the state where the vehicle is at curb weight and the wheels are in full contact with the ground.

1) Install in the reverse order of removal.

2) Inspect the wheel alignment and adjust if necessary.

Tightening torque:

Upper arm to Rear sub frame

80 N·m (8.2 kgf-m, 59 ft-lb)

Upper arm to Rear housing

80 N·m (8.2 kgf-m, 59 ft-lb)

Rear ABS wheel speed sensor bracket

7.5 N·m (0.76 kgf-m, 5.5 ft-lb)

C: INSPECTION

1) Visually check the upper arm for damage and deformation.

2) Visually check the bushing for abnormal cracks, damages or fatigue.