

19.Shifter Fork and Rod

A: REMOVAL

- 1) Remove the manual transmission assembly from the vehicle. <Ref. to 6MT-24, REMOVAL, Manual Transmission Assembly.>
- 2) Remove the back-up light switch neutral position switch. <Ref. to 6MT-36, REMOVAL, Switches and Harness.>
- 3) Remove the transfer case together with the extension case assembly. <Ref. to 6MT-39, REMOVAL, Transfer Case and Extension Case Assembly.>
- 4) Remove the transmission case. <Ref. to 6MT-55, REMOVAL, Transmission Case.>
- 5) Remove the drive pinion shaft assembly. <Ref. to 6MT-64, REMOVAL, Drive Pinion Shaft Assembly.>
- 6) Remove the main shaft assembly for single-range. <Ref. to 6MT-58, REMOVAL, Main Shaft Assembly for Single-Range.>
- 7) Remove the front differential assembly. <Ref. to 6MT-73, REMOVAL, Front Differential Assembly.>
- 8) Remove the check ball plugs, gasket, check ball springs and check balls.

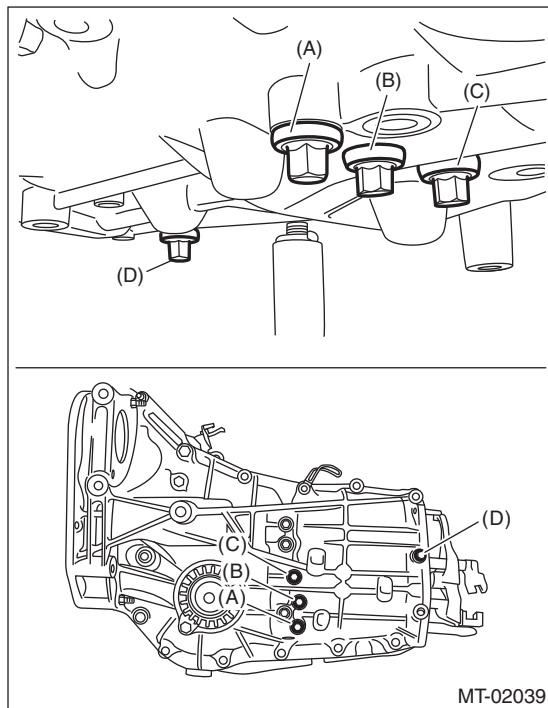

- (A) 1st-2nd
- (B) 3rd-4th
- (C) 5th-6th
- (D) Rev.

- 9) Drive out the spring pins on the 5th-6th shifter fork and reverse shifter fork by tapping with the ST, and remove the 5th-6th shifter fork, reverse shifter fork, 5th-6th fork rod and reverse fork rod.

NOTE:

Before driving out the spring pin on the reverse shifter fork, position the gear in the reverse position. If the gear is in the neutral position, the spring pin cannot be removed due to small clearance with the transmission case.

ST 398791700 SPRING PIN REMOVER 2

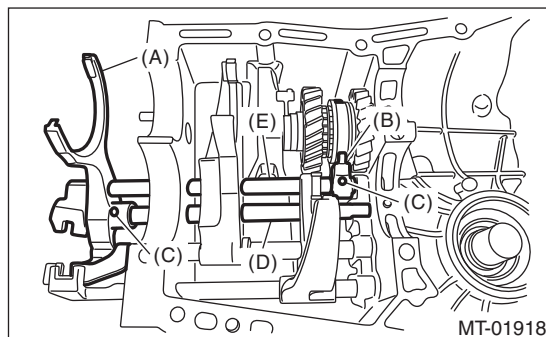

- (A) 5th-6th shifter fork
- (B) Reverse shifter fork
- (C) Spring pin
- (D) 5th-6th fork rod
- (E) Reverse fork rod

- 10) Drive out the spring pin by tapping with the ST, and remove the 3rd-4th shifter fork and fork rod.

NOTE:

When removing the rod, keep other rods in neutral.

ST 398791700 SPRING PIN REMOVER 2

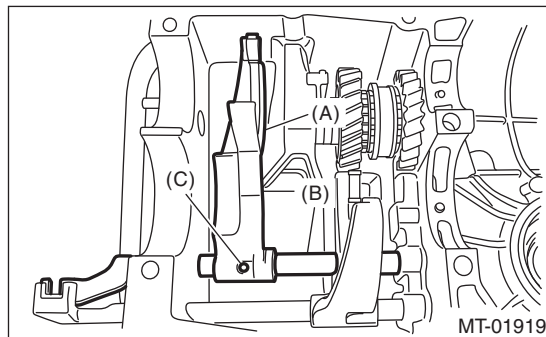

- (A) 3rd-4th shifter fork
- (B) 3rd-4th fork rod
- (C) Spring pin

Shifter Fork and Rod

MANUAL TRANSMISSION AND DIFFERENTIAL

11) Drive out the spring pin by tapping with the ST, and remove the 1st-2nd shifter fork and fork rod.

ST 398791700 SPRING PIN REMOVER 2

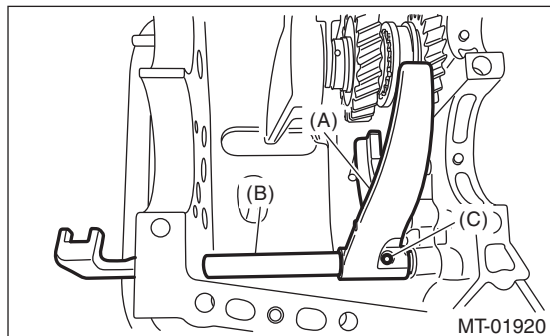

- (A) 1st-2nd shifter fork
- (B) 1st-2nd fork rod
- (C) Spring pin

B: INSTALLATION

1) Install the 1st-2nd fork rod into 1st-2nd shifter fork through the hole on the rear of transmission case.

2) Align the holes in the rod and the fork, and drive the spring pin into these holes using the ST to fix.

NOTE:

Use new spring pin.

ST 398791700 SPRING PIN REMOVER 2

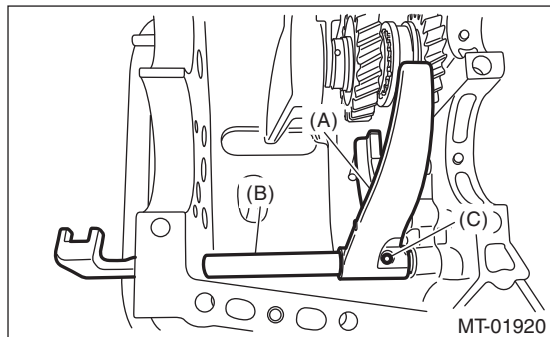

- (A) 1st-2nd shifter fork
- (B) 1st-2nd fork rod
- (C) Spring pin

3) Attach the 3rd-4th fork rod into 3rd-4th shifter fork through the hole on the rear of transmission case.

4) Align the holes in the rod and the fork, and drive the spring pin into these holes using the ST to fix.

NOTE:

- Use new spring pin.
- Set other rods to neutral.

- Check that the positions of interlock plunger is correct.

ST 398791700 SPRING PIN REMOVER 2

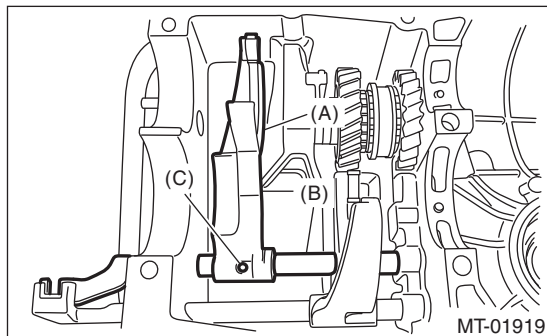

- (A) 3rd-4th shifter fork
- (B) 3rd-4th fork rod
- (C) Spring pin

5) Install the 5th-6th fork rod into 5th-6th shifter fork, then insert through the hole on the rear of transmission case. Align the hole of the 5th-6th shifter fork with the hole on the transmission case, then insert the reverse fork rod to install the reverse shifter fork.

6) Align the holes in the rod and the fork, and drive the spring pin into these holes using the ST to fix.

NOTE:

- Use new spring pin.
- Set other rods to neutral.
- Check that the positions of interlock plunger is correct.

ST 398791700 SPRING PIN REMOVER 2

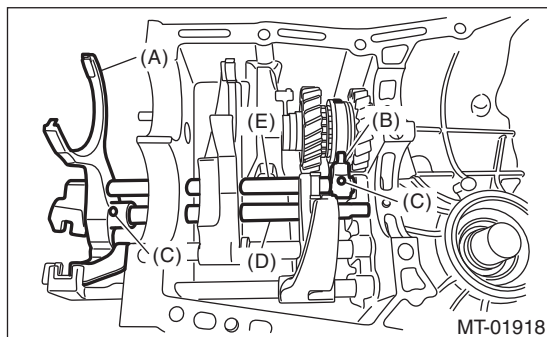

- (A) 5th-6th shifter fork
- (B) Reverse shifter fork
- (C) Spring pin
- (D) 5th-6th fork rod
- (E) Reverse fork rod

7) Install the check ball plugs, gaskets, check ball springs and check balls.

NOTE:

Use a new gasket.

Tightening torque:

20 N·m (2.0 kgf-m, 14.8 ft-lb)

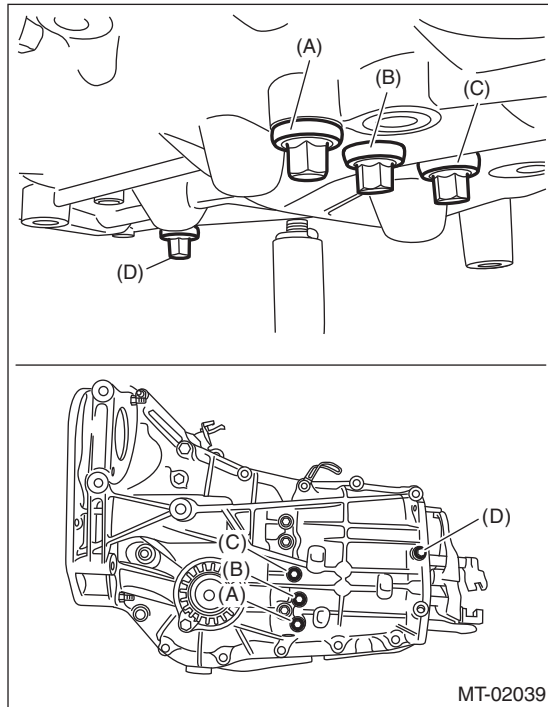

- (A) 1st-2nd
- (B) 3rd-4th
- (C) 5th-6th
- (D) Rev.

8) Install the front differential assembly. <Ref. to 6MT-73, INSTALLATION, Front Differential Assembly.>

9) Install the main shaft assembly for single-range. <Ref. to 6MT-58, INSTALLATION, Main Shaft Assembly for Single-Range.>

10) Install the drive pinion shaft assembly. <Ref. to 6MT-64, INSTALLATION, Drive Pinion Shaft Assembly.>

11) Install the transmission case. <Ref. to 6MT-55, INSTALLATION, Transmission Case.>

12) Install the transfer case together with the extension case assembly. <Ref. to 6MT-39, INSTALLATION, Transfer Case and Extension Case Assembly.>

13) Install the back-up light switch neutral position switch. <Ref. to 6MT-36, INSTALLATION, Switches and Harness.>

14) Install the manual transmission assembly to the vehicle. <Ref. to 6MT-28, INSTALLATION, Manual Transmission Assembly.>

C: INSPECTION

1) Check the fork and rod for damage. Replace it if it is damaged.

2) Gearshift mechanism

Repair or replace the gearshift mechanism if excessively worn, bent or defective in any way.

3) Inspect the clearance between 2nd driven gear and coupling sleeve. If any clearance is not within specifications, replace the shifter fork as required.

Clearance (a):

9.4 — 10.0 mm (0.370 — 0.394 in)

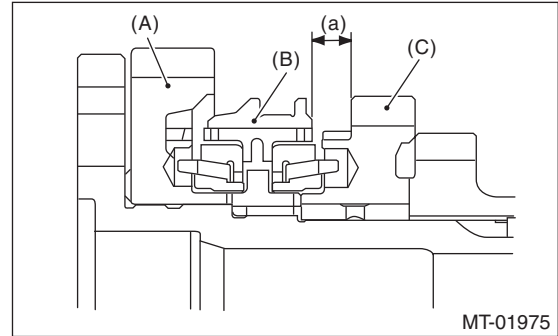

- (A) 1st driven gear
- (B) Coupling sleeve
- (C) 2nd driven gear

1st-2nd shifter fork		
Part number	Mark	Content
32804AA120	1	Approaches 1st gear by 0.2 mm (0.008 in).
32804AA130	No mark	Standard
32804AA140	3	Approaches 2nd gear by 0.2 mm (0.008 in)

Shifter Fork and Rod

MANUAL TRANSMISSION AND DIFFERENTIAL

4) Inspect the clearance between the 3rd, 4th drive gear and the coupling sleeve. If any clearance is not within specifications, replace the shifter fork as required.

Clearance (a):
7.4 mm (0.291 in)

Clearance (b):
9.3 mm (0.366 in)

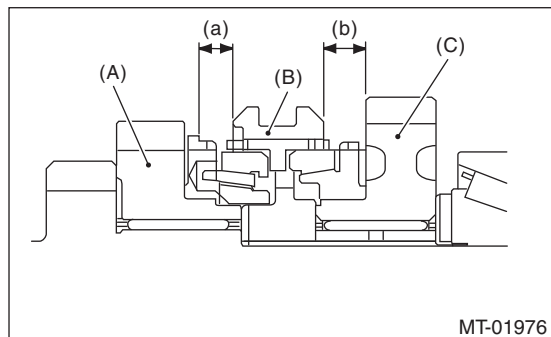

- (A) 3rd drive gear
- (B) Coupling sleeve
- (C) 4th drive gear

3rd-4th shifter fork		
Part number	Mark	Content
32810AA061	1	Approaches 4th gear by 0.2 mm (0.008 in).
32810AA071	No mark	Standard
32810AA101	3	Approaches 3rd gear by 0.2 mm (0.008 in)

5) Inspect the clearance between 5th, 6th drive gear and coupling sleeve. If any clearance is not within specifications, replace the shifter fork as required.

Clearance (a):
8.8 mm (0.346 in)

Clearance (b):
9.4 mm (0.370 in)

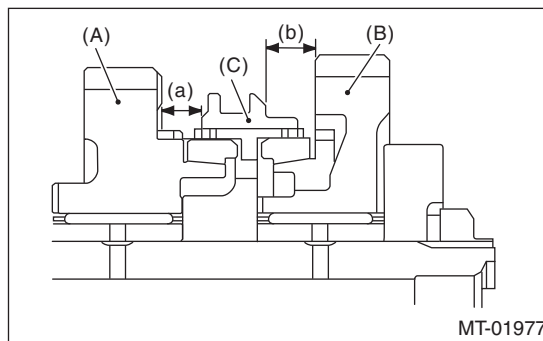

- (A) 5th drive gear
- (B) Coupling sleeve
- (C) 6th drive gear

5th-6th shifter fork		
Part number	Mark	Content
32940AA020	1	Approaches 5th gear by 0.2 mm (0.008 in).
32940AA030	No mark	Standard
32940AA040	2	Approaches 6th gear by 0.2 mm (0.008 in).

6) Inspect the rod end clearances (A) and (B). If any clearance is not within specifications, replace the rod or fork as required.

Clearance (A):
1st-2nd — 3rd-4th
0.1 — 0.9 mm (0.004 — 0.035 in)

Clearance (B):
3rd-4th — 5th-6th
0.2 — 1.0 mm (0.008 — 0.039 in)

