

## 16. Cam Sprocket

### A: REMOVAL

#### NOTE:

When replacing the single part, perform the work with the engine installed to body.

- 1) Remove the V-belts. <Ref. to ME(H6DO)-48, REMOVAL, V-belt.>
- 2) Remove the crank pulley. <Ref. to ME(H6DO)-49, REMOVAL, Crank Pulley.>
- 3) Remove the chain cover. <Ref. to ME(H6DO)-50, REMOVAL, Chain Cover.>
- 4) Remove the timing chain assembly. <Ref. to ME(H6DO)-59, REMOVAL, Timing Chain Assembly.>
- 5) Use the ST to lock the cam sprocket, and remove the cam sprocket bolt.

ST 499977500 CAM SPROCKET WRENCH

- IN side

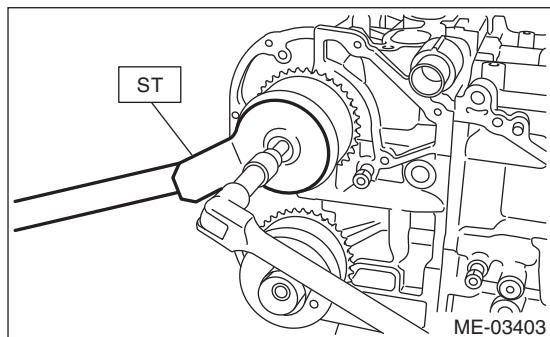

- EX side

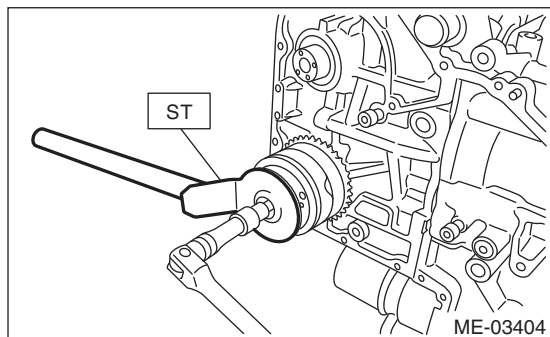

- 6) Remove the cam sprocket.

### B: INSTALLATION

- 1) Remove the cam sprocket.
- 2) Use the ST to lock the cam sprocket, and install the cam sprocket bolt.

#### Tightening torque:

**Tighten to 29.5 N·m (3.0 kgf-m, 21.8 ft-lb) of torque, and then tighten further by 45°.**

ST 499977500 CAM SPROCKET WRENCH

- IN side

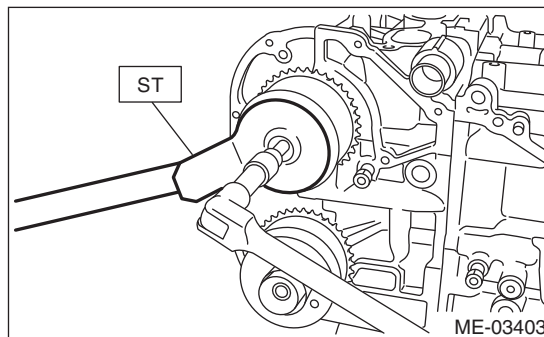

- EX side

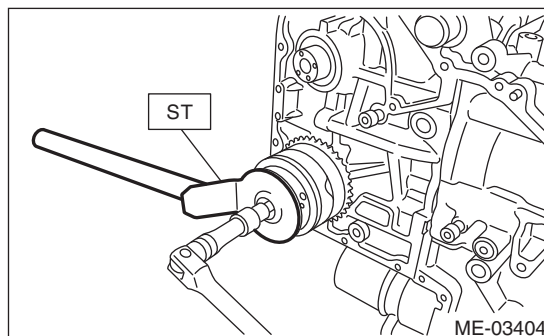

- 3) Install the timing chain assembly. <Ref. to ME(H6DO)-65, INSTALLATION, Timing Chain Assembly.>
- 4) Install the chain cover. <Ref. to ME(H6DO)-53, INSTALLATION, Chain Cover.>
- 5) Install the crank pulley. <Ref. to ME(H6DO)-49, INSTALLATION, Crank Pulley.>
- 6) Install the V-belts. <Ref. to ME(H6DO)-48, INSTALLATION, V-belt.>

### C: INSPECTION

- 1) Check the cam sprocket teeth for abnormal wear and scratches.
- 2) Make sure there is no free play between cam sprocket and key.