

PCV Hose Assembly

EMISSION CONTROL (AUX. EMISSION CONTROL DEVICES)

13.PCV Hose Assembly

A: REMOVAL

CAUTION:

Do not remove except when the hose is broken.

- 1) Remove the air intake boot assembly. <Ref. to IN(H4SO)-8, REMOVAL, Air Intake Boot.>
- 2) Disconnect the vacuum hose (A) from PCV valve, and remove the PCV hose assembly (B) from cylinder block RH and PCV pipe.

NOTE:

Pinch the clamp of the PCV hose assembly by fitting the cut out in the ST with the protrusion on the clamp as shown in the figure, and unlock the clamp.

ST 18353AA000 CLAMP PLIERS

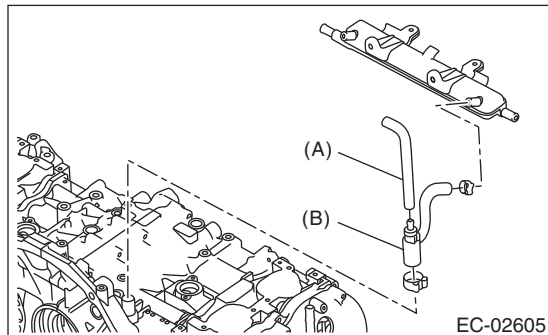
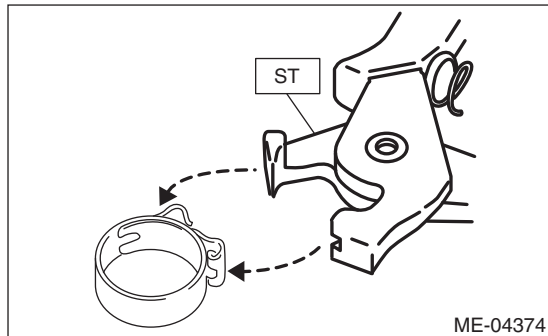

B: INSTALLATION

- 1) Install the PCV hose assembly (B) to the cylinder block RH and PCV pipe, and then connect the vacuum hose (A) to the PCV valve.

NOTE:

Use a new clamp for the PCV hose assembly, fit the cut out in the ST with the protrusion on the clamp as shown in the figure, and lock the clamp.
ST 18353AA000 CLAMP PLIERS

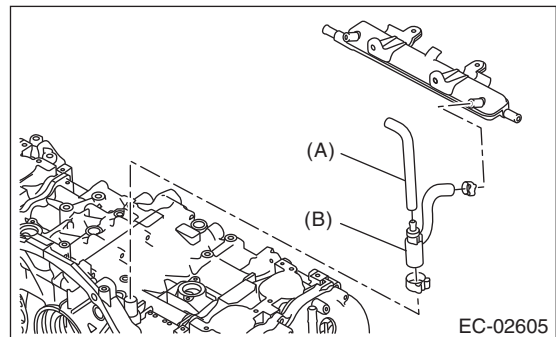
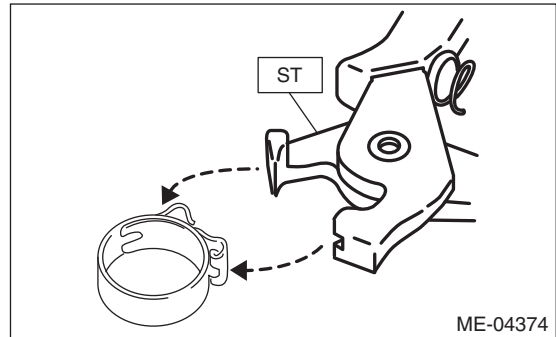

- 2) Install the air intake boot assembly. <Ref. to IN(H4SO)-8, INSTALLATION, Air Intake Boot.>

C: INSPECTION

Check the PCV hose assembly for cracks, damage or looseness.