

7. Under Coat

A: SPECIFICATION

Repair material:

THREE BOND 6115

- 1) The application thickness is 0.4 mm or more when no instruction is indicated.
- 2) Take care that under coat does not become attached to other locations than shown in the figures and the following locations.
 - High-temperature parts related to the exhaust pipe
 - Hoses, tubes, and harness parts
 - Installation surfaces of rear suspension, transmission, subframe, etc.
- 3) Application area

- Side view

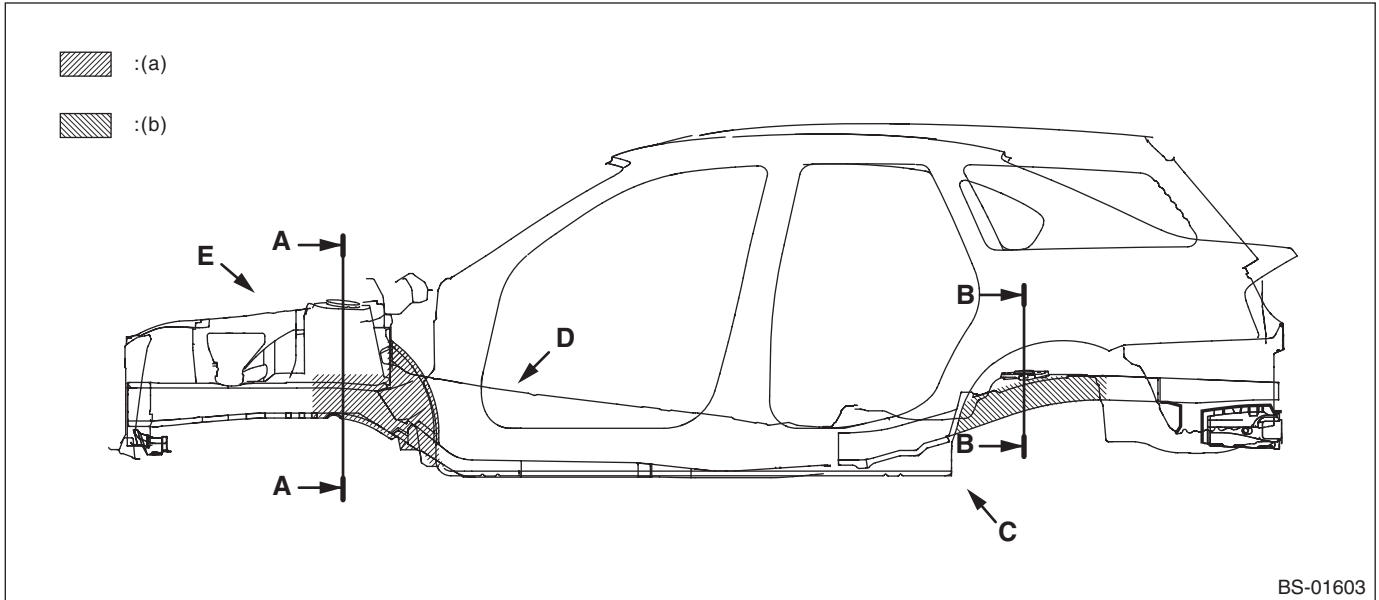

(a) Under coat application locations

(b) Under coat application locations
(Film thickness = 600 μm or more)

Under Coat

BODY STRUCTURE

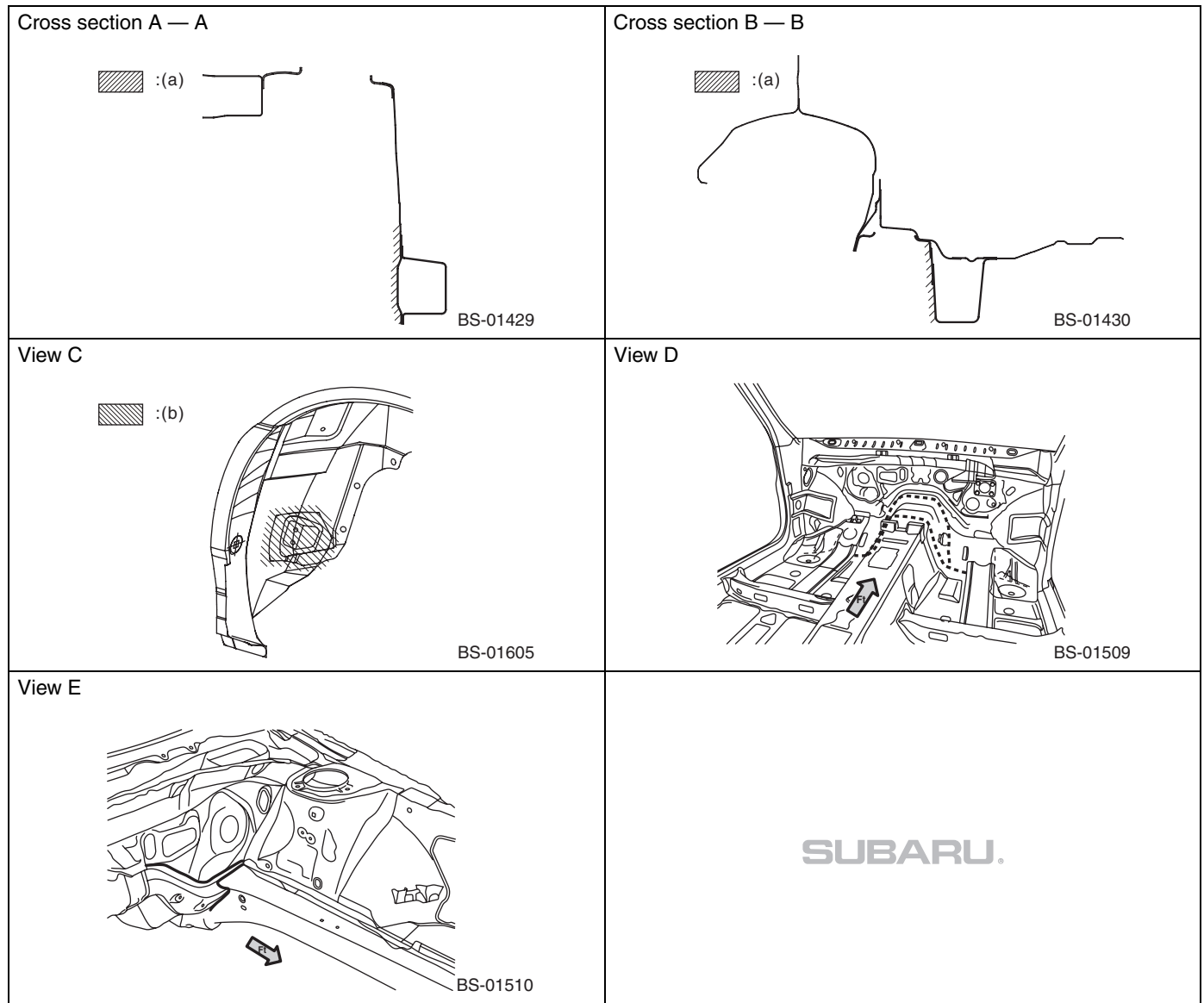

(a) Under coat application locations

(b) Under coat application locations
(Film thickness = 600 μ or more)

- Bottom view/rear view

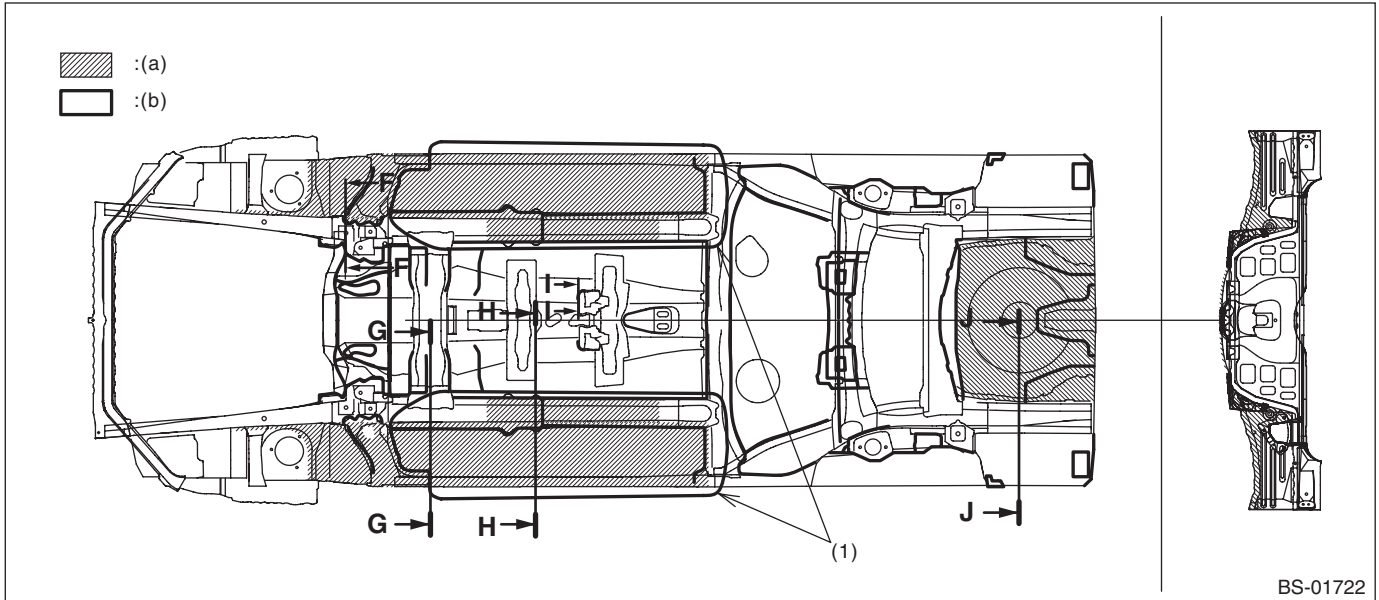

- (1) For models with an under cover, no under coat is required in this area.
- (a), (b) Under coat application locations

Under Coat

BODY STRUCTURE

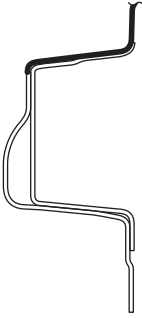
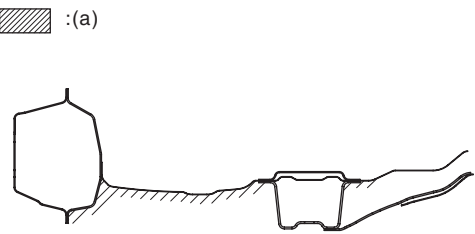
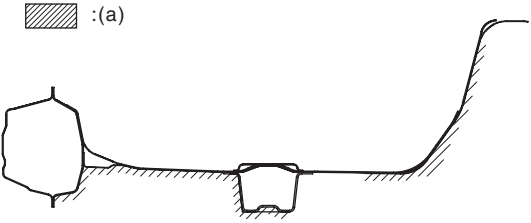
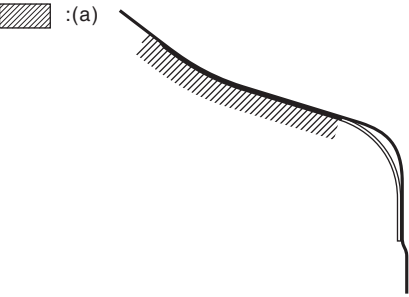
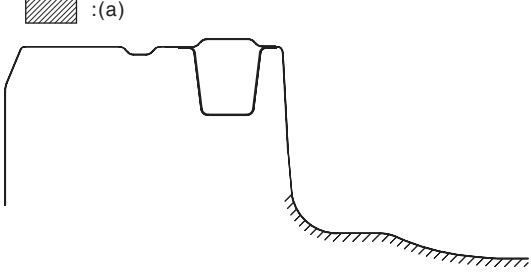
<p>Cross section F — F</p>  <p>BS-01511</p>	<p>Section G — G (rotated 90°)</p>  <p>BS-01606</p>
<p>Section H — H (rotated 90°)</p>  <p>BS-01607</p>	<p>Section I — I</p>  <p>BS-01512</p>
<p>Section J — J (rotated 90°)</p>  <p>BS-01608</p>	<p>SUBARU®</p>

(a) Under coat application locations