

## 15. Front & Rear Differential Gear Oil

### A: REPLACEMENT

#### 1. FRONT DIFFERENTIAL (MT MODEL)

Front differential gear oil for MT model lubricates the transmission and differential together. Refer to "Transmission Oil" for replacement procedure. <Ref. to PM-26, Transmission Gear Oil.>

#### 2. FRONT DIFFERENTIAL (AT MODEL)

1) Drain the differential gear oil by removing drain plug using TORX® bit T70.

#### CAUTION:

If the front differential gear oil is spilt over exhaust pipe, wipe it off with cloth to avoid emitting smoke or causing a fire.

#### NOTE:

- Before starting work, cool off the differential gear oil well.
- 4AT model

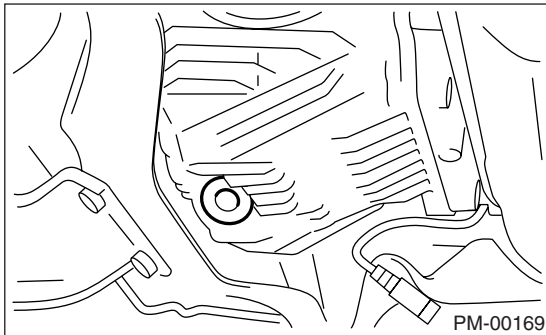

- 5AT model

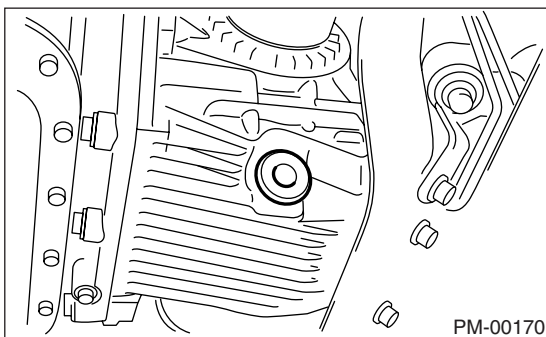

2) Replace the gasket with new part, and then tighten the drain plug to specified torque.

#### Tightening torque:

- 4AT model
  - Copper gasket
    - 70 N·m (7.1 kgf-m, 51.6 ft-lb)
  - Aluminum gasket
    - 44 N·m (4.5 kgf-m, 32.5 ft-lb)

- 5AT model
  - Copper gasket
    - 70 N·m (7.1 kgf-m, 51.6 ft-lb)

3) Fill differential gear oil through the oil level gauge hole up to the upper point of level gauge.

#### Recommended gear oil:

Refer to "RM" section. <Ref. to RM-2, LUBRICANTS, RECOMMENDED MATERIALS, Recommended Materials.>

#### NOTE:

Each oil manufacturer has its base oil and additives. Thus, do not mix two or more brands.

#### Gear oil capacity:

##### 4AT model

1.1 — 1.3 ℓ (1.2 — 1.4 US qt, 1.0 — 1.1 Imp qt)

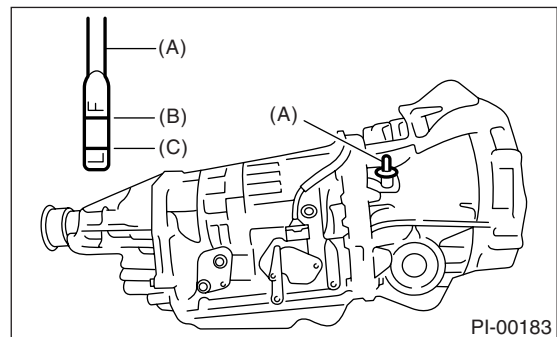

- (A) Oil level gauge
- (B) Upper level
- (C) Lower level

##### 5AT model

1.3 — 1.5 ℓ (1.4 — 1.6 US qt, 1.1 — 1.3 Imp qt)

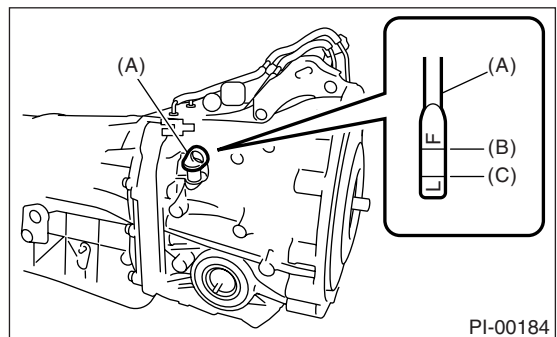

- (A) Oil level gauge
- (B) Upper level
- (C) Lower level

# Front & Rear Differential Gear Oil

## PERIODIC MAINTENANCE SERVICES

### 3. REAR DIFFERENTIAL

- 1) Drain the oil by removing drain plug.
- 2) Remove the filler plug for quick draining oil.
- 3) Install the drain plug after draining oil.

#### NOTE:

- Apply liquid gasket to the drain plug threads for T-type (except for turbo 6MT model).
- Use a new gasket for VA-type and T-type (turbo 6MT model).

#### Liquid gasket:

**THREE BOND 1105 (Part No. 004403010)**

#### Tightening torque:

**T-type (except for turbo 6MT model)**

**49.0 N·m (5.0 kgf-m, 36.2 ft-lb)**

**T-type (turbo 6MT model)**

**60 N·m (6.1 kgf-m, 44.3 ft-lb)**

**VA1-type**

**34 N·m (3.5 kgf-m, 25.3 ft-lb)**

**VA2-type**

**29 N·m (3.0 kgf-m, 21.4 ft-lb)**

- 4) Pour oil to the bottom end of filler plug hole.

#### Recommended gear oil:

**Refer to "RM" section. <Ref. to RM-2, LUBRICANTS, RECOMMENDED MATERIALS, Recommended Materials.>**

- Except for VA2-type

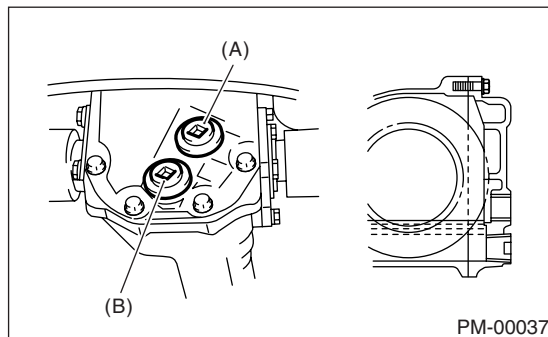

- (A) Filler plug  
(B) Drain plug

- VA2-type

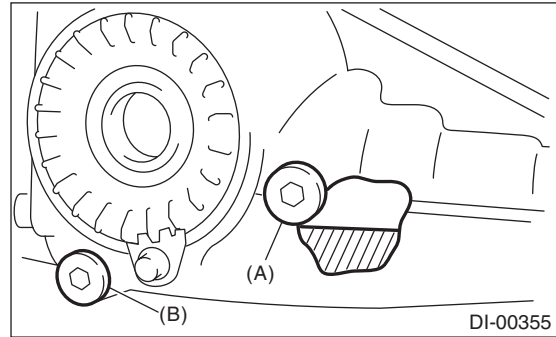

- (A) Filler plug  
(B) Drain plug

#### Oil capacity:

**Except for turbo 6MT model**

**0.8 ℓ (0.8 US qt, 0.7 Imp qt)**

**Turbo 6MT model**

**1.0 ℓ (1.1 US qt, 0.9 Imp qt)**

#### NOTE:

Each oil manufacturer has its base oil and additives. Thus, do not mix two or more brands.

- 5) Install the filler plug.

#### NOTE:

- Apply liquid gasket to the drain plug threads for T-type (except for turbo 6MT model).
- Use a new gasket for VA-type and T-type (turbo 6MT model).

#### Liquid gasket:

**THREE BOND 1105 (Part No. 004403010)**

#### Tightening torque:

**T-type (except for turbo 6MT model)**

**49.0 N·m (5.0 kgf-m, 36.2 ft-lb)**

**T-type (turbo 6MT model)**

**60 N·m (6.1 kgf-m, 44.3 ft-lb)**

**VA1-type**

**34 N·m (3.5 kgf-m, 25.3 ft-lb)**

**VA2-type**

**29 N·m (3.0 kgf-m, 21.4 ft-lb)**