

4. Air Intake Boot

A: REMOVAL

1. AIR INTAKE BOOT NO. 1

- 1) Turn the ignition switch to OFF.
- 2) Remove the collector cover.
 - (1) Carefully pull up the front of collector cover at two positions (A).
 - (2) Carefully pull up the rear of collector cover at two positions (B) while moving it backward.

NOTE:

Be careful not to contact the fuel delivery tube when moving the collector cover rearward.

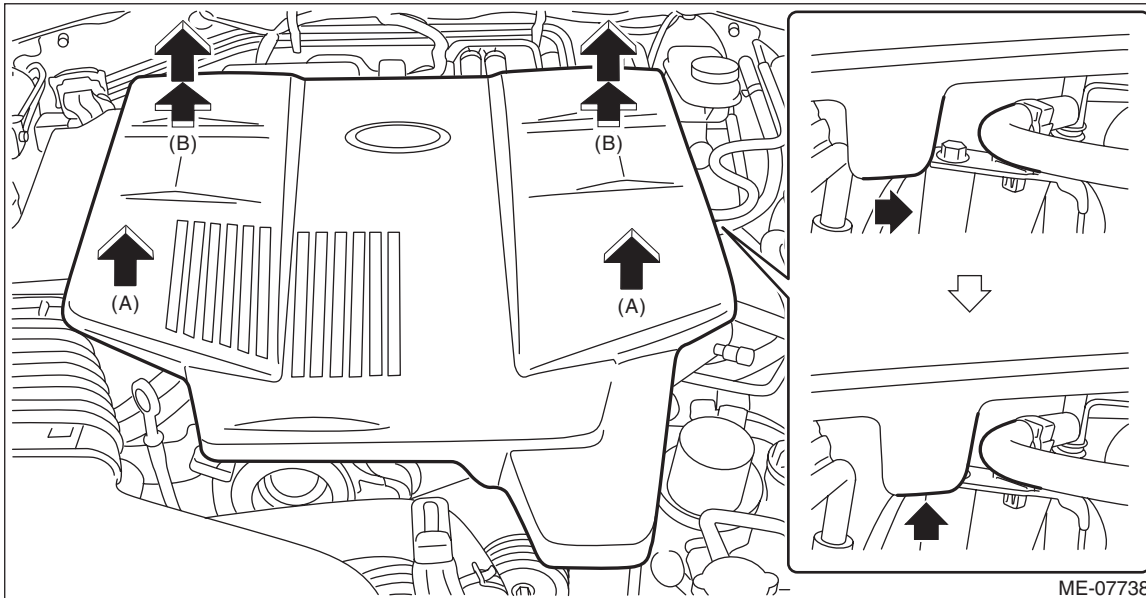

- 3) Remove the air intake duct. <Ref. to IN(H4DO(HEV))-15, REMOVAL, Air Intake Duct.>
- 4) Remove the air intake boot No. 1 from the protrusion (A) on the intake duct.

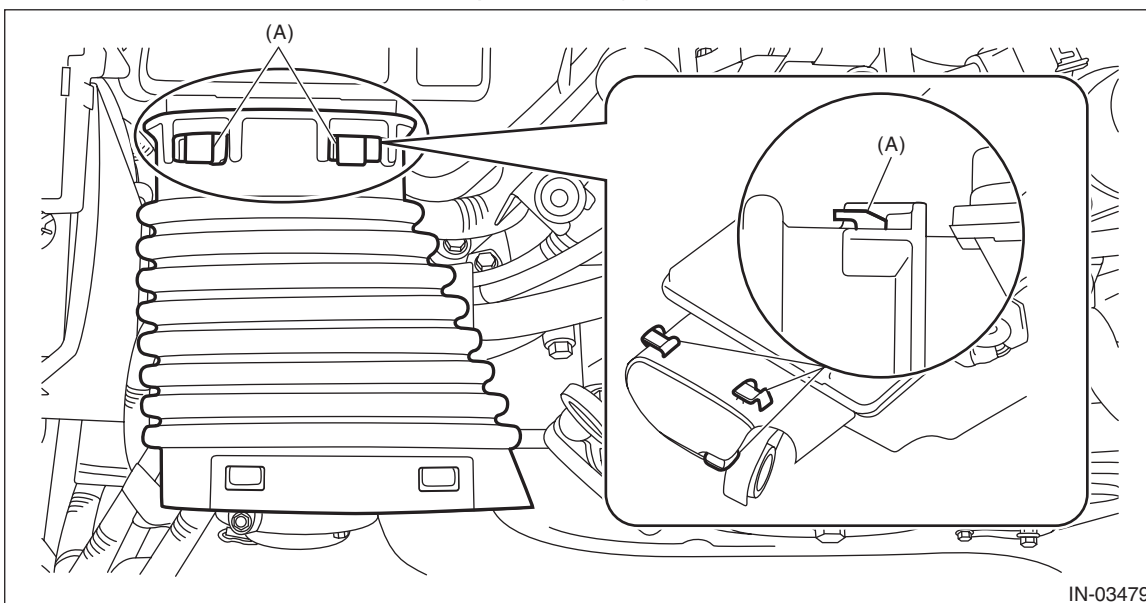

2. AIR INTAKE BOOT NO. 2

- 1) Turn the ignition switch to OFF.
- 2) Remove the collector cover.
 - (1) Carefully pull up the front of collector cover at two positions (A).
 - (2) Carefully pull up the rear of collector cover at two positions (B) while moving it backward.

NOTE:

Be careful not to contact the fuel delivery tube when moving the collector cover rearward.

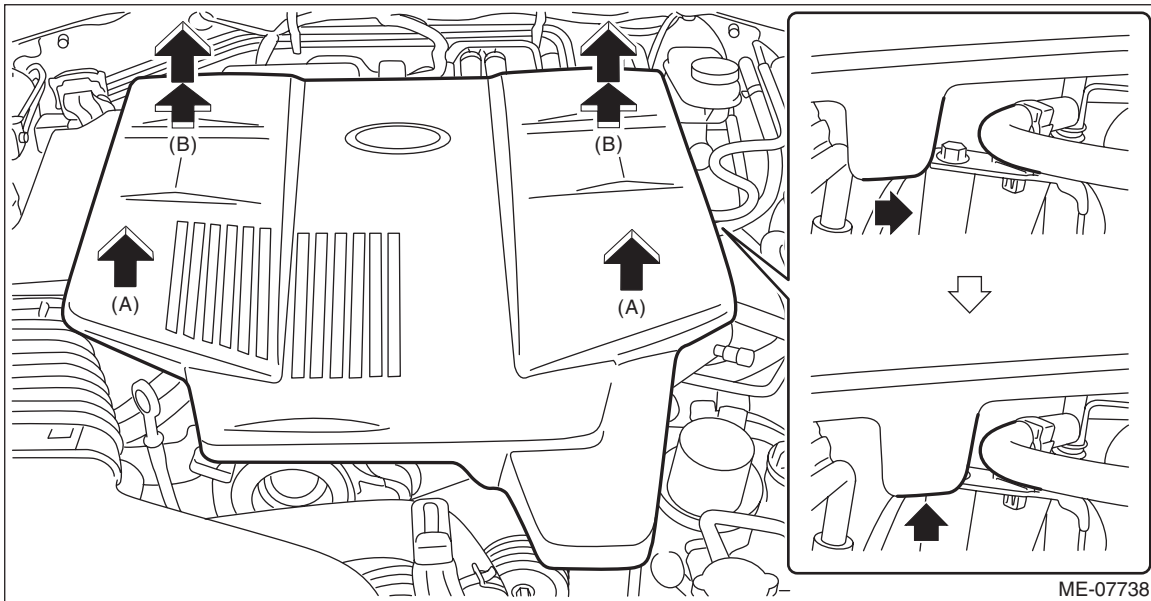

- 3) Remove the clip (A) which secures the resonator chamber to the air cleaner case (rear), and then loosen the clamp (B) which secures the resonator chamber to the air cleaner case (rear) and the air intake boot No. 2.

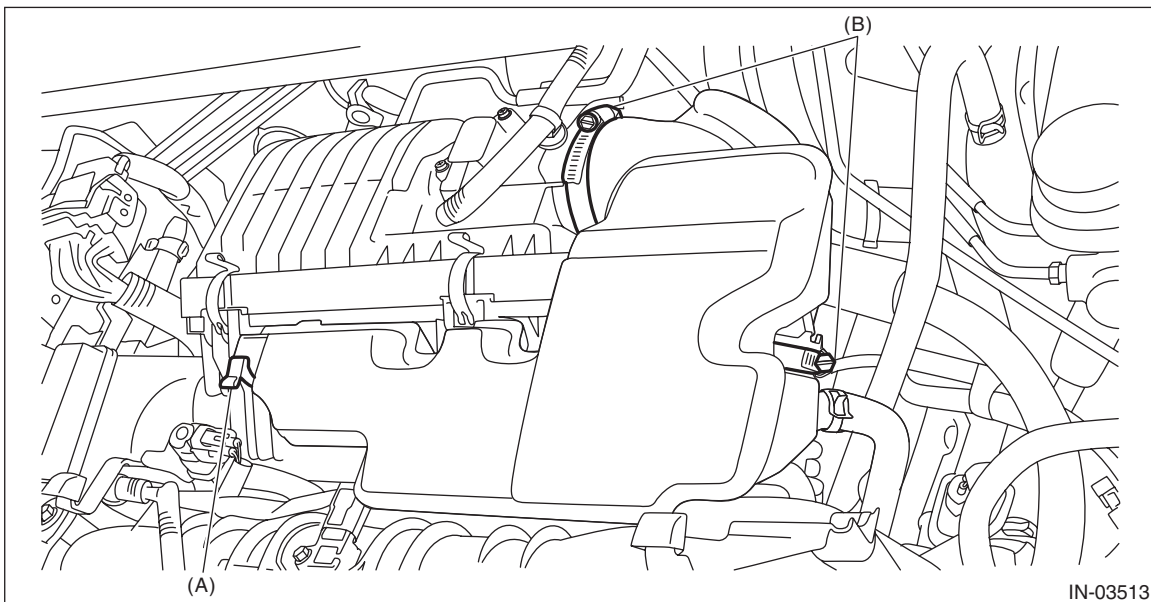

Air Intake Boot

INTAKE (INDUCTION)

4) Remove the resonator chamber from the air cleaner case (rear) and the air intake boot No. 2, and move the resonator chamber to the left side wheel apron.

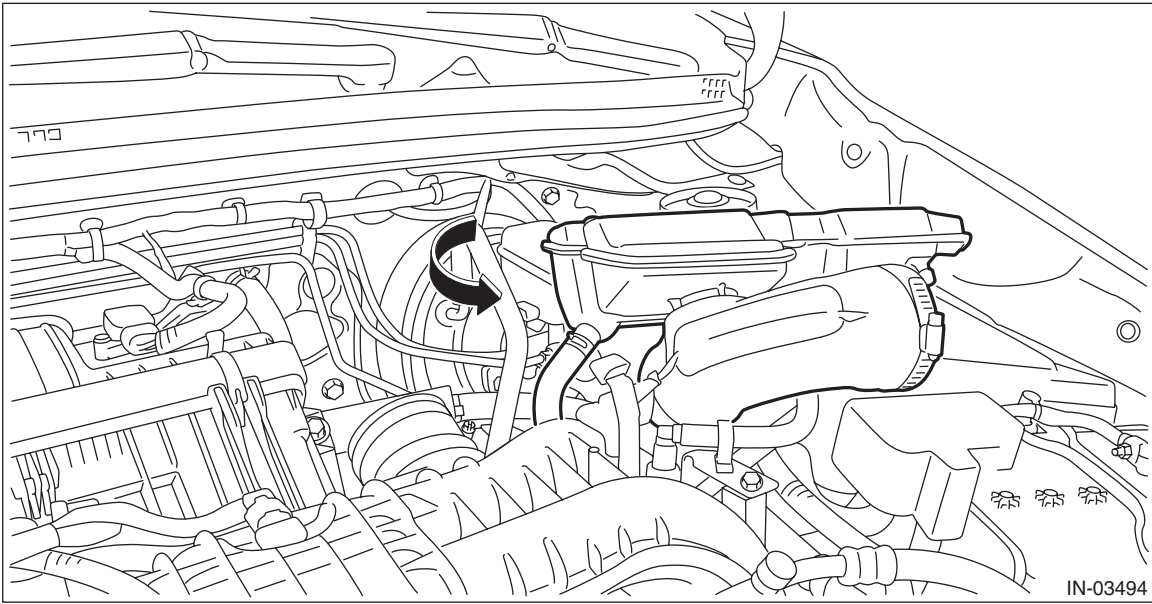

5) Remove the air intake boot No. 2 from the throttle body.

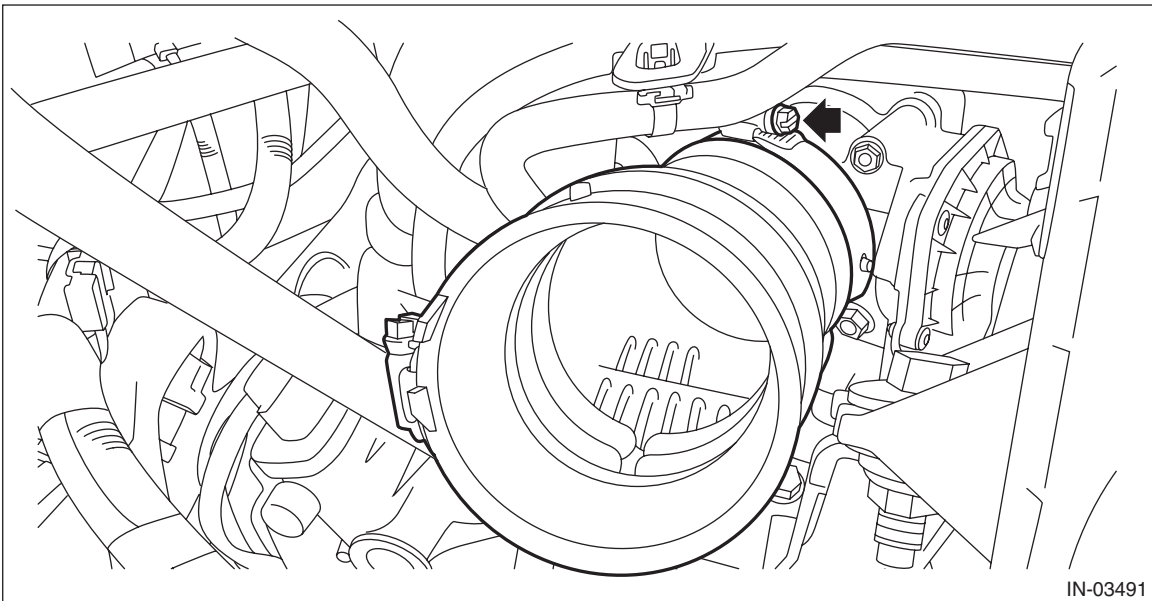

B: INSTALLATION

1. AIR INTAKE BOOT NO. 1

Install in the reverse order of removal.

NOTE:

- Make sure that the air intake boot No. 1 is securely installed to the protrusion (a) on the intake duct and the protrusion (b) on the air intake duct.
- Check the air intake boot No. 1 for peel-off.

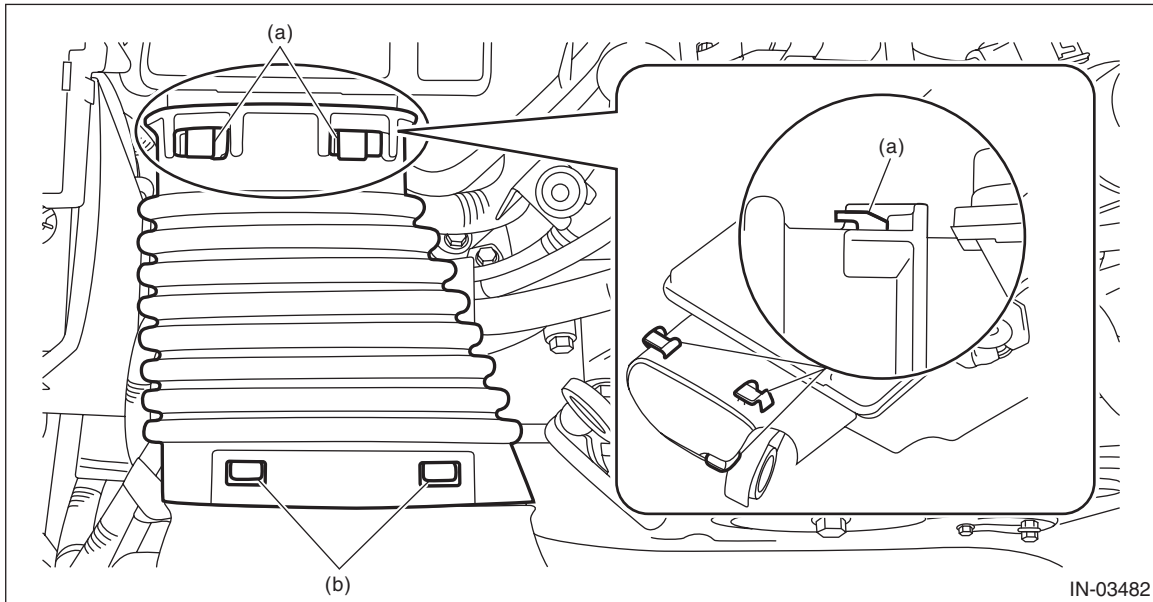

Air Intake Boot

INTAKE (INDUCTION)

2. AIR INTAKE BOOT NO. 2

1) Install the air intake boot No. 2 to the throttle body.

NOTE:

- Align the clamp hole (a) with the protrusion of the air intake boot No. 2, and install the clamp in the direction as shown in the figure below.
- When installing the air intake boot No. 2 to the throttle body, align the air intake boot No. 2 (b) with the protrusion on the throttle body.

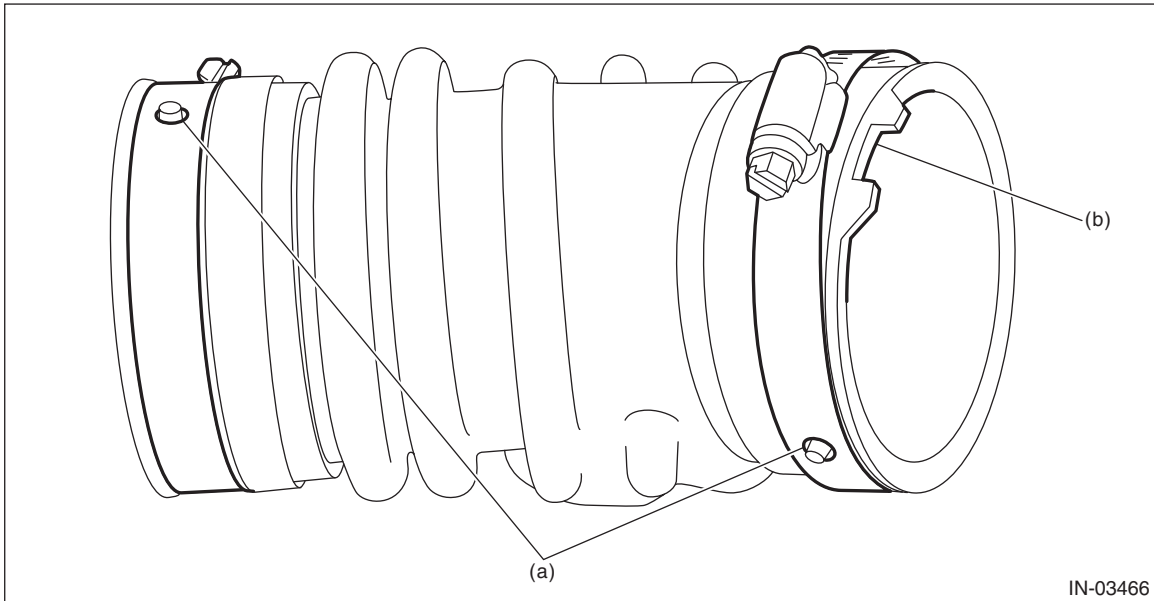

IN-03466

Tightening torque:

3 N·m (0.3 kgf-m, 2.2 ft-lb)

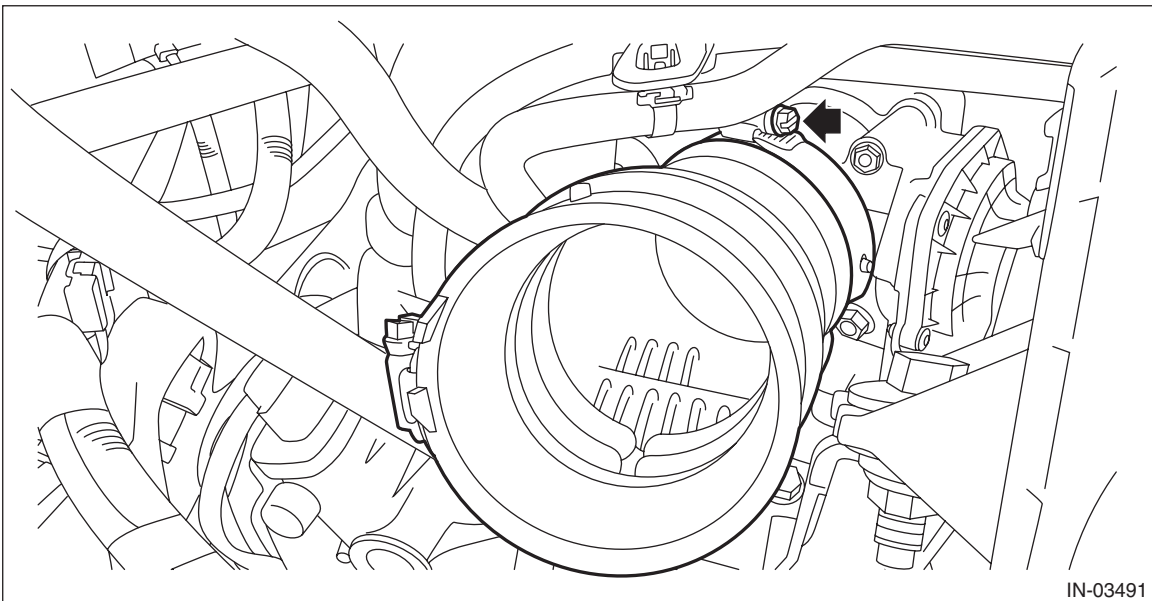

IN-03491

2) Install the resonator chamber. <Ref. to IN(H4DO(HEV))-19, INSTALLATION, Resonator Chamber.>

3) Install the collector cover.

C: INSPECTION

- 1) Check that the air intake boot has no deformation, cracks or other damages.
- 2) Inspect that no foreign objects are mixed in the air intake boot.