

Air Cleaner Element

INTAKE (INDUCTION)

2. Air Cleaner Element

A: REMOVAL

- 1) Turn the ignition switch to OFF.
- 2) Remove the collector cover.
 - (1) Carefully pull up the front of collector cover at two positions (A).
 - (2) Carefully pull up the rear of collector cover at two positions (B) while moving it backward.

NOTE:

Be careful not to contact the fuel delivery tube when moving the collector cover rearward.

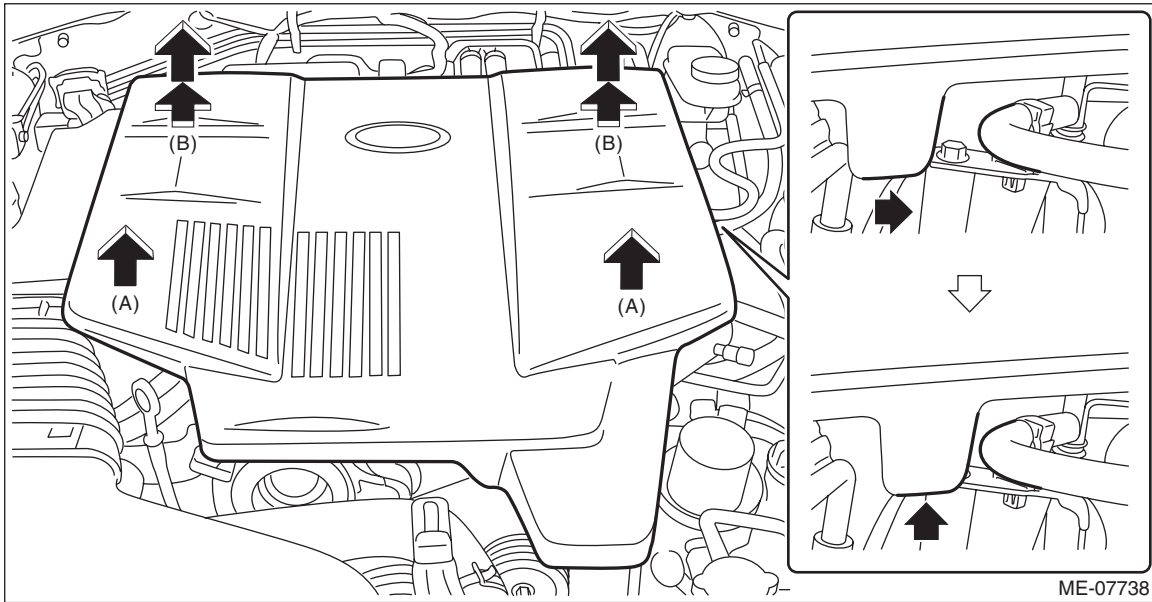

- 3) Remove the clip (A) from the resonator chamber, and remove the clip (B) from the air cleaner case (rear).
- 4) Lift the resonator chamber (C) and open the air cleaner case (rear).
- 5) Put aside the air cleaner case (rear) as shown in the figure, and remove the air cleaner element.

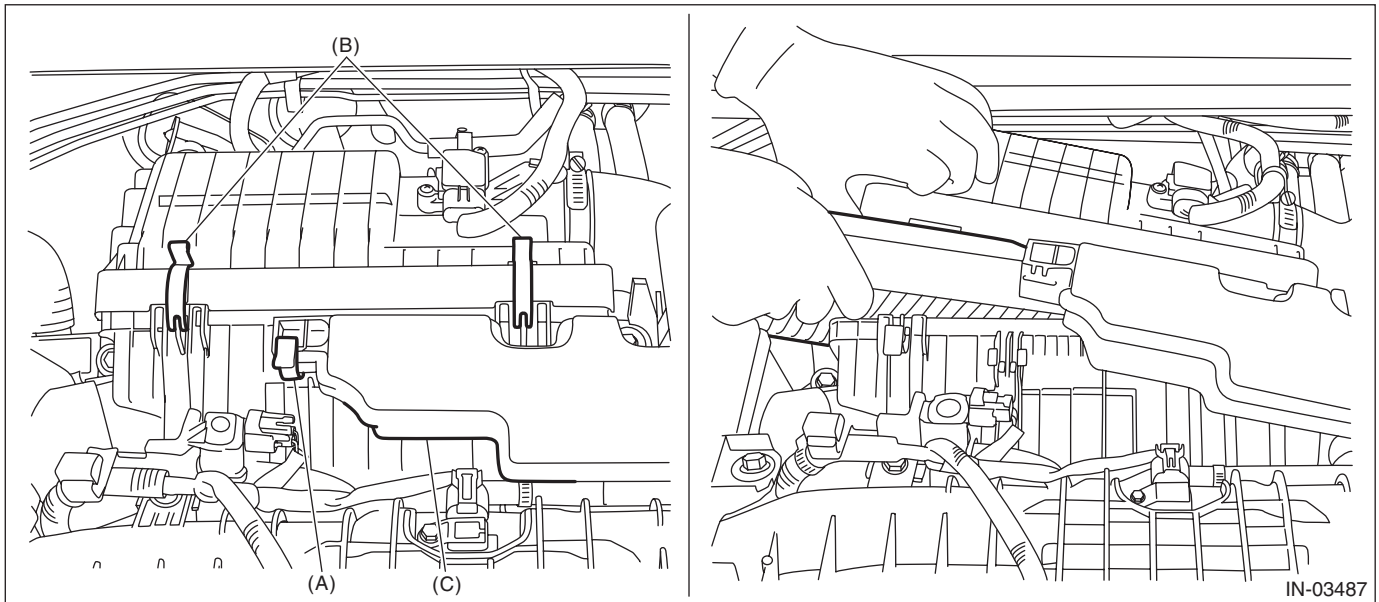

B: INSTALLATION

Install in the reverse order of removal.

CAUTION:

Be sure to use SUBARU genuine air cleaner element depending on the engine type when replacing the air cleaner elements. Using other air cleaner element may affect the engine performance.

NOTE:

- Check that there are no foreign objects in the air cleaner case.
- When installing the air cleaner case (rear), align the protrusion of the air cleaner case (rear) to the hole on the air cleaner case (front).

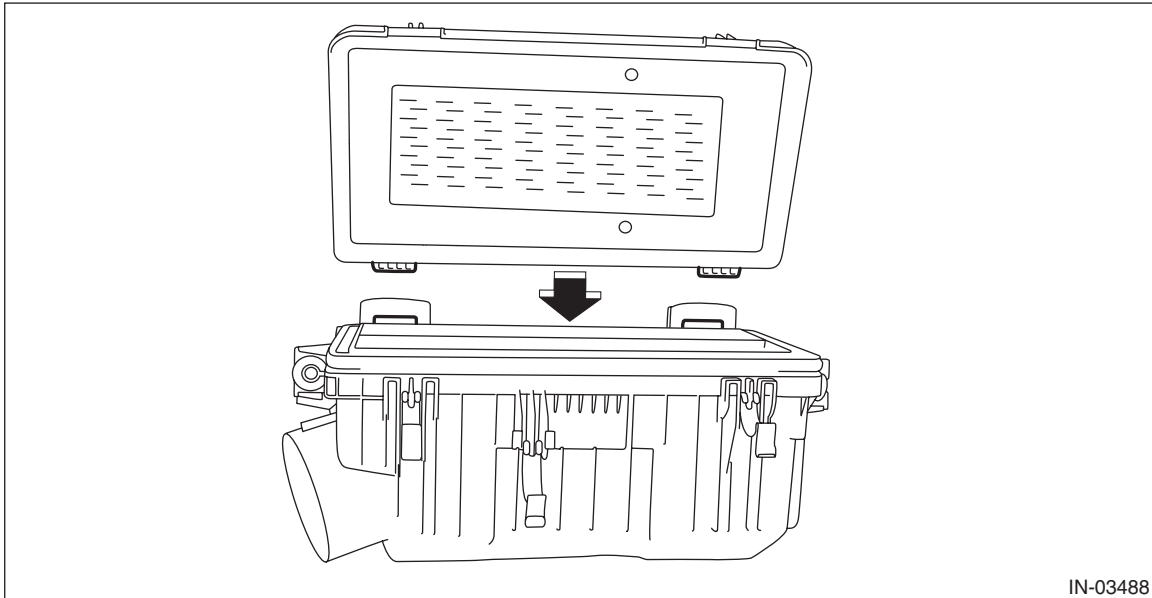

C: INSPECTION

- 1) Check that the air cleaner element has no deformation, cracks or other damages.
- 2) Check the air cleaner element for excessive dirt.
- 3) Replace the air cleaner case (rear) if the HC absorption filter is damaged.