

5. Wiper Blade

A: REMOVAL

1. FRONT

While pushing the locking clip (A) up, pull out the blade assembly - windshield wiper in the direction of the arrow, and remove it from the arm assembly - windshield wiper.

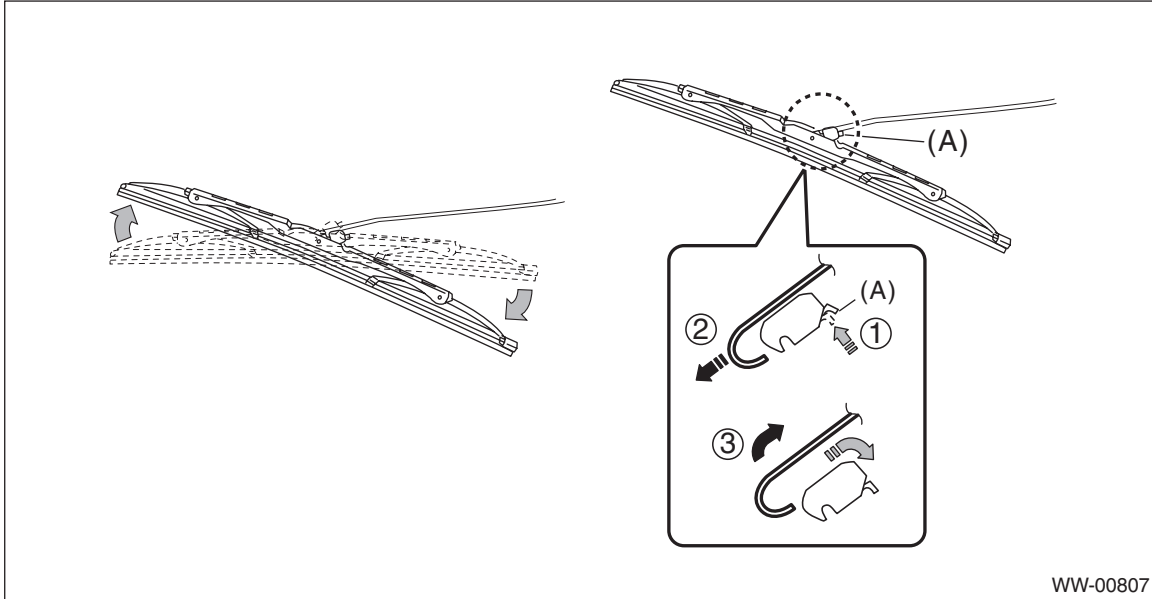

2. REAR

Turn the blade assembly - rear wiper in the direction of arrow (A) and remove it from the arm assembly - rear wiper.

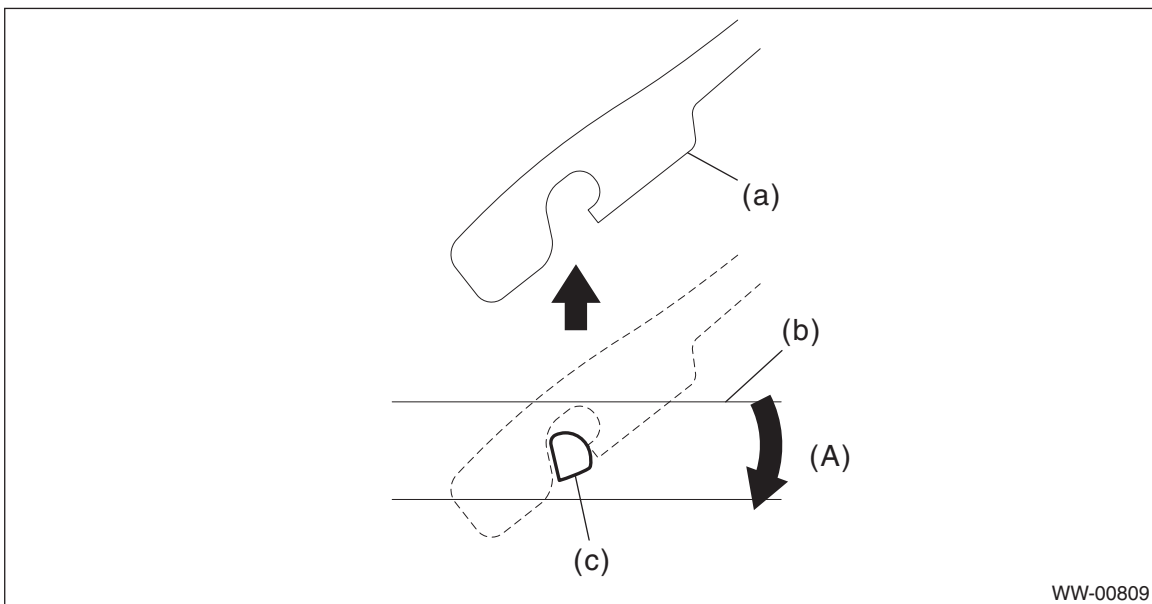

(A) Turn the wiper blade.

(a) Arm ASSY - rear wiper

(b) Blade ASSY - rear wiper

(c) Wiper blade attachment section

B: INSTALLATION

- 1) Install each part in the reverse order of removal.
- 2) Confirm that the clip is locked securely.

C: DISASSEMBLY

1. FRONT

Pull side (A) of the wiper rubber stopper, and remove the rubber assembly - windshield wiper from the blade assembly - windshield wiper.

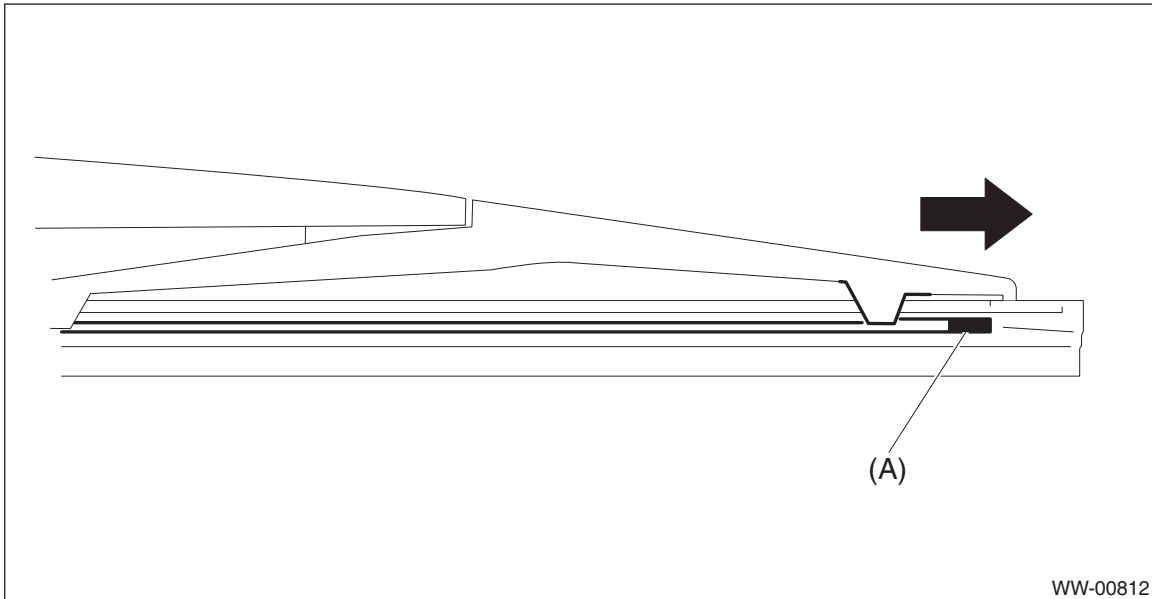

2. REAR

Slightly pull the top of the rubber assembly - rear wiper from the stopper (A), and pull out completely.

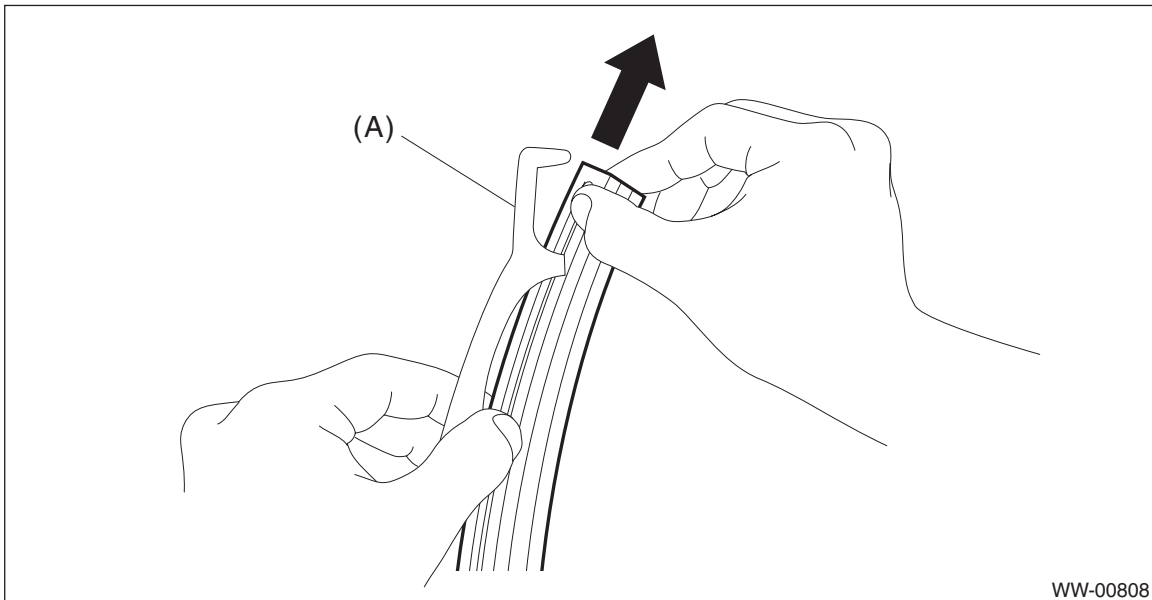

D: ASSEMBLY

1. FRONT

1) Insert the rubber assembly - windshield wiper onto the blade - windshield wiper so that the stopper is in the position shown in the figure.

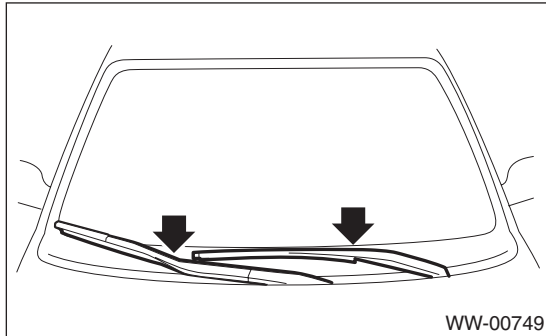

2) Make sure the rubber assembly - windshield wiper is securely fastened to the pull stopper (A).

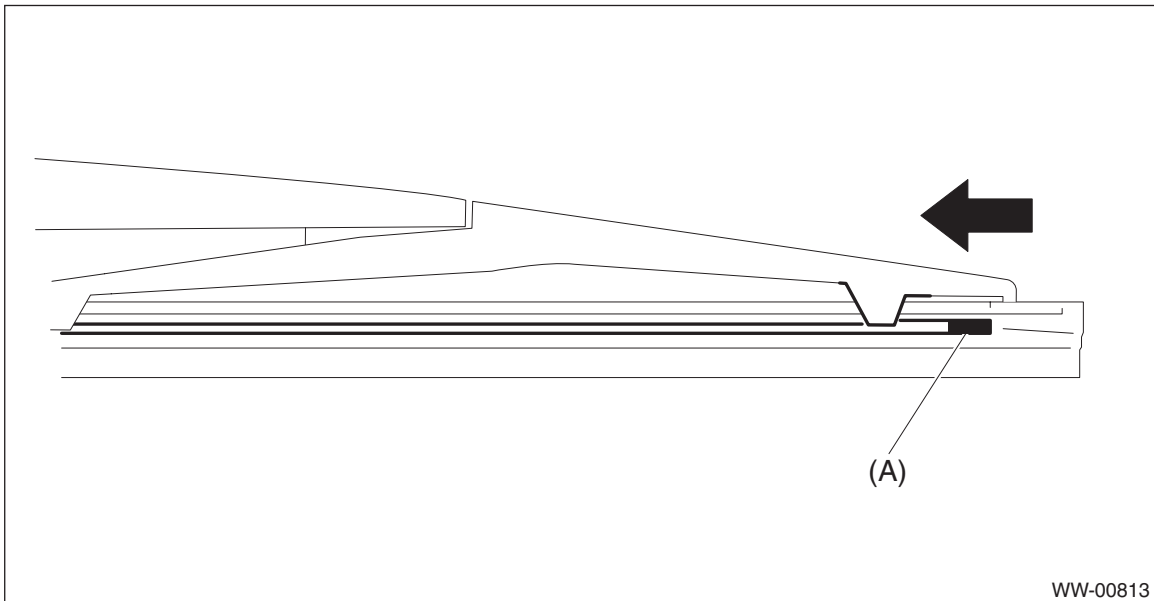

2. REAR

1) Insert the rubber assembly - rear wiper into claw (B).

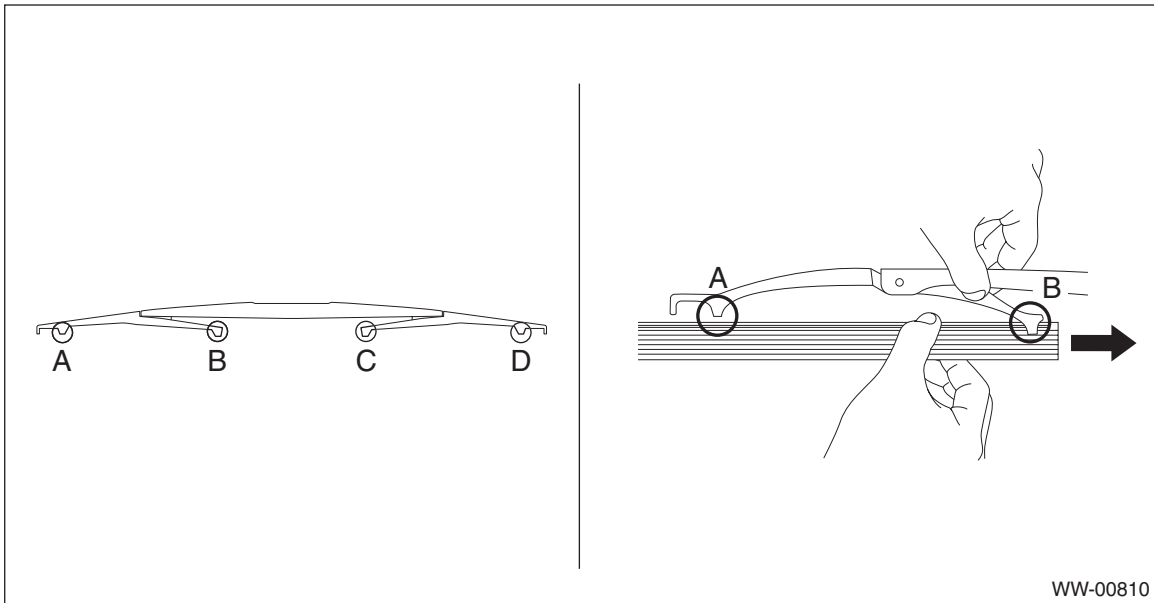

2) Insert the rubber assembly - rear wiper until its top end protrudes approx. 20 mm (0.79 in) from stopper (D).

3) Insert the rubber assembly - rear wiper into claw (A).

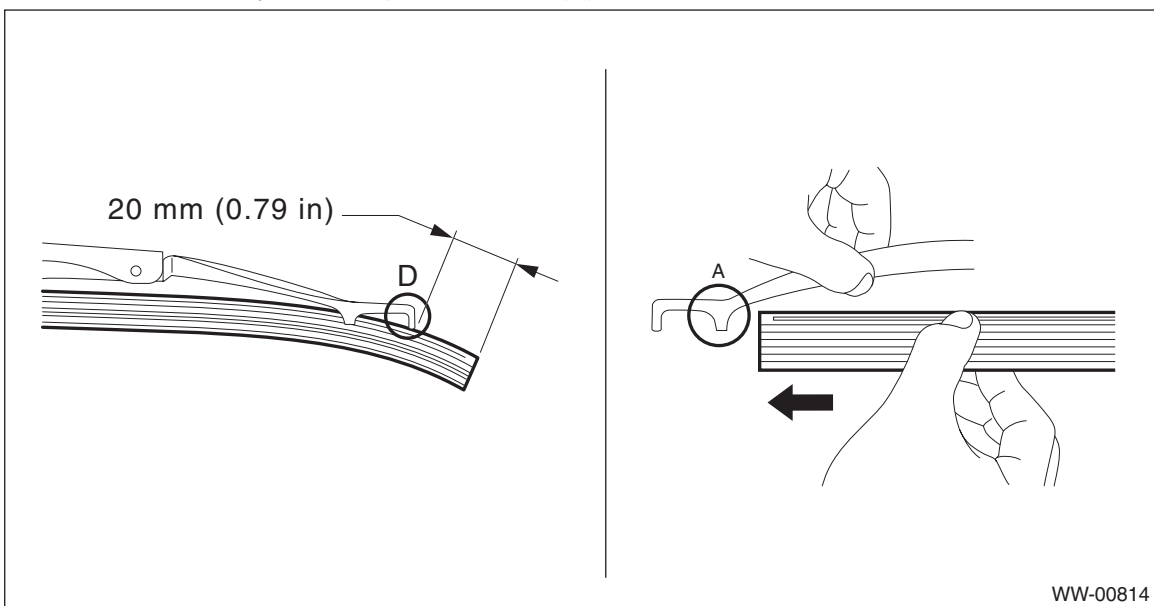

E: INSPECTION

1) Check and clean the rubber assembly - wiper.

CAUTION:

- **Do not use organic solvent cleaner to clean the rubber portion in order to avoid deterioration.**
- **Apply windshield washer fluid or mild detergent on soft cloth or paper towel to clean the rubber portion.**

If hardening, deformation or damage is found at the rubber portion, replace the rubber assembly - wiper.

2) Operate the washer system to check whether flutters or streaks occur.

3) If flutters or streaks occurred, perform the following procedures.

- (1) Check that the blade assembly - wiper is free from deformation, and the movable parts operate smoothly.
- (2) Remove oil film and dirt on the glass.

CAUTION:

- **When using powder type glass cleaner, make sure to dissolve it in water completely. When used without sufficient water, it may damage the glass surface.**
- **Using glass cleaner, clean the glass surface with soft cloth or sponge.**

(3) Operate the windshield wiper again to check whether flutters or streaks occur. If they do, repeat the procedure again.

4) If the problem still persists after performing steps 1) to 3), replace the rubber assembly - wiper with a new part.