

4. Seat Heater System

A: REMOVAL

1. SEAT HEATER UNIT

- 1) Remove the front seats. <Ref. to SE-7, REMOVAL, Front Seat.>
- 2) Remove the backrest cover of front seat and seat cushion cover. <Ref. to SE-9, DISASSEMBLY, Front Seat.>
- 3) Remove the seat heater module.

CAUTION:

If the seat heater module is removed, replace the pad assembly with a new part.

2. SEAT HEATER SWITCH

- 1) Disconnect the ground cable from battery. <Ref. to NT-5, BATTERY, NOTE, Note.>

NOTE:

- For the 12 volt engine restart battery of HEV model, disconnect the ground terminal from 12V engine restart battery sensor.
 - On CVT models, shift the select lever into "D" before disconnecting the battery ground cable.
- 2) Remove the console box assembly.

- (1) Release the claws, and then remove the boot - hand brake.

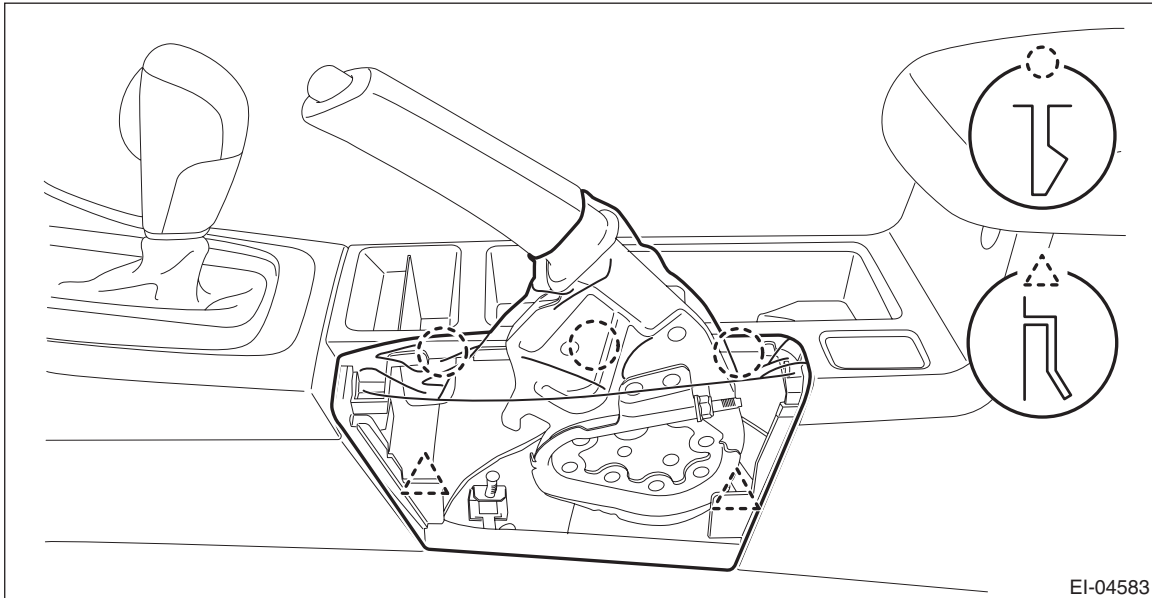

- (2) Move the seat forward, and remove the bolts after detaching the left and right caps.

- (3) Remove the screws, disconnect the harness connector and remove the console box assembly.

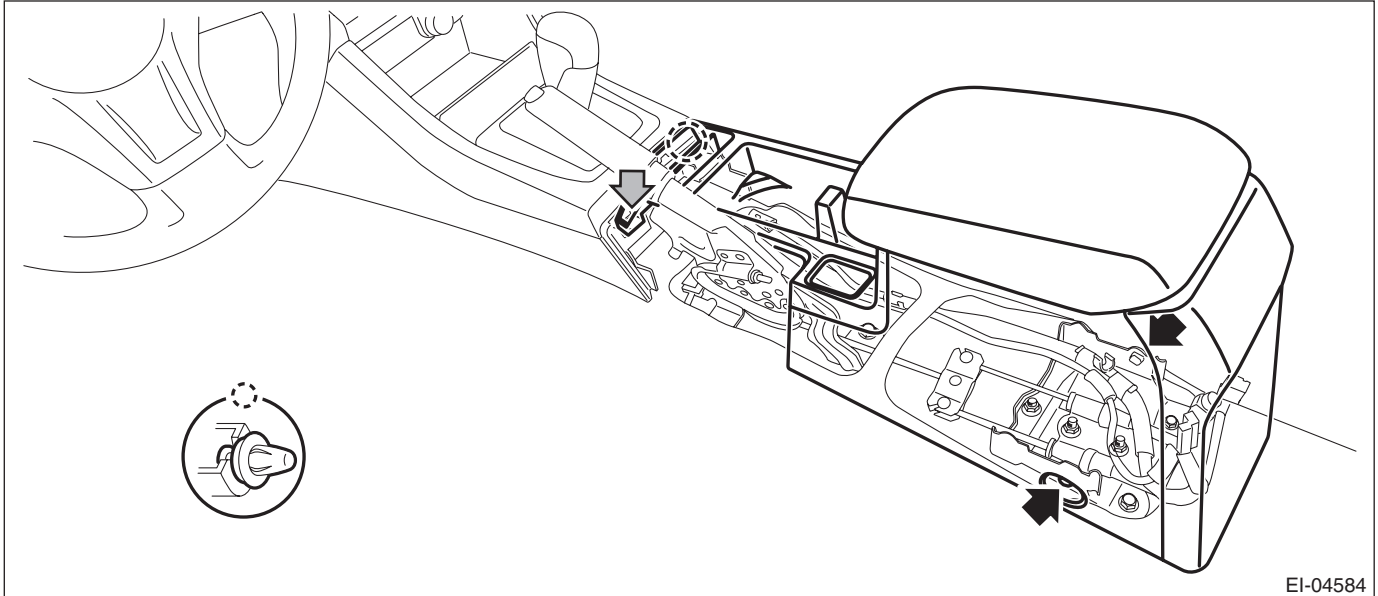

EI-04584

- 3) Remove the screws and remove the seat heater switch from the backside of the console box assembly.

3. SEAT HEATER RELAY AND FUSE

- 1) Disconnect the ground cable from battery. <Ref. to NT-5, BATTERY, NOTE, Note.>

NOTE:

For the 12 volt engine restart battery of HEV model, disconnect the ground terminal from 12V engine restart battery sensor.

- 2) Remove the cover assembly - instrument panel LWR driver.

- (1) Remove the clips, and remove the cover - instrument panel side LH.

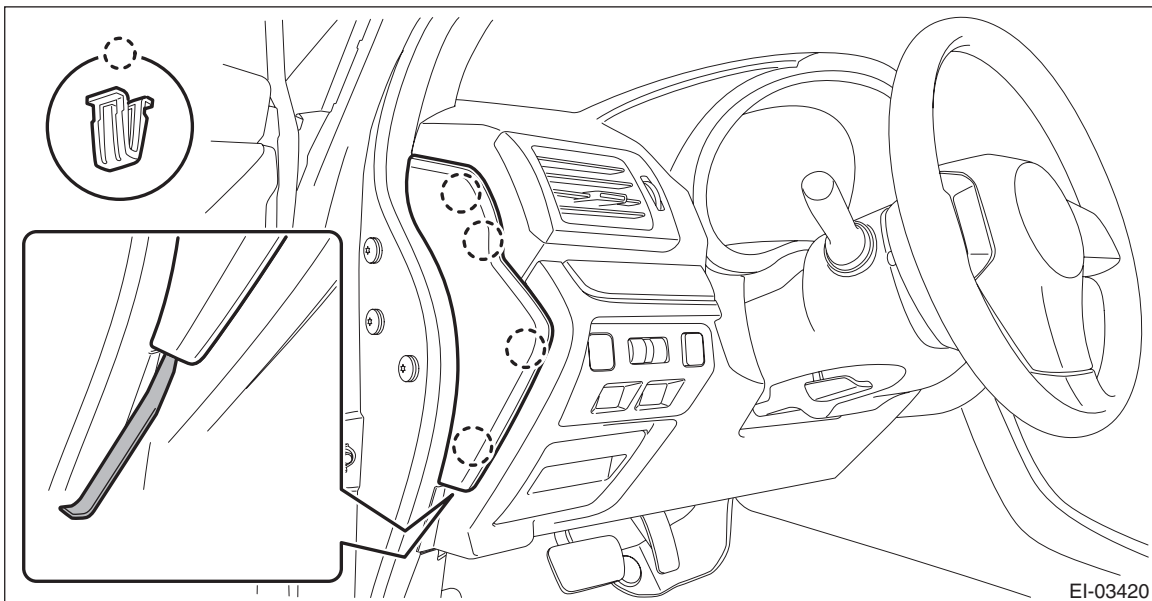

EI-03420

NOTE:

Using a plastic remover, open the cover - instrument panel side LH.

- (2) Remove the screws and release the clips and claws.

Seat Heater System

SEATS

- (3) Disconnect the harness connectors, and remove the cover assembly - instrument panel LWR driver OUT.

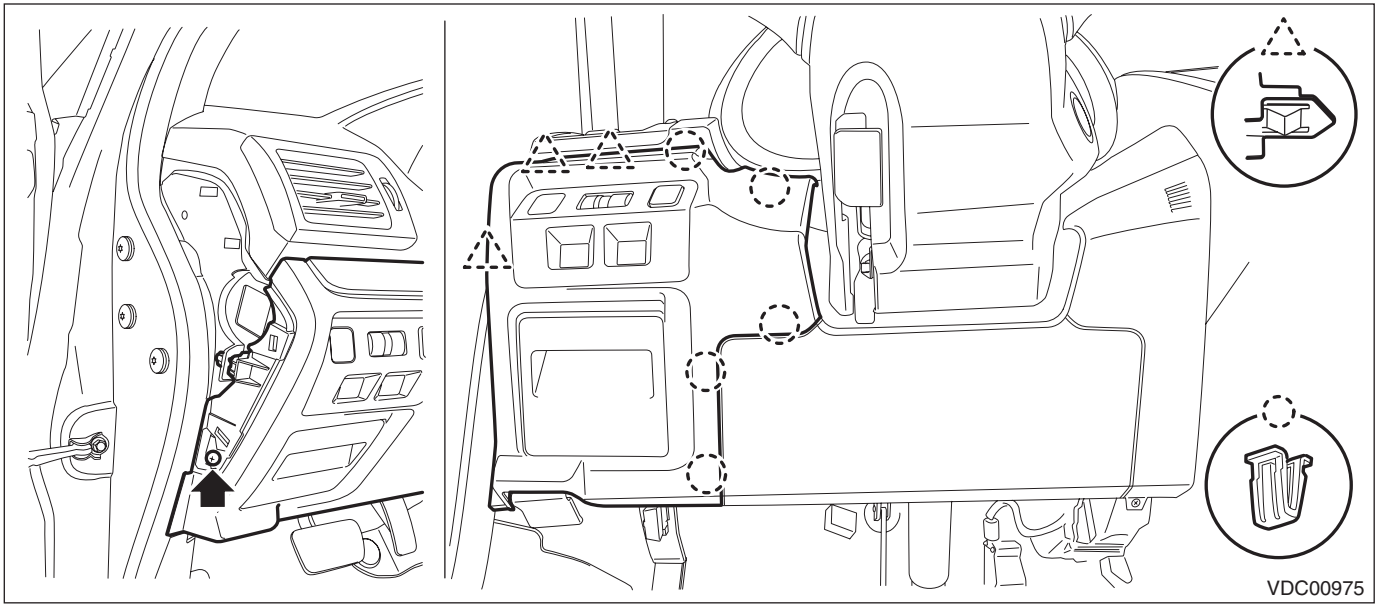

- 3) Remove the pocket assembly.

- (1) Attach the protective tape (a) to the panel center LWR.
- (2) Remove the damper COMPL - pocket.
- (3) Release the stoppers and remove the pocket assembly by pulling it toward you.

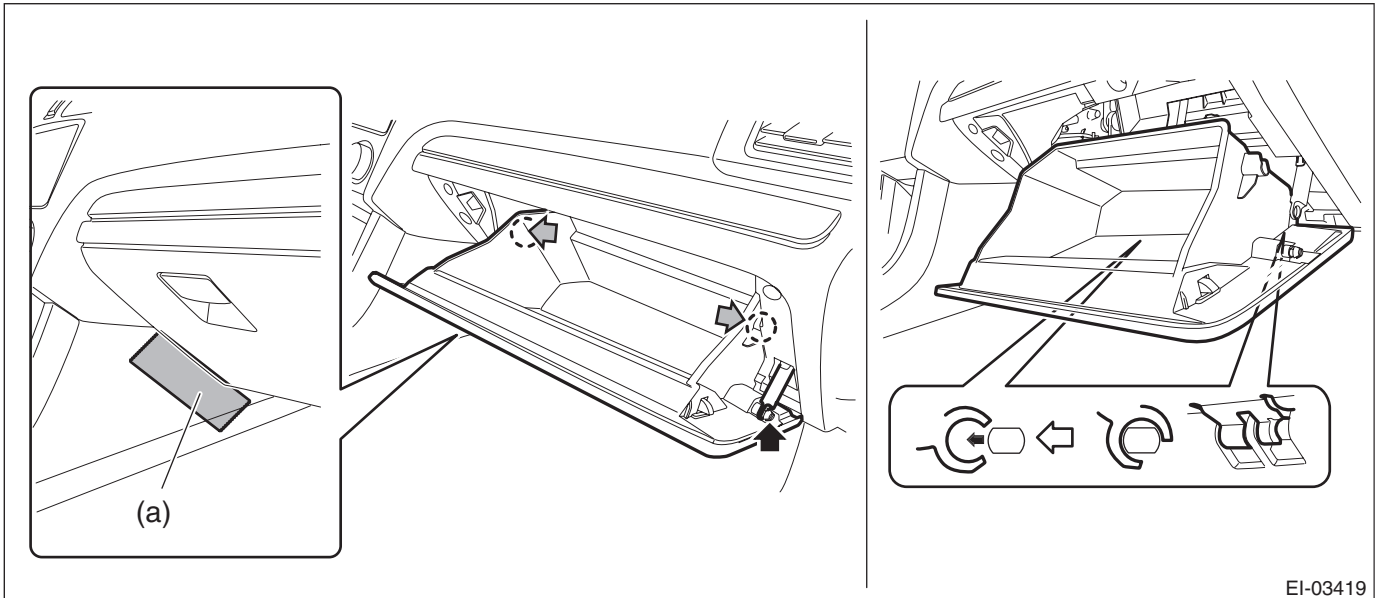

4) Remove the back panel - pocket.

(1) Release the clips, and remove the under cover assembly - passenger.

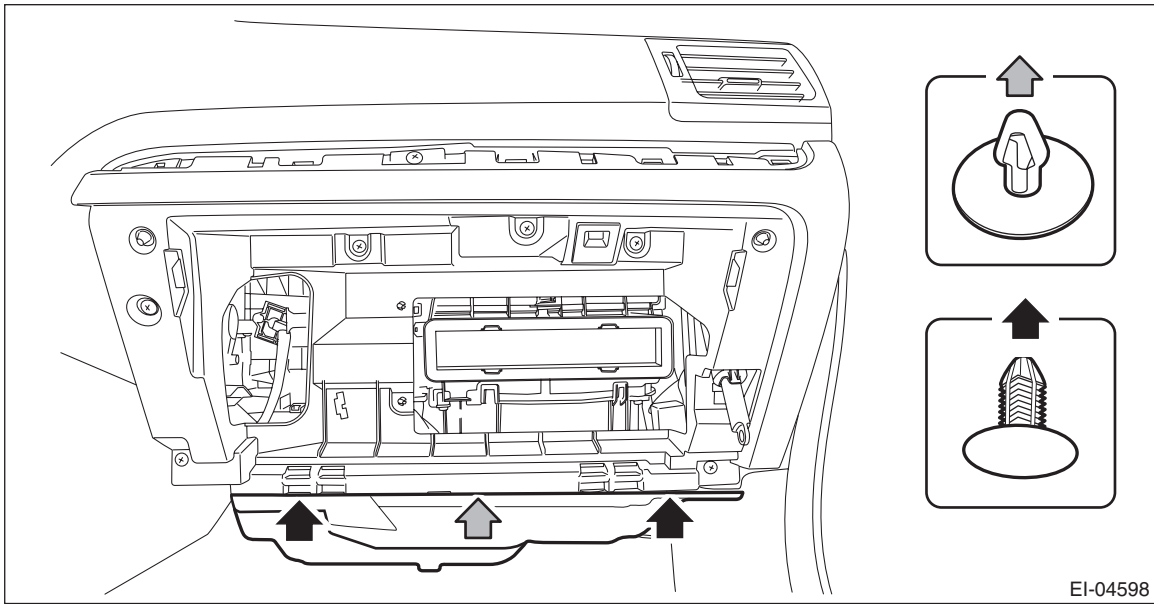

(2) Remove the clips, and remove the cover - instrument panel side RH.

NOTE:

Remove the cover - instrument panel side RH by using a plastic remover.

(3) Release the clips, and remove the ornament - panel assembly passenger.

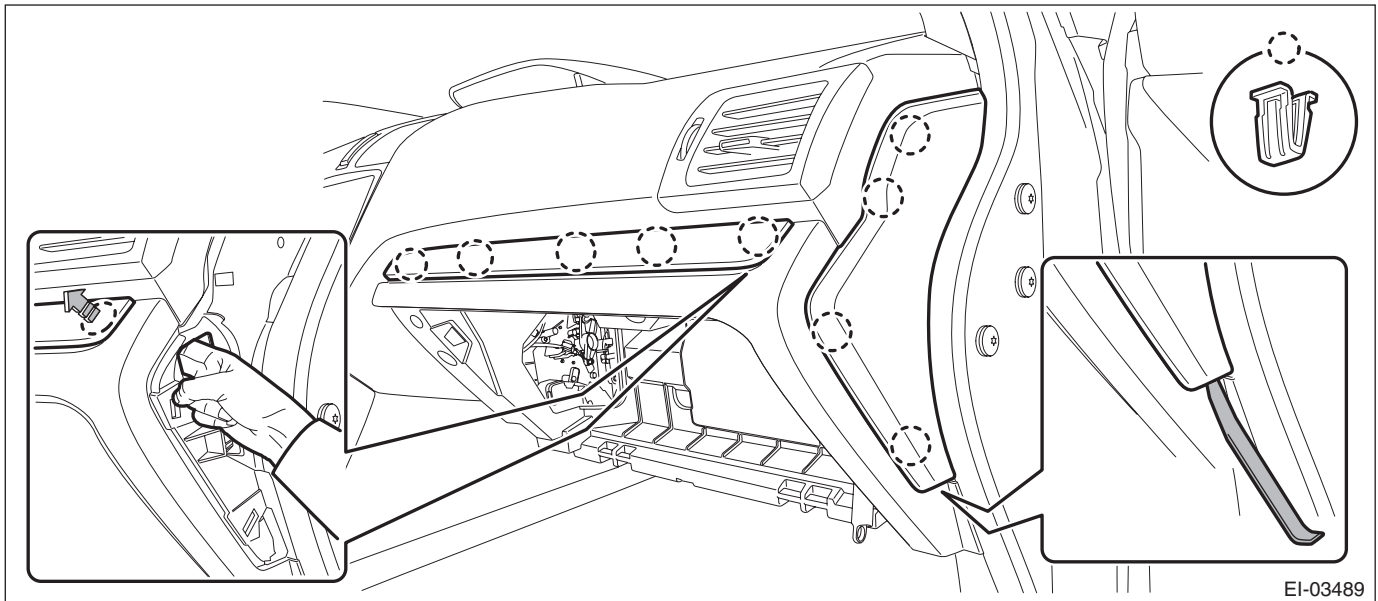

NOTE:

To facilitate the removal, push the clip of the ornament - panel assembly passenger from the backside.

Seat Heater System

SEATS

(4) Release the claws and remove the screws, then remove the back panel - pocket.

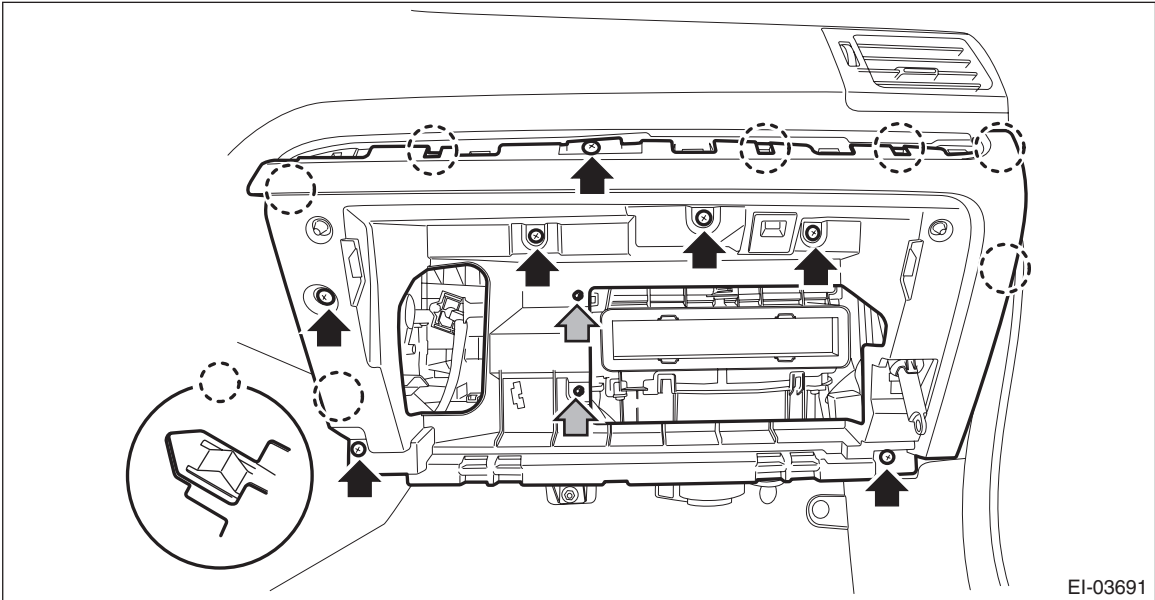

(5) Disconnect the glove box light LED connector.

5) Remove the seat heater relay and fuse.

- (1) Remove the relay & fuse box bolts.
- (2) Remove the seat heater relay from the relay holder.

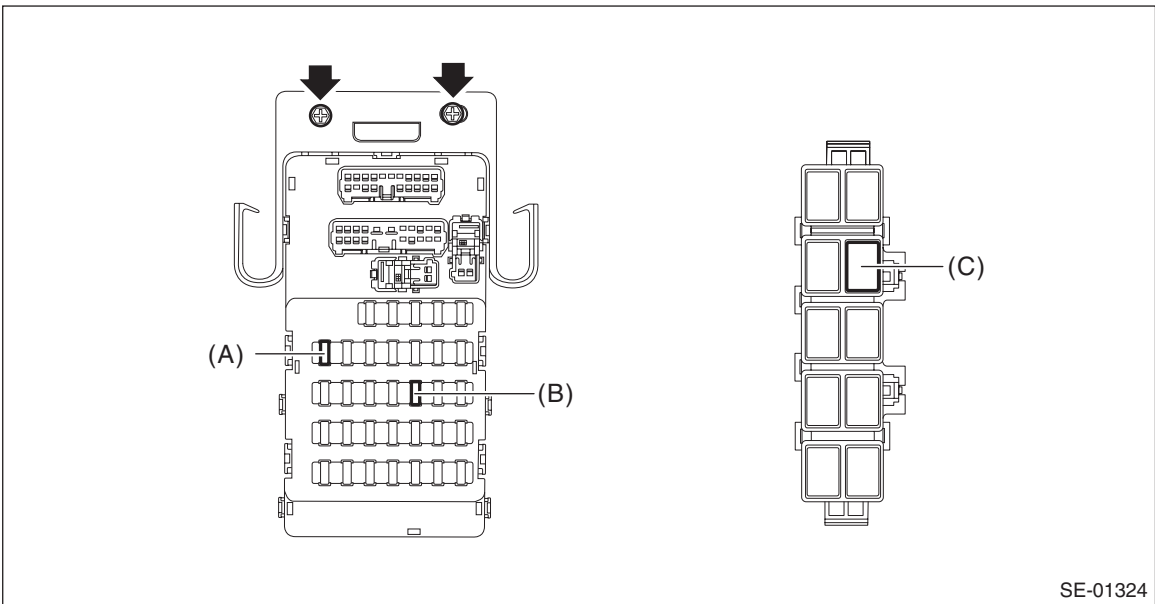

Relay & fuse box	Fuse 7.5 A (remote control mirror)	(A)
	Fuse 15 A (seat heater)	(B)
Relay holder	Seat heater relay	(C)

B: INSTALLATION

CAUTION:

- If the cover - front cushion is removed, make sure to replace the hang wire on the cover - front cushion side with a new wire.
- When replacing the seat cover, be careful not to damage the occupant detection sensor while installing the hog ring.
- When removing or replacing the seat cover, perform “Occupant Detection System Inspection” after installing the seat to check if the occupant detection system operates normally. <Ref. to PI-15, SEAT, PRE-DELIVERY INSPECTION (PDI) PROCEDURE, Pre-delivery Inspection.>
- If the seat heater module is removed, replace the seat cushion pad & frame assembly with a new part.
- If the seat heater module is reused, remove the polyurethane section from the reverse side completely.

Install each part in the reverse order of removal.

Double-sided tape for seat heater module adhesion:
NITTO DENKO 501L or equivalent

C: INSPECTION

1. WIRING DIAGRAM

Refer to “Seat Heater System” in the wiring diagram.

- Gasoline engine model <Ref. to WI(w/o HEV)-198, WIRING DIAGRAM, Seat Heater System.>
- HEV model <Ref. to WI(HEV)-202, WIRING DIAGRAM, Seat Heater System.>

2. DIAGNOSTIC CHART

Symptoms	Repair order
Seat heater does not operate.	1. Check the fuse. <Ref. to SE-41, CHECK SEAT HEATER FUSE, INSPECTION, Seat Heater System.>
	2. Check the seat heater relay. <Ref. to SE-42, CHECK SEAT HEATER RELAY, INSPECTION, Seat Heater System.>
	3. Check the seat heater system power supply and ground circuit. <Ref. to SE-42, CHECK POWER SUPPLY AND GROUND CIRCUIT, INSPECTION, Seat Heater System.>
	4. Check the seat heater module. <Ref. to SE-43, SEAT HEATER UNIT, INSPECTION, Seat Heater System.>
	5. Check the seat heater switch circuit. <Ref. to SE-43, SEAT HEATER SWITCH, INSPECTION, Seat Heater System.>

3. CHECK SEAT HEATER FUSE

Remove the seat heater fuse and inspect visually.

Is the fuse blown out?

- **Yes** → Replace the fuse.
- **No** → Check the power supply and ground circuits.

Seat Heater System

SEATS

4. CHECK SEAT HEATER RELAY

- 1) Remove the seat heater relay from the relay holder.
- 2) Measure the resistance between seat heater relay terminals.

Preparation tool: Circuit tester

Terminal No.	Inspection conditions	Standard	Circuit
36 — 37	Always	1 M Ω or more	
36 — 37	Apply battery voltage between terminals 38 — 39.	Less than 1 Ω	

SE-01325

- 3) Replace the seat heater relay if the inspection result is not within the standard.

5. CHECK POWER SUPPLY AND GROUND CIRCUIT

- 1) Check power supply circuit
 - (1) Disconnect the harness connector of seat heater switch.
 - (2) Turn the ignition switch to ON.
 - (3) Measure the voltage between harness connector terminal and chassis ground.

Connector & terminal

(R43) No. 7 (+) — Chassis ground (-):

Is the voltage 12 V or more?

- **Yes** → Go to step 2.
- **No** → Check the harness between the seat heater switch and fuse.

- 2) Check ground circuit

Measure the resistance between harness connector terminal and chassis ground.

Connector & terminal

(R43) No. 2 — Chassis ground:

Is the resistance less than 10 Ω ?

- **Yes** → Go to step 3.
- **No** → Repair the harness.

- 3) Check ground circuit

Measure the resistance between seat heater switch terminals.

Connector & terminal

(R43) No. 7 — (R43) No. 2:

Is the resistance less than 10 Ω ?

- **Yes** → The power supply and ground circuits are normal.
- **No** → Replace the seat heater switch.

6. SEAT HEATER UNIT

1) Disconnect the seat heater unit connector, and check the continuity between terminals of connector.

Connector & terminal

HI

No. 1 — No. 3:

No. 3 — No. 4:

LOW

No. 1 — No. 4:

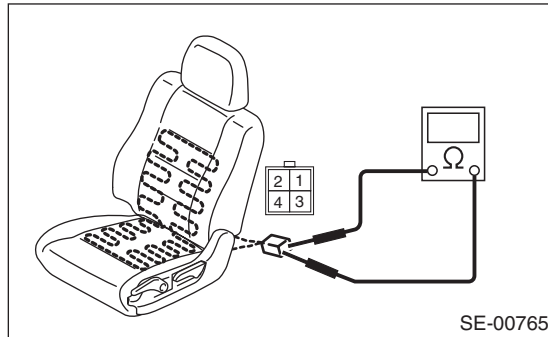

2) If no continuity exists, replace the seat heater module with a new part.

7. SEAT HEATER SWITCH

1) Inspect the continuity between the seat heater switch terminals.

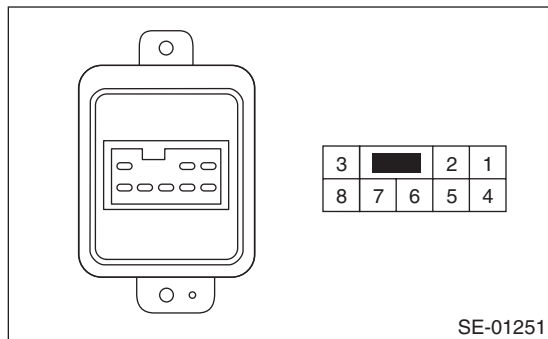

Connector & terminal

HI

No. 7 — No. 2:

No. 7 — No. 4:

No. 7 — No. 8:

LOW

No. 7 — No. 1:

No. 7 — No. 2:

No. 7 — No. 3:

2) If no continuity exists, replace the seat heater switch with a new part.

Seat Heater System

SEATS

BODY 2 SECTION

This service manual has been prepared to provide SUBARU service personnel with the necessary information and data for the correct maintenance and repair of SUBARU vehicles.

This manual includes the procedures for maintenance, disassembling, reassembling, inspection and adjustment of components and diagnostics for guidance of experienced mechanics.

Please peruse and utilize this manual fully to ensure complete repair work for satisfying our customers by keeping their vehicle in optimum condition. When replacement of parts during repair work is needed, be sure to use SUBARU genuine parts.

All information, illustration and specifications contained in this manual are based on the latest product information available at the time of publication approval.

SECURITY AND LOCKS

SL

SUNROOF/T-TOP/CONVERTIBLE TOP
(SUNROOF)

SR

EXTERIOR/INTERIOR TRIM

EI

EXTERIOR BODY PANELS

EB

CRUISE CONTROL SYSTEM

CC

CRUISE CONTROL SYSTEM
(DIAGNOSTICS)CC(w/o
HEV)(diag)CRUISE CONTROL SYSTEM
(DIAGNOSTICS)

CC(HEV)(diag)

IMMOBILIZER (DIAGNOSTICS)

IM(diag)

LAN SYSTEM (DIAGNOSTICS)

LAN(w/o
HEV)(diag)

EyeSight

ES

EyeSight (DIAGNOSTICS)

ES(diag)

LAN SYSTEM (DIAGNOSTICS)

LAN(HEV)(diag)

HYBRID ELECTRIC VEHICLE

HEV

HYBRID ELECTRIC VEHICLE
(DIAGNOSTICS)

HEV(diag)

GENERAL DESCRIPTION (HEV)

GD(HEV)

PEDESTRIAN ALERT SYSTEM

PA

PEDESTRIAN ALERT SYSTEM
(DIAGNOSTICS)

PA(diag)

BODY 2 SECTION**KEYLESS ACCESS WITH PUSH BUTTON
START SYSTEM (DIAGNOSTICS) KPS(diag)****BODY CONTROL SYSTEM (DIAGNOSTICS) BC(diag)**

SECURITY AND LOCKS

SL

	Page
1. General Description	2
2. Relay and Fuse	12
3. Door Lock Control System	14
4. Keyless Entry System	20
5. Keyless Access System	32
6. Push Button Start System	33
7. Security System	35
8. Front Inner Remote	39
9. Front Outer Handle	40
10. Front Door Latch and Door Lock Actuator Assembly	44
11. Rear Inner Remote	47
12. Rear Outer Handle	48
13. Rear Door Latch and Door Lock Actuator Assembly	52
14. Rear Gate Opener Button	54
15. Rear Gate Latch and Actuator Assembly	56
16. Trunk Lid Latch and Actuator Assembly	58
17. Front Hood Lock Assembly	60
18. Remote Openers	63
19. Ignition Key Lock	70
20. Key Lock Cylinders	75
21. Security Control Module	80
22. Impact Sensor	81
23. Keyless Entry Control Module	83
24. Keyless Buzzer	85
25. Body Integrated Unit	87
26. Keyless Transmitter	90
27. Access Key	93
28. Immobilizer Control Module	95
29. Immobilizer Antenna	96
30. Keyless Access Indoor Antenna	99
31. Keyless Access Outdoor Antenna	103
32. Rear Lock Button	105
33. Trunk Opener Button	107
34. Receiver	108
35. Keyless Access CM	110
36. ID Code Box	112
37. Steering Lock CM	113
38. Push Button Ignition Switch	114
39. Starter Relay (Push Button Start)	117
40. IG Relay1 (Push Button Start)	119
41. IG Relay2 (Push Button Start)	121
42. Accessory Relay (Push Button Start)	123
43. Starter Cut Relay	124
44. Access Buzzer	126
45. Function Setting (Customize)	128
46. Keyless Access With Push Button Start System	129