

7. Disposal of Pretensioner

A: PROCEDURE

WARNING:

Make sure to follow the instructions below. Otherwise, personal injuries may occur.

- Before discarding a pretensioner, always perform an activation process to prevent any false activation.
- Wear protective gloves, safety goggles and earplugs during this operation. Wash your hands afterwards.
- Do not touch the pretensioner just after activation because it is very hot. Before handling it for disposal, wait for 40 minutes.

CAUTION:

- Perform a pretensioner operation process in a safe, level place. Do not perform the process outdoors when there is a strong rain or wind.
- Do not drop or damage the pretensioner.
- A large explosive noise will occur when the pretensioner is deployed. Warn persons in the area, and do not allow anyone to approach a radius of 5 m (16 ft) from the discard location.
- After activating the pretensioner, smoke may arise. Therefore, always perform an operation process in a well-ventilated place without any smoke sensor.
- Do not expose the activated pretensioner to water.
- Wrap the activated pretensioner in a sealed vinyl bag when discarding.
- If it is impossible to perform a pretensioner activation process due to some situational reasons, consult SUBARU dealership or one of the authorized workshops.

- 1) Fold the backrest all the way forward, and move the front seat all the way forward.
- 2) Turn the ignition switch to OFF.
- 3) Disconnect the ground cable from battery and wait for at least 60 seconds before starting work. <Ref. to NT-5, BATTERY, NOTE, Note.>
- 4) Disconnect connector of the pretensioner.

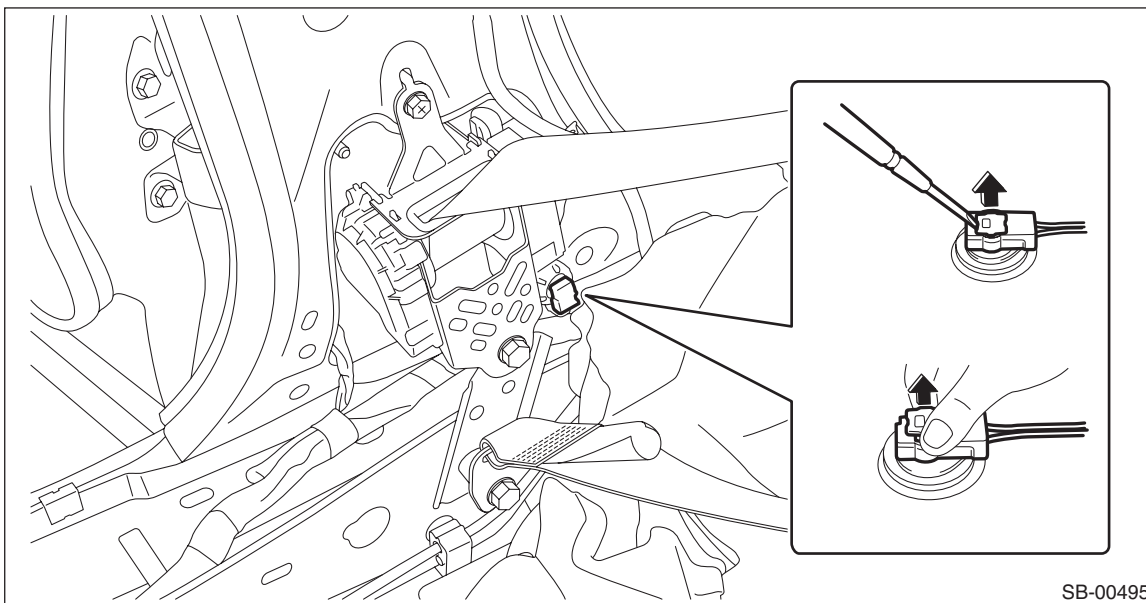

- 5) Short the alligator clip and terminal of the airbag deployment tool together.

CAUTION:

Short the airbag deployment tool terminals until just before the pretensioner operation process.

Preparation tool:

ST: AIRBAG DEPLOYMENT TOOL (98299PA030)

Disposal of Pretensioner

SEAT BELT SYSTEM

6) Connect the airbag deployment tool (A) and test harness adapter D (B).

Preparation tool:

ST: TEST HARNESS ADAPTER D (98299SA010)

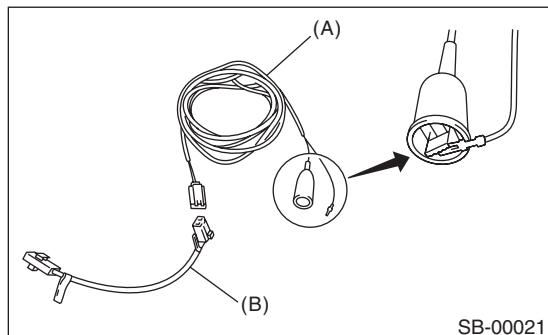

7) Connect the test harness adapter D connector to the pretensioner.

8) Make sure there is no one inside the vehicle.

9) Extend the wiring of the airbag deployment tool to its limit, and completely close all the windows and sun-roof.

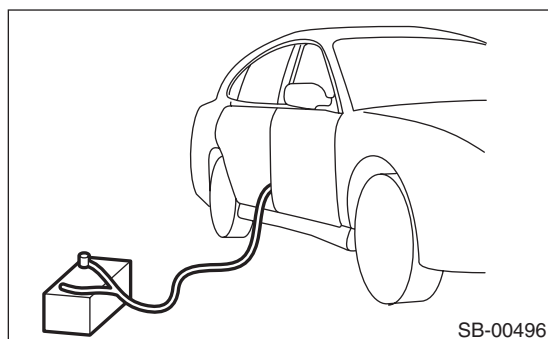

10) Move the battery 5 m (16 ft) or more from the vehicle, and affix nearby.

11) Connect the airbag deployment tool alligator clip to the battery negative (–) terminal.

12) Connect the other cable of airbag deployment tool to the battery positive (+) terminal, and activate the pretensioner.

CAUTION:

- After activation, the pretensioner will be extremely hot. Let it cool down for at least 40 minutes in an area with no one around.
- Do not expose the activated pretensioner to water.

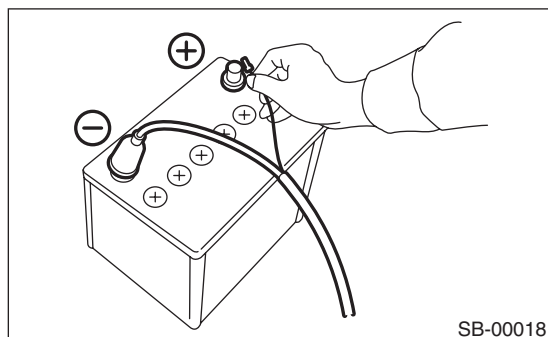

13) Perform operation process of lap seat belt pretensioner from steps 13) to 21) for the passenger's side.

14) Disconnect the connector from the lap seat belt pretensioner.

15) Short the alligator clip and terminal of the airbag deployment tool together.

CAUTION:

Short the airbag deployment tool terminals until just before the pretensioner operation process.

Preparation tool:

ST: AIRBAG DEPLOYMENT TOOL (98299PA030)

16) Connect the airbag deployment tool (A) and test harness adapter D (B).

Preparation tool:

ST: TEST HARNESS ADAPTER D (98299SA010)

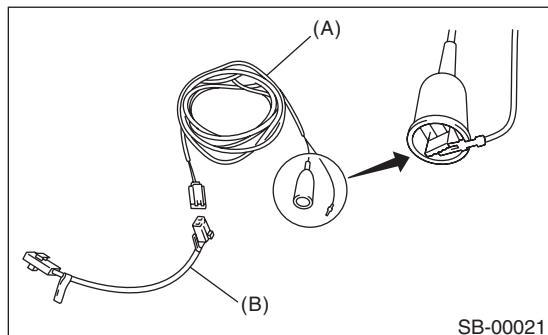

17) Connect the test harness adapter D connector to the lap seat belt pretensioner.

18) Make sure there is no one inside the vehicle.

19) Extend the wiring of airbag deployment tool to the limit, and close all the windows and sunroof completely.

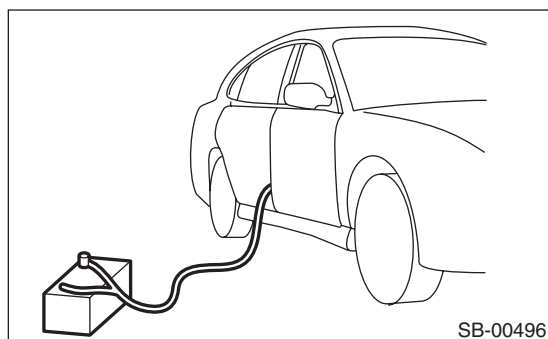

20) Move the battery 5 m (16 ft) or more from the vehicle, and affix nearby.

21) Connect the airbag deployment tool alligator clip to the battery negative (–) terminal.

22) Connect the other cable of airbag deployment tool to the battery positive (+) terminal, and activate the pretensioner.

CAUTION:

- After activation, the pretensioner will be extremely hot. Let it cool down for at least 40 minutes in an area with no one around.
- Do not expose the activated pretensioner to water.

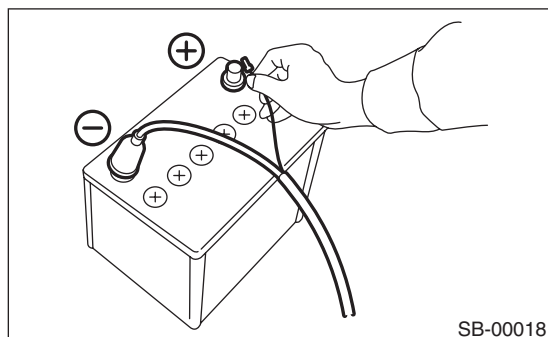

23) Remove the seat belt outer - front. <Ref. to SB-16, REMOVAL, Front Seat Belt.>

Disposal of Pretensioner

SEAT BELT SYSTEM

24) Cut the seat belt at a position as close as possible to the seat belt retractor.

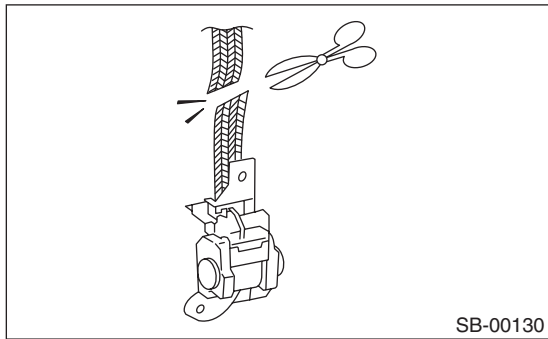

25) Cut the seat belt at a position as close as possible to the lap seat belt pretensioner.

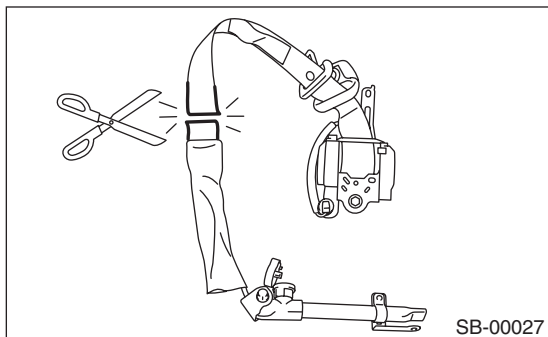

26) Place the activated pretensioner in a sealed vinyl bag, then discard.

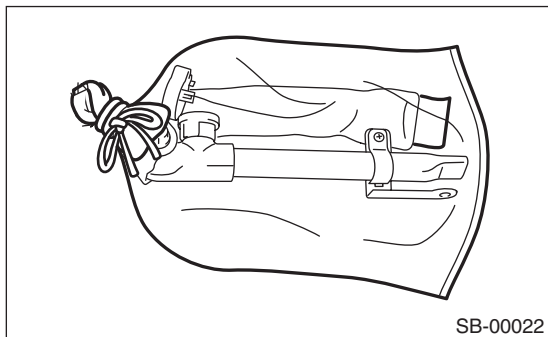
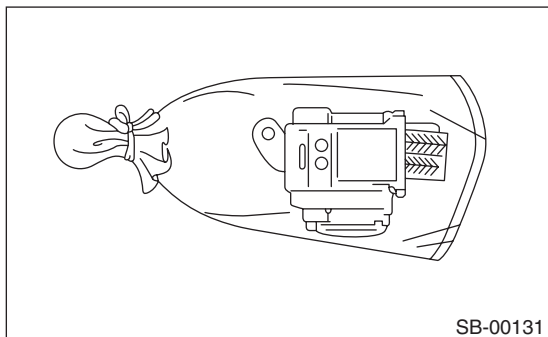

LIGHTING SYSTEM

LI

	Page
1. General Description	2
2. Relay and Fuse	5
3. Headlight System	7
4. Day Time Running Light System	10
5. Clearance Light and Illumination Light System	11
6. Front Fog Light System	12
7. Turn Signal Light and Hazard Light System	13
8. Back-up Light System	16
9. Stop Light System	17
10. Interior Light System	18
11. Auto Headlight Beam Leveler System	19
12. Combination Switch (Light)	21
13. Light Control Sensor	27
14. Headlight Assembly	29
15. Headlight Bulb	36
16. Hazard Switch	44
17. Turn Signal Light & Hazard Light Module	45
18. Front Turn Signal Light Bulb	47
19. Clearance/Parking Light Bulb	49
20. Front Side Marker Light Bulb	51
21. Front Fog Light Assembly	53
22. Front Fog Light Bulb	57
23. Side Turn Signal Light Assembly	59
24. Rear Combination Light Assembly	60
25. Tail/Stop Light Bulb	63
26. Rear Turn Signal Light Bulb	66
27. Rear Side Marker Light Bulb	69
28. Back-up Light Bulb	71
29. License Plate Light	74
30. High-mounted Stop Light	76
31. Spot Map Light	80
32. Room Light	82
33. Luggage Room Light	84
34. Trunk Room Light	86
35. Glove Box Light	88
36. Ignition Switch Illumination	90
37. Auto Headlight Beam Leveler Control Module	92
38. Rear Height Sensor	94
39. Day Time Running Resistor	96
40. Reflex Reflector	98
41. Door Switch	99
42. SRF OFF Switch	100