

Luggage Room Light

LIGHTING SYSTEM

33.Luggage Room Light

A: REMOVAL

1) Disconnect the ground cable from battery. <Ref. to NT-5, BATTERY, NOTE, Note.>

NOTE:

For the 12 volt engine restart battery of HEV model, disconnect the ground terminal from 12V engine restart battery sensor.

2) Remove the light assembly - luggage room.

CAUTION:

When using a flat tip screwdriver, apply protective tape or cloth and be careful not to cause damage.

(1) Release the claws and remove the main body of the light assembly - luggage room.

(2) Disconnect the connector and remove the light assembly - luggage room and the bulb.

CAUTION:

Use a dry clean cloth so that no grease or water adheres to the glass portion of the bulb.

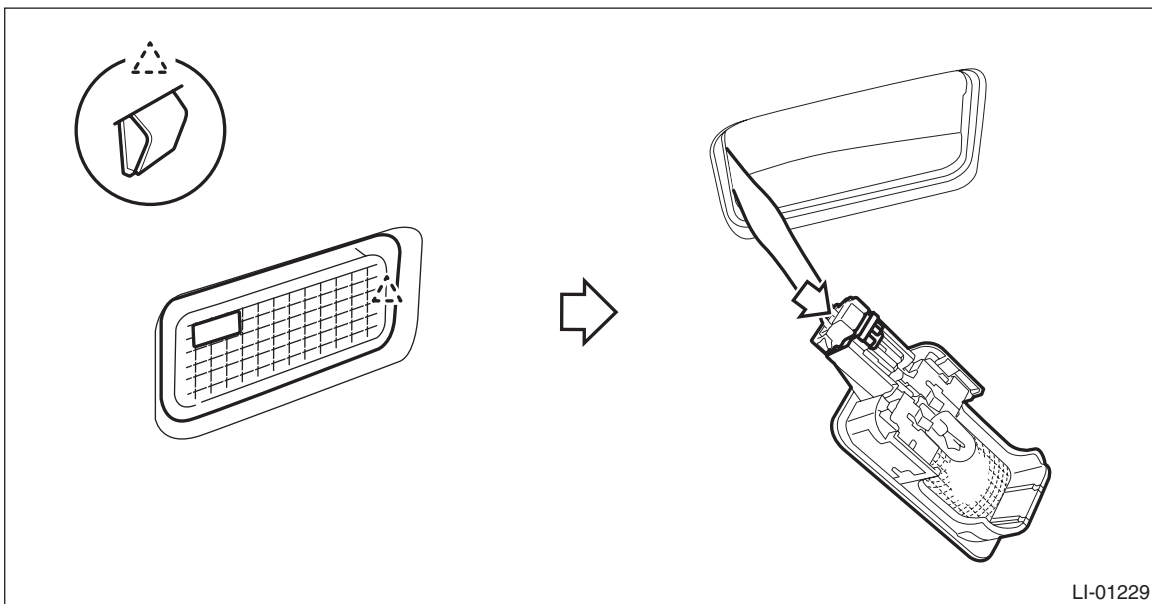

B: INSTALLATION

Install each part in the reverse order of removal.

C: INSPECTION

1. LUGGAGE ROOM LIGHT BULB

- 1) Visually check the bulb for blow out.
- 2) Check the bulb specification. <Ref. to LI-2, SPECIFICATION, General Description.>
- 3) Replace the bulb if it is found defective.

2. LUGGAGE ROOM LIGHT SWITCH

Unit inspection

Preparation tool:

Circuit tester

- 1) Check the resistance between switch terminals.

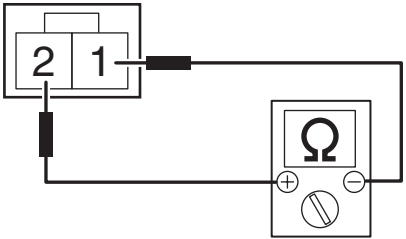
Terminal No.	Inspection conditions	Specification	Connection diagram
1 — 2	Switch OFF	1 MΩ or more	
	Switch ON	Less than 1 Ω	

LI-01253

- 2) Replace the light assembly - luggage room if the inspection result is not within the standard value.