

29. License Plate Light

A: REMOVAL

1) Disconnect the ground cable from battery. <Ref. to NT-5, BATTERY, NOTE, Note.>

NOTE:

For the 12 volt engine restart battery of HEV model, disconnect the ground terminal from 12V engine restart battery sensor.

2) Remove the garnish - trunk. (4 door model) <Ref. to EI-162, REMOVAL, Trunk Lid Garnish.>

3) Remove the license plate light.

(1) Release the claws and pull out the license plate light.

(2) Disconnect the connector and remove the bulb socket and bulb from the license plate light.

CAUTION:

Use a dry clean cloth so that no grease or water adheres to the glass portion of the bulb.

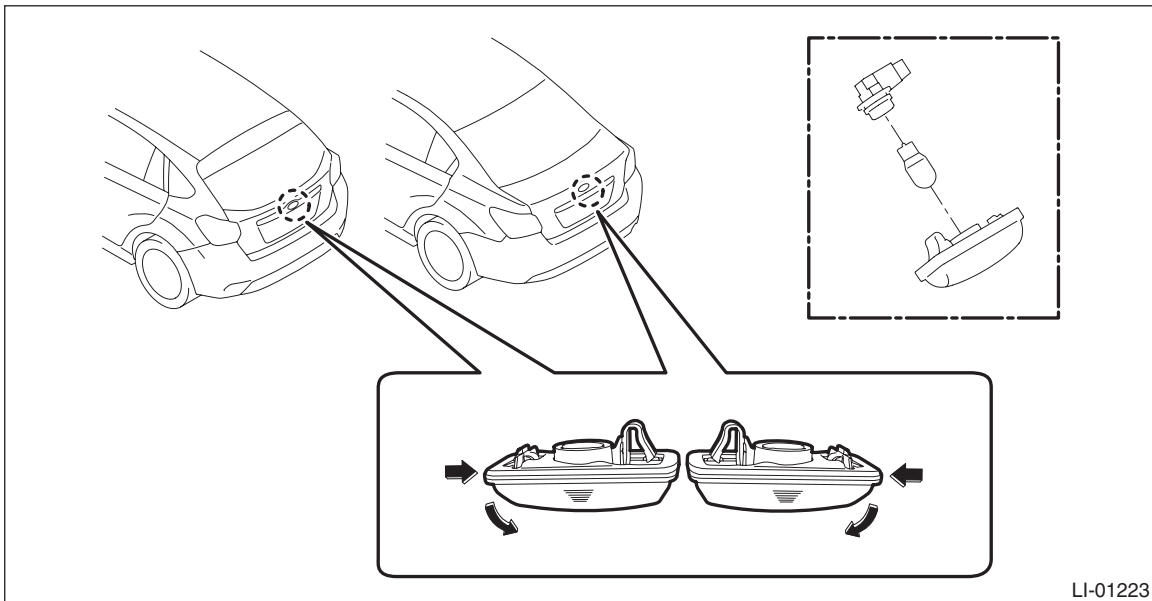

LI-01223

NOTE:

For 4 door model, when removing the bulb only, remove the trim panel - trunk lid halfway, then remove the bulb socket and the bulb.

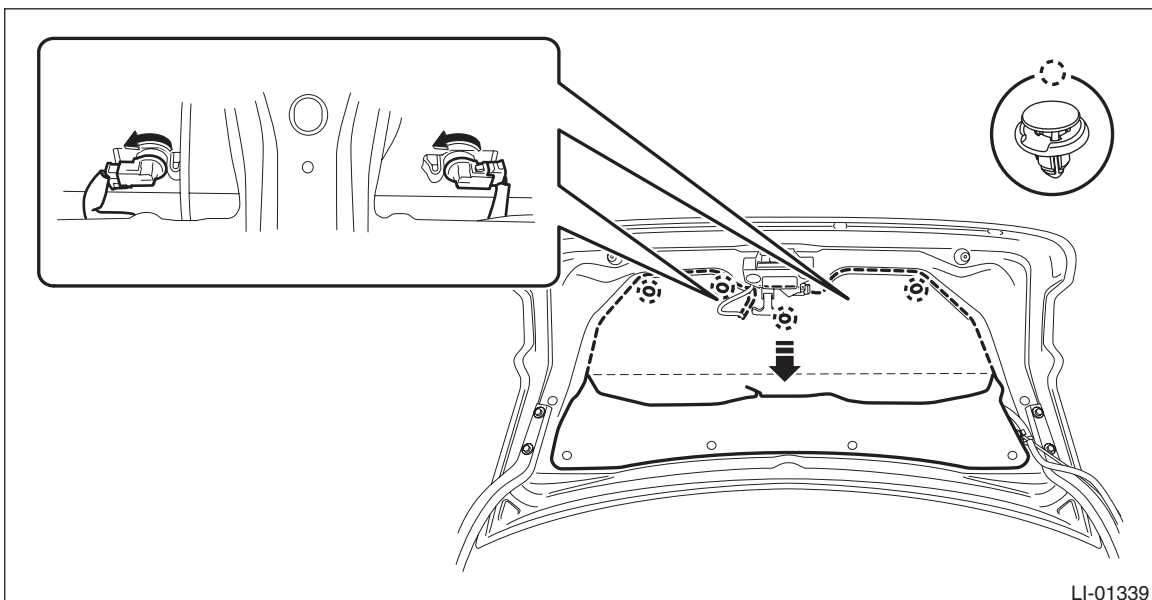

LI-01339

B: INSTALLATION

Install each part in the reverse order of removal.

C: INSPECTION

- 1) Visually check the bulb for blow out.
- 2) Check the bulb specification. <Ref. to LI-2, SPECIFICATION, General Description.>
- 3) Replace the bulb if it is found defective.