

## 10. Multi-function Display (MFD)

### A: REMOVAL

#### 1. MULTI FUNCTION DISPLAY

1) Disconnect the ground cable from battery. <Ref. to NT-5, BATTERY, NOTE, Note.>

**NOTE:**

For the 12 volt engine restart battery of HEV model, disconnect the ground terminal from 12V engine restart battery sensor.

2) Remove the center grille assembly. <Ref. to AC-104, CENTER GRILLE ASSEMBLY, REMOVAL, Air Vent Grille.>

3) Release the claw and hook, and then remove the cover center UPR.

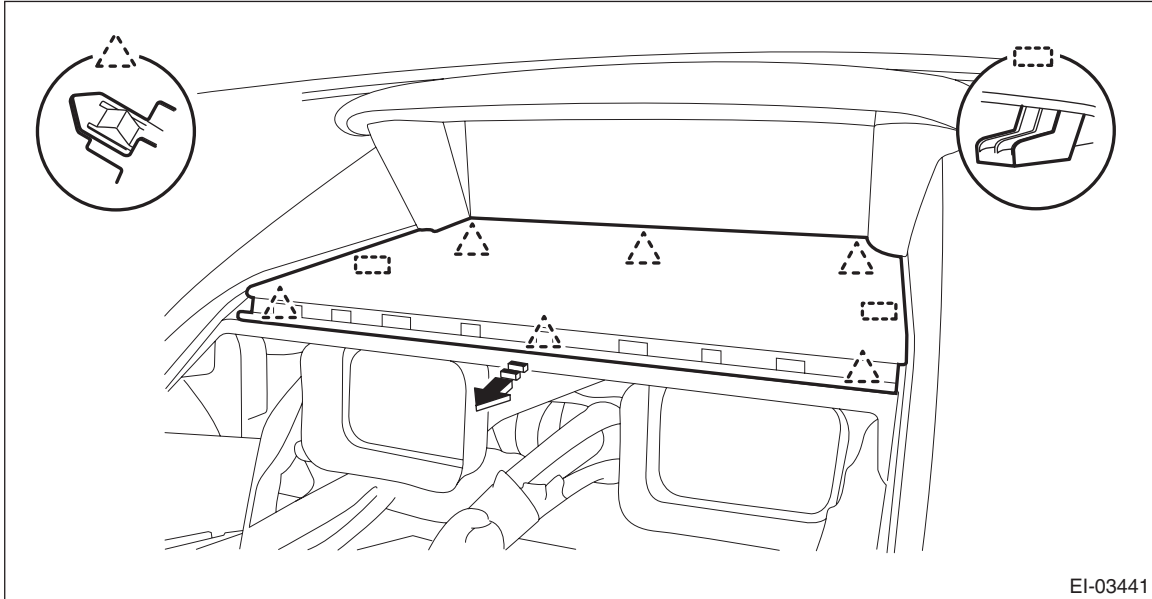

**NOTE:**

Lightly push up the back of the cover center UPR, hook the finger to the end portion and pull it toward you to remove it.

## Multi-function Display (MFD)

### INSTRUMENTATION/DRIVER INFO

4) Remove the multi-function display.

#### CAUTION:

**Be careful not to damage the multi-function display or instrument panel.**

- (1) Release the screws and claws.
- (2) Pull the multi-function display assembly toward you, and disconnect the connector.

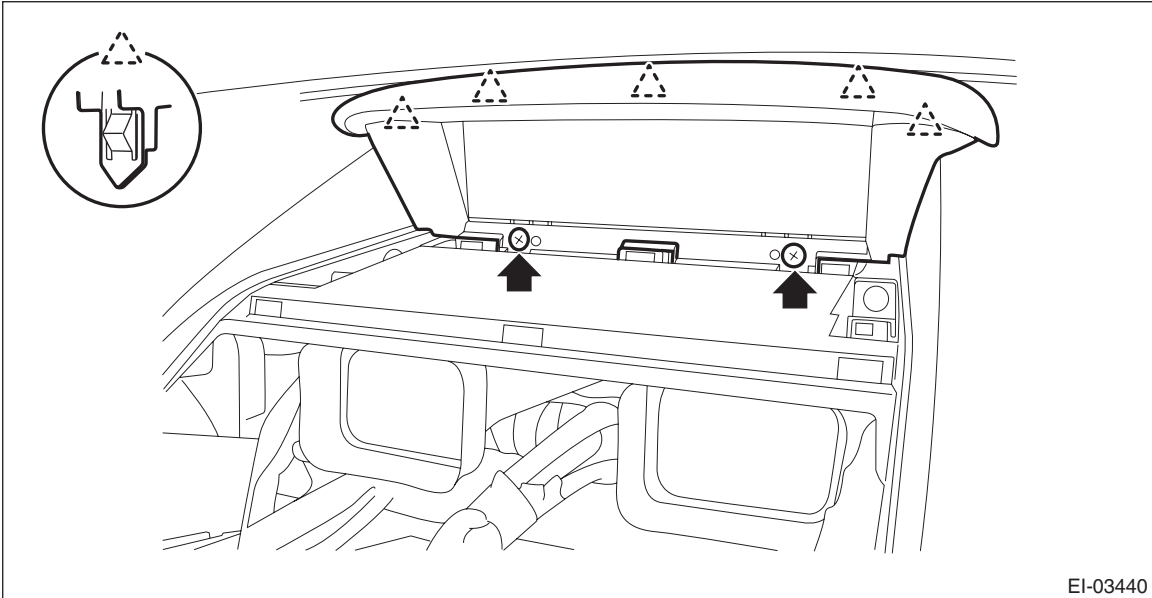

(3) Remove the screw, and remove the multi-function display from the panel - display.

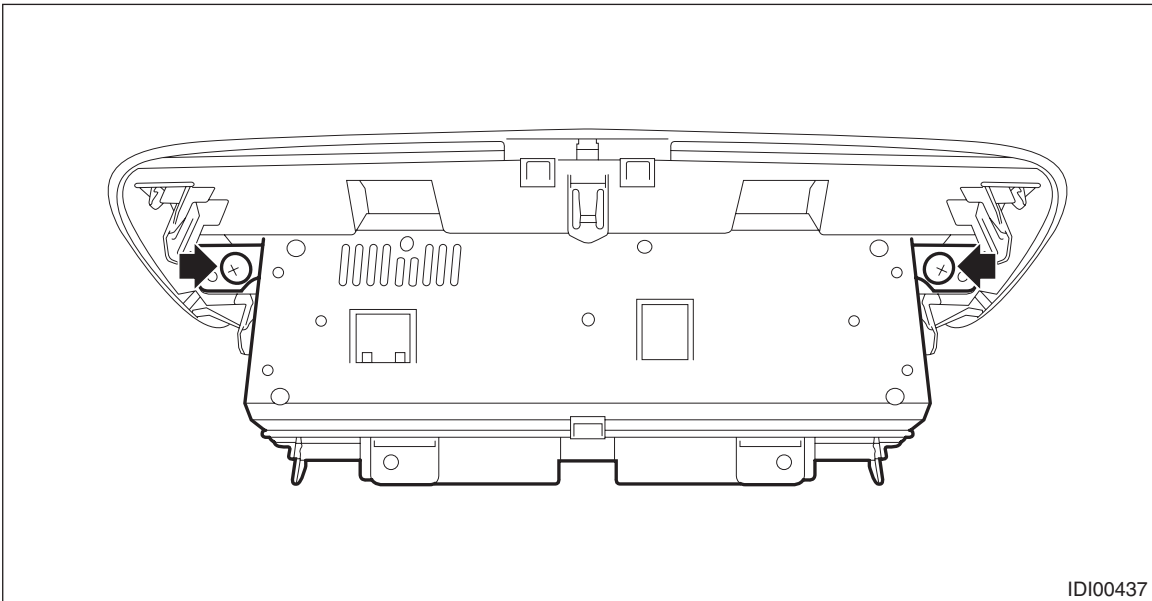

## 2. MULTI-FUNCTION DISPLAY SWITCH

1) Disconnect the ground cable from battery. <Ref. to NT-5, BATTERY, NOTE, Note.>

#### NOTE:

For the 12 volt engine restart battery of HEV model, disconnect the ground terminal from 12V engine restart battery sensor.

2) Remove the center grille assembly. <Ref. to AC-104, CENTER GRILLE ASSEMBLY, REMOVAL, Air Vent Grille.>

3) Release the claw, and remove the switch - multi-function display.

## B: INSTALLATION

### CAUTION:

- Make sure the electrical connector is connected securely.
- Make sure that the multi-function display operates normally.
- After installing the center grille assembly, check that the air vent grille of the center grille assembly is inserted correctly into the air vent duct.
- When the multi-function display has been replaced, perform the following operations.
  - Be sure to reset the ODO fuel economy value of the multi-function display (MFD). <Ref. to IDI-15, ODO FUEL ECONOMY VALUE RESET (HIGH GRADE TYPE ONLY), OPERATION, Multi-function Display (MFD) System.>
  - Be sure to correction the lifetime fuel economy value of the multi-function display (MFD). <Ref. to IDI-14, DIAGNOSTIC MODE (HIGH GRADE TYPE ONLY), OPERATION, Multi-function Display (MFD) System.>

Install each part in the reverse order of removal.

## C: INSPECTION

### 1. MULTI-FUNCTION DISPLAY SWITCH

1) Measure the resistance between connector terminals.

#### Preparation tool:

**Circuit tester**

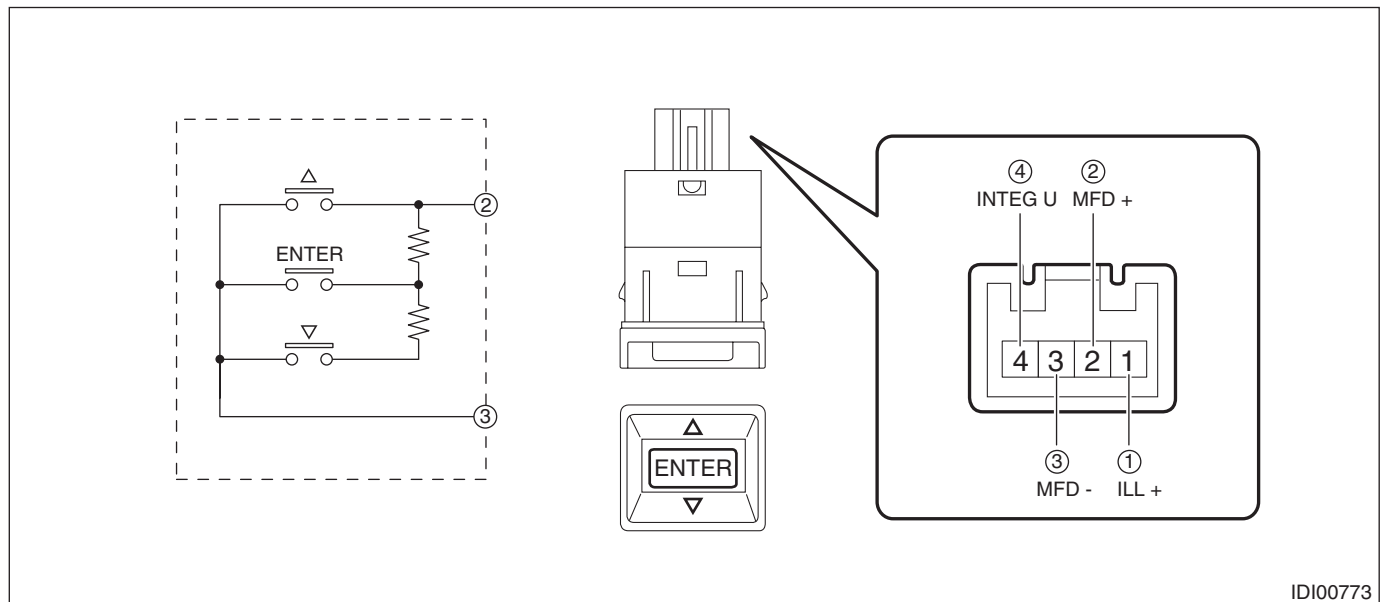

IDI00773

Terminal No.	Inspection conditions		Standard
2 — 3	△ (UP) ENTER ▽ (DOWN)	All OFF	1 MΩ or more
	△ (UP)	ON	Less than 1 Ω
	ENTER	ON	Approx. 1000 Ω
	▽ (DOWN)	ON	Approx. 3670 Ω

2) If the inspection result is not within the standard, replace the switch - multi-function display.