

7. Rear Speaker

A: REMOVAL

1) Disconnect the ground cable from battery. <Ref. to NT-5, BATTERY, NOTE, Note.>

NOTE:

For the 12 volt engine restart battery of HEV model, disconnect the ground terminal from 12V engine restart battery sensor.

2) Remove the trim panel - rear door.

(1) Attach the protective tape (a).

(2) Open the cover and remove the screw.

(3) Remove the clips, and remove the trim panel - rear door from the panel assembly - rear door.

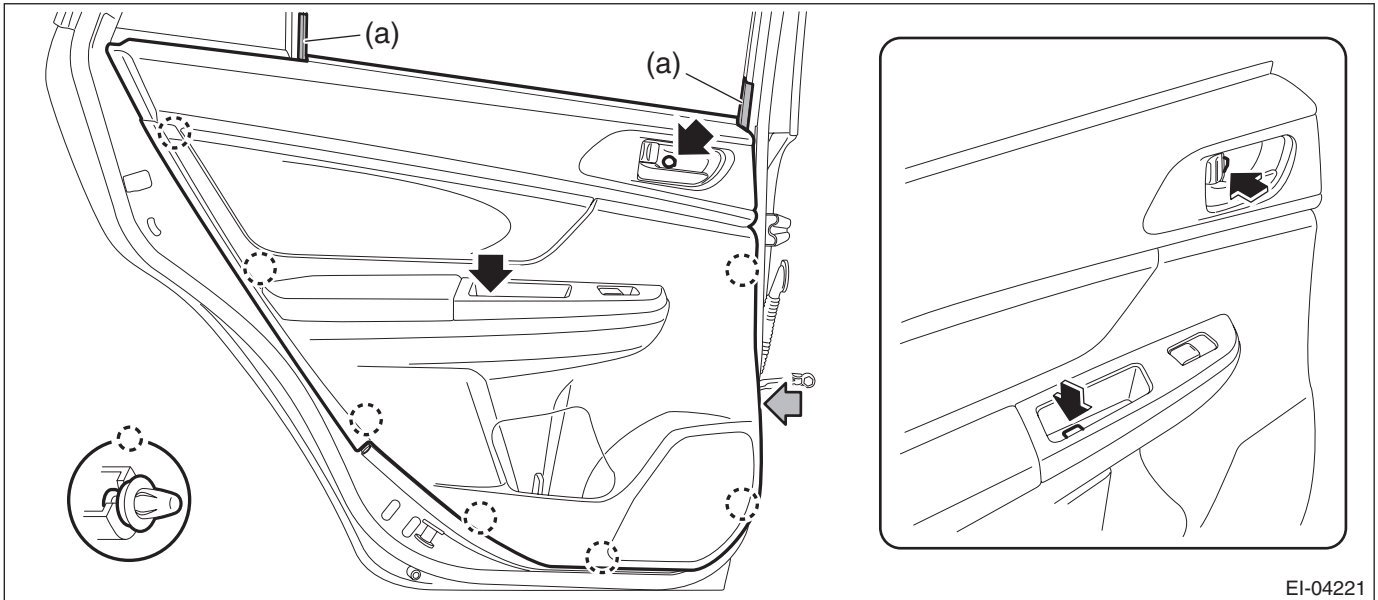

EI-04221

NOTE:

It is easier to remove the door trim if the removal is performed from the gray arrow section.

(4) Detach the door lock cable (a) and door open cable (b) from the remote assembly - door.

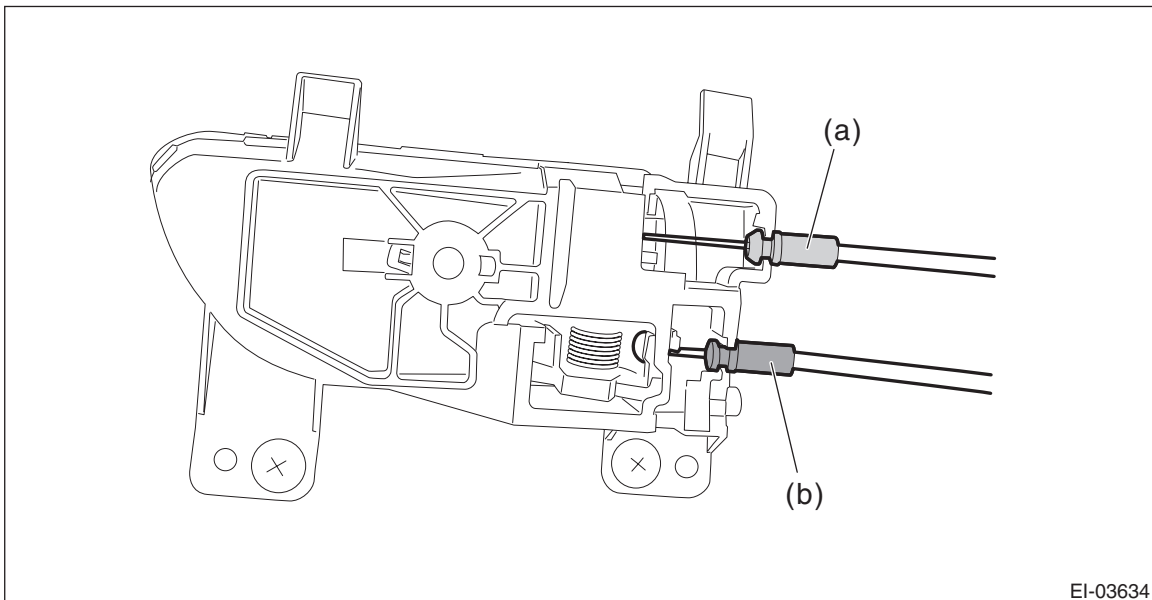

EI-03634

(5) Disconnect the harness connector and remove the trim panel - rear door.

3) Remove the rear speaker assembly.

(1) Remove the screws.

(2) Disconnect the connector behind the speaker and remove the rear speaker assembly.

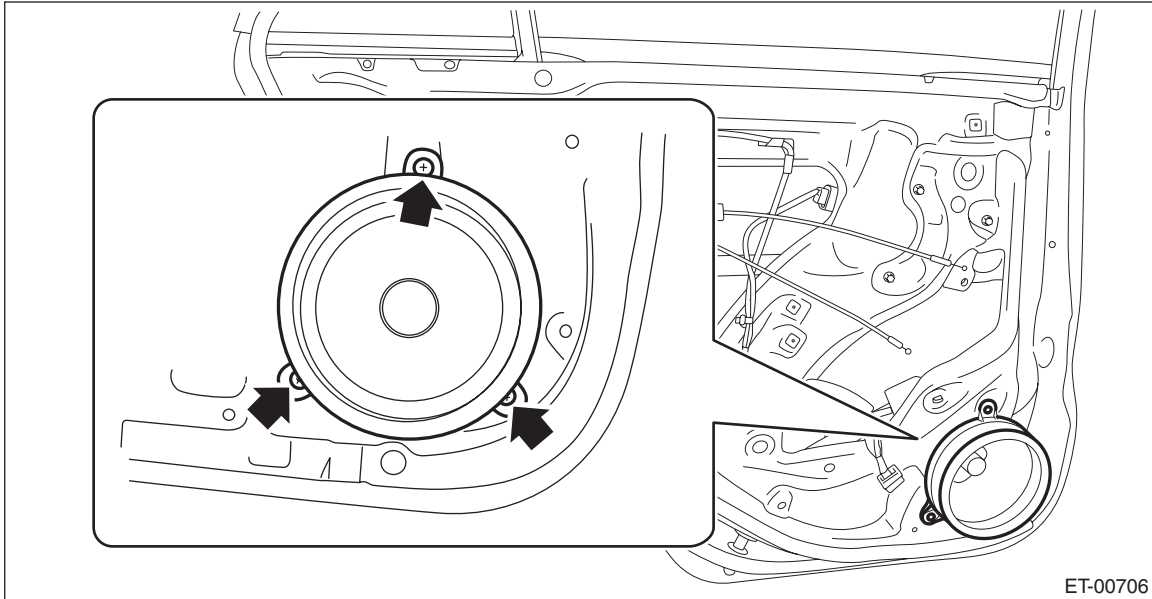

B: INSTALLATION

Install each part in the reverse order of removal.

NOTE:

Attach the door lock cable (a - end ball: small) to the upper side, and attach the door open cable (b - end ball: large) to the lower side.

