

15.Rear Accessory Power Supply Socket

A: WIRING DIAGRAM

Refer to “Rear Accessory Power Supply Socket System” in the wiring diagram.

- Gasoline engine model: <Ref. to WI(w/o HEV)-184, WIRING DIAGRAM, Rear Accessory Power Supply Socket System.>
- HEV model: <Ref. to WI(HEV)-186, WIRING DIAGRAM, Rear Accessory Power Supply Socket System.>

B: REMOVAL

- 1) Disconnect the ground cable from battery. <Ref. to NT-5, BATTERY, NOTE, Note.>

NOTE:

For the 12 volt engine restart battery of HEV model, disconnect the ground terminal from 12V engine restart battery sensor.

- 2) Remove the console box assembly. <Ref. to EI-81, REMOVAL, Console Box.>

- 3) While releasing the claw inside, press it in from the rear to remove the socket assembly.

- (1) While releasing the claw inside, press it in from the rear to remove the socket assembly.

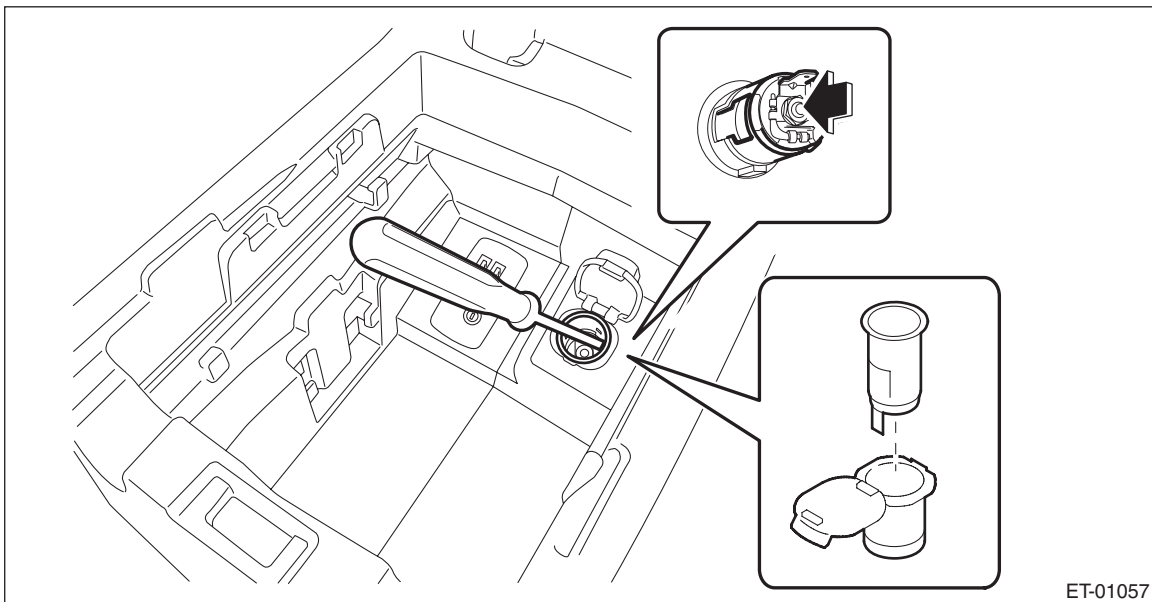

ET-01057

- (2) Remove the cap - socket.

C: INSTALLATION

Install each part in the reverse order of removal.

NOTE:

Align the grooves of the holder with the claws of accessory power supply socket.

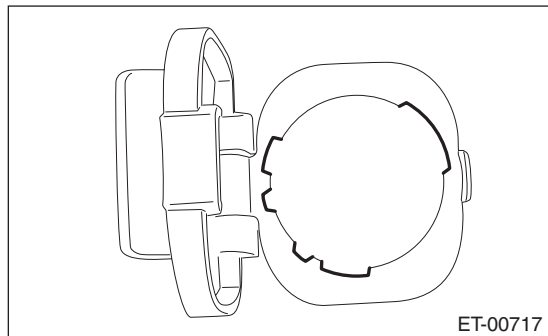

ET-00717

Tightening torque:

Console box assembly: 6.5 N·m (0.66 kgf-m, 4.8 ft-lb)