

## 7. Switches and Harness

### A: REMOVAL

#### 1. BACK-UP LIGHT AND NEUTRAL POSITION SWITCH

- 1) Disconnect the ground cable from battery.
- 2) Remove the intercooler. <Ref. to IN(w/o STI)-12, REMOVAL, Intercooler.>
- 3) Disconnect the connector back-up light switch & neutral position switch.

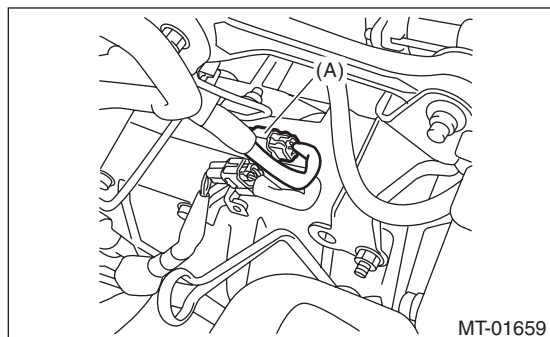

(A) Neutral position switch and back-up light switch connector

- 4) Lift up the vehicle.
- 5) Remove the back-up light switch & neutral position switch with the harness.

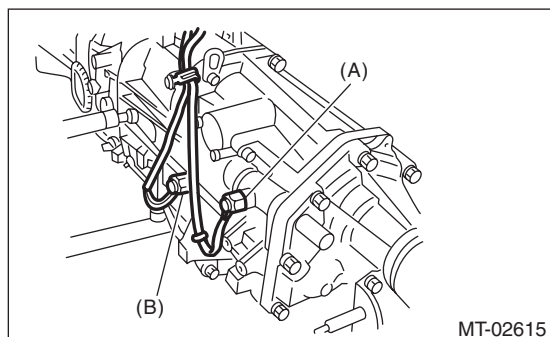

(A) Neutral position switch  
(B) Back-up light switch

### B: INSTALLATION

#### 1. BACK-UP LIGHT AND NEUTRAL POSITION SWITCH

- 1) Install the back-up light switch & neutral position switch with the harness.

#### Tightening torque:

**32.3 N·m (3.3 kgf·m, 23.8 ft·lb)**

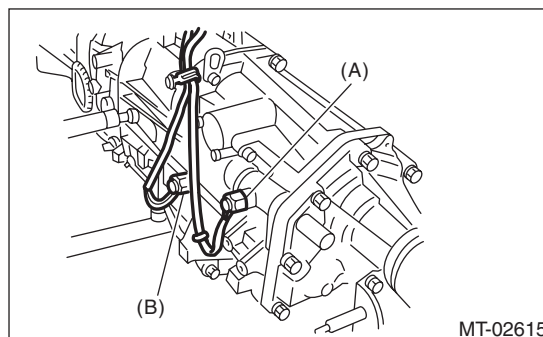

(A) Neutral position switch  
(B) Back-up light switch

- 2) Connect the connectors of back-up light switch & neutral position switch.
- 3) Install the intercooler. <Ref. to IN(w/o STI)-12, INSTALLATION, Intercooler.>
- 4) Connect the battery ground terminal.

### C: INSPECTION

#### 1. BACK-UP LIGHT SWITCH

Check the back-up light switch. <Ref. to LI-8, INSPECTION, Back-up Light System.>

#### 2. NEUTRAL POSITION SWITCH

- 1) Turn the ignition switch to OFF.
- 2) Disconnect the connector of neutral position switch.
- 3) Measure the resistance between neutral position switch terminals.

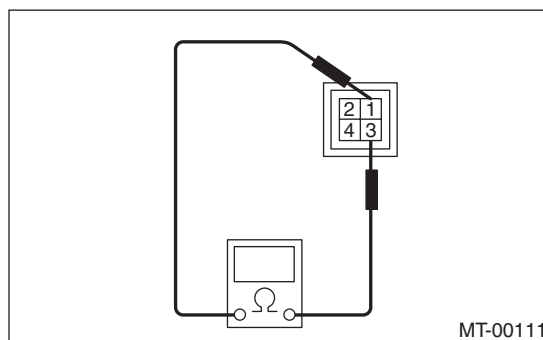

Gear shift position	Terminal No.	Specified resistance
Neutral position	1 and 3	Less than 1 Ω
Other positions		1 MΩ or more

- 4) Replace faulty parts.