

### 7. Clutch Pipe and Hose

#### A: REMOVAL

- 1) Disconnect the ground cable from battery.
- 2) Remove the intercooler. <Ref. to IN(STI)-12, REMOVAL, Intercooler.> <Ref. to IN(w/o STI)-12, REMOVAL, Intercooler.>
- 3) Drain the clutch fluid. <Ref. to CL-25, Clutch Fluid.>
- 4) Disconnect the clutch pipe from the clutch hose and master cylinder.
- 5) Remove the clip, then remove the clutch hose from the bracket.

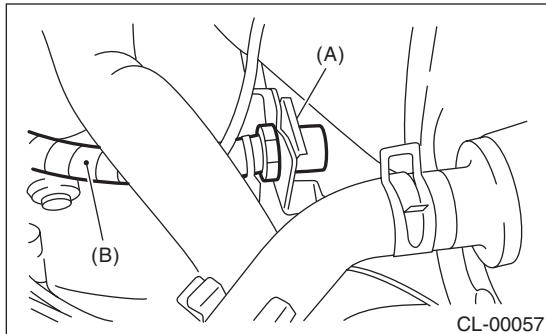

- (A) Clip  
(B) Clutch hose

- 6) Disconnect the hose from operating cylinder.
- 7) Remove the clutch bracket.

#### B: INSTALLATION

Install in the reverse order of removal.

##### NOTE:

Bleed air from the clutch fluid. <Ref. to CL-26, Clutch Fluid Air Bleeding.>

##### Tightening torque:

**T1: 15 N·m (1.5 kgf-m, 11.1 ft-lb)**

**T2: 18 N·m (1.8 kgf-m, 13.3 ft-lb)**

**T3: 25 N·m (2.5 kgf-m, 18.4 ft-lb)**

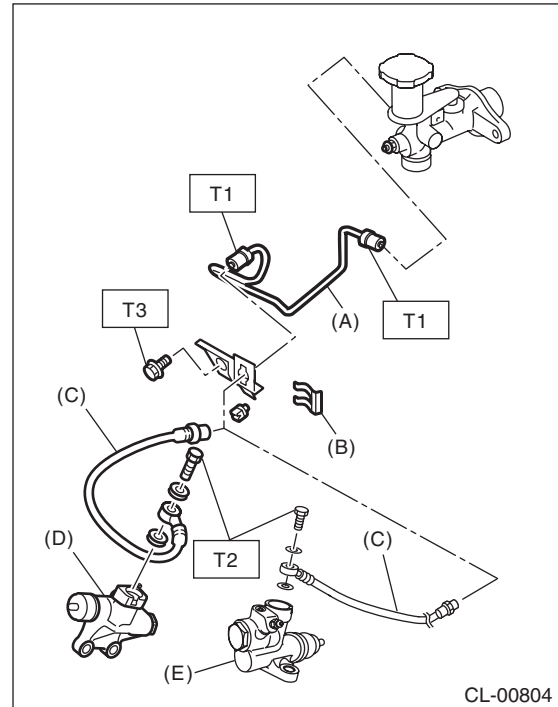

- (A) Clutch pipe  
(B) Clip  
(C) Clutch hose  
(D) STI model  
(E) Except for STI model

#### C: INSPECTION

Check the pipes and hoses for breaks and damage. Check joints for fluid leakage. If crack, breakage or damage is found, repair or replace the faulty pipe or hose.