

## 14. Timing Belt Cover

### A: REMOVAL

#### NOTE:

When replacing a single part, perform the work with the engine assembly installed to body.

- 1) Remove the secondary air pump. <Ref. to EC(w/o STI)-29, REMOVAL, Secondary Air Pump.>
- 2) Remove the crank pulley. <Ref. to ME(w/o STI)-45, REMOVAL, Crank Pulley.>
- 3) Remove the timing belt cover RH (A).
- 4) Remove the timing belt cover LH (B).
- 5) Remove the front timing belt cover (C).

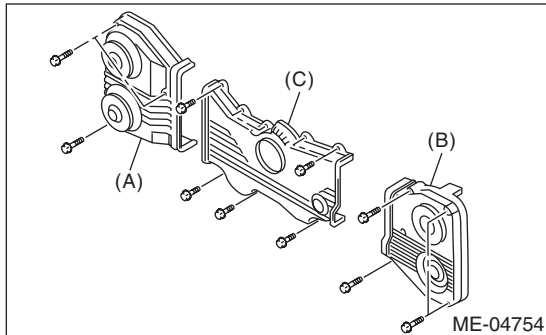

### B: INSTALLATION

- 1) Install the front timing belt cover (C).

#### **Tightening torque:**

**5 N·m (0.5 kgf-m, 3.7 ft-lb)**

- 2) Install the timing belt cover LH (B).

#### **Tightening torque:**

**5 N·m (0.5 kgf-m, 3.7 ft-lb)**

- 3) Install the timing belt cover RH (A).

#### **Tightening torque:**

**5 N·m (0.5 kgf-m, 3.7 ft-lb)**

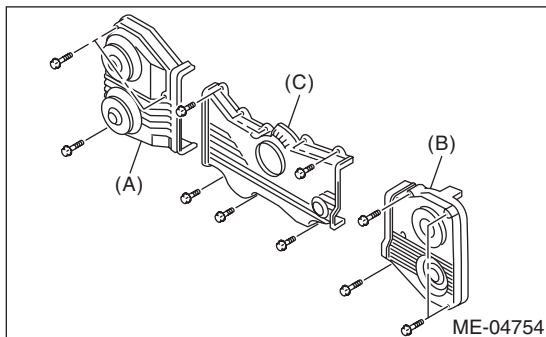

- 4) Install the crank pulley. <Ref. to ME(w/o STI)-45, INSTALLATION, Crank Pulley.>
- 5) Install the secondary air pump. <Ref. to EC(w/o STI)-29, INSTALLATION, Secondary Air Pump.>

### C: INSPECTION

Check the timing belt cover for damage.